

**REMOVAL OF EXISTING TRAFFIC SIGNAL EQUIPMENT**

THE FOLLOWING ITEMS SHALL BE REMOVED BY THE CONTRACTOR AND SHALL BE DISPOSED OF BY THEM OUTSIDE THE RIGHT-OF-WAY AT THEIR EXPENSE. THE SALVAGE VALUE OF THE REMOVED EQUIPMENT SHALL BE REFLECTED IN THE CONTRACT BID PRICE.

- 1 EACH CONTROLLER AND CABINET (COMPLETE)
- 8 EACH SIGNAL HEAD, 1 - FACE, 3 - SECTION
- 4 EACH SIGNAL HEAD, 1 - FACE, 5 - SECTION
- 6 EACH TRAFFIC SIGNAL BACKPLATE
- 2 EACH SIGNAL POST
- 8 EACH PEDESTRIAN SIGNAL HEAD, 1-FACE
- 7 EACH PEDESTRIAN PUSHBUTTON
- 1 EACH SERVICE INSTALLATION

**NOTES:**

- 1) EXISTING SIGNAL SHALL REMAIN OPERATIONAL DURING CONSTRUCTION.
- 2) TRAFFIC POSTS AND EQUIPMENT MOUNTED TO THEM SHALL NOT BE REMOVED UNTIL PROPOSED MAST ARM ASSEMBLIES ARE ENERGIZED AND APPROVED FOR OPERATION BY THE ENGINEER.

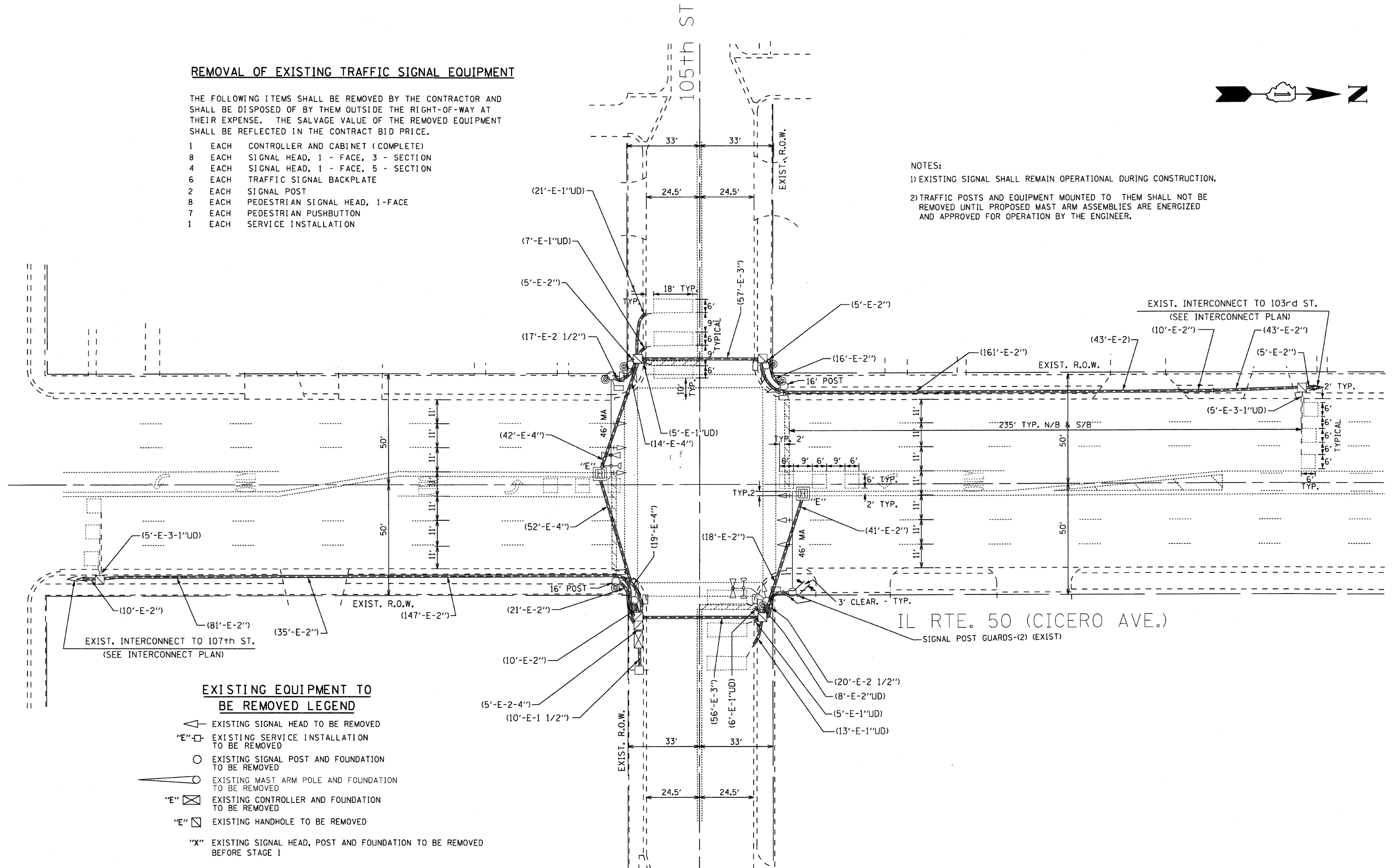
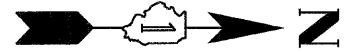

**EXISTING EQUIPMENT TO BE REMOVED LEGEND**

- ◁ EXISTING SIGNAL HEAD TO BE REMOVED
- "E" □ EXISTING SERVICE INSTALLATION TO BE REMOVED
- EXISTING SIGNAL POST AND FOUNDATION TO BE REMOVED
- ◁ EXISTING MAST ARM POLE AND FOUNDATION TO BE REMOVED
- "E" ⊠ EXISTING CONTROLLER AND FOUNDATION TO BE REMOVED
- "E" ⊠ EXISTING HANDHOLE TO BE REMOVED
- "X" EXISTING SIGNAL HEAD, POST AND FOUNDATION TO BE REMOVED BEFORE STAGE 1

FILE NAME =	USER NAME = #USER#	DESIGNED - JS	REVISED -	<b>STATE OF ILLINOIS DEPARTMENT OF TRANSPORTATION</b>	<b>IL ROUTE 50 (CICERO AVE.) AND 105TH ST. REMOVE EXISTING TRAFFIC SIGNAL EQUIPMENT PLAN</b>	F.A.P. RTE.	SECTION	COUNTY	TOTAL SHEETS	SHEET NO.
#FILE#	DRAWN - DW	REVISOR -	350			2009-013 TS	COOK	29	12	
PLOT SCALE = #SCALE#	CHECKED - JD	REVISOR -	CONTRACT NO. 60G11							
PLOT DATE = #DATE#	DATE -	REVISOR -	FED. ROAD DIST. NO. [ILLINOIS] FED. AID PROJECT							
					SCALE: 1"=20'	SHEET NO. 12 OF 29 SHEETS		STA. TO STA.		