

TRAFFIC SIGNAL LEGEND

- CONTROLLER
- SERVICE INSTALLATION
- SIGNAL HEAD
- SIGNAL HEAD WITH BACKPLATE
- SIGNAL HEAD, PEDESTRIAN
- SIGNAL POST
- MAST ARM ASSEMBLY AND POLE, STEEL
- MAST ARM ASSEMBLY AND POLE, ALUMINUM
- COMMON TRENCH
- UNIT DUCT
- HANDHOLE
- HEAVY DUTY HANDHOLE
- DOUBLE HANDHOLE
- G.S. CONDUIT IN TRENCH OR PUSHED
- PEDESTRIAN PUSHBUTTON DETECTOR
- DETECTOR LOOP
- CAST IRON JUNCTION BOX
- EMERGENCY VEHICLE SYSTEM DETECTOR
- CONFIRMATION BEACON
- SIGNAL HEAD OPTICALLY PROGRAMMED
- CONDUIT SPLICE
- WOOD POLE
- RACEWAY FOR MAGNETIC DETECTOR, TYPE I OR TYPE II
- VEHICLE DETECTOR, NON COMPENSATED MAGNETIC TYPE
- RAILROAD CONTROL CABINET
- ILLUMINATED SIGN, FIBER OPTIC "NO LEFT TURN"
- ILLUMINATED SIGN, FIBER OPTIC "NO RIGHT TURN"
- TELEPHONE
- UNINTERRUPTED POWER SUPPLY

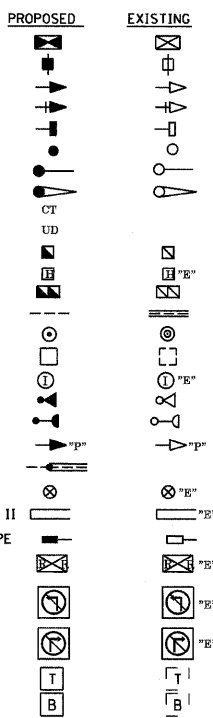

INSTALL NEW SERVICE AT EXIST. LOCATION

RESTORATION OF WORK AREA, RESTORATION OF THE TRAFFIC SIGNAL WORK AREA SHALL BE INCIDENTAL TO THE RELATED PAY ITEM SUCH AS FOUNDATION, CONDUIT, HANDHOLE, TRENCH AND BACKFILL, ETC., AND NO EXTRA COMPENSATION SHALL BE ALLOWED. ALL ROADWAY SURFACES SUCH AS SHOULDERS, MEDIAN, SIDEWALKS, PAVEMENT ETC. SHALL BE REPLACED IN KIND. ALL DAMAGE TO MOWED LAWNS SHALL BE REPLACED WITH AN APPROVED SOD, AND ALL DAMAGE TO UNMOWED FIELDS SHALL BE SEEDED IN ACCORDANCE WITH STANDARD SPECIFICATIONS 252 AND 250 RESPECTIVELY.

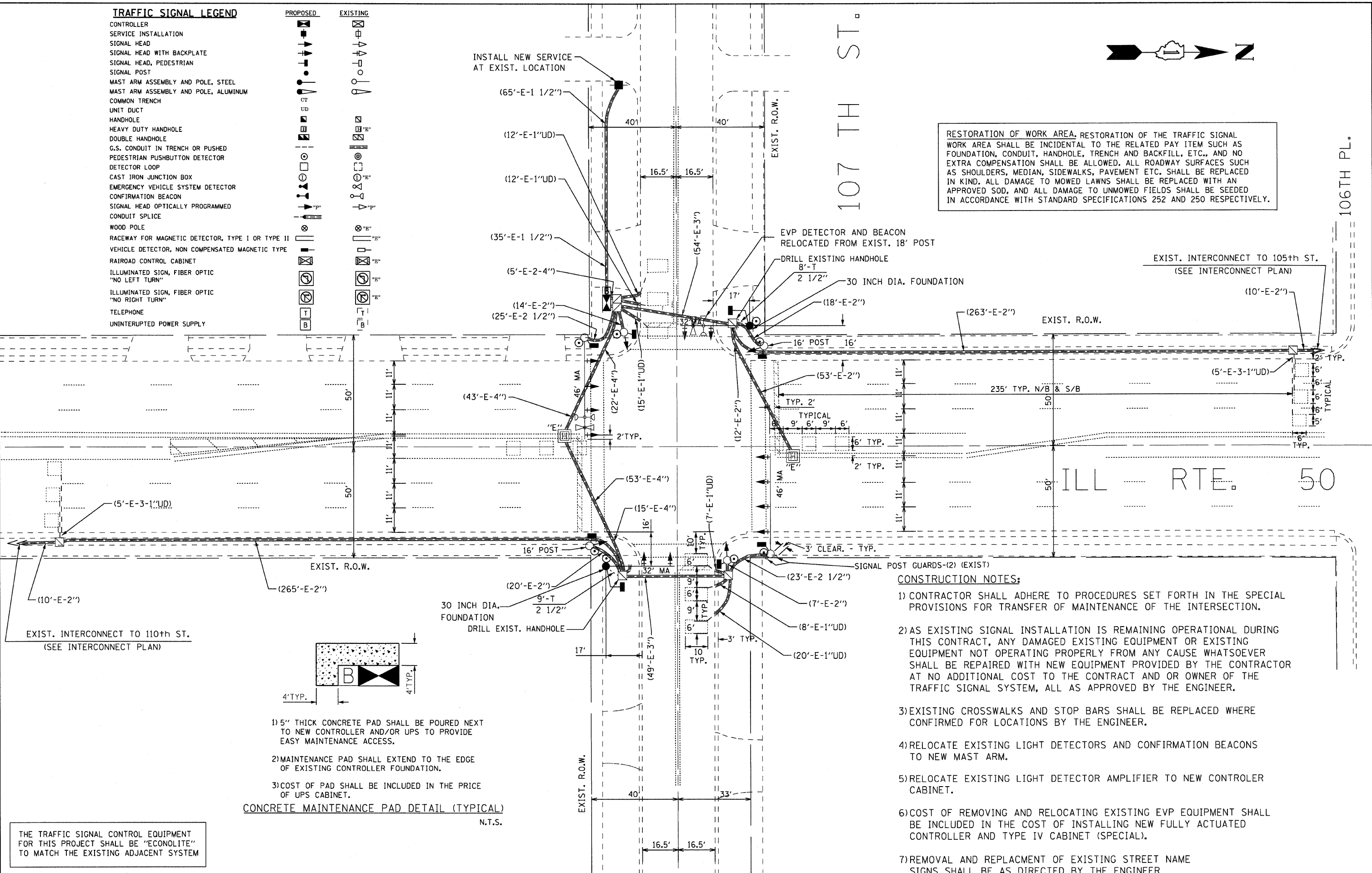

EXIST. INTERCONNECT TO 110th ST. (SEE INTERCONNECT PLAN)

EXIST. INTERCONNECT TO 105th ST. (SEE INTERCONNECT PLAN)

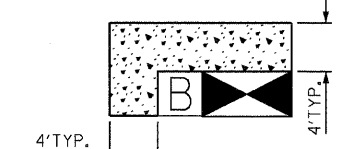

- 1) 1.5" THICK CONCRETE PAD SHALL BE POURED NEXT TO NEW CONTROLLER AND/OR UPS TO PROVIDE EASY MAINTENANCE ACCESS.
- 2) MAINTENANCE PAD SHALL EXTEND TO THE EDGE OF EXISTING CONTROLLER FOUNDATION.
- 3) COST OF PAD SHALL BE INCLUDED IN THE PRICE OF UPS CABINET.

CONCRETE MAINTENANCE PAD DETAIL (TYPICAL) N.T.S.

THE TRAFFIC SIGNAL CONTROL EQUIPMENT FOR THIS PROJECT SHALL BE "ECONOLITE" TO MATCH THE EXISTING ADJACENT SYSTEM

CONSTRUCTION NOTES:

- 1) CONTRACTOR SHALL ADHERE TO PROCEDURES SET FORTH IN THE SPECIAL PROVISIONS FOR TRANSFER OF MAINTENANCE OF THE INTERSECTION.
- 2) AS EXISTING SIGNAL INSTALLATION IS REMAINING OPERATIONAL DURING THIS CONTRACT, ANY DAMAGED EXISTING EQUIPMENT OR EXISTING EQUIPMENT NOT OPERATING PROPERLY FROM ANY CAUSE WHATSOEVER SHALL BE REPAIRED WITH NEW EQUIPMENT PROVIDED BY THE CONTRACTOR AT NO ADDITIONAL COST TO THE CONTRACT AND OR OWNER OF THE TRAFFIC SIGNAL SYSTEM, ALL AS APPROVED BY THE ENGINEER.
- 3) EXISTING CROSSWALKS AND STOP BARS SHALL BE REPLACED WHERE CONFIRMED FOR LOCATIONS BY THE ENGINEER.
- 4) RELOCATE EXISTING LIGHT DETECTORS AND CONFIRMATION BEACONS TO NEW MAST ARM.
- 5) RELOCATE EXISTING LIGHT DETECTOR AMPLIFIER TO NEW CONTROLLER CABINET.
- 6) COST OF REMOVING AND RELOCATING EXISTING EVP EQUIPMENT SHALL BE INCLUDED IN THE COST OF INSTALLING NEW FULLY ACTUATED CONTROLLER AND TYPE IV CABINET (SPECIAL).
- 7) REMOVAL AND REPLACEMENT OF EXISTING STREET NAME SIGNS SHALL BE AS DIRECTED BY THE ENGINEER

FILE NAME =	USER NAME = *USER*	DESIGNED - JS	REVISED -	STATE OF ILLINOIS DEPARTMENT OF TRANSPORTATION	IL ROUTE 50 (CICERO AVE.) AND 107TH ST. TRAFFIC SIGNAL MODERNIZATION PLAN	F.A.P. RTE. 350	SECTION 2009-013 TS	COUNTY COOK	TOTAL SHEETS 29	SHEET NO. 16	
*FILE#		DRAWN - DW	REVISED -			SCALE: 1"=20'		SHEET NO. 16 OF 29 SHEETS		STA. TO STA.	
		CHECKED - JD	REVISED -			FED. ROAD DIST. NO. [ILLINOIS] FED. AID PROJECT					
		DATE -	REVISED -			CONTRACT NO. 60G11					