

F.A.P. RTE.	SECTION	COUNTY	TOTAL SHEETS	SHEET NO.
326	2009-001 RS	KANE	37	1
FED. ROAD DIST. NO. 1	ILLINOIS	CONTRACT NO. 60G12		

FOR INDEX OF SHEETS, SEE SHEET NO. 2

DESIGN DESIGNATION:

SPEED LIMIT : 55 M.P.H. TO 45 M.P.H.

2007 ADT = 20,900

PROJECT IS LOCATED IN THE VILLAGE OF SUGAR GROVE

STATE OF ILLINOIS
DEPARTMENT OF TRANSPORTATION
DIVISION OF HIGHWAYS

PROPOSED
HIGHWAY PLANS

F.A.P. 326 / US 30 / IL 47

SECTION: 2009-001 RS

US 30 / IL 56 TO KENDALL COUNTY LINE & RAMPS AT IL 47

RESURFACING (3P)

PROJECT: *ESP-0326(079)*

KANE AND ~~KENDALL~~ COUNTIES

C-91-328-09

D-91-328-09



PROJECT ENDS
STA. 231 + 68

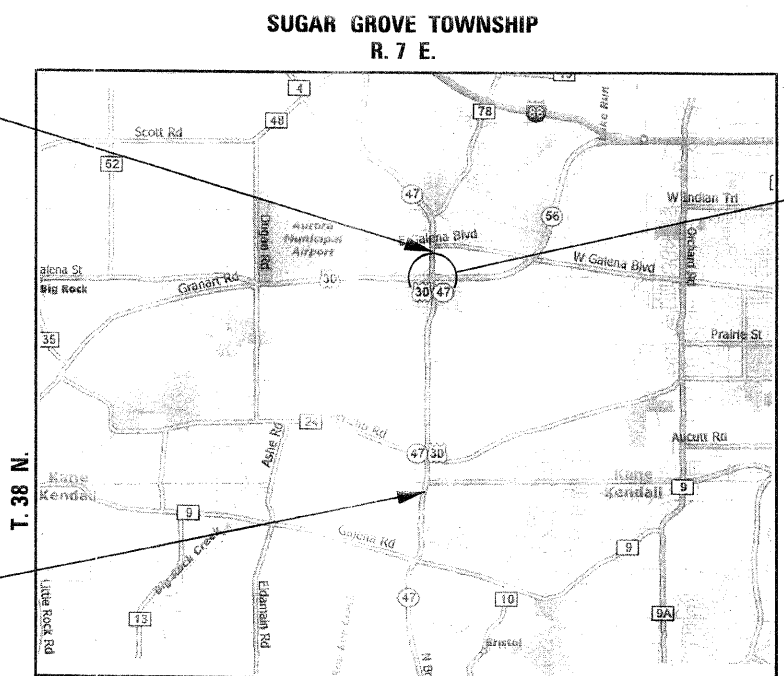

RAMPS
'A', 'B', 'B-1', 'C',
'D', 'E', 'F', 'F-1'

PROJECT BEGINS
STA. 44 + 40

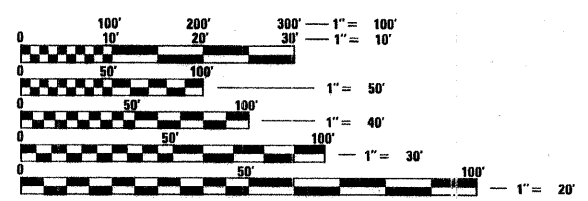

FULL SIZE PLANS HAVE BEEN PREPARED USING STANDARD ENGINEERING SCALES. REDUCED SIZED PLANS WILL NOT CONFORM TO STANDARD SCALES. IN MAKING MEASUREMENTS ON REDUCED PLANS, THE ABOVE SCALES MAY BE USED.

J.U.L.I.E.
JOINT UTILITY LOCATING INFORMATION FOR EXCAVATORS
1-800-892-0123
OR 811

DISTRICT ONE - DESIGN
PLAN PREP ENGINEER: KEN ENG (847) 705-4247

CONTRACT NO. 60G12

GROSS LENGTH OF PROJECT = 18,728 FEET = 3.547 MILES
NET LENGTH OF PROJECT = 18,728 FEET = 3.547 MILES

STATE OF ILLINOIS
DEPARTMENT OF TRANSPORTATION
DIVISION OF HIGHWAYS

SUBMITTED JANUARY 30, 2008

Diana M. O'Keefe
DEPUTY DIRECTOR OF HIGHWAYS, REGION ONE ENGINEER

March 27, 2009
Charles G. Ingersoll
ENGINEER OF DESIGN AND ENVIRONMENT

March 27, 2009
Christine M. Reed
DIRECTOR OF HIGHWAYS, CHIEF ENGINEER



Birinder S. Sachdeva
BIRINDER S. SACHDEVA, P.E.
EXPIRES: 11-30-2009

January 28, 2009
DATE

PRINTED BY THE AUTHORITY
OF THE STATE OF ILLINOIS

CHRISTIAN-ROGE & ASSOCIATES, INC.
ENGINEERS - PLANNERS - SURVEYORS
211 W. WACKER DRIVE CHICAGO, IL. 60606
TELEPHONE: 312-372-2023