

F.A.I. RTE.	SECTION	COUNTY	TOTAL SHEETS	SHEET NO.
90/94	0202.6-2P, ETC, 1415 & 1517R-7	COOK	246	33
STA. 35+00		TO STA. 50+00		
FED. ROAD DIST. NO.	ILLINOIS	FED. AID PROJECT	CONTRACT NO. 62408	

TEMPORARY CONCRETE BARRIER LAYOUT (TO FF)

LOCATION	STATION	OFFSET
D	42+35.54 E.B.	25.00' LT
E	43+22.74 E.B.	32.27' LT

PLAN

SURVEYED	BY	DATE
ALIGNED		
CHECKED		
RT. OF WAY		
CHECKED		
NO.		

PROFILE

SURVEYED	BY	DATE
GRADES		
CHECKED		
BLM. NOTES		
STRUCTURE		
NOTATIONS		
CHECKED		
NO.		

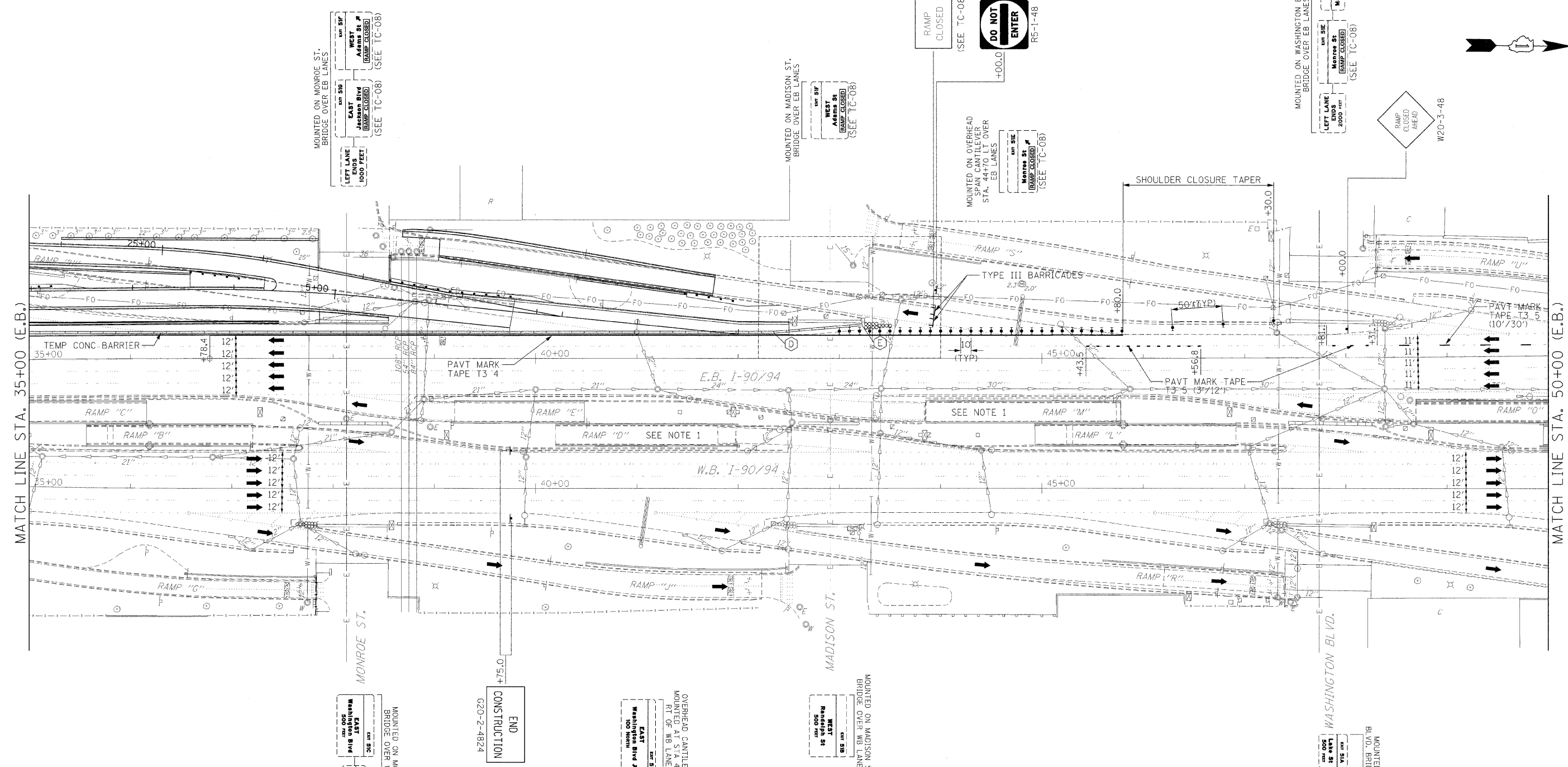

- LEGEND**
- ◆ TYPE II BARRICADE, DRUM OR VERTICAL BARRICADE WITH STEADY BURN MONODIRECTIONAL LIGHT
 - ◆ DIRECTION INDICATOR BARRICADE WITH STEADY BURN MONODIRECTIONAL LIGHT
 - DRUM WITH STEADY BURNING MONODIRECTIONAL LIGHT
 - ↑ ARROW BOARD
 - ↓ SIGN
 - ▨ CONSTRUCTION AREA

NOTES:
 1.) THE ELEVATED PORTION OF RAMP HAS ALREADY BEEN REMOVED AND THE RETAINED EARTH PORTION IS ALL THAT REMAINS.

ILLINOIS DEPARTMENT OF TRANSPORTATION
MAINTENANCE OF TRAFFIC
 I-90/94 KENNEDY EXPRESSWAY
 STAGE 1
 STA. 35+00 TO STA. 50+00
 SCALE: 1" = 50'
 DATE: 02/06/09
 DRAWN BY: BEC
 CHECKED BY: GB

