

F.A.P. RTE.	SECTION	COUNTY	TOTAL SHEETS	SHEET NO.
337	20R-6	LAKE	149	18
STA.		TO STA.		
FED. ROAD DIST. NO.		ILLINOIS FED. AID PROJECT		
CONTRACT NO. 62519				

PROP. CURVE CR1  
 PI STA = 104+841.324  
 $\Delta = 43^\circ 45' 54''$  (LT)  
 R = 750.000 m  
 T = 301.232 m  
 L = 572.883 m  
 E = 58.233 m  
 $e = 2.6\%$   
 T.R. = 25.2m  
 S.E. RUN. = 37.5m  
 P.C. STA = 104+540.092  
 P.T. STA = 105+112.975

PROP. CURVE MC1  
 PI STA = 9+950.121  
 $\Delta = 3^\circ 39' 33''$  (LT)  
 R = 2,328.501 m  
 T = 74.382 m  
 L = 148.714 m  
 E = 1.188 m  
 $e = NC$   
 P.C. STA = 9+875.739  
 P.T. STA = 10+024.453

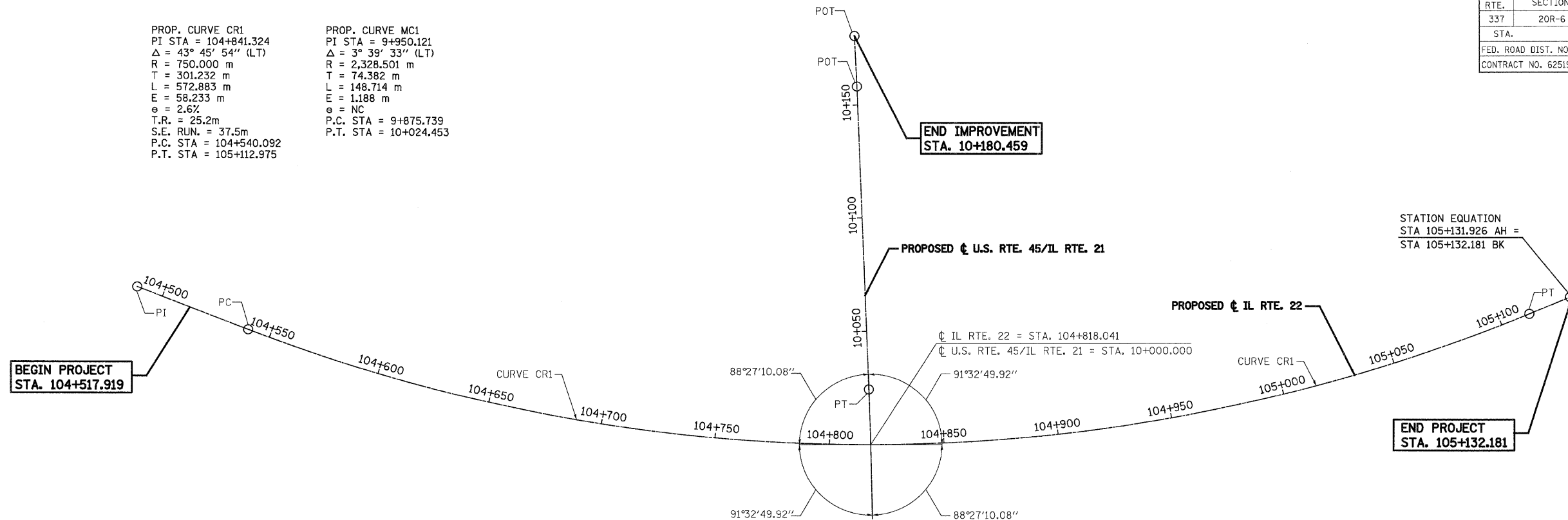

COORDINATE TABLE					
	DESCRIPTION	ALIGNMENT POINT	N	E	
IL RTE. 22		PI 104+488.234	614110.1928	332840.5597	
		BEGIN PROJECT	104+517.919	614107.6056	332870.1317
	CURVE CR1		PC 104+540.092	614105.6730	332892.2208
			PI 104+841.324	614079.4189	333192.3065
			PT 105+112.975	614268.0286	333427.1833
	END PROJECT	105+132.181	614280.0540	333442.1587	
U.S. RTE. 45/ IL RTE. 21		BEGIN IMPROVEMENT	9+845.844	613984.5266	333209.6205
	CURVE MC1		PC 9+875.739	614013.4397	333202.0233
			PI 9+950.121	614085.3800	333183.1203
			PT 10+024.453	614155.9671	333159.6644
		POT 10+158.234	614282.9227	333117.4773	
	END IMPROVEMENT	POT 10+180.459	614303.9377	333110.2428	

SUPERELEVATION TRANSITIONS						
LT EOP	PGL EL.	X-SLOPE	PROP $\bar{C}$ STATION	X-SLOPE	PGL EL.	RT EOP
201.564	201.708	-2.00% (NC)	104+517.919	0.20% (SE)	201.708	201.722
201.403	201.547	-2.00% (NC)	104+540.092 (PC)	1.70% (SE)	201.547	201.669
201.266	201.453	-2.60% (SE)	104+553.116	2.60% (SE)	201.453	201.640
200.927	201.114	-2.60% (SE)	104+600.000	2.60% (SE)	201.114	201.301
199.011	199.198	-2.60% (SE)	105+099.116	2.60% (SE)	199.198	199.385
199.190	199.363	-2.40% (NC)	105+112.975 (PT)	2.40% (SE)	199.363	199.536
199.380	199.524	-2.00% (NC)	105+132.181	2.00% (SE)	199.524	199.668

SIDE ROAD COORDINATE TABLE		
STATION EQUATION	N	E
$\bar{C}$ IL RTE. 22 = STA. 104+818.041	614132.7227	333167.2545
$\bar{C}$ U.S. RTE. 45/IL RTE. 21 = STA. 10+000.000		

P:\Lisle\DOT\917\A0\Drawings\RDWY\MF\Shfts\AIN\S\_Alf\_01.dgn  
 PDF(Grey\_Large).plt  
 5:06:45 PM  
 2/5/2009  
 Hkoepfen(Rdwy\_Lisle)



REVISIONS		ILLINOIS DEPARTMENT OF TRANSPORTATION FAP ROUTE 337 (IL ROUTE 22) ALIGNMENT, TIES, & BENCHMARKS
NAME	DATE	

SCALE: 1:1000  
 DATE: 1/28/2009  
 DRAWN BY: TCK  
 CHECKED BY: DTH