

F.A.P. RTE.	SECTION	COUNTY	TOTAL SHEETS	SHEET NO.
337	20R-6	LAKE	149	26
STA.	TO STA.			
FED. ROAD DIST. NO.	ILLINOIS FED. AID PROJECT			
CONTRACT NO. 62519				

P:\Lise\DOT\9717\AO\Drawings\RDWY\MOT\Shts\MOT\S\_MOT\_01\_00.dgn  
 PDF(Grey\_Large).plt  
 5:07:20 PM  
 2/5/2009  
 kkoepchen(Rdwy\_Lise)

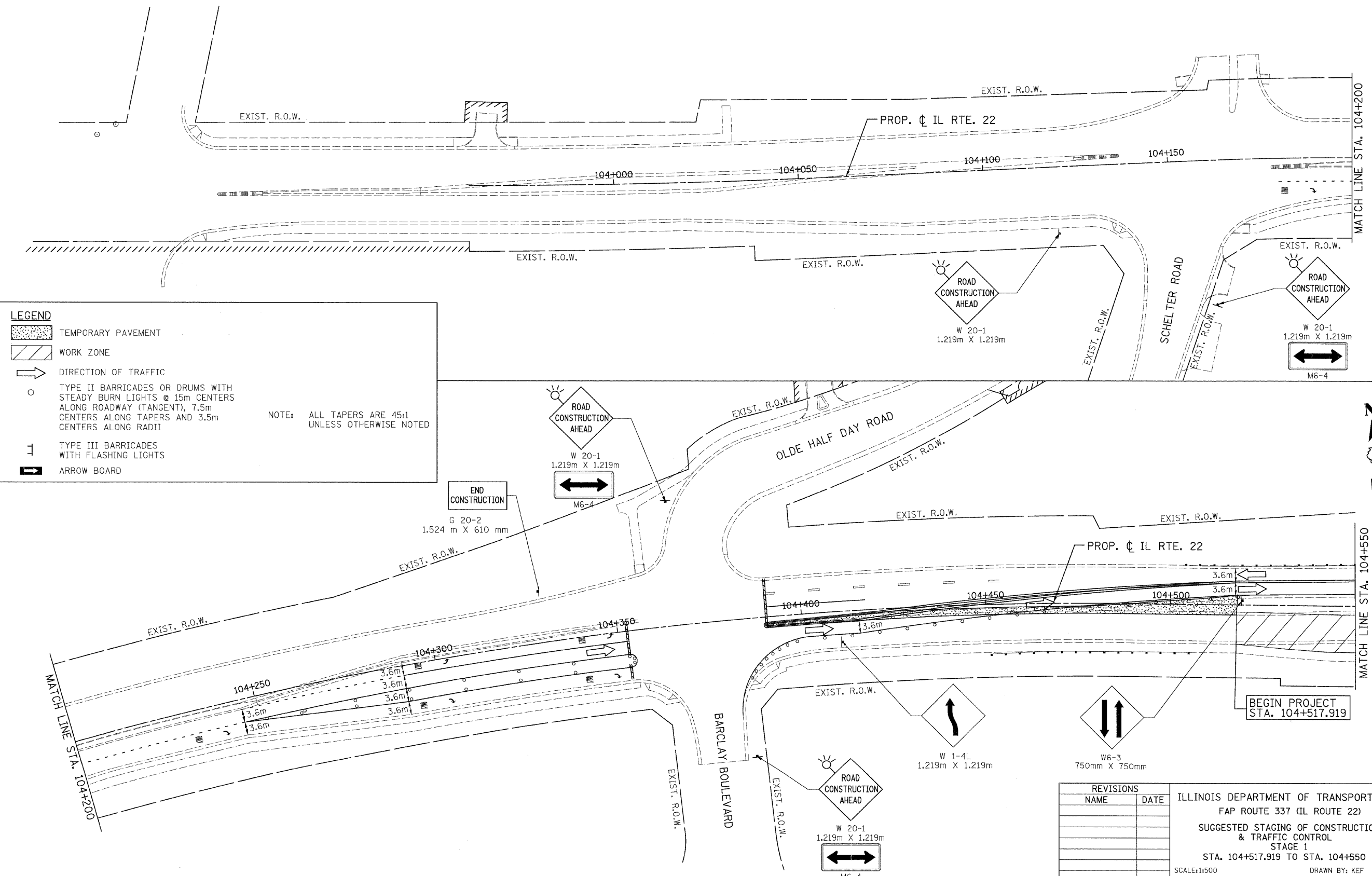

REVISIONS	
NAME	DATE

ILLINOIS DEPARTMENT OF TRANSPORTATION  
 FAP ROUTE 337 (IL ROUTE 22)  
 SUGGESTED STAGING OF CONSTRUCTION & TRAFFIC CONTROL  
 STAGE 1  
 STA. 104+517.919 TO STA. 104+550  
 SCALE: 1:500  
 DATE: 1/28/2009  
 DRAWN BY: KEF  
 CHECKED BY: CPK