

F.A.P. RTE.	SECTION	COUNTY	TOTAL SHEETS	SHEET NO.
337	20R-6	LAKE	149	29
STA.	TO STA.			
FED. ROAD DIST. NO.	ILLINOIS FED. AID PROJECT			
CONTRACT NO. 62519				

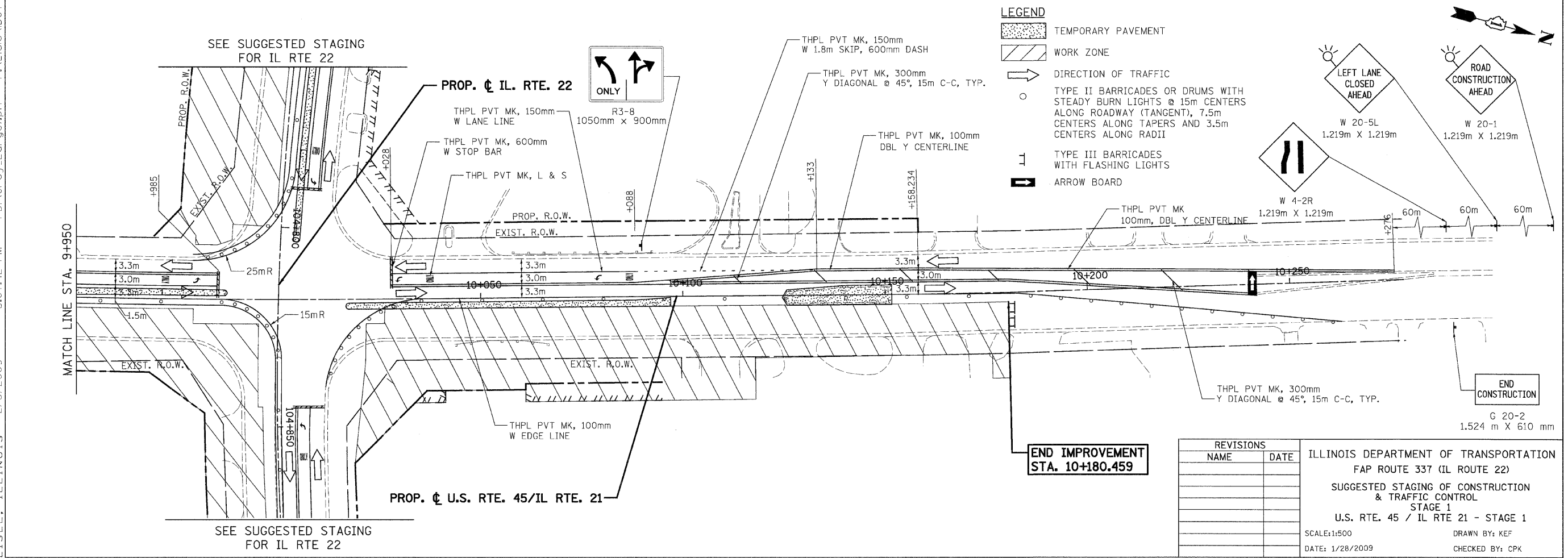
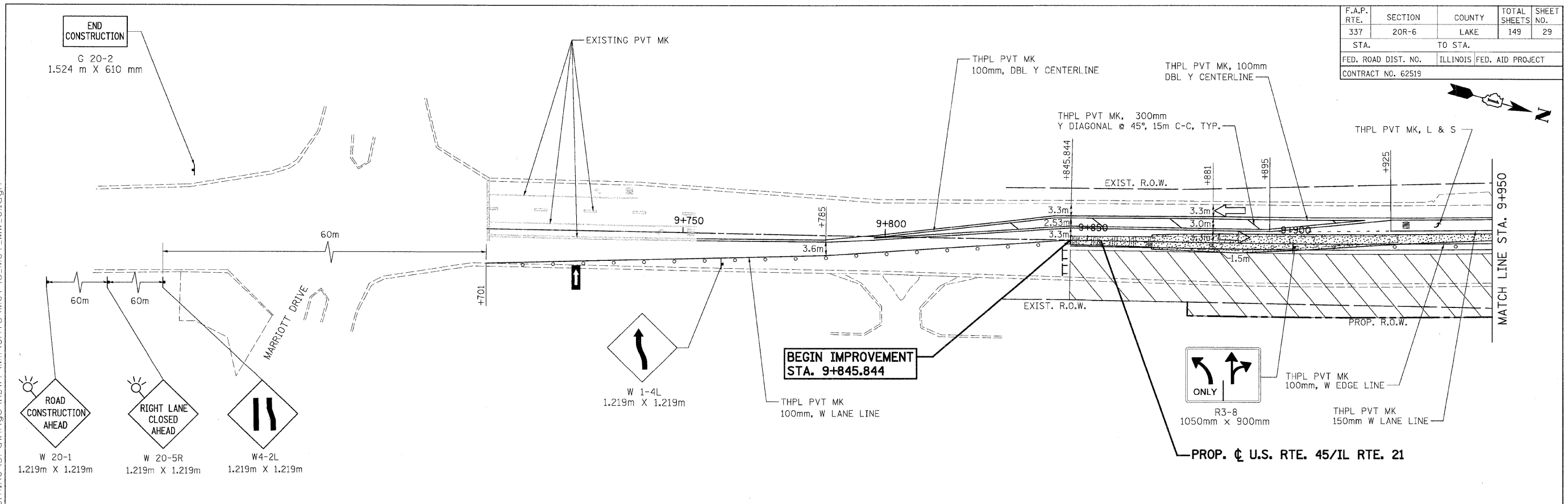

REVISIONS	
NAME	DATE

ILLINOIS DEPARTMENT OF TRANSPORTATION
FAP ROUTE 337 (IL ROUTE 22)
SUGGESTED STAGING OF CONSTRUCTION & TRAFFIC CONTROL
STAGE 1
U.S. RTE. 45 / IL RTE 21 - STAGE 1
SCALE: 1:500
DATE: 1/28/2009
DRAWN BY: KEF
CHECKED BY: CPK

hkoepen(Rdwy-Lisle) 5:07:42 PM PDF(Grey_Large).plt P:\Lisle\DOT\9717\AO\Drawings\RDWY\M1\Shfts\MOT\S-MOT_MW_01.dgn
 PATRICK ENGINEERING INC. LISLE, ILLINOIS