

F.A.P. RTE.	SECTION	COUNTY	TOTAL SHEETS	SHEET NO.
337	20R-6	LAKE	149	33
STA.		TO STA.		
FED. ROAD DIST. NO.		ILLINOIS FED. AID PROJECT		
CONTRACT NO. 62519				

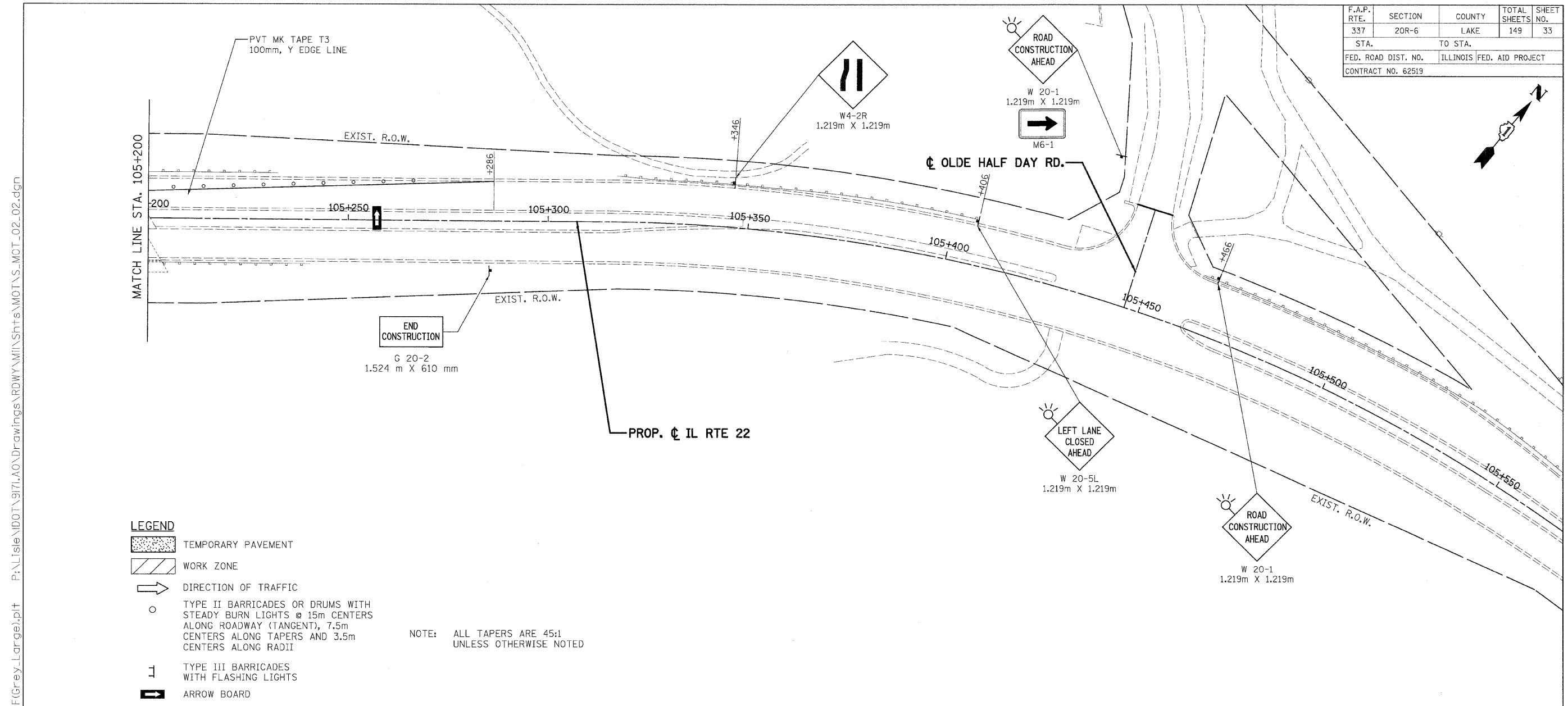

- LEGEND**
- TEMPORARY PAVEMENT
 - WORK ZONE
 - DIRECTION OF TRAFFIC
 - TYPE II BARRICADES OR DRUMS WITH STEADY BURN LIGHTS @ 15m CENTERS ALONG ROADWAY (TANGENT), 7.5m CENTERS ALONG TAPERS AND 3.5m CENTERS ALONG RADII
 - TYPE III BARRICADES WITH FLASHING LIGHTS
 - ARROW BOARD

NOTE: ALL TAPERS ARE 45:1 UNLESS OTHERWISE NOTED

tkoeppen(Rdwy_Lisle) 2/5/2009 5:08:19 PM PDF(Grey_Large).plt P:\Lisle\DOT\9171\A0\Drawings\RDWY\MII\Shts\MOT\S_MOT_02_02.dgn



REVISIONS	
NAME	DATE

ILLINOIS DEPARTMENT OF TRANSPORTATION
 FAP ROUTE 337 (IL ROUTE 22)
 SUGGESTED STAGING OF CONSTRUCTION
 & TRAFFIC CONTROL
 STAGE 2
 STA. 105+200 TO STA. 105+466
 SCALE: 1:500
 DATE: 1/28/2009
 DRAWN BY: KEF
 CHECKED BY: CPK