

F.A.P. RTE.	SECTION	COUNTY	TOTAL SHEETS	SHEET NO.
337	20R-6	LAKE	149	34
STA.	TO STA.			
FED. ROAD DIST. NO.	ILLINOIS FED. AID PROJECT			
CONTRACT NO. 62519				

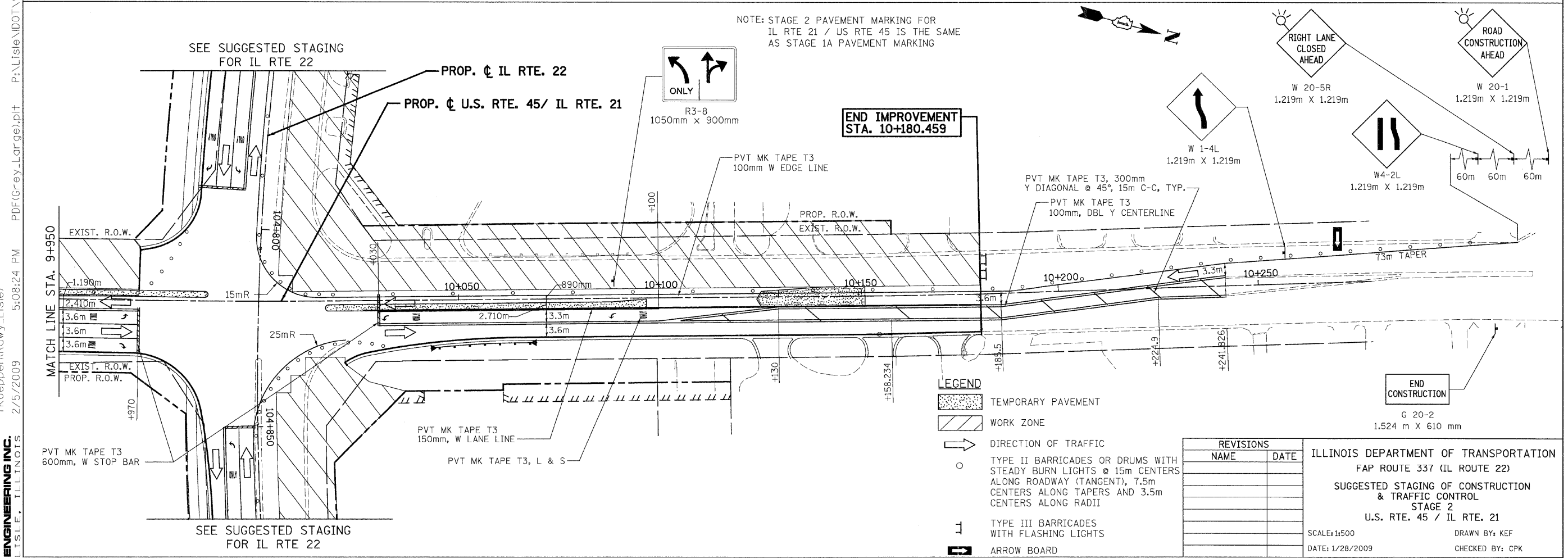
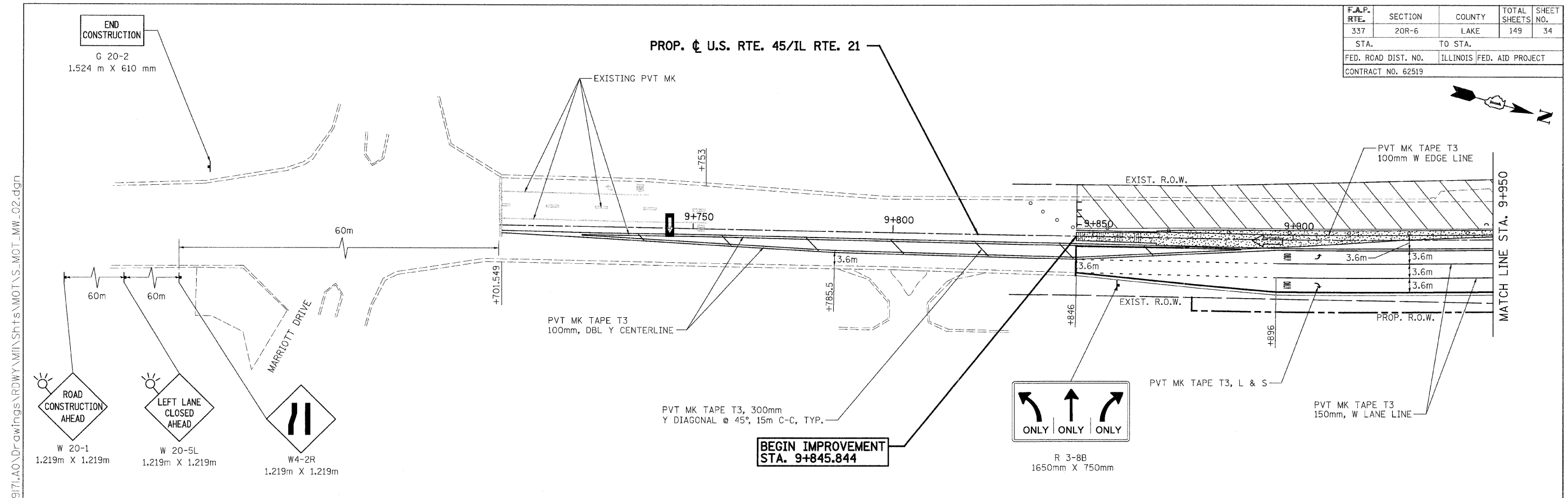

NOTE: STAGE 2 PAVEMENT MARKING FOR IL RTE 21 / US RTE 45 IS THE SAME AS STAGE 1A PAVEMENT MARKING

LEGEND

- TEMPORARY PAVEMENT
- WORK ZONE
- DIRECTION OF TRAFFIC
- TYPE II BARRICADES OR DRUMS WITH STEADY BURN LIGHTS @ 15m CENTERS ALONG ROADWAY (TANGENT), 7.5m CENTERS ALONG TAPERS AND 3.5m CENTERS ALONG RADII
- TYPE III BARRICADES WITH FLASHING LIGHTS
- ARROW BOARD

REVISIONS	
NAME	DATE

ILLINOIS DEPARTMENT OF TRANSPORTATION
 FAP ROUTE 337 (IL ROUTE 22)
 SUGGESTED STAGING OF CONSTRUCTION
 & TRAFFIC CONTROL
 STAGE 2
 U.S. RTE. 45 / IL RTE. 21

SCALE: 1:500
 DATE: 1/28/2009

DRAWN BY: KEF
 CHECKED BY: CPK

t: koeppen(Rdwy_Lisle) 5:08:24 PM PDF(Grey_Large).plt P:\Lisle\DOT\9171\AO\Drawings\RDHW\MI\Shts\MOT\S_MOT_MW_02.dgn
 PATRICK ENGINEERING INC. LISLE, ILLINOIS 2/5/2009