

F.A.P. RTE.	SECTION	COUNTY	TOTAL SHEETS	SHEET NO.
337	20R-6	LAKE	149	35
STA.	TO STA.			
FED. ROAD DIST. NO.	ILLINOIS FED. AID PROJECT			
CONTRACT NO. 62519				

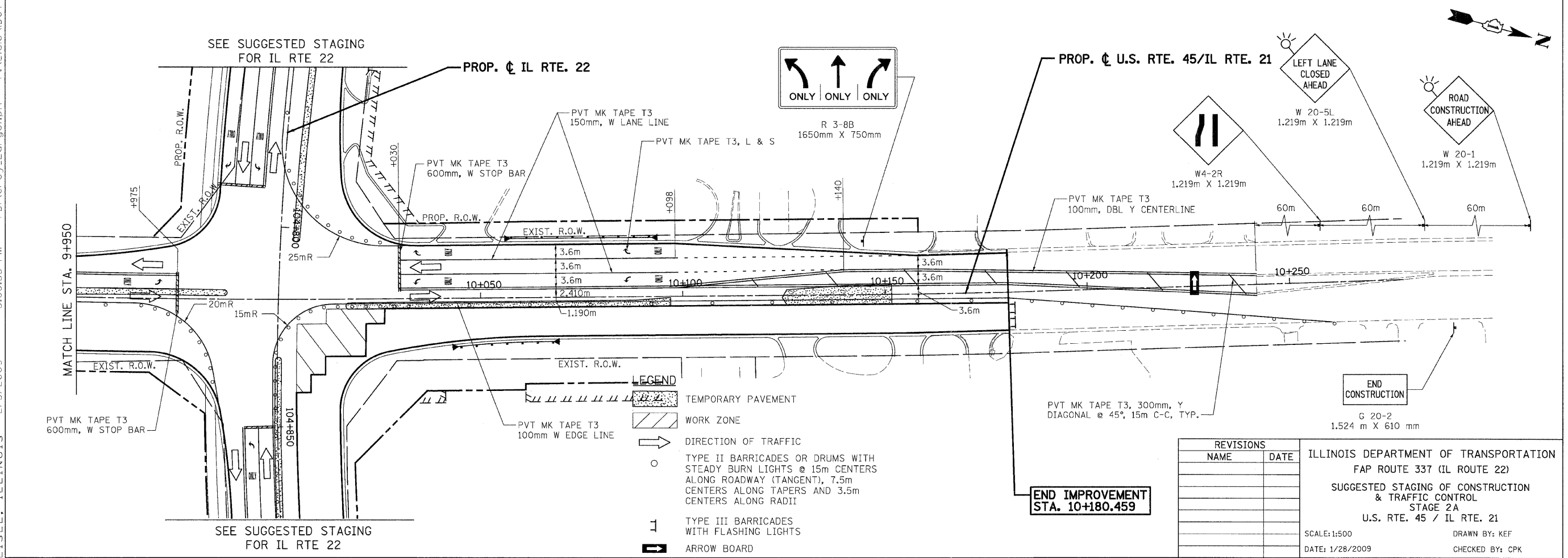
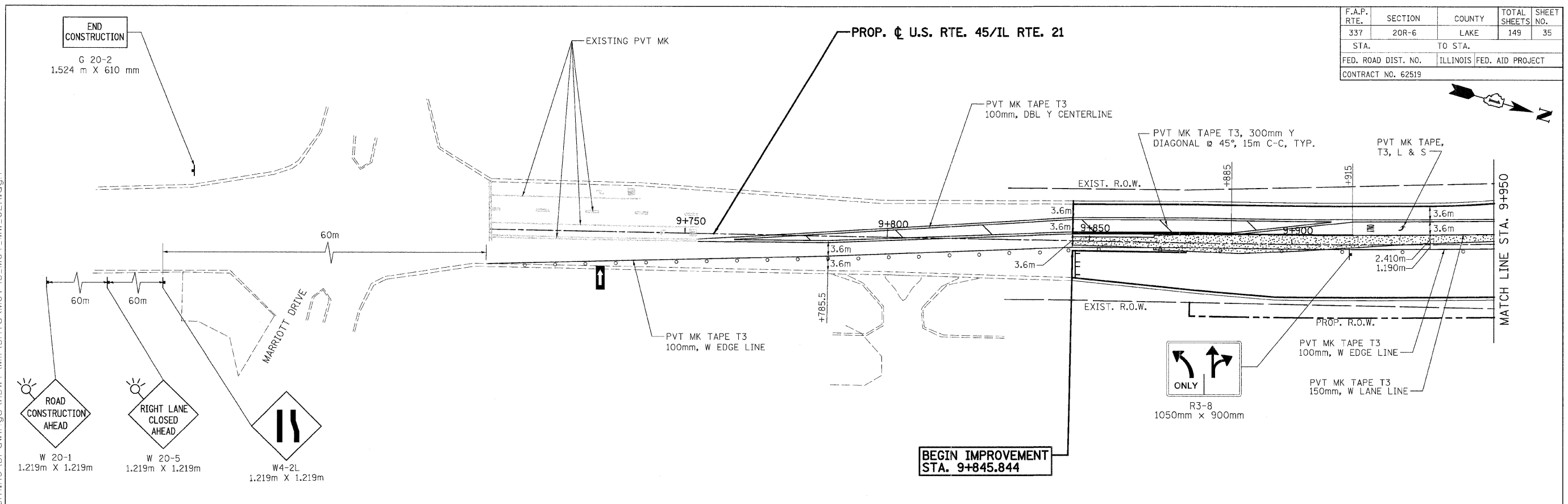

REVISIONS	
NAME	DATE

ILLINOIS DEPARTMENT OF TRANSPORTATION
FAP ROUTE 337 (IL ROUTE 22)
SUGGESTED STAGING OF CONSTRUCTION
& TRAFFIC CONTROL
STAGE 2A
U.S. RTE. 45 / IL RTE. 21

SCALE: 1:500
DATE: 1/28/2009

DRAWN BY: KEF
CHECKED BY: CPK

P:\Lislie\DOT\9171\AO\Drawings\RDWY\MOT\Smts\MOT\S_MOT_MW_02A.dgn
 PDF(Grey_Large).plt
 5:08:33 PM
 2/5/2009
 tkoepen(Rdwy_Lislie)
 PATRICK ENGINEERING INC.
 LISIE, ILLINOIS