

F.A.P. RTE.	SECTION	COUNTY	TOTAL SHEETS	SHEET NO.
337	20R-6	LAKE	149	57
STA.		TO STA.		
FED. ROAD DIST. NO.		ILLINOIS FED. AID PROJECT		
CONTRACT NO. 62519				

INLET FILTERS					
STATION	EACH	STATION	EACH	STATION	EACH
104+557.971 RT	1	104+801.637 RT	1	104+976.000 RT	1
104+597.032 RT	1	104+804.000 RT	1	104+967.000 LT	1
104+625.350 RT<	2	104+835.000 RT	1	105+006.000 RT	1
104+615.000 LT&RT	2	104+846.000 RT	2	104+999.282 LT	1
104+653.712 RT<	2	104+845.000 LT	1	105+038.000 RT	1
104+650.000 RT<	2	104+865.000 LT	1	105+039.989 LT	1
104+695.000 RT	1	104+880.000 RT	2	105+042.887 RT	1
104+740.000 LT	1	104+890.000 LT	1	105+043.067 LT	1
104+755.000 LT&RT	4	104+915.000 RT	2	105+100.000 RT<	2
104+785.000 LT&RT	2	104+935.000 RT	2	105+003.496 LT	1
104+788.328 RT	1	104+925.000 LT	1	TOTAL	45

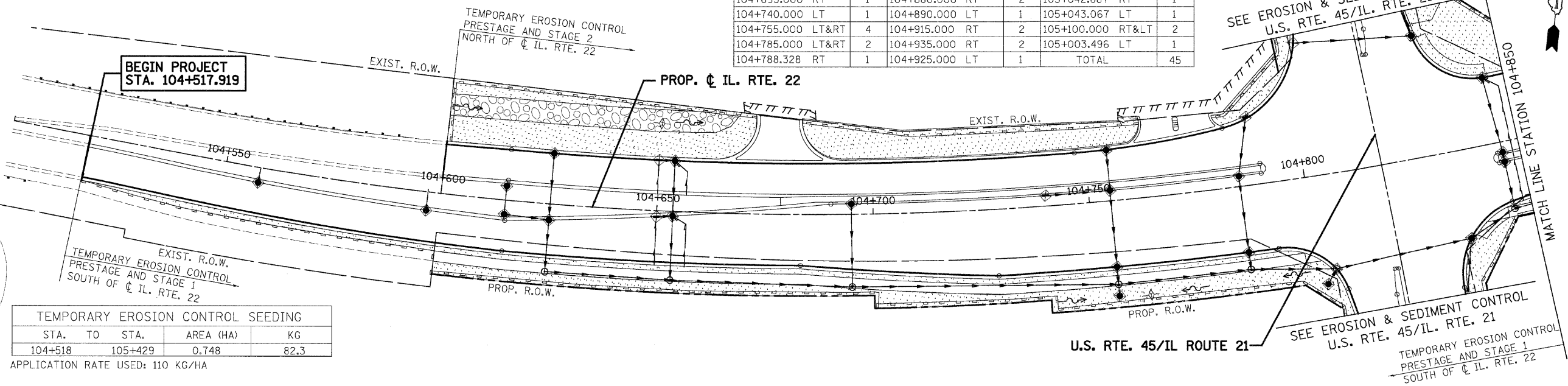

TEMPORARY EROSION CONTROL SEEDING			
STA.	TO STA.	AREA (HA)	KG
104+518	105+429	0.748	82.3

APPLICATION RATE USED: 110 KG/HA

TEMPORARY DITCH CHECKS	
STATION	EACH
104+760.000 RT	1
104+650.000 LT	1
TOTAL	2

LEGEND:

- TEMPORARY DITCH CHECKS
- SEDIMENT CONTROL SILT FENCE
- INLET FILTER
- ROADWAY DITCH FLOW ARROW
- TEMPORARY EROSION CONTROL SEEDING
- RIPRAP

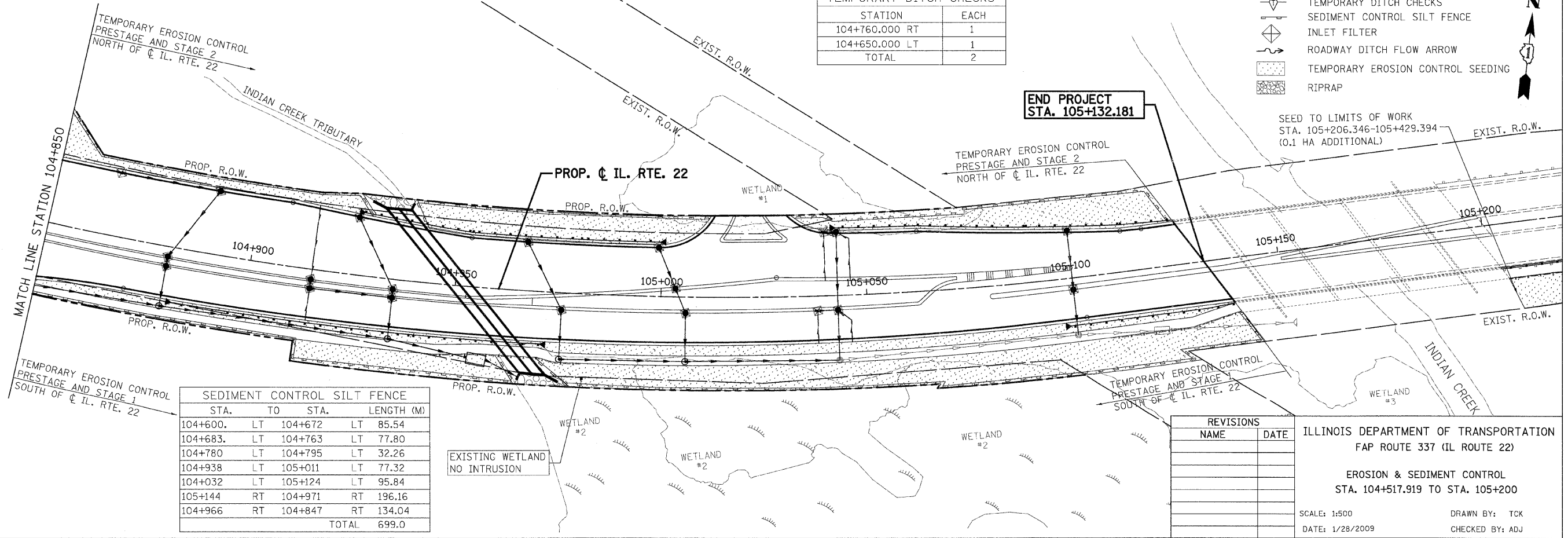

SEDIMENT CONTROL SILT FENCE			
STA.	TO STA.	LENGTH (M)	
104+600.	LT 104+672	LT 85.54	
104+683.	LT 104+763	LT 77.80	
104+780	LT 104+795	LT 32.26	
104+938	LT 105+011	LT 77.32	
104+032	LT 105+124	LT 95.84	
105+144	RT 104+971	RT 196.16	
104+966	RT 104+847	RT 134.04	
		TOTAL	699.0

REVISIONS	
NAME	DATE

ILLINOIS DEPARTMENT OF TRANSPORTATION
 FAP ROUTE 337 (IL ROUTE 22)
 EROSION & SEDIMENT CONTROL
 STA. 104+517.919 TO STA. 105+200

SCALE: 1:500
 DATE: 1/28/2009

DRAWN BY: TCK
 CHECKED BY: ADJ

tkoepper(Rdwy_Lislie) 5:12:21PM PDF(Grey_Large).plt P:\Lislie\DOT\9171\AO\Drawings\RDWY\MFI\Shts\Draw\S_Ero_01.dgn
 2/5/2009
PATRICK ENGINEERING INC.
 LISLIE, ILLINOIS