

F.A.I. RTE.	SECTION	COUNTY	TOTAL SHEETS	SHEET NO.
57	2021JB-R	COOK	101	024
STA.		TO STA.		
FED. ROAD DIST. NO. 1		ILLINOIS	FED. AID PROJECT	
CONTRACT NO. 62532				

NOTES:

- FOR CURB RAMP AND SIDEWALK DETAILS AND GENERAL NOTES SEE SHEETS 059 TO 061
- ALL SLOPES SHOWN ARE ROUNDED NUMBERS
- THE WIDTHS OF PAVEMENT MARKINGS FOR CROSSWALKS ARE SHOWN ON PAVEMENT MARKING PLANS
- FOR DETAILS OF CURB RAMP AND CURB GUTTER SEE SHEET 058
- KEYSTONE/TOP LANDINGS AREA, RAMPS AND SIDE FLARES WILL BE PAID FOR AS PCC SIDEWALK 8"

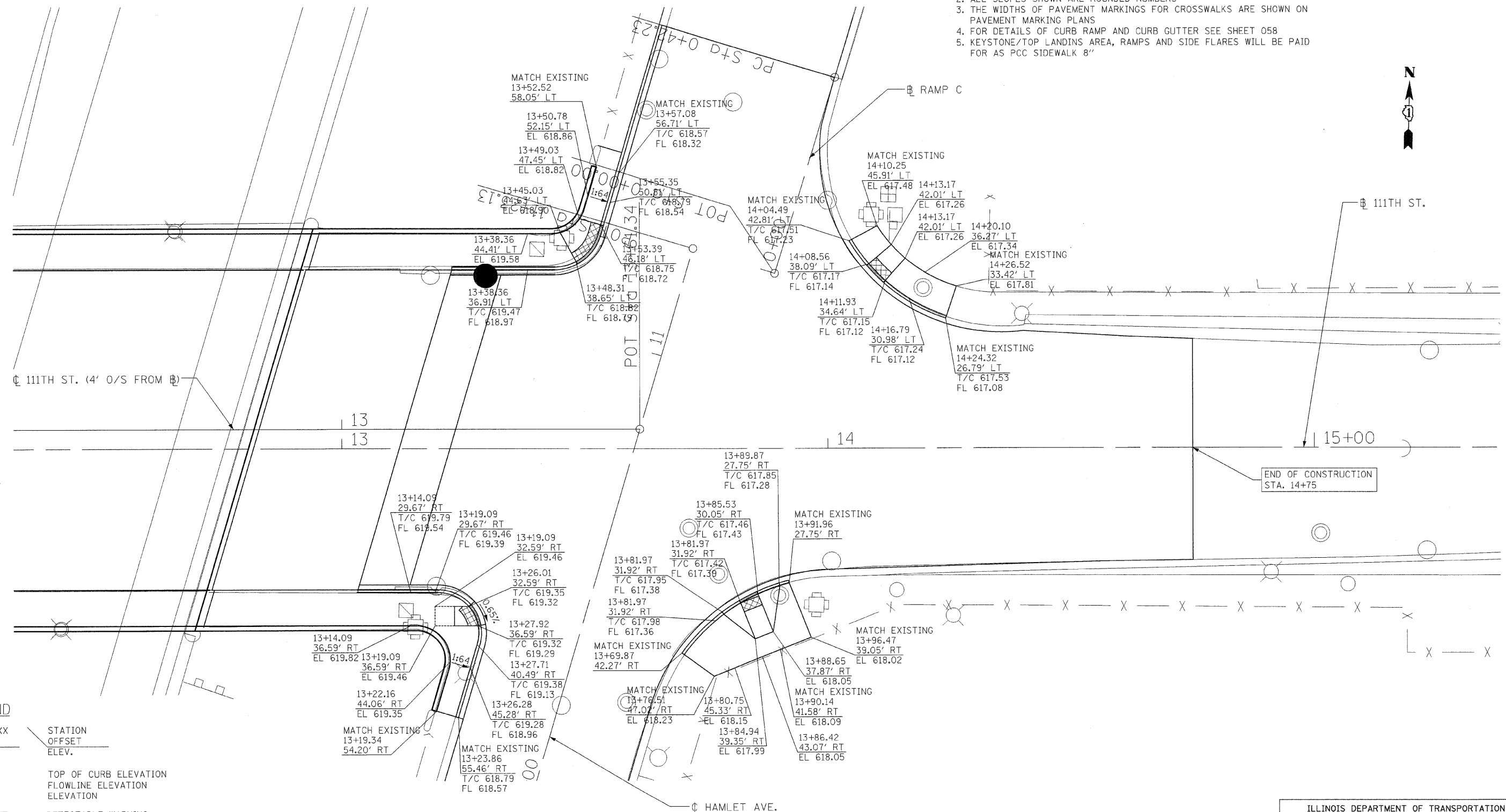

END OF CONSTRUCTION STA. 14+75

LEGEND

- XXX+XX.XX STATION
- XX.XX' OFFSET
- XXX.XX ELEV.
- T/C TOP OF CURB ELEVATION
- FL FLOWLINE ELEVATION
- EL ELEVATION
- [Cross-hatched box] DETECTABLE WARNING TILES
- [Solid shaded box] DEPRESSED CURB
- 0.5% SLOPE DIRECTION
- 1:64 SLOPE DIRECTION
- [Arrow with 0.5%] SLOPE IN PERCENT
- [Arrow with 1:64] SLOPE IN RISE:RUN

PROPOSED ADA RAMP GRADING PLAN FOR 111TH STREET AND HAMLET AVE.

NOTE: ALL STATIONING MEASURED OFF 111TH STREET UNLESS OTHERWISE NOTED.
 • CONTRACTOR SHALL VERIFY EXISTING ELEVATION PRIOR TO CONSTRUCTION

REVISIONS	
NAME	DATE

ILLINOIS DEPARTMENT OF TRANSPORTATION
 111TH STREET OVER
 F.A.I. ROUTE 57 (INTERSTATE 57)

**111TH AND HAMLET AVE.
 ADA SIDEWALK DETAILS**

SCALE: 1"=10'
 DATE: 01/16/09

DRAWN BY: BRH
 CHECKED BY: ACL

TENG
 TENG & ASSOCIATES, INC.
 ENGINEERS/ARCHITECTS/PLANNERS
 205 N. MICHIGAN AVE., CHICAGO, IL 60601
 TELEPHONE: 312/616-0000

\\ALT0084.DGN, \\DRA0006.DGN, \\TIB0004.DGN, \\DRA0007.DGN, \\TPO000.DGN, \\AC-SCRATCH-07.DGN, \\VOW001B.DGN
 1-16-2009, 11:42:17
 T:\DOCUMENTS\2009\01\111TH AND HAMLET AVE ADA SIDEWALK DETAILS.DGN
 1 2 3 4 5 6 7 8 9 10 11 12 13 14 15 16 17 18 19 20 21 22 23 24 25 26 27 28 29 30 31 32 33 34 35 36 37 38 39 40 41 42 43 44 45 46 47 48 49 50 51 52 53 54 55 56 57 58 59 60 61 62