

NOTES:

- STANDARD 701006 TO BE UTILIZED IN STAGE 2
- ALL MAINTENANCE OF TRAFFIC SIGNS USED IN STAGE 1 TO REMAIN FOR STAGE 2 ALONG IL ROUTE 25.
- ALL SIGNS SHALL BE POST OR SKID MOUNTED.
- REMOVE ALL CONFLICTING SIGNS AND PAVEMENT MARKINGS.
- RELOCATE TEMPORARY CONCRETE BARRIER AND TEMPORARY ATTENUATOR TO ALIGN WITH STAGE 2 TEMPORARY PAVEMENT MARKINGS.
- THE CONTRACTOR SHALL PROVIDE ACCESS TO ADJUTING PROPERTY AT ALL TIMES DURING THE CONSTRUCTION OF THIS PROJECT, EXCEPT FOR PERIODS OF SHORT DURATION (SEE GENERAL NOTES FOR DETAILS).
- ROAD CLOSED SIGNS TO BE INSTALLED ABOVE THE TYPE III BARRICADES.
- THE TYPE III BARRICADES AND SIGNS SHALL REMAIN IN PLACE FOR THE DURATION OF THE CONSTRUCTION OPERATIONS INCLUDING PROPOSED TRAFFIC SIGNAL INSTALLATION. THE REMOVAL OF THE BARRICADES SHALL BE COORDINATED WITH KANE COUNTY.
- THE CONTRACTOR SHALL COORDINATE CONSTRUCTION SIGNS INSTALLATION AND TEMPORARY LANES DELINEATION WITH ADJACENT IL RTE. 25 CONSTRUCTION OPERATIONS TO THE NORTH OF PROJECT LIMITS.

LEGEND

- DRUMS WITH BI-DIRECTIONAL STEADY BURN LIGHTS @ 50' CENTERS, 25' CENTERS ALONG TAPERS AND 12' CENTERS ALONG RADIUS RETURNS
- TRAFFIC DIRECTION
- ▬ DOUBLE VERTICAL PANELS (BACK TO BACK) WITH BI-DIRECTIONAL STEADY BURNING LIGHTS
- ⊥ TYPE III BARRICADES WITH FLASHING LIGHTS
- ▨ WORK ZONE
- ▩ TEMPORARY PAVEMENT
- ARROW BOARD
- ▬ TEMP. CONCRETE BARRIER

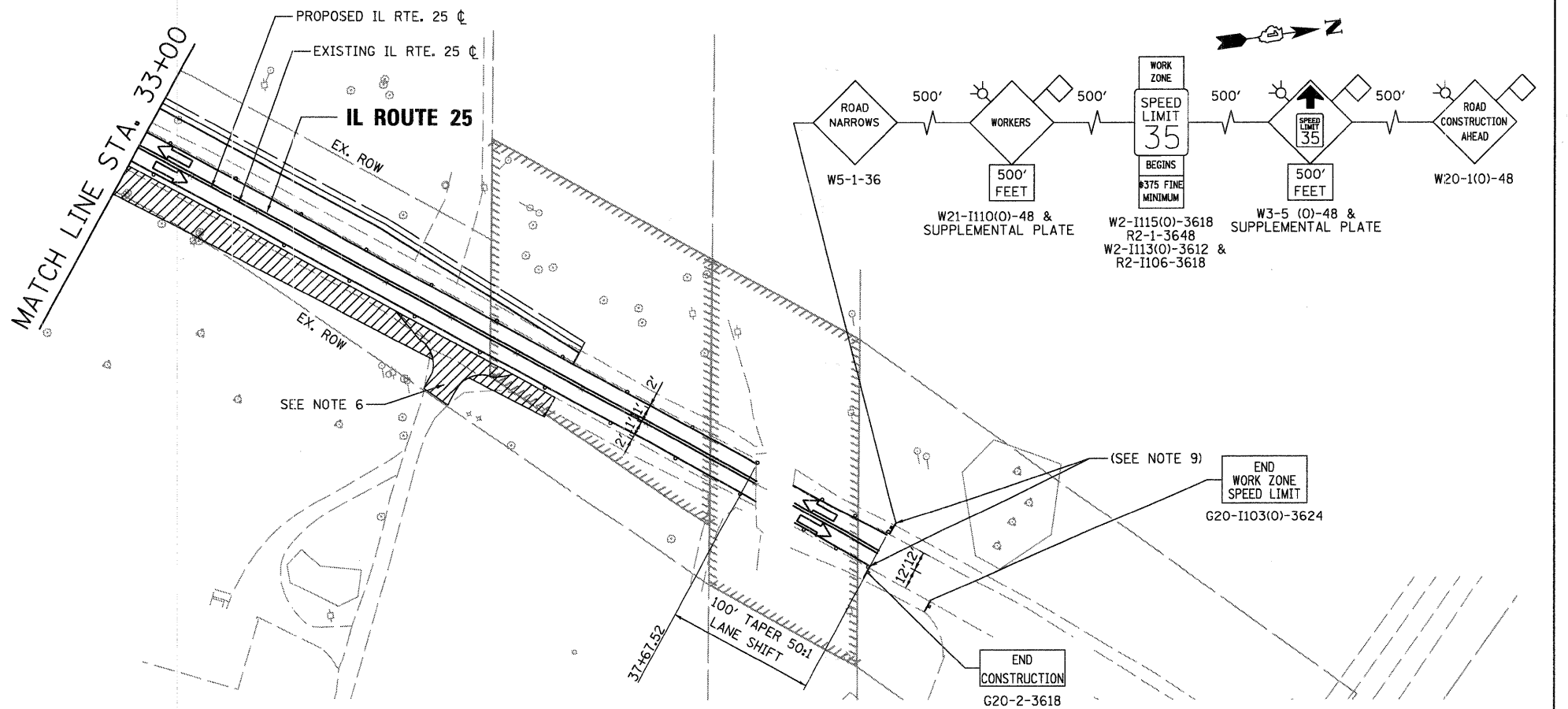

FILE NAME = IL25.mot&22.mot	USER NAME = GYSherman	DESIGNED - GS	REVISED -	STATE OF ILLINOIS DEPARTMENT OF TRANSPORTATION	IL ROUTE 25 MAINTENANCE OF TRAFFIC STAGE 2 PLAN	F.A.P. RTE.	SECTION	COUNTY	TOTAL SHEETS	SHEET NO.	
	PLOT SCALE = 50.0000' / IN.	CHECKED - SE	REVISED -			361	06-00214-20-BR	KANE	320	46	
PLOT DATE = 1/13/2009	DATE - 01/16/09	REVISED -	REVISED -	SCALE: 1"=50'	SHEET NO. 4 OF 5 SHEETS	STA. TO STA.	CONTRACT NO.				
						FED. ROAD DIST. NO.	ILLINOIS FED. AID PROJECT				

Baker
Engineering, Inc.