

COUNTY HWY.	FISCAL YEAR	TOTAL SHEETS	SHEET NO.
VARIOUS	2008	30	10
SEC. 07-00230-07-TL DUPAGE CO.			

63107

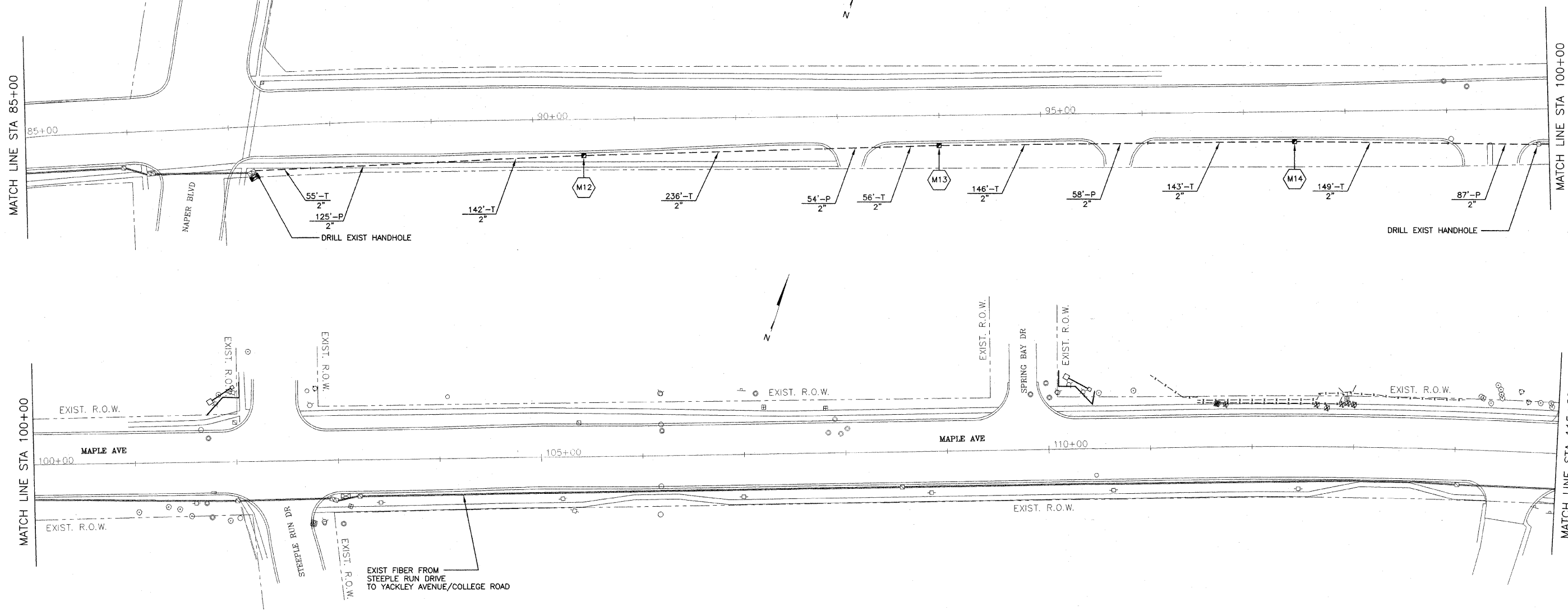
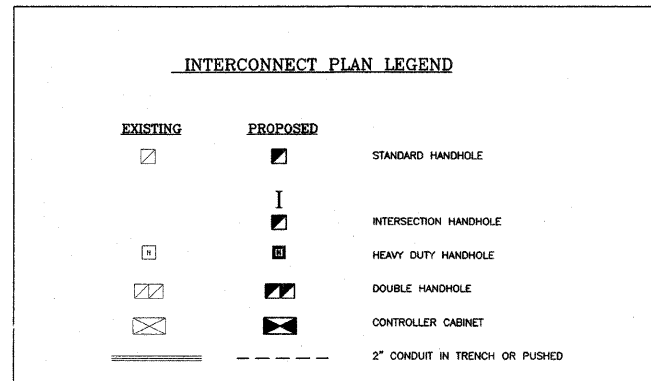

RESTORATION OF WORK AREA

RESTORATION OF THE TRAFFIC SIGNAL WORK AREA SHALL BE INCIDENTAL TO THE RELATED PAY ITEM SUCH AS FOUNDATION, CONDUIT, HANDHOLE, TRENCH AND BACKFILL, ETC., AND NO EXTRA COMPENSATION SHALL BE ALLOWED. ALL ROADWAY SURFACES SUCH AS SHOULDERS, MEDIANS, SIDEWALKS, PAVEMENT, ETC. SHALL BE REPLACED IN KIND. ALL DAMAGE TO MOWED LAWNS SHALL BE REPLACED WITH AN APPROVED SOD, AND ALL DAMAGE TO UNKNOWN FIELDS SHALL BE SEEDED IN ACCORDANCE WITH STANDARD SPECIFICATIONS 252 AND 250 RESPECTIVELY.

REVISIONS	
NAME	DATE

DUPAGE COUNTY DIVISION OF TRANSPORTATION
CHICAGO AVENUE / MAPLE AVENUE
TRAFFIC SIGNAL INTERCONNECT PLAN

SCALE: 1"=50'
DATE: 10/24/08

DRAWN BY: TH
DESIGNED BY: TH
CHECKED BY: DAZ