

63107

SCHEDULE OF QUANTITIES

PAY CODE NUMBER	PAY ITEM	UNIT	TOTAL QUANTITIES
81000600	CONDUIT IN TRENCH, 2" DIA., GALVANIZED STEEL	FOOT	475
81000700	CONDUIT IN TRENCH, 2 1/2" DIA., GALVANIZED STEEL	FOOT	120
81001000	CONDUIT IN TRENCH, 4" DIA., GALVANIZED STEEL	FOOT	10
81018500	CONDUIT PUSHED, 2" DIA., GALVANIZED STEEL	FOOT	175
81018900	CONDUIT PUSHED, 4" DIA., GALVANIZED STEEL	FOOT	230
81400100	HANDHOLE	EACH	3
81400200	HEAVY DUTY HANDHOLE	EACH	1
81400300	DOUBLE HANDHOLE	EACH	1
81900200	TRENCH AND BACKFILL FOR ELECTRICAL WORK	FOOT	605
85000200	MAINTENANCE OF EXISTING TRAFFIC SIGNAL INSTALLATION	EACH	1
85700200	FULL-ACTUATED CONTROLLER AND TYPE IV CABINET	EACH	1
86400100	TRANSCIVER-FIBER OPTIC	EACH	1
87301215	ELECTRIC CABLE IN CONDUIT, SIGNAL, NO. 14 2C	FOOT	1350
87301225	ELECTRIC CABLE IN CONDUIT, SIGNAL, NO. 14 3C	FOOT	645
87301245	ELECTRIC CABLE IN CONDUIT, SIGNAL, NO. 14 5C	FOOT	1090
87301255	ELECTRIC CABLE IN CONDUIT, SIGNAL, NO. 14 7C	FOOT	280
87301305	ELECTRIC CABLE IN CONDUIT, LEAD-IN, NO. 14 1 PR	FOOT	370
87301805	ELECTRIC CABLE IN CONDUIT, SERVICE, NO. 6 2C	FOOT	190
X8730027	ELECTRIC CABLE IN CONDUIT, GROUNDING, NO. 6 1C	FOOT	920
X8730250	ELECTRIC CABLE IN CONDUIT, NO. 20 3/C, TWISTED, SHIELDED	FOOT	410
X0324477	ELECTRIC CABLE IN CONDUIT NO. 10 1/C	FOOT	930
87502500	TRAFFIC SIGNAL POST, GALVANIZED STEEL 16 FT.	EACH	2
87502520	TRAFFIC SIGNAL POST, GALVANIZED STEEL 18 FT.	EACH	1
87702920	STEEL COMBINATION MAST ARM ASSEMBLY AND POLE 38 FT.	EACH	1
87702950	STEEL COMBINATION MAST ARM ASSEMBLY AND POLE 44 FT.	EACH	1
87800100	CONCRETE FOUNDATION, TYPE A	FOOT	12
87800200	CONCRETE FOUNDATION, TYPE D	FOOT	8
87800415	CONCRETE FOUNDATION, TYPE E 36-INCH DIAMETER	FOOT	30
88200210	TRAFFIC SIGNAL BACKPLATE, LOUVERED, ALUMINUM	EACH	4
88500100	INDUCTIVE LOOP DETECTOR	EACH	11
88600100	DETECTOR LOOP, TYPE 1	FOOT	445
88700200	LIGHT DETECTOR	EACH	2
88700300	LIGHT DETECTOR AMPLIFIER	EACH	1
88800100	PEDESTRIAN PUSH-BUTTON	EACH	2
89502375	REMOVE EXISTING TRAFFIC SIGNAL EQUIPMENT	EACH	1
88030020	SIGNAL HEAD, LED, 1-FACE, 3-SECTION, MAST ARM MOUNTED	EACH	3
88030110	SIGNAL HEAD, LED, 1-FACE, 5-SECTION, MAST ARM MOUNTED	EACH	1
88030050	SIGNAL HEAD, LED, 1-FACE, 3-SECTION, BRACKET MOUNTED	EACH	4
88030100	SIGNAL HEAD, LED, 1-FACE, 5-SECTION, BRACKET MOUNTED	EACH	1
88100200	PEDESTRIAN SIGNAL HEAD, LED, 1-FACE, BRACKET MOUNTED	EACH	2
82102310	LUMINAIRE, SODIUM VAPOR, HORIZONTAL MOUNT, 310 WATT	EACH	2
X8050010	SERVICE INSTALLATION-GROUND MOUNTED	EACH	1
X0324007	OPTIMIZE TRAFFIC SIGNAL SYSTEM	EACH	1

CABLE PLAN

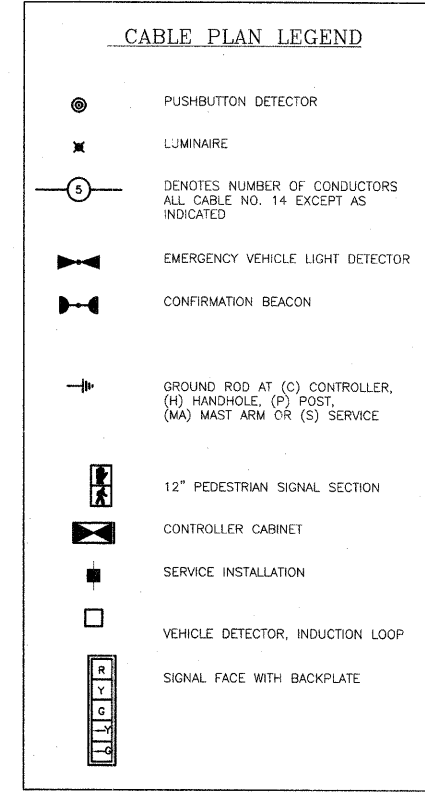
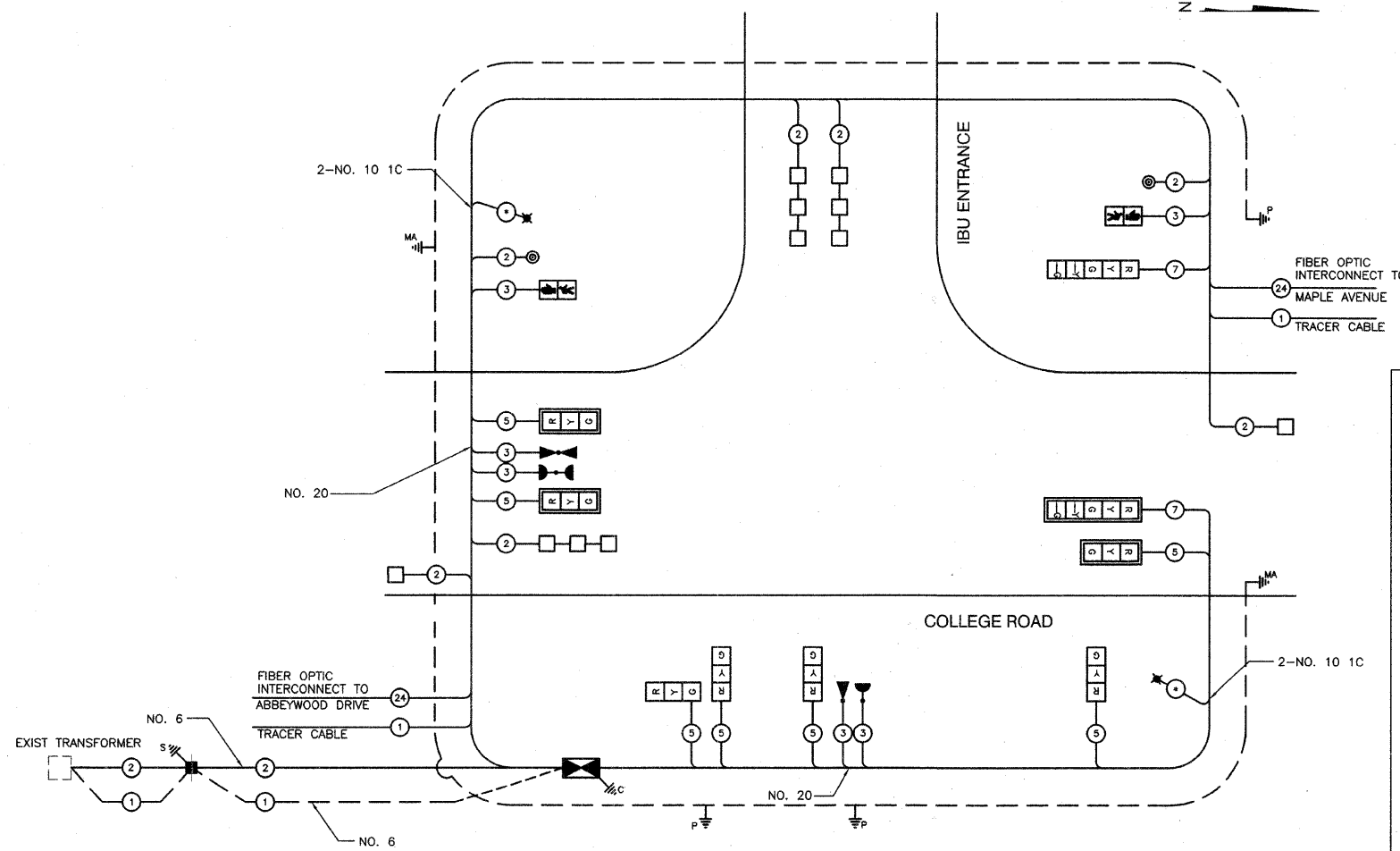

NOTE:

PUSHBUTTON "A" SHALL PLACE A CALL IN PHASES 2 AND 4
 PUSHBUTTON "C" SHALL PLACE A CALL IN PHASES 6 AND 8

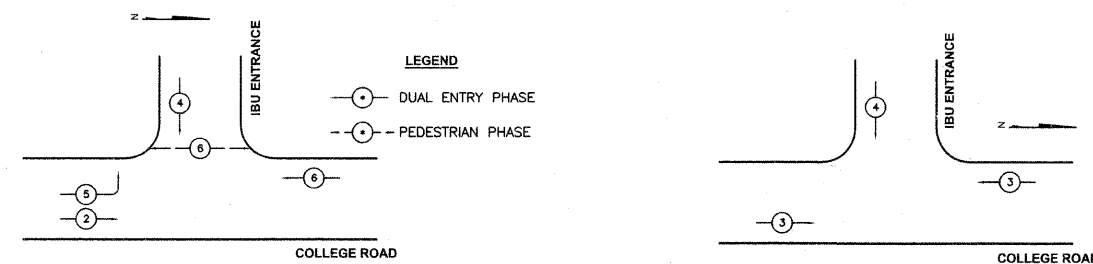

PROPOSED EMERGENCY VEHICLE PREEMPTORS

EMERGENCY VEHICLE PREEMPTOR	3	4
MOVEMENT	←	→

EMERGENCY VEHICLE PREEMPTION SEQUENCE

DU PAGE COUNTY D.O.T TRAFFIC SIGNAL INSTALLATION ELECTRICAL SERVICE REQUIREMENTS

TYPE	NO. LAMPS	WATTAGE		OPERATION (%)	TOTAL WATTAGE
		INCAND.	LED		
RED BALL	9	135	10	0.60	54
YELLOW BALL	9	135	22	0.03	6
GREEN BALL	9	135	12	0.37	40
RED ARROW	0	135	5	0.85	0
YELLOW ARROW	2	135	10	0.02	0.4
GREEN ARROW	2	135	5	0.13	1.3
PED - WALK	2	90	5	0.05	0.5
PED - DON'T WALK	2	90	6	0.95	11.4
CONTROLLER	1	100		1.00	100
LUMINAIRE	2	310		0.50	310
TOTAL=					524

FOUNDATION(DEPTH)	FT. (m)	CABLE SLACK	FT. (m)	VERTICAL	FT. (m)
TYPE A - POST	4 (1.2)	HANDHOLE	6.5 (2.0)	ALL FOUNDATIONS	3.5 (1.0)
D - CONTROLLER	4 (1.2)	DOUBLE HANDHOLE	13 (4.0)	MAST ARM (L) POLE	20'+L-2'
E - M. ARM POLE		SIGNAL POST	2 (1.0)		(6m+L-0.6m)=
	24" (600 mm)	CONTROLLER CAB.	1 (0.5)	BRACKET MOUNTED	13 (4.0)
	30" (750 mm)	FIBER OPTIC	13 (4.0)	PED. BUTTON	4 (1.2)
		ELECTRIC SERVICE	1 (0.5)	ELECTRIC SERVICE	13.5 (4.1)
		GROUND CABLE	1 (0.5)	SERVICE TO GROUND	13.5 (4.1)
				POST MOUNTED	6 (1.8)

REVISIONS

NAME	DATE

DUPAGE COUNTY DIVISION OF TRANSPORTATION
CABLE PLAN, PHASE DESIGNATION DIAGRAM AND SCHEDULE OF QUANTITIES COLLEGE ROAD & IBU ENTRANCE
 SCALE: 1"=20'
 DATE: 10/24/08
 DRAWN BY: TH
 DESIGNED BY: TH
 CHECKED BY: DAZ