

STATE OF ILLINOIS
DEPARTMENT OF TRANSPORTATION
PLANS FOR

PROPOSED FEDERAL-AID HIGHWAY

**T.R. 73 (ALLENDALE ROAD)
OVER VANDER KARR CREEK
SECTION 05-00310-00-BR
PROJECT NO: BROS-0111(44)
BRIDGE REPLACEMENT
MCHENRY COUNTY
C-91-125-05**

F.A. RTE.	SECTION	COUNTY	TOTAL SHEETS	SHEET NO.
73	05-00310-00-BR	MCHENRY	44	1
FED. ROAD DIST. NO. - ILLINOIS FED. AID PROJECT			CONTRACT NO. 63114	

FOR INDEX OF SHEETS SEE SHEET 2

DESIGN DESIGNATION

ALLENDALE ROAD
FUNCTIONAL CLASSIFICATION: LOCAL ROAD
DESIGN SPEED = 60 MPH
POSTED SPEED = 55 MPH

TRAFFIC DATA

ALLENDALE ROAD
EXISTING ADT = 580 (2005)
DESIGN ADT = 740 (2030)

PROJECT LOCATED IN THE
GREENWOOD TOWNSHIP

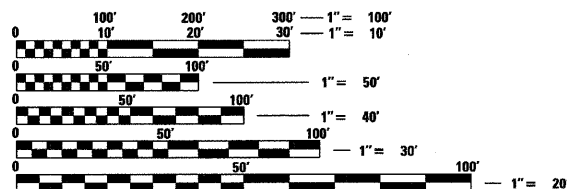

FULL SIZE PLANS HAVE BEEN PREPARED USING STANDARD ENGINEERING SCALES, REDUCED SIZED PLANS WILL NOT CONFORM TO STANDARD SCALES, IN MAKING MEASUREMENTS ON REDUCED PLANS, THE ABOVE SCALES MAY BE USED.



CONTRACT NO : 63114

J.U.L.I.E.
JOINT UTILITY LOCATION INFORMATION FOR EXCAVATION
1-800-892-0123

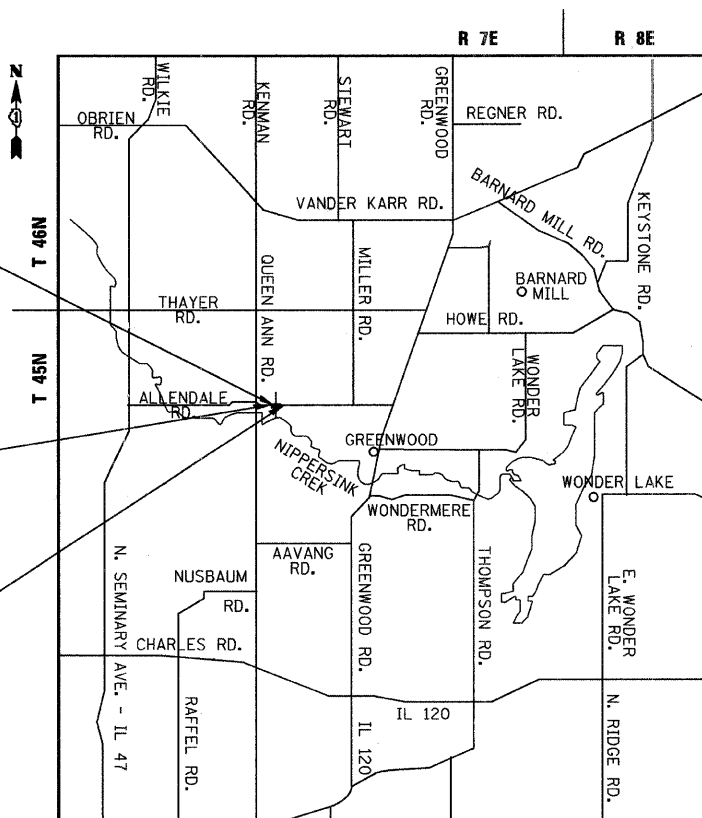

SN: 056-3173
STA. 107+00.88
1-SPAN PPC
I-BEAM STRUCTURE
ON 2 INTEGRAL
ABUTMENTS

BEGIN PROJECT
STA. 102+50

END PROJECT
STA. 111+50

THE PROJECT CONSISTS OF
THE REPLACEMENT OF
SN: 056-3064 WITH
SN: 056-3173 OVER
VANDER KARR CREEK;
WIDENING AND RECONSTRUCTION
OF ALLENDALE ROAD FROM
STA. 102+50 TO STA. 111+50



LOCATION MAP
SCALE: 1" = 500'
GROSS AND NET LENGTH OF PROJECT = 900 FT = 0.17 MI



LOCATION OF SECTION INDICATED THIS: - [black rectangle]

AGENCY RESPONSIBLE FOR LETTING

APPROVED DECEMBER 19, 2008
Joseph R. Kopyeski Jr.
COUNTY OF MCHENRY, COUNTY ENGINEER

PASSED FEBRUARY 11, 2008
Chris H. Christensen
DISTRICT 1 ENGINEER OF LOCAL ROAD & STREETS

RELEASING FOR BID
BASED ON LIMITED
REVIEW FEBRUARY 11, 2008
Diana M. O'Keefe
DEPUTY DIRECTOR OF HIGHWAYS, REGION 1 ENGINEER

PRINTED BY THE AUTHORITY
OF THE STATE OF ILLINOIS

Ciorba Group, Inc.

DESIGN FIRM
REGISTRATION NUMBER

184-001016

CONSULTING ENGINEERS
SUITE 402, 5507 NORTH CUMBERLAND AVE
CHICAGO, ILLINOIS 60656 :: (773) 775-4009

PLANS PREPARED BY: CIORBA GROUP

ASSOCIATE FIELD ENGINEER: KEVIN STALLWORTH (847) 705-4169

FILE NAME = N:\PROJ\33395\Design\ProposedPlan\33395-01-tr1.eodgn