

McHENRY COUNTY  
DIVISION OF TRANSPORTATION

**GENERAL NOTES**

1. Reinforcement bars shall conform to the requirements of ASTM A 706 Gr 60. See Special Provisions.
2. Reinforcement bars designated (E) shall be epoxy coated.
3. The existing structural steel coating contains lead. The Contractor shall take appropriate precautions to deal with the presence of lead on this project.
4. The Contractor shall drive test piles to 110% of the nominal required bearing specified in production locations at substructures specified or approved by the Engineer before ordering the remainder of piles.
5. Plan dimensions and details relative to existing plans are subject to nominal construction variations. The Contractor shall field verify existing dimensions and details affecting new construction and make necessary approved adjustments prior to construction or ordering of materials. Such variations shall not be cause for additional compensation for a change in scope of the work, however, the Contractor will be paid for the quantity actually furnished at the unit price bid for the work.
6. The embankment configuration shown shall be the minimum that must be placed and compacted prior to construction of the abutments.
7. The Contractor shall utilize the Protective Shield, Special during demolition to prevent the deposition of any material into Vander Karr Creek. In addition, the Contractor shall take extreme caution during all other phases of construction to prevent the deposition of any material into Vander Karr Creek. Demolition and construction activities within the floodplain shall be limited to the grading limits shown on the grading plans.

**INDEX OF SHEETS**

- S-1 General Plan and Elevation
- S-2 General Notes and Bill of Materials
- S-3 Top of Slab Elevations No. 1
- S-4 Top of Slab Elevations No. 2
- S-5 Top of West Approach Slab Elevations
- S-6 Top of East Approach Slab Elevations
- S-7 Superstructure Plan and Cross Section
- S-8 Integral Abutment Diaphragm Details
- S-9 Concrete Bridge Railing Details
- S-10 Superstructure Details
- S-11 Framing Plan
- S-12 54" PPC I-Beam Details I
- S-13 54" PPC I-Beam Details II
- S-14 West Abutment
- S-15 East Abutment
- S-16 Abutment Concrete Removal Plan
- S-17 Metal Shell Pile Details
- S-18 Bar Splicer Assembly Details
- S-19 Soil Borings 1
- S-20 Soil Borings 2

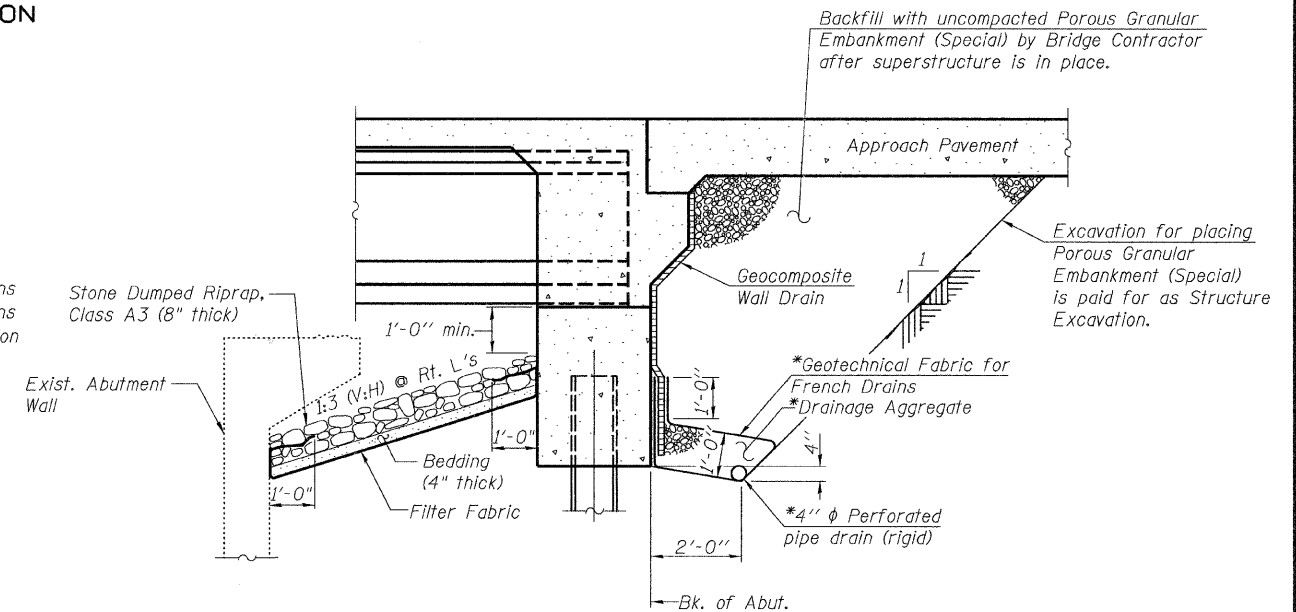

**SECTION THRU INTEGRAL ABUTMENT**  
(Horiz. dim. @ Rt. L's)

\*Included in the cost of Pipe Underdrains for Structures.

Note:  
All drainage system components shall extend to 2'-0" from the end of each wingwall except an outlet pipe shall extend until intersecting with the side slopes. The pipes shall drain into concrete headwalls. (See Article 601.05 of the Standard Specifications and Highway Standard 601101).

**TOTAL BILL OF MATERIAL**

PAY ITEM	DESCRIPTION	UNIT	ESTIMATED QUANTITY
20700400	Porous Granular Embankment, Special	Cu. Yd.	210
28100705	Stone Dumped Riprap, Class A3	Sq. Yd.	95
28200200	Filter Fabric	Sq. Yd.	95
50101500	Removal of Existing Superstructures	Each	1
50102400	Concrete Removal	Cu. Yd.	14.0
50157307	Protective Shield, Special	L. Sum	1
50200100	Structure Excavation	Cu. Yd.	36.4
50300225	Concrete Structures	Cu. Yd.	43.4
50300254	Rubbed Finish	Sq. Ft.	1,023
50300255	Concrete Superstructure	Cu. Yd.	147.4
50300260	Bridge Deck Grooving	Sq. Yd.	394
50300300	Protective Coat	Sq. Yd.	498
50401105	Furnishing and Erecting Precast Prestressed Concrete I-Beams, 54"	Foot	548.5
50800205	Reinforcement Bars, Epoxy Coated	Pound	36,600
50800515	Bar Splicers	Each	80
51200959	Furnishing Metal Shell Piles 14" x 0.312"	Foot	810
51202305	Driving Piles	Foot	810
51203200	Test Pile Metal Shells	Each	2
51204650	Pile Shoes	Each	20
51500100	Name Plates	Each	1
59100100	Geocomposite Wall Drain	Sq. Yd.	127
60109580	Pipe Underdrains for Structures 4"	Foot	170
X0325862	Concrete Bridge Railing	Foot	186

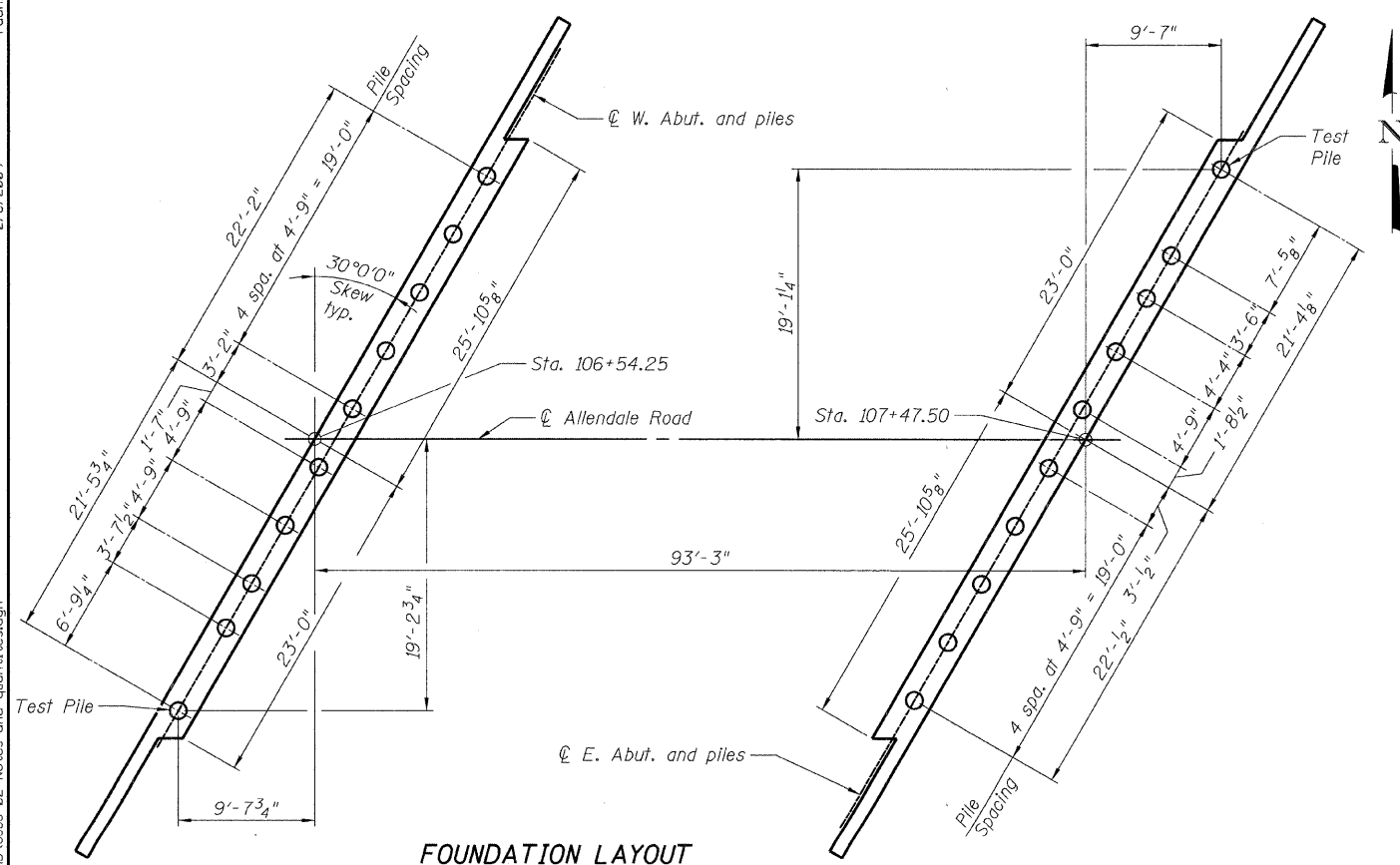

**FOUNDATION LAYOUT**

DESIGNED	AMK
CHECKED	EKM
DRAWN	RD
CHECKED	EKM

**Ciorba Group, Inc.**  
CONSULTING ENGINEERS  
5507 North Cumberland Avenue, Suite 402 Chicago, Illinois 60656  
Tel. 773.775.4009 Fax 773.775.4014 Email chicago@ciorba.com

**GENERAL NOTES & BILL OF MATERIAL**  
**STRUCTURE NO. 056-3173**

SHEET NO. S-2 OF S-20 SHEETS	F.A. RTE.	SECTION	COUNTY	TOTAL SHEETS	SHEET NO.
		05-00310-00-BR	McHENRY	44	18
			CONTRACT NO. 63114		
FED. ROAD DIST. NO.		ILLINOIS	FED. AID PROJECT		

848 1/2 IN.  
 rdenley  
 2/6/2009  
 N:\PROJ\3335\Design\Structural\CA0\3335 02 Notes and quantities.dgn