

McHENRY COUNTY
DIVISION OF TRANSPORTATION

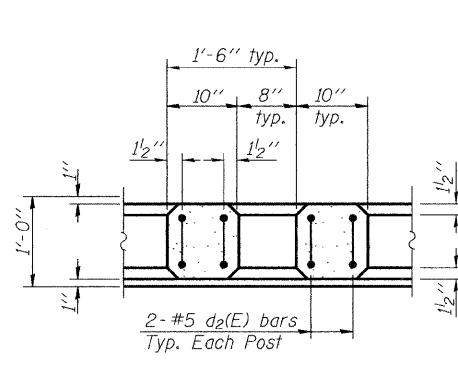

SECTION E-E

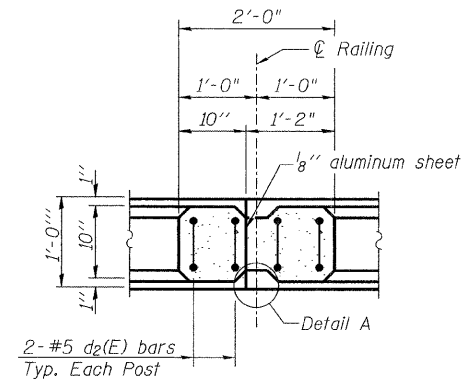

SECTION F-F

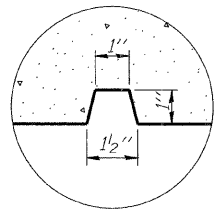

DETAIL A

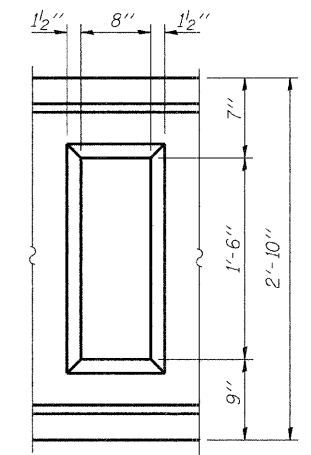

WINDOW DETAIL

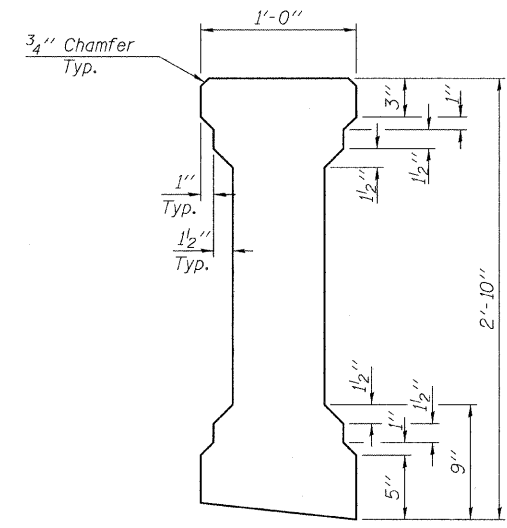

SPAN PILASTER JOINT
ALUMINUM JOINT DETAIL

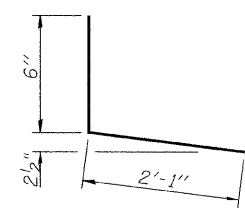

BAR d(E)

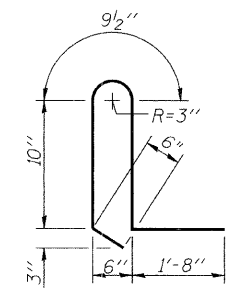

BAR d1(E)

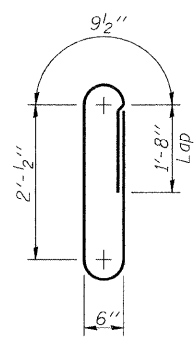

BAR d2(E)

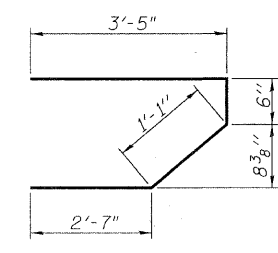

BAR s(E)

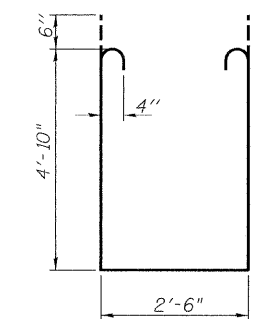

BAR s1(E)

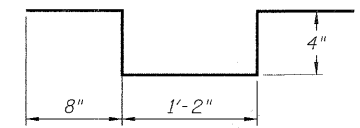

BAR a4(E)

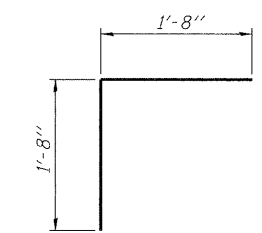

BAR v(E)

SUPERSTRUCTURE
BILL OF MATERIAL

Bar	No.	Size	Length	Shape
a(E)	171	# 5	42' - 0"	—
a1(E)	124	# 5	40' - 4"	—
a2(E)	342	# 6	6' - 0"	—
a3(E)	8	# 5	25' - 4"	—
a4(E)	14	# 4	3' - 2"	┌
b(E)	132	# 5	32' - 5"	—
b1(E)	144	# 5	24' - 10"	—
b2(E)	4	# 4	4' - 6"	—
d(E)	250	# 5	2' - 7"	└
d1(E)	374	# 5	4' - 8"	└
m(E)	8	# 6	25' - 0"	—
m1(E)	12	# 6	26' - 1"	—
m2(E)	24	# 6	11' - 1"	—
m3(E)	10	# 6	5' - 10"	—
m4(E)	4	# 6	2' - 4"	—
s(E)	92	# 5	7' - 7"	┌
s1(E)	82	# 4	13' - 2"	└
v(E)	84	# 5	3' - 4"	└
Reinforcement Bars, Epoxy Coated			Pound	29,740
Concrete Superstructure			Cu. Yds.	147.4
Concrete Bridge Railing			Foot	186
Bridge Deck Grooving			Sq. Yd.	394
Protective Coat			Sq. Yd.	498
Rubbed Finish			Sq. Ft.	1,023

Bars indicated thus 1 x 15-#5 etc. indicates 1 line of bars with 15 lengths per line.

SUPERSTRUCTURE DETAILS
STRUCTURE NO. 056-3173

SHEET NO. S-10 OF S-20 SHEETS	F.A. RTE.	SECTION	COUNTY	TOTAL SHEETS	SHEET NO.
		05-00310-00-BR	McHENRY	44	26
			CONTRACT NO. 63114		
FED. ROAD DIST. NO.		ILLINOIS FED. AID PROJECT			

DESIGNED	AMK
CHECKED	EKM
DRAWN	RD
CHECKED	EKM

Ciorba Group, Inc.
CONSULTING ENGINEERS
5507 North Cumberland Avenue, Suite 402 Chicago, Illinois 60656
Tel. 773.775.4009 Fax 773.775.4014 Email chicago@ciorba.com

1.00000000 1/ IN.
 rdanley
 2/6/2009
 N:\PROJ\3335\Design\Structural\CAD\3335 10 Superstructure Details.dgn