

F. A. U. NO.	SECTION	COUNTY	TOTAL SHEETS	SHEET NO.
1583	08-00056-00-RS	COOK	10	1
STA.	TO STA.			
FED. ROAD DIST. NO.	ILLINOIS	FED. AID PROJECT	M-9003(124)	

CONTRACT #63116

STATE OF ILLINOIS
DEPARTMENT OF TRANSPORTATION
DIVISION OF HIGHWAYS

**PLANS FOR PROPOSED
FEDERAL AID HIGHWAY**

FAU 1583 / 115TH STREET
HARLEM AVENUE TO RIDGELAND AVENUE
LOCAL AGENCY PAVEMENT PRESERVATION

STREET RESURFACING
PROJECT: M-9003(124)
SECTION NO.: 08-00056-00-RS
JOB NO.: C-91-140-09
VILLAGE OF WORTH
COOK COUNTY

INDEX OF SHEETS

- COVER SHEET, INDEX OF SHEETS, LOCATION MAP
- INDEX OF STATE STANDARDS
- SUMMARY OF QUANTITIES & GENERAL NOTES
- TYPICAL CROSS SECTION
- PAVEMENT PLAN
- STRIPING PLAN
- DISTRICT ONE STANDARD DETAILS

HIGHWAY STANDARDS

- | | |
|-----------|---|
| 000001-05 | STANDARD STANDARDS, ABBREVIATIONS AND PATTERNS |
| 280001-04 | TEMPORARY EROSION CONTROL SYSTEMS |
| 424001-05 | CURB RAMPS FOR SIDEWALK |
| 442201-03 | CLASS C AND D PATCHES |
| 604001-03 | FRAME AND LIDS, TYPE 1 |
| 606001-04 | CONCRETE CURB TYPE B AND COMBINATION CONCRETE CURB & GUTTER |
| 701501-05 | URBAN LANE CLOSURE 2-L, 2-W, UNDIVIDED |
| 701606-06 | URBAN LANE CLOSURE, MULTILANE, 2W WITH MOUNTABLE MEDIAN |
| 701701-06 | URBAN LANE CLOSURE, MULTILANE INTERSECTION |
| 701801-04 | LANE CLOSURE, MULTILANE, 1W OR 2W, CROSSWALK OR SIDEWALK CLOSURE, |
| 701901-01 | TRAFFIC CONTROL DEVICES |
| 780001-02 | TYPICAL PAVEMENT MARKINGS |

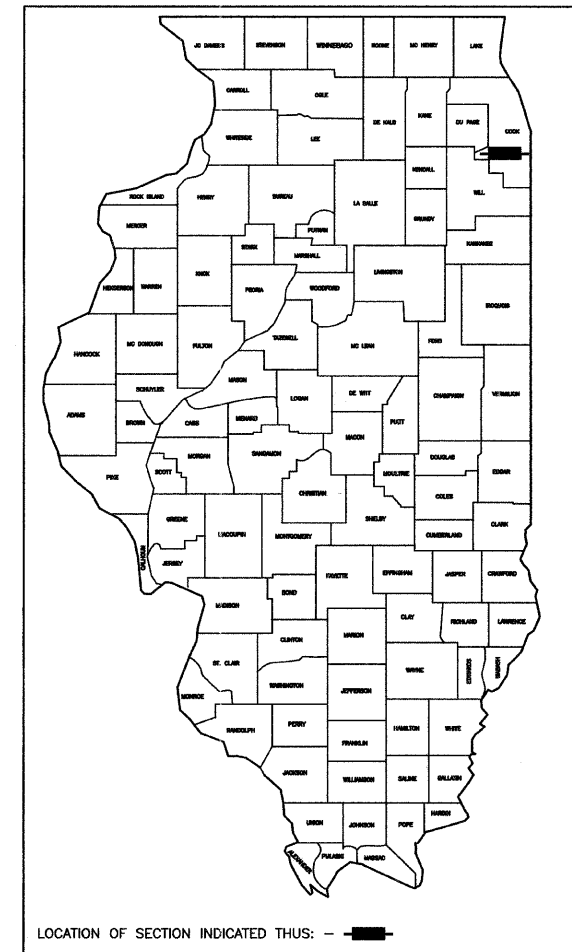

LOCATION OF SECTION INDICATED THUS: - ■ -



SCALES
 PLAN - 1"=50'
 PROFILE HORIZ. - 1"=50'
 PROFILE VERT. - 1"=5'
 CROSS SECTIONS - 1"=10'

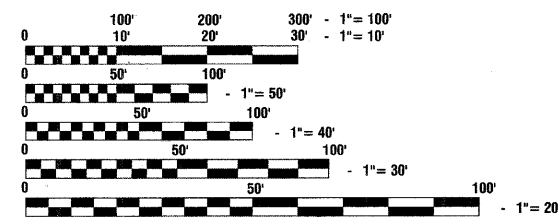

FULL SIZE PLANS HAVE BEEN PREPARED USING STANDARD ENGINEERING SCALES, REDUCED SIZED PLANS WILL NOT CONFORM TO STANDARD SCALES, IN MAKING MEASUREMENTS ON REDUCED PLANS, THE ABOVE SCALES MAY BE USED.

J. U. L. I. E.
JOINT UTILITY LOCATION INFORMATION FOR EXCAVATION
1-800-892-0123 or 811

CONTRACT NO. 63116

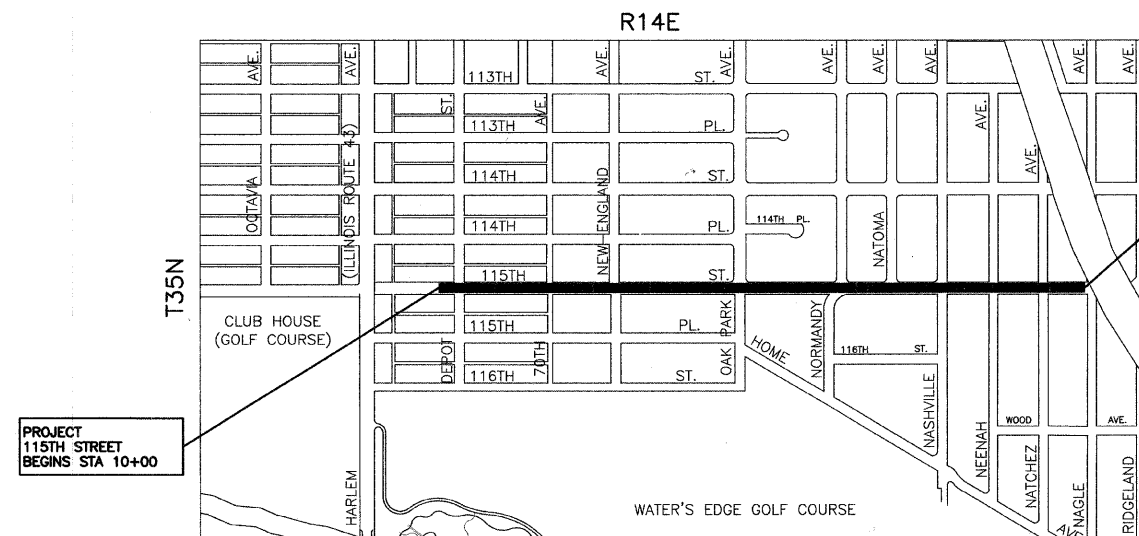

PROJECT
115TH STREET
BEGINS STA 10+00

PROJECT
115TH STREET
ENDS STA 52+76

LOCATION MAP

— INDICATES PROPOSED IMPROVEMENT
 GROSS LENGTH= 4,276 FEET = 0.81 MILES
 NET LENGTH= 4,276 FEET = 0.81 MILES

115TH STREET COLLECTOR
 ADT=5,500 (2008)
 =5,500 (2030)
 DESIGN SPEED=35 MPH
 SPEED LIMIT= 35 MPH

FIELD ENGINEER: MELCHOR MANGOBA 847-705-4408
 CONSULTANTS: ROBINSON ENGINEERING, LTD. 708-331-6700
 CONTACT ENGINEER: MICHAEL SPOLAR

STATE OF ILLINOIS DEPARTMENT OF TRANSPORTATION
DIVISION OF HIGHWAYS

Approved: 12-19-2008
Edward J. Heysler
Mayor, Village of Worth

Passed: FEBRUARY 9, 2009
CHRISTOPHER HOLT
District 1 Engineer of Local Roads & Streets

Released for Bid Based on Limited Review: FEBRUARY 9, 2009
Diane M. O'Keefe
Deputy Director of Highways, Region 1 Engineer

PRINTED BY THE AUTHORITY OF
THE STATE OF ILLINOIS

PREPARED BY OR UNDER THE
DIRECT SUPERVISION OF:

Michael Spolar
12/19/2008

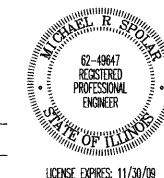

SUMMARY OF QUANTITIES					PAVEMENT	MARKINGS	SIGNS	LANDSCAPE	LIGHTS	SIGNALS	TRAINING
S.I.	CODE NO.	PAY ITEM	UNIT	QUAN	CONSTRUCTION TYPE CODE						
					I000	SFTY-1D	Y002-1C	Y003	Y030-1E	Y031	Y080
	40600100	BITUMINOUS MATERIALS (PRIME COAT)	GALLON	1889	1889						
	40600300	AGGREGATE (PRIME COAT)	TON	38	38						
	40600895	CONSTRUCTING TEST STRIP	EACH	2	2						
	40600982	HOT-MIX ASPHALT SURFACE REMOVAL - BUTT JOINT	SQ YD	820	820						
	40603335	HOT-MIX ASPHALT SURFACE COURSE, MIX "D", N50	TON	1635	1635						
	42300300	PORTLAND CEMENT CONCRETE DRIVEWAY PAVEMENT, 7 INCH	SQ YD	100	100						
	42400200	PORTLAND CEMENT CONCRETE SIDEWALK 5 INCH	SQ FT	591	591						
	42400800	DETECTABLE WARNINGS	SQ FT	450	450						
	44000157	HOT-MIX ASPHALT SURFACE REMOVAL, 2"	SQ YD	18074	18074						
	44000200	DRIVEWAY PAVEMENT REMOVAL	SQ YD	200	200						
	44000600	SIDEWALK REMOVAL	SQ FT	591	591						
	44001700	COMBINATION CONCRETE CURB AND GUTTER REMOVAL AND REPLACEMENT	FOOT	522	522						
	44201753	CLASS D PATCHES, TYPE II, 9 INCH	SQ YD	86	86						
	44201757	CLASS D PATCHES, TYPE III, 9 INCH	SQ YD	292	292						
	44201759	CLASS D PATCHES, TYPE IV, 9 INCH	SQ YD	393	393						
	60250200	CATCH BASINS TO BE ADJUSTED	EACH	5	5						
	60252800	CATCH BASINS TO BE RECONSTRUCTED	EACH	2	2						
	60255500	MANHOLES TO BE ADJUSTED	EACH	10	10						
	60257900	MANHOLES TO BE RECONSTRUCTED	EACH	2	2						
	60266600	VALVE BOXES TO BE ADJUSTED	EACH	2	2						
	60406100	FRAMES AND LIDS, TYPE 1, CLOSED LID	EACH	2	2						
	67100100	MOBILIZATION	L SUM	1	1						
	70102620	TRAFFIC CONTROL AND PROTECTION, STANDARD 701501	L SUM	1	1						
	70102625	TRAFFIC CONTROL AND PROTECTION, STANDARD 701606	L SUM	1	1						
	70102635	TRAFFIC CONTROL AND PROTECTION, STANDARD 701701	L SUM	1	1						
	70102640	TRAFFIC CONTROL AND PROTECTION, STANDARD 701801	L SUM	1	1						
	70300100	SHORT-TERM PAVEMENT MARKING	FOOT	1000		1000					
*	78000200	THERMOPLASTIC PAVEMENT MARKING - LINE 4"	FOOT	8688		8688					
*	78000400	THERMOPLASTIC PAVEMENT MARKING - LINE 6"	FOOT	636		636					
*	78000600	THERMOPLASTIC PAVEMENT MARKING - LINE 12"	FOOT	704		704					
*	78000650	THERMOPLASTIC PAVEMENT MARKING - LINE 24"	FOOT	783		783					
	X4067107	POLYMERIZED LEVELING BINDER (MACHINE METHOD), IL-4.75, N50	TON	794		794					
	XX006806	HOT-MIX ASPHALT DRIVEWAY PAVEMENT	SQ YD	200	200						

GENERAL NOTES:

- BEFORE STARTING ANY EXCAVATION, THE CONTRACTOR SHALL CALL "J.U.L.I.E." AT (800) 892-0123 AT (312) 744-7000 FOR FIELD LOCATIONS OF BURIED ELECTRIC, TELEPHONE AND GAS UTILITIES. (48 HOUR NOTIFICATION IS REQUIRED).
- UTILITIES INDICATED ON THE PLANS ARE PROVIDED FOR THE CONTRACTORS USE AND ARE BASED UPON INFORMATION AVAILABLE AT THE TIME OF THE ADVERTISEMENT FOR BIDS. THE OWNER AND ENGINEER DO NOT GUARANTEE THE ACCURACY OF UTILITIES INFORMATION.
- IT SHALL BE THE CONTRACTOR'S RESPONSIBILITY TO VERIFY ALL DIMENSIONS AND CONDITIONS EXISTING IN THE FIELD PRIOR TO CONSTRUCTION AND ORDERING OF MATERIALS.
- SCHEDULES INCLUDED IN THE PLANS HAVE BEEN PREPARED FROM FIELD NOTES. EXACT LOCATIONS FOR PATCHING SHALL BE DETERMINED IN THE FIELD BY THE ENGINEER.
- ANY REFERENCE TO STANDARDS THROUGHOUT THE PLANS OR SPECIAL PROVISIONS SHALL BE INTERPRETED TO BE THE LATEST STANDARDS OF THE ILLINOIS DEPARTMENT OF TRANSPORTATION.
- THE NOMINAL THICKNESS OF HOT-MIX ASPHALT MIXTURE STATED IN THE SPECIFICATIONS IS THE NOMINAL THICKNESS. DEVIATIONS FROM THE NOMINAL THICKNESS WILL BE PERMITTED WHEN SUCH DEVIATIONS OCCUR DUE TO IRREGULARITIES IN THE EXISTING SURFACE OR BASE ON WHICH THE HOT-MIX ASPHALT SURFACE IS PLACED.

* - INDICATES SPECIALTY ITEMS

FILE NAME = 08478-QUAN-01 - 001	USER NAME =	DESIGNED -- RES	REVISED --	STATE OF ILLINOIS DEPARTMENT OF TRANSPORTATION	115TH STREET RESURFACING SUMMARY OF QUANTITIES & GENERAL NOTES WORTH, ILLINOIS			F.A. RTE.	SECTION	COUNTY	TOTAL SHEETS	SHEET NO.
		CHECKED -- PKB	REVISED --		SCALE: NONE	SHEET NO. 2	OF 10 SHEETS	STA. --	TO STA. --	COOK	10	2
	PLOT SCALE = NONE	DRAWN -- SLG	REVISED --		CONTRACT NO. 63117							
	PLOT DATE = 12/18/08	CHECKED -- MJD	REVISED --		FED. ROAD DIST. NO. 1 ILLINOIS FED. AID PROJECT M-9003(124)							

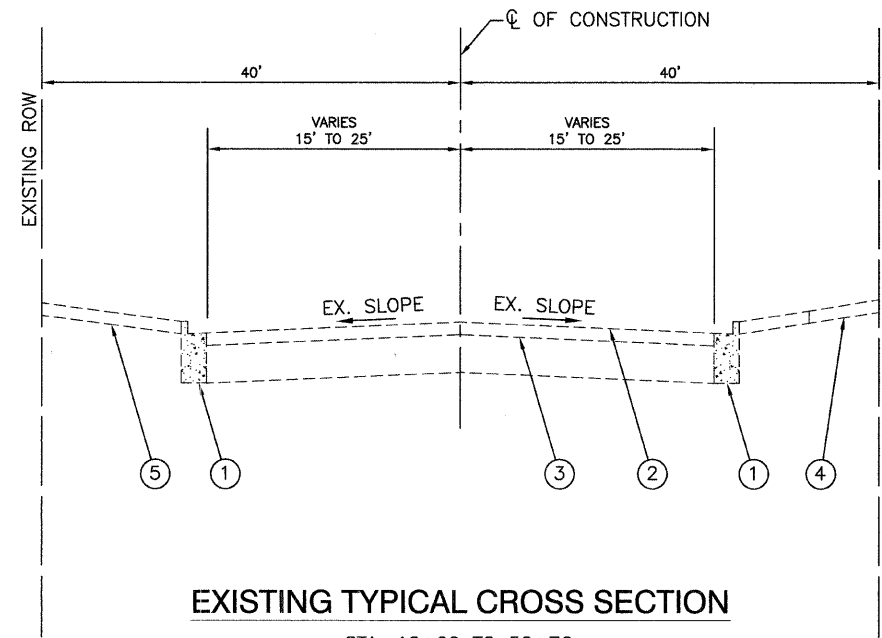

EXISTING TYPICAL CROSS SECTION

STA. 10+00 TO 52+76

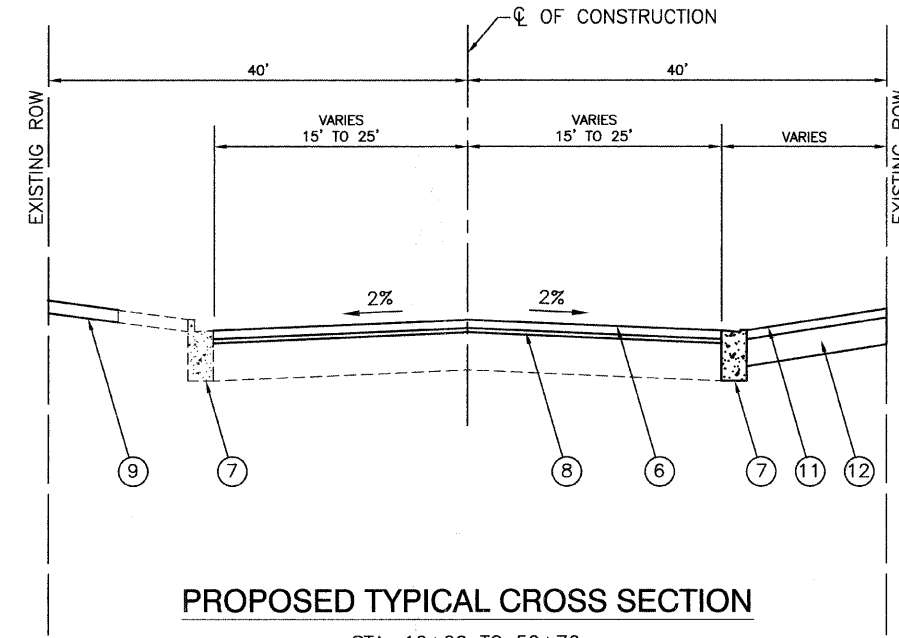

PROPOSED TYPICAL CROSS SECTION

STA. 10+00 TO 52+76

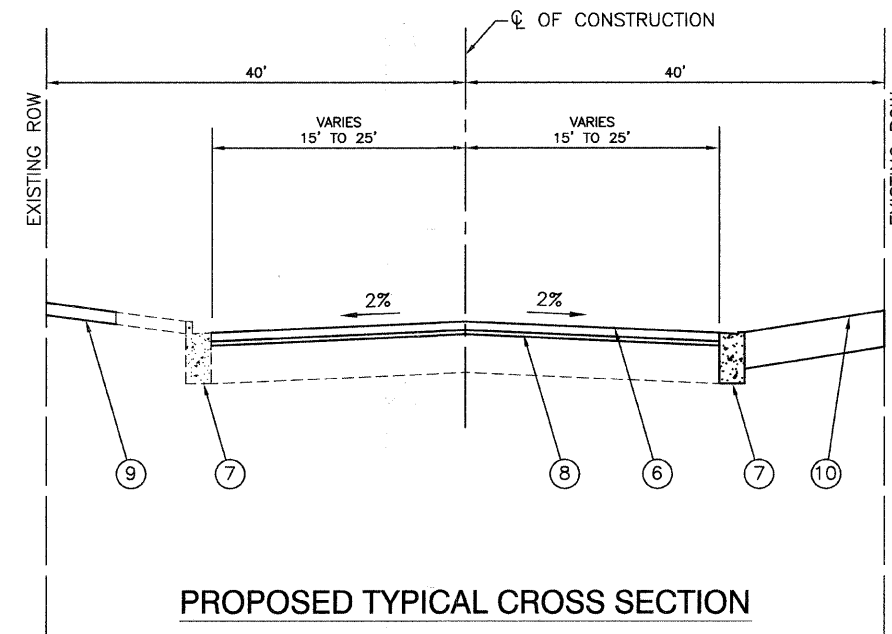

PROPOSED TYPICAL CROSS SECTION

STA. 10+00 TO 52+76

- 1 EXISTING CURB & GUTTER TO BE REMOVED AT LOCATIONS AS SHOWN ON PLANS OR DIRECTED BY ENGINEER
- 2 HOT-MIX ASPHALT SURFACE REMOVAL, 2"
- 3 EXISTING BITUMINOUS BASE COURSE TO REMAIN, ±10"
- 4 EXISTING P.C. CONCRETE SIDEWALK TO BE REMOVED AT LOCATIONS AS SHOWN ON PLANS OR DIRECTED BY ENGINEER
- 5 EXISTING DRIVEWAY PAVEMENT TO BE REMOVED AT LOCATIONS AS SHOWN ON PLANS OR DIRECTED BY ENGINEER
- 6 HOT-MIX ASPHALT SURFACE COURSE, MIX D, N50 1½"
- 7 COMBINATION CONCRETE CURB & GUTTER, B6.12 AT LOCATIONS AS SHOWN ON PLANS OR DIRECTED BY ENGINEER
- 8 POLYMERIZED LEVELING BINDER (MACHINE METHOD), IL-4.75, N50, 3/4"
- 9 PORTLAND CEMENT CONCRETE SIDEWALK, 5 INCH AT LOCATIONS SHOWN ON PLANS OR DIRECTED BY ENGINEER
- 10 PORTLAND CEMENT CONCRETE DRIVEWAY PAVEMENT AT LOCATIONS SHOWN ON PLANS OR DIRECTED BY ENGINEER
- 11 HOT-MIX ASPHALT SURFACE COURSE, MIX "C", N50, 2"
- 12 HOT-MIX ASPHALT BASE COURSE, 6"

HOT-MIX ASPHALT MIXTURE REQUIREMENTS

MIXTURE TYPE	AC TYPE	AIR VOIDS
RESURFACING		
HOT-MIX ASPHALT SURFACE COURSE, MIX "D", N50(IL-9.5mm); 1 1/2"	PG 64-22	4% @ 50 Gyr.
POLYMERIZED LEVELING BINDER (MACHINE METHOD), IL-4.75, N50, 3/4"	SBS/SBR PG 76-28 *	4% @ 50 Gyr.
DRIVEWAYS		
HOT MIX ASPHALT SURFACE COURSE, MIX "C", N50(IL-9.5mm); 2"	PG 64-22	4% @ 50 Gyr.
HOT MIX ASPHALT BASE COURSE, (HMA BINDER IL-19.0mm); 6"	PG 64-22 *	4% @ 50 Gyr.
PATCHING		
CLASS D PATCHES, TYPE II, III, IV, (HMA BINDER IL-19.0mm); 9"	PG 64-22 *	4% @ 70 Gyr.

NOTE:
 1. THE UNIT WEIGHT USED TO CALCULATE ALL HOT-MIX ASPHALT SURFACE MIXTURE QUANTITIES IS 112 LBS/SY/IN.
 2. *WHEN RAP EXCEEDS 20%, THE NEW ASPHALT BINDER IN THE MIX SHALL BE PG 58-22.

FILE NAME = 08478.TYPX.01 - PD1

USER NAME =	DESIGNED — MRS	REVISED —
	CHECKED — PKB	REVISED —
PLOT SCALE = NONE	DRAWN — MJD	REVISED —
PLOT DATE = 12/18/08	CHECKED — MJD	REVISED —

STATE OF ILLINOIS
 DEPARTMENT OF TRANSPORTATION

115TH STREET RESURFACING
 TYPICAL CROSS SECTIONS
 WORTH, ILLINOIS

SCALE: NONE SHEET NO. 3 OF 10 SHEETS STA. — TO STA. —

F.A. RTE.	SECTION	COUNTY	TOTAL SHEETS	SHEET NO.
1583	08-00056-00-RS	COOK	10	3
CONTRACT NO. 63116				
FED. ROAD DIST. NO. 1 ILLINOIS FED. AID PROJECT M-9003(124)				

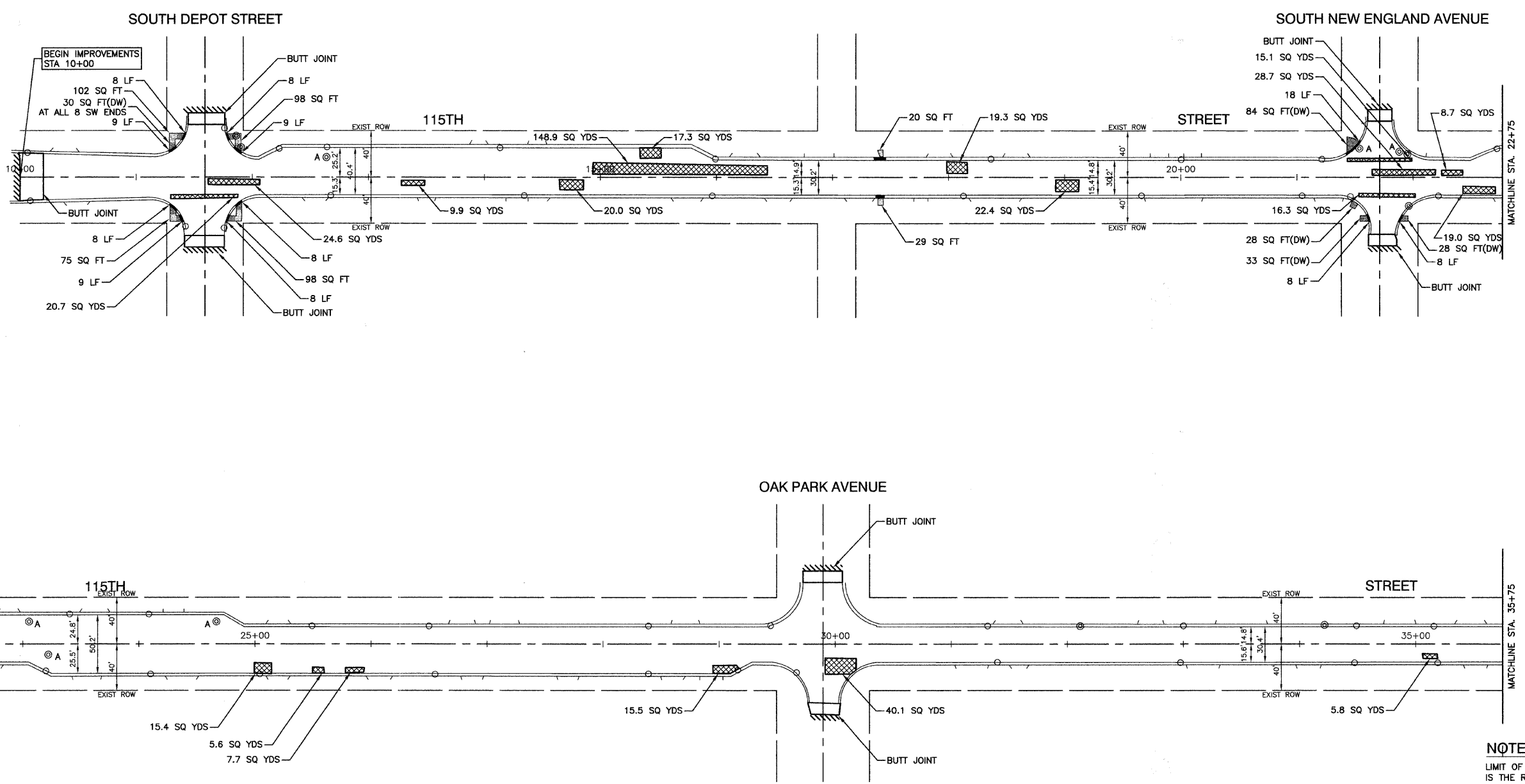

NOTE:
LIMIT OF CONSTRUCTION ON ALL SIDE STREETS IS THE RADIUS RETURN PLUS 10' BUTT JOINT

- LEGEND**
- HMA PAVEMENT REPAIR
 - HMA DRIVEWAY REMOVAL AND REPLACEMENT
 - CONCRETE DRIVEWAY REMOVAL AND REPLACEMENT
 - CONCRETE SIDEWALK REMOVAL AND REPLACEMENT
 - BUTT JOINTS
 - CURB REMOVAL
 - A STRUCTURE TO BE ADJUSTED
 - R STRUCTURE TO BE RECONSTRUCTED
 - ⊙ EXISTING MANHOLE
 - EXISTING CATCH BASIN
 - (DW) DETECTABLE WARNING

FILE NAME = 08478-PLAN-01 - P01	USER NAME =	DESIGNED -- MRS	REVISED --	STATE OF ILLINOIS DEPARTMENT OF TRANSPORTATION	115TH STREET RESURFACING PAVEMENT PLAN WORTH, ILLINOIS			F.A. RTE	SECTION	COUNTY	TOTAL SHEETS	SHEET NO.
	PLOT SCALE = 1"=50'	CHECKED -- PKB	REVISED --		SCALE: 1"=50'	SHEET NO. 4	OF 10 SHEETS	STA. 10+00 TO STA. 35+75	1583	08-00056-00-RS	COOK	10
PLOT DATE = 12/18/08	DRAWN -- MJD	CHECKED -- MJD	REVISED --					CONTRACT NO. 63116				
								FED. ROAD DIST. NO. 1 ILLINOIS FED. AID PROJECT M-9003(124)				

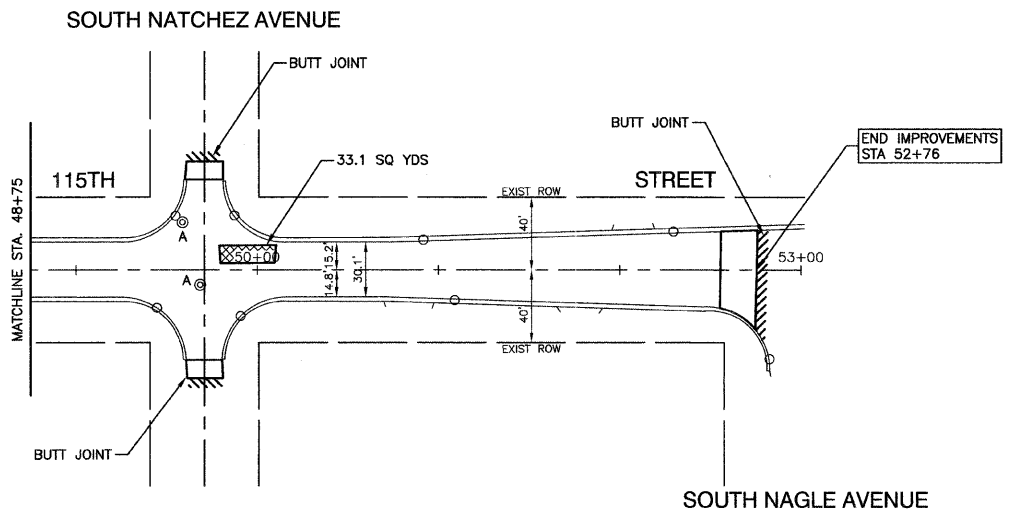
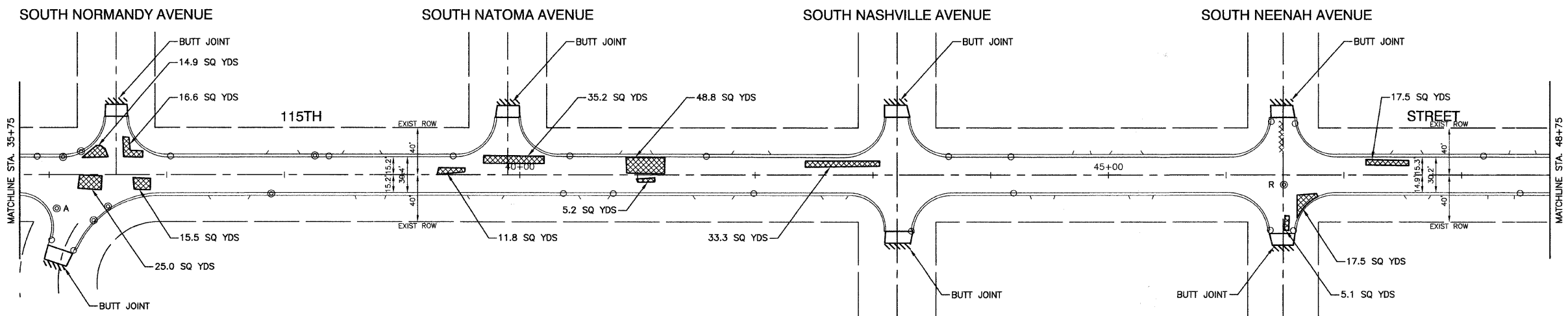

NOTE:
LIMIT OF CONSTRUCTION ON ALL SIDE STREETS IS THE RADIUS RETURN PLUS 10' BUTT JOINT

- LEGEND**
- HMA PAVEMENT REPAIR
 - HMA DRIVEWAY REMOVAL AND REPLACEMENT
 - CONCRETE DRIVEWAY REMOVAL AND REPLACEMENT
 - CONCRETE SIDEWALK REMOVAL AND REPLACEMENT
 - BUTT JOINTS
 - CURB REMOVAL
 - A STRUCTURE TO BE ADJUSTED
 - R STRUCTURE TO BE RECONSTRUCTED
 - ⊙ EXISTING MANHOLE
 - EXISTING CATCH BASIN
 - (DW) DETECTABLE WARNING

FILE NAME = 08478-PLAN-01 - P02	USER NAME =	DESIGNED -- MRS	REVISED --	STATE OF ILLINOIS DEPARTMENT OF TRANSPORTATION	115TH STREET RESURFACING PAVEMENT PLAN WORTH, ILLINOIS			F.A. RTE.	SECTION	COUNTY	TOTAL SHEETS	SHEET NO.
	PLOT SCALE = 1"=50'	CHECKED -- PKB	REVISED --		1583	08-00056-00-RS	COOK	10	5			
	PLOT DATE = 12/18/08	DRAWN -- MJD	REVISED --		SCALE: 1"=50' SHEET NO. 5 OF 10 SHEETS STA. 35+75 TO STA. 52+76			CONTRACT NO. 63116				
		CHECKED -- MJD	REVISED --		FED. ROAD DIST. NO. 1 ILLINOIS		FED. AID PROJECT M-9003(124)					

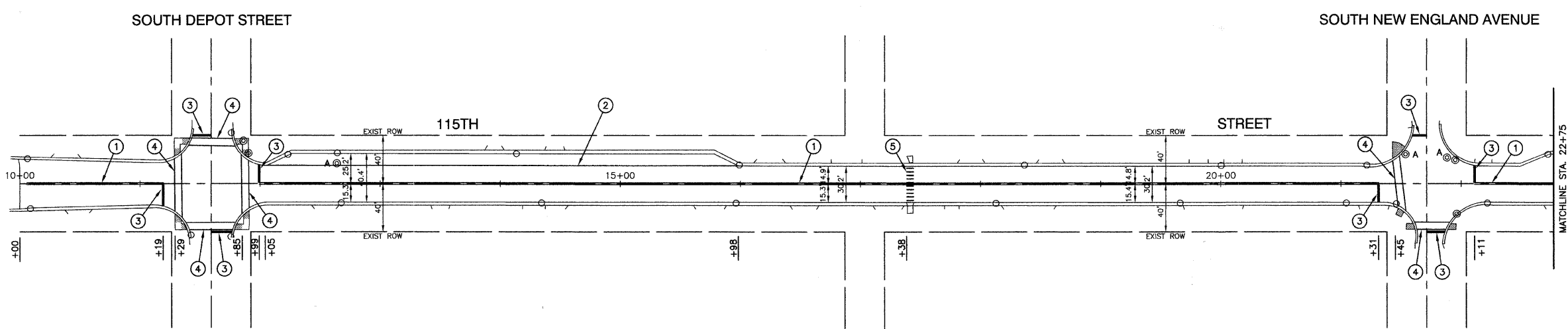

NOTE:
ALL LEGEND ITEMS ARE THERMOPLASTIC
PAVEMENT MARKING OF THE WIDTH AND TYPE SPECIFIED

PAVEMENT MARKING LEGEND

- ① DOUBLE 4" YELLOW CENTERLINE (11" C/C)
- ② 4" WHITE EDGE LINE
- ③ 24" WHITE STOP BAR
- ④ 6" WHITE CROSSWALK (6' C/C)
- ⑤ 12" WHITE CROSSWALK (3' C/C)

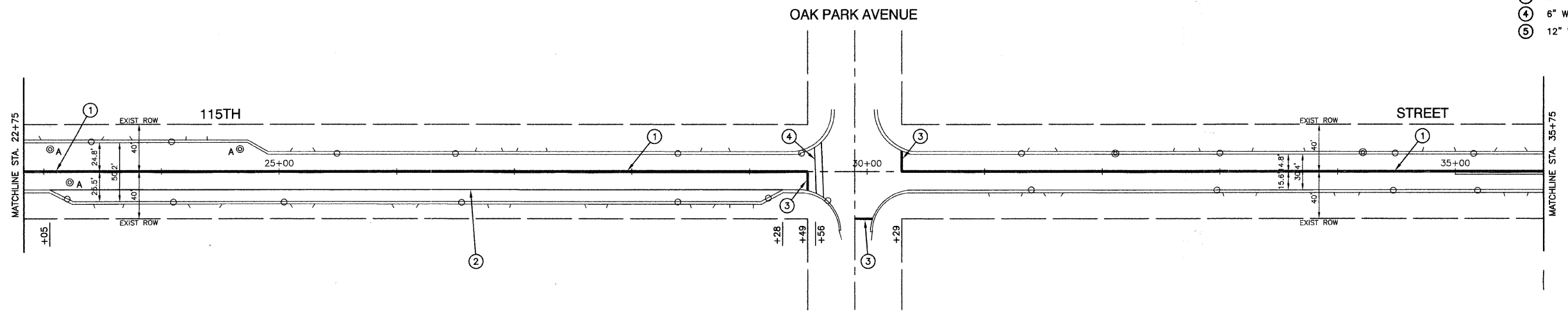

FILE NAME = 08478-PV/MK-01 - P01	USER NAME =	DESIGNED -- MRS	REVISED --	STATE OF ILLINOIS DEPARTMENT OF TRANSPORTATION	115TH STREET RESURFACING STRIPING PLAN WORTH, ILLINOIS			F.A. RTE	SECTION	COUNTY	TOTAL SHEETS	SHEET NO.
	PLOT SCALE = 1"=50'	CHECKED -- PKB	REVISED --		1583	08-00056-00-RS	COOK	10	6			
	PLOT DATE = 12/18/08	DRAWN -- MJD	REVISED --		SCALE: 1"=50' SHEET NO. 6 OF 10 SHEETS STA. 10+00 TO STA. 35+75			CONTRACT NO. 63116				
		CHECKED -- MJD	REVISED --					FED. ROAD DIST. NO. 1 ILLINOIS FED. AID PROJECT M-9003(124)				

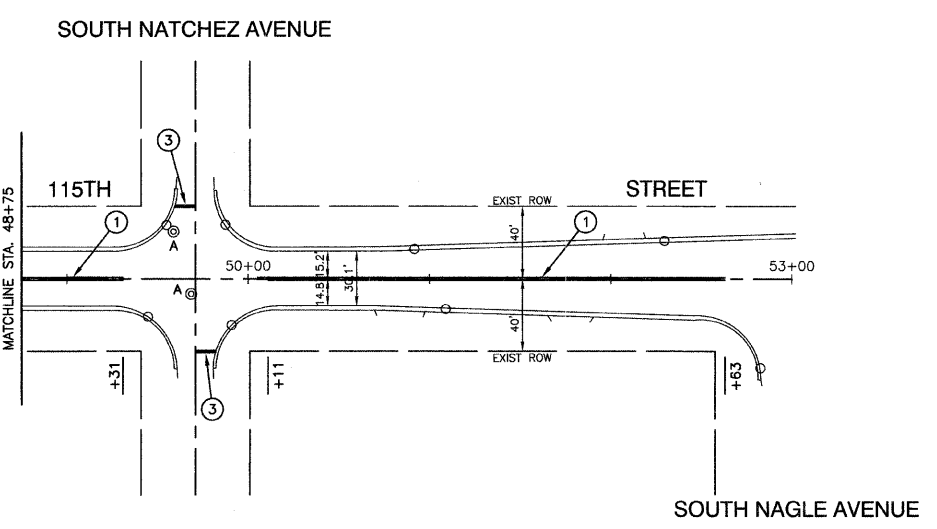
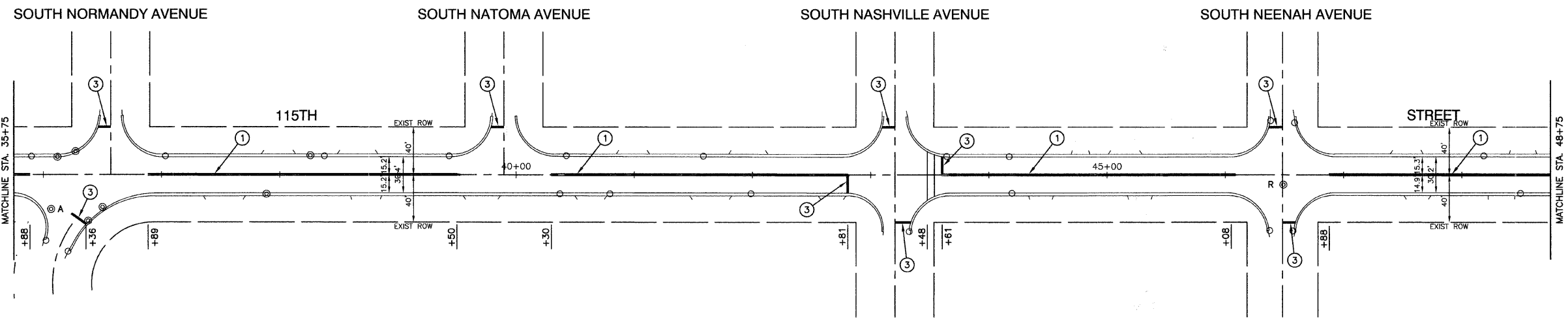

NOTE:
ALL LEGEND ITEMS ARE THERMOPLASTIC
PAVEMENT MARKING OF THE WIDTH AND TYPE SPECIFIED

PAVEMENT MARKING LEGEND

- ① DOUBLE 4" YELLOW CENTERLINE (11" C/C)
- ② 4" WHITE EDGE LINE
- ③ 24" WHITE STOP BAR
- ④ 6" WHITE CROSSWALK (6' C/C)
- ⑤ 12" WHITE CROSSWALK (3' C/C)

FILE NAME = 08478-PVMK-01 - P02	USER NAME =	DESIGNED -- MRS	REVISED --	STATE OF ILLINOIS DEPARTMENT OF TRANSPORTATION	115TH STREET RESURFACING STRIPING PLAN WORTH, ILLINOIS			F.A. RTE	SECTION	COUNTY	TOTAL SHEETS	SHEET NO.
		CHECKED -- PKB	REVISED --		1583	08-00058-00-RS	COOK	10	7			
	PLOT SCALE = 1"=50'	DRAWN -- MJD	REVISED --		SCALE: 1"=50' SHEET NO. 7 OF 10 SHEETS STA. 35+75 TO STA. 52+76			FED. ROAD DIST. NO. 1	ILLINOIS	FED. AID PROJECT M-9003(124)		
	PLOT DATE = 12/18/08	CHECKED -- MJD	REVISED --		CONTRACT NO. 63116							

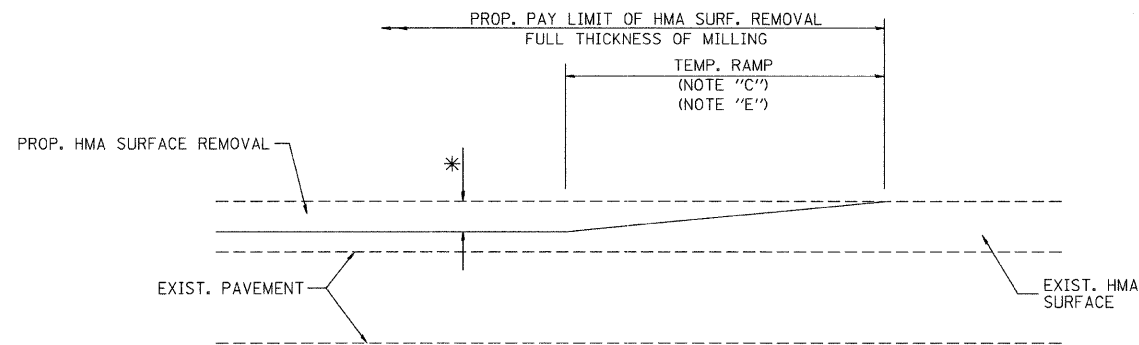

MILLED TEMPORARY RAMP
(FOR BUTT JOINT AND HMA TAPER SEE DETAIL BELOW)

OPTION 1

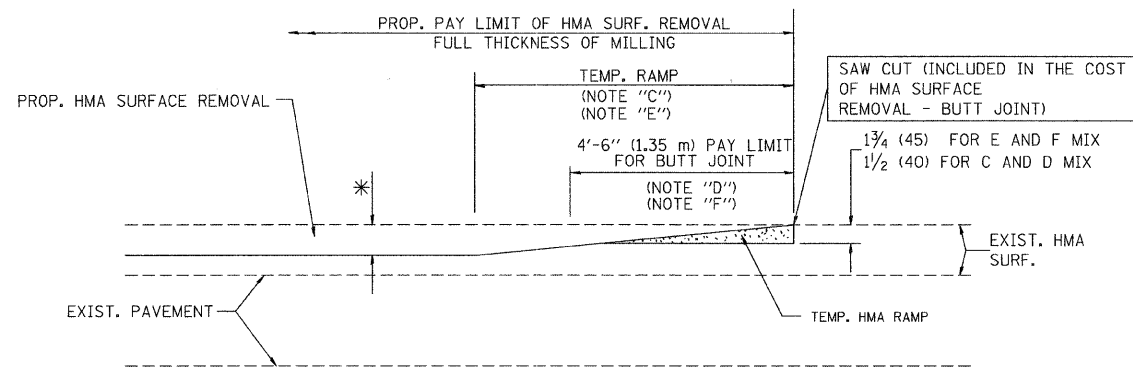

HMA CONSTRUCTED TEMPORARY RAMP
(FOR BUTT JOINT AND HMA TAPER SEE DETAIL BELOW)

OPTION 2

TYPICAL TEMPORARY RAMP

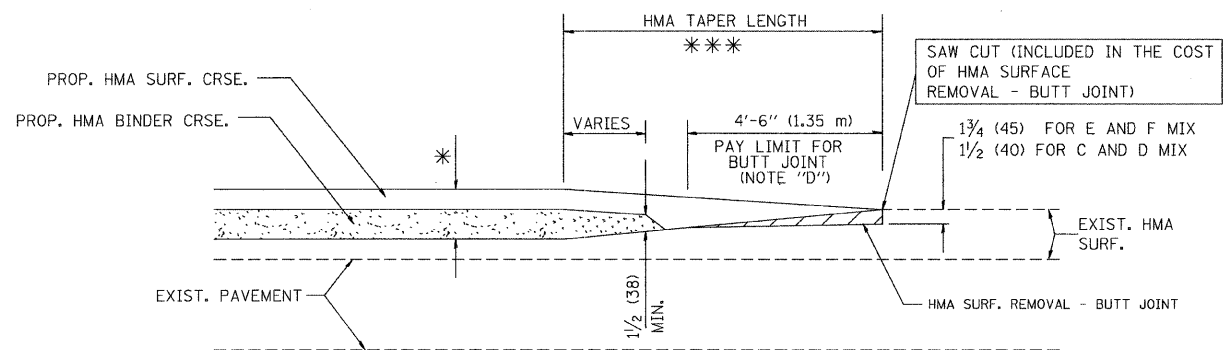

BUTT JOINT AND
HMA TAPER

TYPICAL BUTT JOINT AND HMA TAPER
FOR MILLING AND RESURFACING

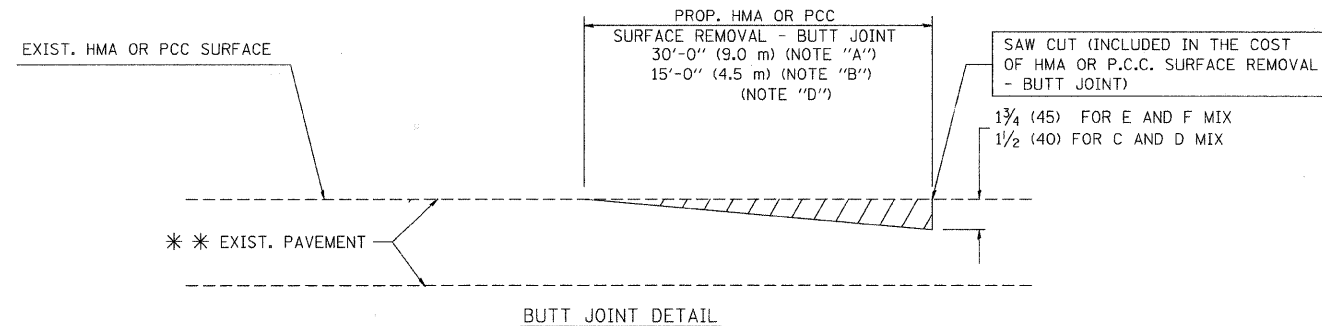

BUTT JOINT DETAIL

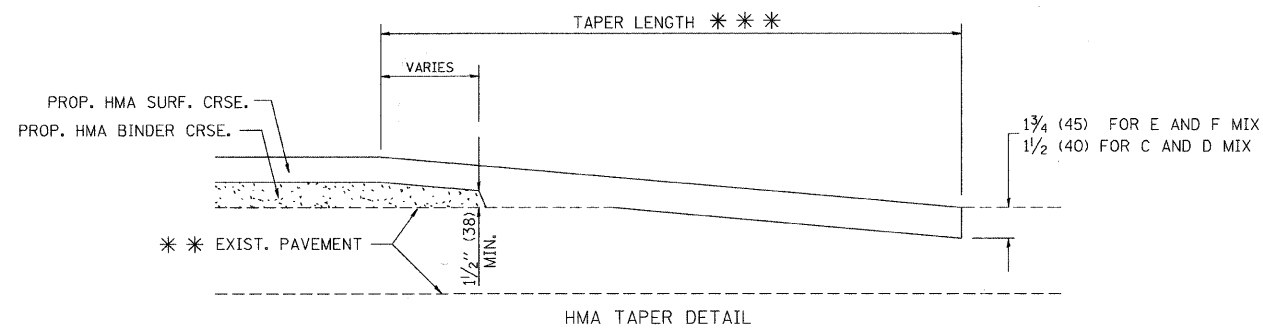

HMA TAPER DETAIL

TYPICAL BUTT JOINT AND HMA TAPER
FOR RESURFACING ONLY

** PC CONCRETE, HMA OR HMA RESURFACED PAVEMENT.

NOTES

- A: MAINLINE ROADWAYS AND MAJOR SIDE ROADS.
 - B: MINOR SIDE ROADS.
 - C: THE TEMP. RAMP SHALL BE CONSTRUCTED IMMEDIATELY UPON REMOVAL OF THE EXISTING HMA SURFACE.
 - D: THE BUTT JOINT SHALL BE CONSTRUCTED IMMEDIATELY PRIOR TO PLACING THE PROPOSED HMA COURSES.
 - E: TAPER THE TEMP. RAMP AT A RATE OF 3'-0" (900 mm) PER 1 INCH (25 mm) OF MILLING THICKNESS.
 - F: INSTALLATION AND REMOVAL OF THE 4'-6" (1.35 m) TEMP. RAMP IS INCLUDED IN COST OF HMA SURFACE REMOVAL - BUTT JOINT
 - G: SEE ARTICLE 406.08 AND 406.14 OF THE STANDARD SPECIFICATIONS FOR "HMA AND/OR PCC SURFACE REMOVAL, BUTT JOINT".
- * SEE TYPICAL SECTIONS FOR MILLING THICKNESS.
- ** 20'-0" (6.1 m) PER 1 (25) RESURFACING (NOTE "A")
10'-0" (3.0 m) PER 1 (25) RESURFACING (NOTE "B")

BASIS OF PAYMENT:

THE BUTT JOINT WILL BE PAID FOR AT THE CONTRACT UNIT PRICE PER SQUARE YARD (SQUARE METER) FOR "HOT-MIX ASPHALT SURFACE REMOVAL - BUTT JOINT" OR FOR "PORTLAND CEMENT CONCRETE SURFACE REMOVAL - BUTT JOINT".

ALL DIMENSIONS ARE IN INCHES (MILLIMETERS) UNLESS OTHERWISE SHOWN.

FILE NAME = W:\dstatd\22x34\bd32.dgn	USER NAME = gaglienobt	DESIGNED - M. DE YONG	REVISED - R. SHAH 10-25-94
		DRAWN -	REVISED - A. ABBAS 03-21-97
		CHECKED -	REVISED - M. GOMEZ 04-06-01
		DATE - 06-13-90	REVISED - R. BORO 01-01-07

STATE OF ILLINOIS
DEPARTMENT OF TRANSPORTATION

DISTRICT ONE BUTT JOINT AND HMA TAPER DETAILS			
SCALE: NONE	SHEET NO. 8	OF 10 SHEETS	STA. TO STA.

F.A.U. RTE	SECTION	COUNTY	TOTAL SHEETS	SHEET NO.
1583	08-00058-00-RS	COOK	10	8
BD400-05 BD32			CONTRACT NO. 63116	
FED. ROAD DIST. NO. 1 ILLINOIS FED. AID PROJECT M-9003(124)				

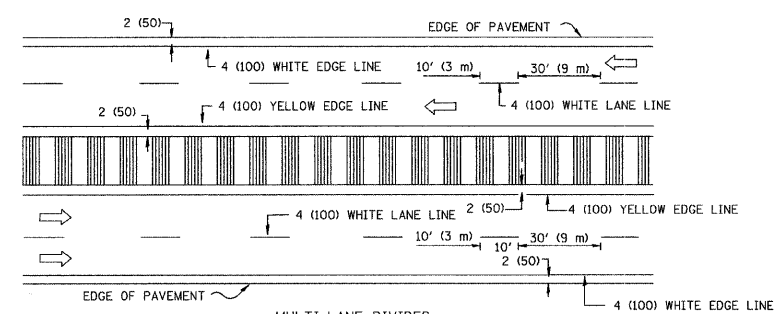
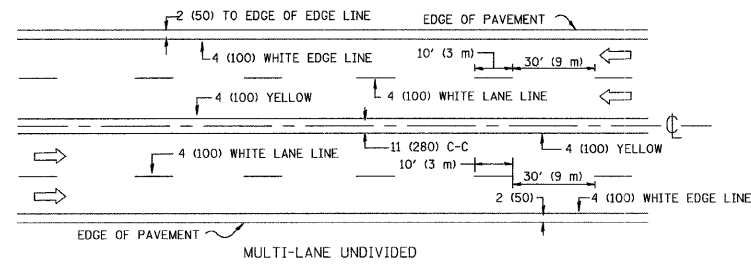
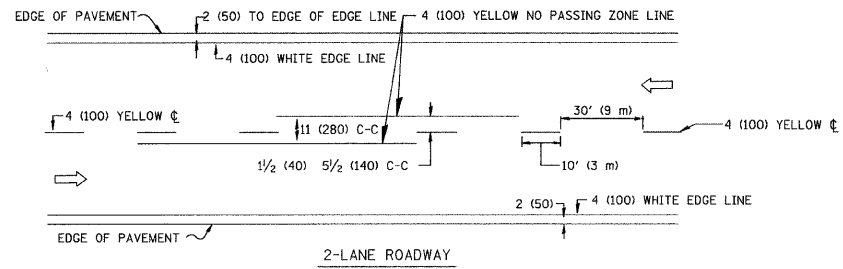

NOTE: MEDIANS WITH BARRIER CURB DO NOT REQUIRE AN EDGE LINE

TYPICAL LANE AND EDGE LINE MARKING

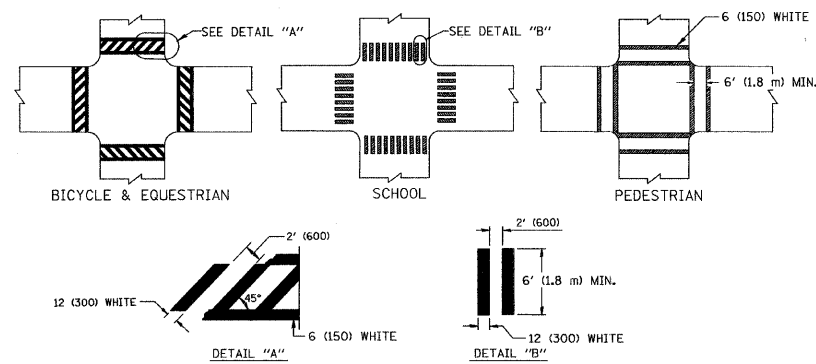

TYPICAL CROSSWALK MARKING

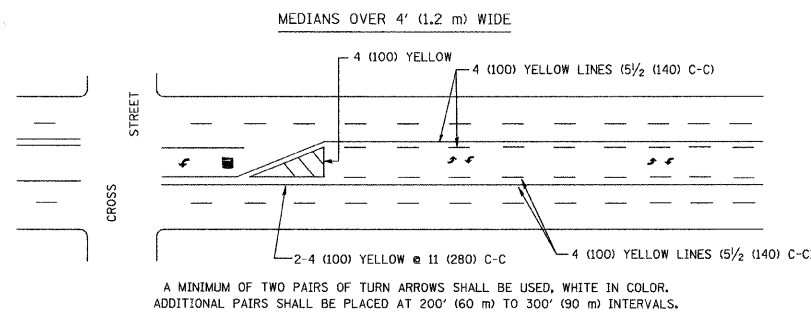
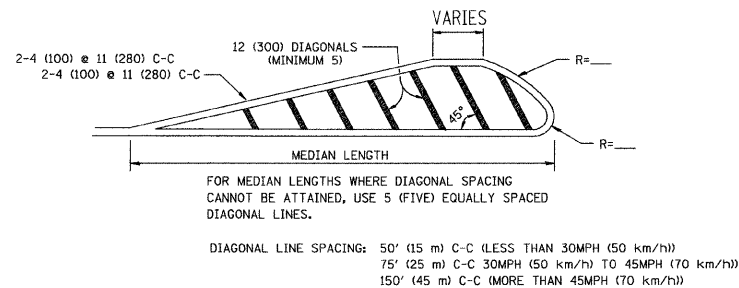
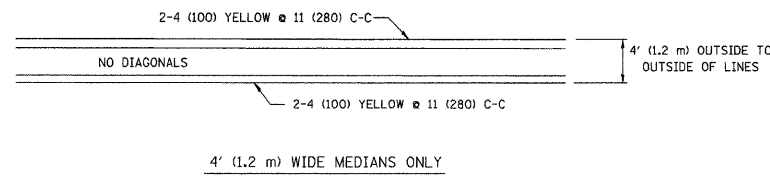

TYPICAL PAINTED MEDIAN MARKING

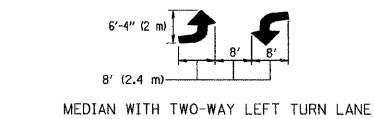

TYPICAL LEFT (OR RIGHT) TURN LANE

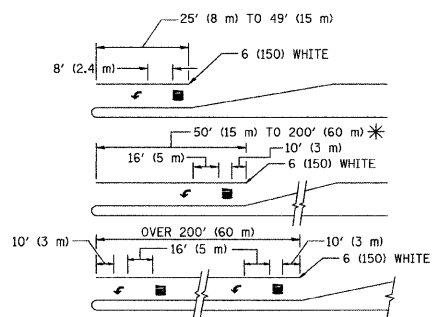

TYPICAL TURN LANE MARKING

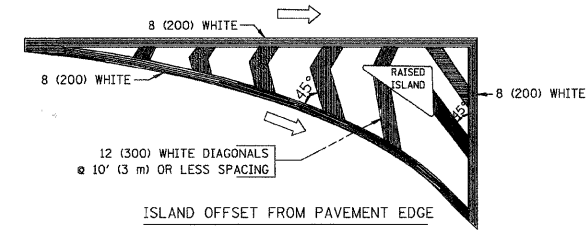

ISLAND OFFSET FROM PAVEMENT EDGE

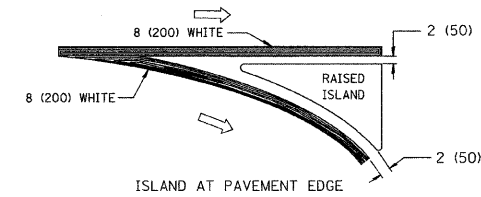

ISLAND AT PAVEMENT EDGE

TYPICAL ISLAND MARKING

TYPE OF MARKING	WIDTH OF LINE	PATTERN	COLOR	SPACING / REMARKS
CENTERLINE ON 2 LANE PAVEMENT	4 (100)	SKIP-DASH	YELLOW	10' (3 m) LINE WITH 30' (9 m) SPACE
CENTERLINE ON MULTI-LANE UNDIVIDED PAVEMENT	2 @ 4 (100)	SOLID	YELLOW	11 (280) C-C
NO PASSING ZONE LINES FOR ONE DIRECTION FOR BOTH DIRECTIONS	4 (100) 2 @ 4 (100)	SOLID SOLID	YELLOW YELLOW	5/2 (140) C-C FROM SKIP-DASH CENTERLINE 11 (280) C-C OMIT SKIP-DASH CENTERLINE BETWEEN
LANE LINES	4 (100) 5 (125)	SKIP-DASH SKIP-DASH	WHITE WHITE	10' (3 m) LINE WITH 30' (9 m) SPACE
DOTTED LINES (EXTENSIONS OF CENTER, LANE OR TURN LANE MARKINGS)	SAME AS LINE BEING EXTENDED	SKIP-DASH	SAME AS LINE BEING EXTENDED	2' (600) LINE WITH 6' (1.8 m) SPACE
EDGE LINES	4 (100)	SOLID	YELLOW-LEFT WHITE-RIGHT	OUTLINE MOUNTABLE MEDIANS IN YELLOW; EDGE LINES ARE NOT USED NEXT TO BARRIER CURB
TURN LANE MARKINGS	6 (150) LINE; FULL SIZE LETTERS & SYMBOLS (8' (2.4m))	SOLID	WHITE	SEE TYPICAL TURN LANE MARKING DETAIL
TWO WAY LEFT TURN MARKING	2 @ 4 (100) EACH DIRECTION 8' (2.4m) LEFT ARROW	SKIP-DASH AND SOLID IN PAIRS	YELLOW WHITE	10' (3 m) LINE WITH 30' (9 m) SPACE FOR SKIP-DASH; 5/2 (140) C-C BETWEEN SOLID LINE AND SKIP-DASH LINE SEE TYPICAL TWO-WAY LEFT TURN MARKING DETAIL
CROSSWALK LINES (PEDESTRIAN) A. DIAGONALS (BIKE & EQUESTRIAN) B. LONGITUDINAL BARS (SCHOOL)	2 @ 6 (150) 12 (300) @ 45° 12 (300) @ 90°	SOLID SOLID SOLID	WHITE WHITE WHITE	NOT LESS THAN 6' (1.8 m) APART 2' (600) APART 2' (600) APART SEE TYPICAL CROSSWALK MARKING DETAILS.
STOP LINES	24 (600)	SOLID	WHITE	PLACE 4' (1.2 m) IN ADVANCE OF AND PARALLEL TO CROSSWALK, IF PRESENT. OTHERWISE, PLACE AT DESIRED STOPPING POINT. PARALLEL TO CROSSROAD CENTERLINE, WHERE POSSIBLE
PAINTED MEDIANS	2 @ 4 (100) WITH 12 (300) DIAGONALS @ 45° NO DIAGONALS USED FOR 4' (1.2 m) WIDE MEDIANS	SOLID	YELLOW: TWO WAY TRAFFIC WHITE: ONE WAY TRAFFIC	11 (280) C-C FOR THE DOUBLE LINE SEE TYPICAL PAINTED MEDIAN MARKING.
CORE MARKING AND CHANNELIZING LINES	8 (200) WITH 12 (300) DIAGONALS @ 45°	SOLID	WHITE	DIAGONALS: 15' (4.5 m) C-C (LESS THAN 30MPH (50 km/h)) 20' (6 m) C-C 30MPH (50 km/h) TO 45MPH (70 km/h) 30' (9 m) C-C (OVER 45MPH (70 km/h))
RAILROAD CROSSING	24 (600) TRANSVERSE LINES; "RR" IS 6' (1.8 m) LETTERS; 16 (400) LINE FOR "X"	SOLID	WHITE	SEE STATE STANDARD 780001 AREA OF: "R"=3.6 SQ. FT. (0.33 m ²) EACH "X"=54.0 SQ. FT. (5.0 m ²)
SHOULDER DIAGONALS	12 (300) @ 45°	SOLID	WHITE - RIGHT YELLOW - LEFT	50' (15 m) C-C (LESS THAN 30MPH (50 km/h)) 75' (25 m) C-C (30 MPH (50 km/h) TO 45MPH (70 km/h)) 150' (45 m) C-C (OVER 45MPH (70 km/h))

FOR FURTHER DETAILS ON PAVEMENT MARKING REFER TO STANDARD SPECIFICATIONS FOR ROAD AND BRIDGE CONSTRUCTION AND STATE STANDARD 780001.

All dimensions are in inches (millimeters) unless otherwise shown.

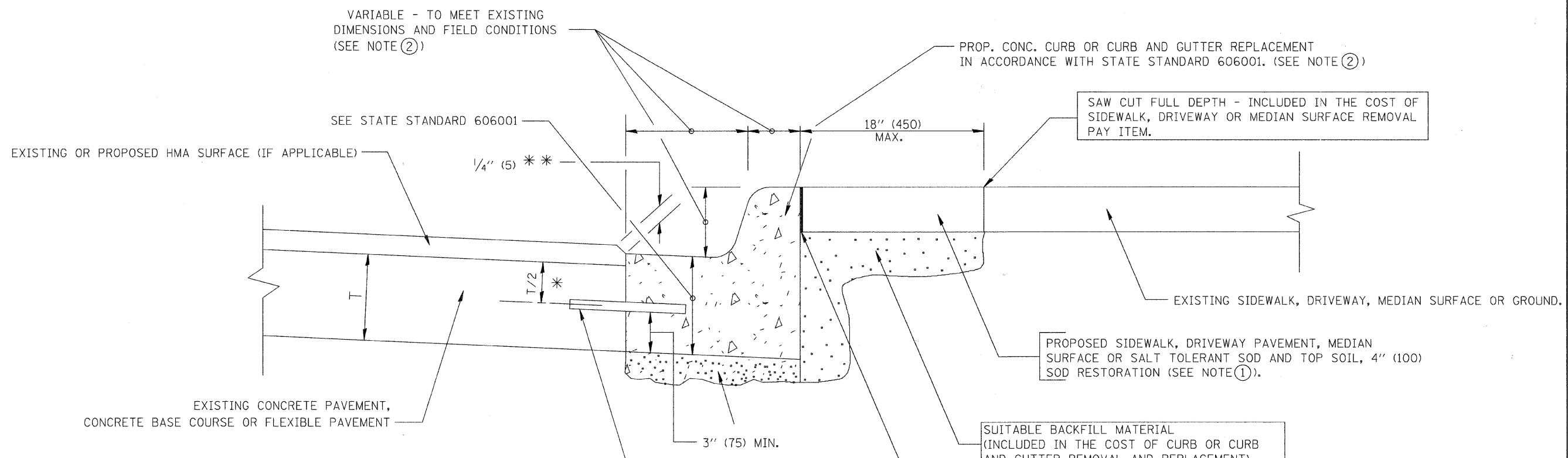

* 3" (75) MINIMUM FROM TOP AND BOTTOM OF THE CONCRETE PAVEMENT OR BASE COURSE.

** IF THE FINAL SURFACE OF THE PAVEMENT IS CONCRETE, THE GUTTER IS TO BE FLUSH WITH THE PAVEMENT.

NOTE: ① SIDEWALK, DRIVEWAY PAVEMENT OR MEDIAN SURFACE SHALL BE SIMILAR TO THE MATERIAL BEING REMOVED AND WILL BE PAID FOR SEPARATELY.

SALT TOLERANT SOD AND TOP SOIL, 4" (100) RESTORATION WILL NOT BE PAID FOR SEPARATELY, BUT SHALL BE INCLUDED IN THE COST OF CURB OR CURB AND GUTTER REMOVAL AND REPLACEMENT.

② CURB OR CURB AND GUTTER REPLACEMENT SHALL MATCH THE SHAPE OF THE EXISTING CURB OR CURB AND GUTTER UNLESS OTHERWISE SPECIFIED.

③ FOR CURB OR CURB AND GUTTER REMOVAL AND REPLACEMENT ADJACENT TO FLEXIBLE PAVEMENT DELETE EPOXY COATED TIE BARS.

④ LONGITUDINAL BARS, IF ENCOUNTERED IN THE EXISTING CURB OR CURB AND GUTTER, ARE NOT TO BE REPLACED. CUTTING AND REMOVING LONGITUDINAL BARS SHALL BE INCLUDED IN THE COST OF CURB OR CURB AND GUTTER REMOVAL AND REPLACEMENT.

⑤ THE COST OF HMA SURFACE REMOVAL IN THE EXISTING GUTTER FLAG SHALL BE INCLUDED IN THE COST OF THE CURB AND GUTTER REMOVAL AND REPLACEMENT.

⑥ THE REMOVAL AND REPLACEMENT OF THE EXISTING CURB OR CURB AND GUTTER SHALL BE DONE IN ACCORDANCE WITH THE APPLICABLE PORTIONS OF SECTION 440 AND 606 OF THE STANDARD SPECIFICATIONS.

⑦ THE LOCATIONS OF REMOVAL AND REPLACEMENT OF EXISTING CURB OR CURB AND GUTTER SHALL BE DETERMINED BY THE RESIDENT ENGINEER AT THE TIME OF CONSTRUCTION.

UNSUITABLE SUB-BASE MATERIAL TO BE REMOVED, IF DIRECTED BY THE ENGINEER, SHALL BE REPLACED WITH EITHER SUB-BASE GRANULAR MATERIAL, TYPE B OR ADDITIONAL THICKNESS OF CONCRETE.

REMOVAL AND REPLACEMENT 4" (100) OR LESS IS INCLUDED IN THE COST OF CURB OR CURB AND GUTTER REMOVAL AND REPLACEMENT.

REMOVAL AND REPLACEMENT IN EXCESS OF 4" (100) WILL BE PAID FOR IN ACCORDANCE WITH ARTICLE 109.04 OF THE STANDARD SPECIFICATIONS.

PROPOSED #6 (20) EPOXY COATED TIE BARS 24" (600) LONG AT 24" (600) CENTERS WILL NOT BE PAID FOR SEPARATELY. DELETE EPOXY COATED TIE BARS IF EXISTING TIE BARS ARE USABLE AS DETERMINED BY THE ENGINEER. (SEE NOTE ③).

BASIS OF PAYMENT:
THIS WORK WILL BE PAID FOR AT THE CONTRACT UNIT PRICE PER FOOT (METER) FOR "CURB REMOVAL AND REPLACEMENT" OR "COMBINATION CONCRETE CURB AND GUTTER REMOVAL AND REPLACEMENT".

CURB OR CURB AND GUTTER REMOVAL AND REPLACEMENT

ALL DIMENSIONS ARE IN INCHES (MILLIMETERS) UNLESS OTHERWISE SHOWN.

FILE NAME = W:\diststd\22x34\bd24.dgn	USER NAME = geglencbt	DESIGNED - A. HOUSEH	REVISED - R. SHAH 10-03-96	STATE OF ILLINOIS DEPARTMENT OF TRANSPORTATION	DISTRICT ONE TYPICAL PAVEMENT MARKINGS		F.A.U. RTE. 1583	SECTION 08-00056-00-RS	COUNTY COOK	TOTAL SHEETS 10	SHEET NO. 10	
	PLOT SCALE = 50.000' / IN.	DRAWN -	REVISED - A. ABBAS 03-21-97		SCALE: NONE	SHEET NO. 10	OF 10 SHEETS	STA.	TO STA.	CONTRACT NO. 63116		
	PLOT DATE = 1/4/2008	CHECKED -	REVISED - M. GOMEZ 01-22-01		FED. ROAD DIST. NO. 1 ILLINOIS FED. AID PROJECT M-9003(124)							
		DATE - 03-11-94	REVISED - R. BORO 01-01-07									