

F. A. A. REC.	SECTION	COUNTY	TOTAL SHEETS	SHEET NO.
	06-00162-02-SW	COOK	6	1
STA.	TO STA.			
FED. ROAD DIST. NO. 1	ILLINOIS	FED. AID PROJECT	CMM-9003(079)	

CONTRACT #63119

STATE OF ILLINOIS
DEPARTMENT OF TRANSPORTATION
DIVISION OF HIGHWAYS

**PLANS FOR PROPOSED
FEDERAL AID HIGHWAY**

**DORCHESTER AVENUE
151ST STREET TO THE SOUTH LEG OF 152ND STREET
SAFE ROUTES TO SCHOOL PROGRAM
SIDEWALK CONSTRUCTION AND BUS LOADING ZONE EXTENSION
CMAQ PROJECT NO.: CMM-9003(079)
L.A. SECTION NO.: 06-00162-02-SW
LEAD LOCAL AGENCY: VILLAGE of LANSING
LOCATED IN: VILLAGE of DOLTON
COOK COUNTY
C-91-020-09**

INDEX OF SHEETS
SEE SHEET NO. 2

STATE STANDARDS
SEE SHEET NO. 2

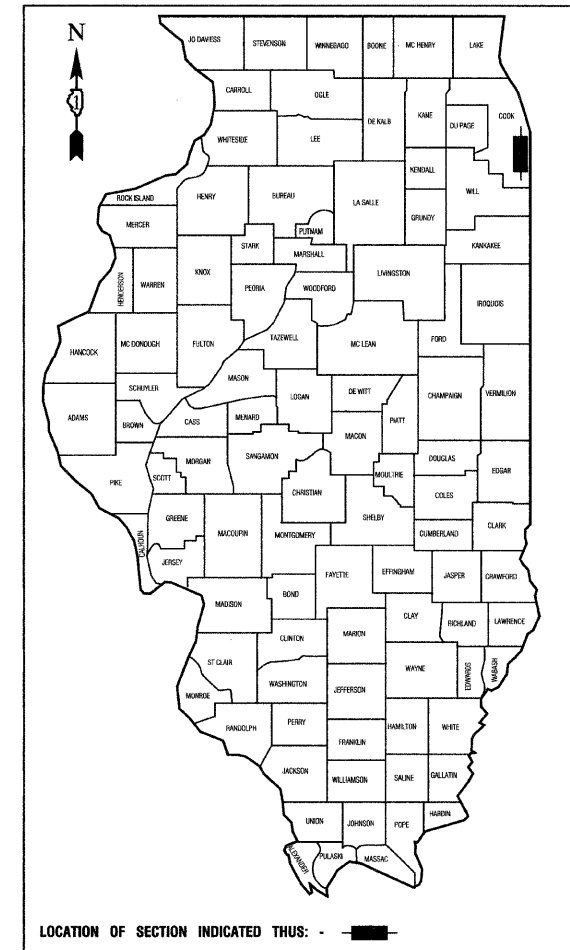

I.D.O.T. FIELD ENGINEER: MELCHOR MANGOBA 847-705-4408
CONSULTANTS: ROBINSON ENGINEERING, LTD. 708-331-6700

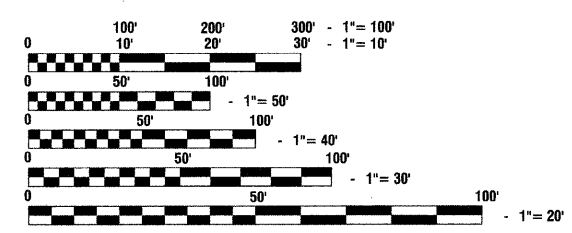

FULL SIZE PLANS HAVE BEEN PREPARED USING STANDARD ENGINEERING SCALES, REDUCED SIZED PLANS WILL NOT CONFORM TO STANDARD SCALES, IN MAKING MEASUREMENTS ON REDUCED PLANS, THE ABOVE SCALES MAY BE USED.

J. U. L. I. E.
JOINT UTILITY LOCATION INFORMATION FOR EXCAVATION
1-800-892-0123 or 811

CONTRACT NO. 63119

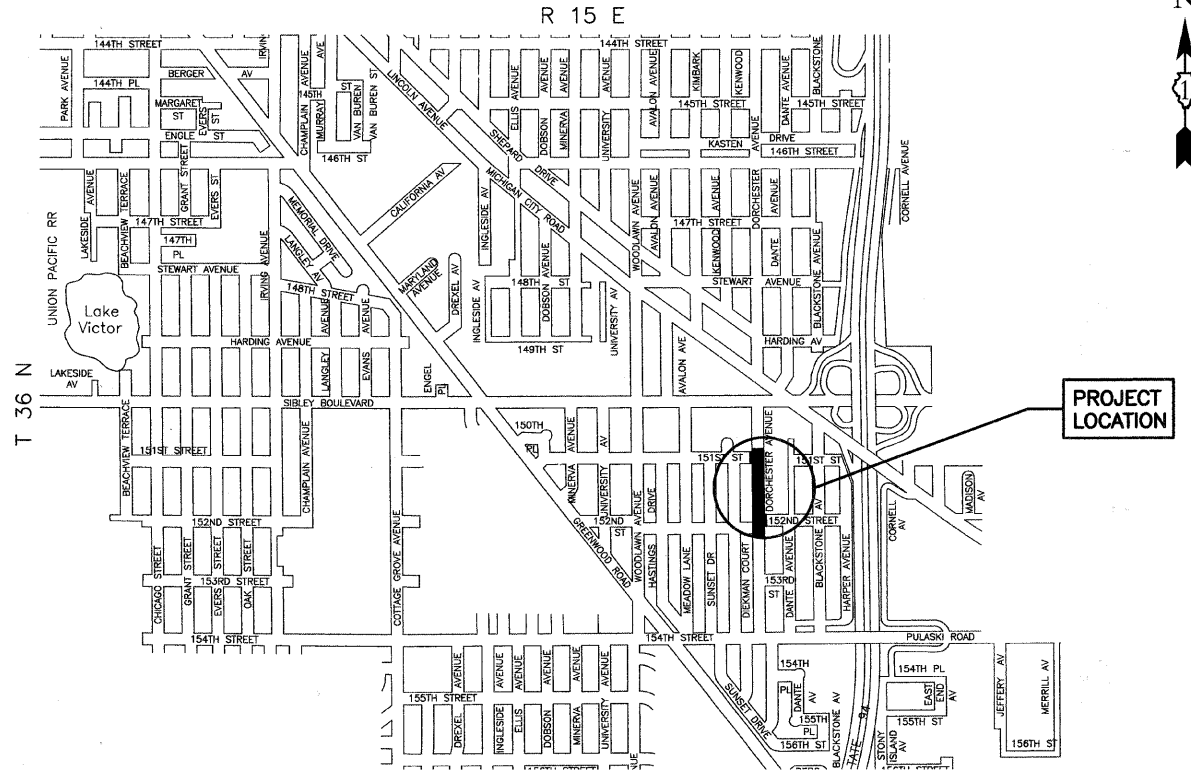

LOCATION MAP
GROSS LENGTH=830 FEET=0.16 MILES
NET LENGTH=830 FEET=0.16 MILES

STATE OF ILLINOIS DEPARTMENT OF TRANSPORTATION
DIVISION OF HIGHWAYS

Approved: 12/19/08
James W. Schaffner
President, Village of Lansing

Passed: FEBRUARY 9, 2009
Christopher Holt
District 1 Engineer of Local Roads & Streets

Released for Bid Based on Limited Review: FEBRUARY 10, 2009
Diane M. O'Keefe
Deputy Director of Highways, Region 1 Engineer

PRINTED BY THE AUTHORITY OF
THE STATE OF ILLINOIS

PREPARED BY OR UNDER THE DIRECT SUPERVISION OF:
James M. Jank
12/22/08

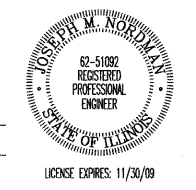

INDEX OF SHEETS

1. COVER SHEET
2. SUMMARY OF QUANTITIES, INDEX OF SHEETS, STATE STANDARDS, & GENERAL NOTES
3. TYPICAL SECTIONS
4. EXISTING PLAN
5. PROPOSED SIDEWALK, PAVEMENT MARKING, AND BUS LANE PLAN
6. DISTRICT 1 TYPICAL PAVEMENT MARKINGS

STATE STANDARDS

424001-05	CURB RAMPS FOR SIDEWALKS
606001-04	CONCRETE CURB TYPE B AND COMBINATION CONCRETE CURB AND GUTTER
701001-02	OFF-RD OPERATIONS, 2L, 2W, MORE THAN 15' (4.5m) AWAY
701006-03	OFF-RD OPERATIONS, 2L, 2W, 15' (4.5m) TO 24" (600mm) FROM PAVEMENT EDGE
701011-02	OFF-RD MOVING OPERATIONS, 2L, 2W, DAY ONLY
701311-03	LANE CLOSURE 2L, 2W MOVING OPERATIONS-DAY ONLY
701801-04	LANE CLOSURE MULTILANE 1W OR 2W CROSSWALK OR SIDEWALK CLOSURE
701901-01	TRAFFIC CONTROL DEVICES
780001-02	TYPICAL PAVEMENT MARKINGS
720001-01	SIGN PANEL MOUNTING DETAILS
720006-02	SIGN PANEL ERECTION DETAILS
720011-01	METAL POSTS FOR SIGNS, MARKERS & DELINEATORS
729001-01	APPLICATIONS OF TYPES A & B METAL POSTS (FOR SIGNS & MARKERS)

GENERAL NOTES:

EXISTING VILLAGE OWNED AND MAINTAINED UTILITY LINES ARE SHOWN ON THE PLANS TO INDICATE THEIR PRESENCE AND APPROXIMATE LOCATION. THE CONTRACTOR SHALL NOTIFY THE VILLAGE OF DOLTON PUBLIC WORKS DEPARTMENT (708) 201-3235 TWO WEEKS PRIOR TO COMMENCING ANY EXCAVATION IN THE VICINITY OF THIS LINES. THE VILLAGE WILL THEN LOCATE AND MARK THE HORIZONTAL LOCATIONS OF THE LINES AND PROVIDE ANY AVAILABLE INFORMATION AS TO THEIR DEPTH. SHOULD ANY OF THE LINES BE DAMAGED BY THE CONTRACTOR'S OPERATION, THE CONTRACTOR SHALL REPAIR THEM TO THE SATISFACTION OF THE ENGINEER AND AT NO COST TO THE VILLAGE/STATE.

UTILITY LINES WERE PLOTTED FROM INFORMATION FURNISHED BY THE VARIOUS UTILITY COMPANIES INVOLVED AND THE ACCURACY SHOULD BE CONSIDERED APPROXIMATE ONLY.

UTILITY COMPANIES MAY BE ADJUSTING THEIR FACILITIES DURING CONSTRUCTION. THE CONTRACTOR SHALL COOPERATE WITH THESE ORGANIZATIONS WHILE THESE ADJUSTMENTS ARE BEING PREFORMED. J.U.L.I.E.-JOINT UTILITY LOCATION INFORMATION FOR EXCAVATORS SYSTEM (800) 892-0123 OR 811.

SIDEWALK SLOPES SHALL NOT EXCEED A 2% CROSS SLOPE, 5% LONGITUDINAL SLOPE.

ALL GRASSED AREAS DISTURBED BY CONSTRUCTION OPERATIONS, INCLUDING LOCATIONS WHERE SIDEWALK IS TO BE REMOVED AND NOT REPLACED ARE TO BE RESTORED WITH TOPSOIL FURNISH AND PLACE, 4", NITROGEN, PHOSPHORUS AND POTASSIUM NUTRIENTS, AND SODDING, SALT TOLERANT AS DEPICTED IN THE SUMMARY OF QUANTITIES.

ALL PROPOSED SIGN PANELS SHALL HAVE TYPE AZ REFLECTORIZED SHEETING.

SUMMARY OF QUANTITIES					PAVEMENT	MARKINGS	SIGNS	LANDSCAPE
S.I.	CODE NO.	PAY ITEM	UNIT	QUAN	CONSTRUCTION TYPE CODE			
					I000	SFTY-1D	Y002-1C	Y003
	20200100	EARTH EXCAVATION	CU YD	89	89			
	21101615	TOPSOIL FURNISH AND PLACE, 4"	SQ YD	235				235
	25000400	NITROGEN FERTILIZER NUTRIENT	POUND	3				3
	25000500	PHOSPHORUS FERTILIZER NUTRIENT	POUND	3				3
	25000600	POTASSIUM FERTILIZER NUTRIENT	POUND	3				3
	25200110	SODDING, SALT TOLERANT	SQ YD	235				235
	31101200	SUB-BASE GRANULAR MATERIAL, TYPE B 4"	SQ YD	237	237			
	35102000	AGGREGATE BASE COURSE, TYPE B 8"	SQ YD	90	90			
	40600100	BITUMINOUS MATERIALS (PRIME COAT)	GALLON	27	27			
	40603080	HOT-MIX ASPHALT BINDER COURSE, IL-19.0, N50	TON	13	13			
	40603310	HOT-MIX ASPHALT SURFACE COURSE, MIX "C", N50	TON	10	10			
	42400200	PORTLAND CEMENT CONCRETE SIDEWALK 5 INCH	SQ FT	1976	1976			
	42400800	DETECTABLE WARNINGS	SQ FT	64	64			
	44000500	COMBINATION CURB AND GUTTER REMOVAL	FOOT	141	141			
	44000600	SIDEWALK REMOVAL	SQ FT	410	410			
	60300305	FRAMES AND LIDS TO BE ADJUSTED	EACH	1	1			
	60601005	CONCRETE CURB, TYPE B (SPECIAL)	FOOT	15	15			
	60608300	COMBINATION CONCRETE CURB AND GUTTER, TYPE M-2.12	FOOT	119	119			
	67100100	MOBILIZATION	L SUM	1	1			
	70102640	TRAFFIC CONTROL AND PROTECTION, STANDARD 701801	L SUM	1	1			
	72000100	SIGN PANEL - TYPE 1	SQ FT	6.0			6.0	
	72400100	REMOVE SIGN PANEL ASSEMBLY - TYPE A	EACH	2			2	
	72900200	METAL POST - TYPE B	FOOT	24			24	
*	78000600	THERMOPLASTIC PAVEMENT MARKING - LINE 12"	FOOT	220		220		
*	78000650	THERMOPLASTIC PAVEMENT MARKING - LINE 24"	FOOT	127		127		
	78300100	PAVEMENT MARKING REMOVAL	SQ FT	200		200		
	X6063401	COMBINATION CONCRETE CURB AND GUTTER, TYPE M-4.12	FOOT	87	87			
	X7240505	RELOCATE SIGN PANEL AND POST	EACH	1			1	
	XX001011	BICYCLE RACKS	EACH	1	1			

* - INDICATES SPECIALTY ITEMS

FILE NAME = 06612_02-INDX-01	USER NAME =	DESIGNED -- MPN	REVISED --	STATE OF ILLINOIS DEPARTMENT OF TRANSPORTATION	DORCHESTER AVENUE SIDEWALK CONSTRUCTION AND BUS LOADING ZONE EXTENSION SUMMARY OF QUANTITIES, INDEX OF SHEETS, STATE STANDARDS, & GENERAL NOTES			F.A.U. RTE.	SECTION	COUNTY	TOTAL SHEETS	SHEET NO.	
		CHECKED -- JAK	REVISED --						06-00162-02-SW	COOK	6	2	
	PLOT SCALE =	DRAWN -- RG	REVISED --			SCALE: NONE	SHEET NO. 2	OF 6	SHEETS	STA.	TO STA.	CONTRACT NO. 63119	
	PLOT DATE = 12-23-08	CHECKED -- MPN	REVISED --			FED. ROAD DIST. NO. 1		ILLINOIS	FED. AID PROJECT CMM-9003(079)				

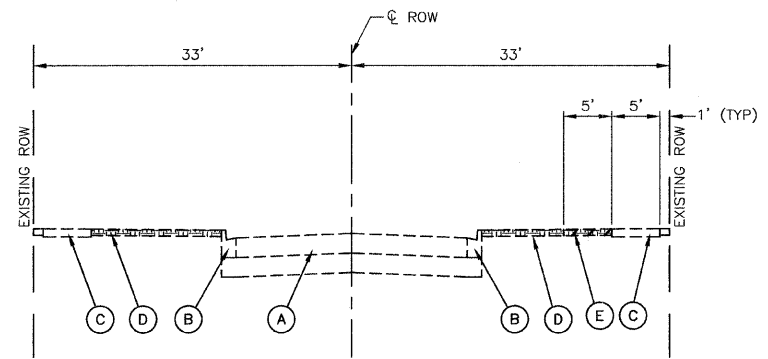

EXISTING TYPICAL CROSS SECTION
STA 11+25 TO STA 12+13 AND STA 16+05 TO STA 18+08

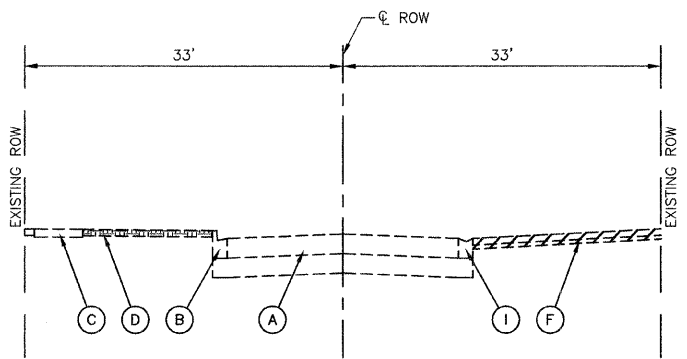

EXISTING TYPICAL CROSS SECTION
STA 12+13 TO STA 12+57

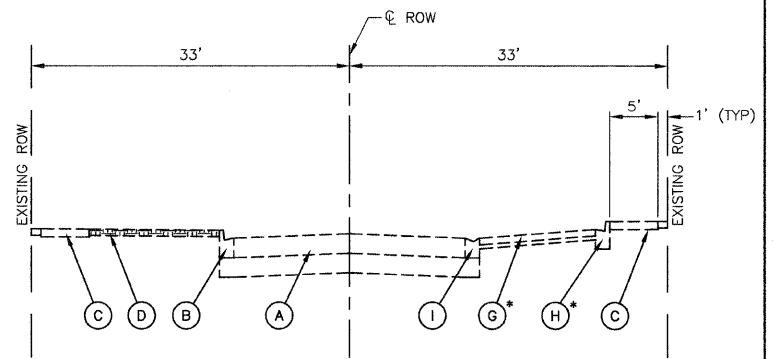

EXISTING TYPICAL CROSS SECTION
STA 12+88 TO STA 16+05

* STA 12+57 TO STA 12+88
EXISTING IS GRASSED PARKWAY UP TO P.C.C.
SIDEWALK AS SHOWN ON THE PLAN SHEET
(REMOVAL OF GRASSED PARKWAY TO BE PAID
FOR AS EARTH EXCAVATION.)

EXISTING LEGEND

- (A) EXISTING ROADWAY TO REMAIN
- (B) EXISTING TYPE M-2.12 CURB AND GUTTER TO REMAIN
- (C) CONCRETE SIDEWALK TO REMAIN
- (D) EXISTING GRASSED PARKWAY
- (E) EXISTING GRASSED PARKWAY TO BE REMOVED
(TO BE PAID FOR AS EARTH EXCAVATION)
- (F) EXISTING BITUMINOUS DRIVEWAY TO BE REMOVED
(TO BE PAID FOR AS EARTH EXCAVATION)
- (G) EXISTING BITUMINOUS BUS LOADING ZONE LANE
- (H) EXISTING CURB AND GUTTER TY. M-4.12 TO REMAIN
- (I) EXISTING DEPRESSED CURB TO REMAIN

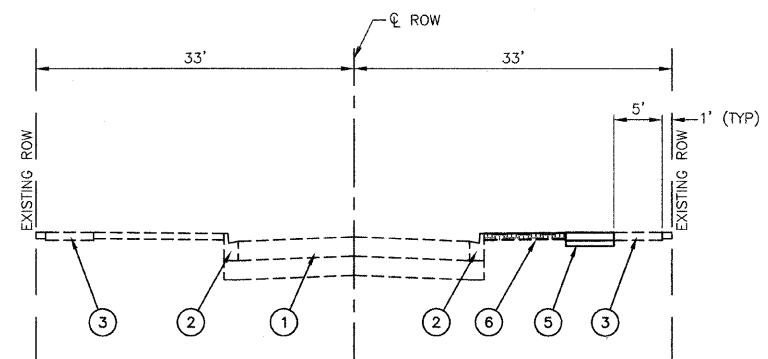

PROPOSED TYPICAL CROSS SECTION
STA 11+25 TO STA 12+13 AND STA 16+05 TO STA 18+08

PROPOSED LEGEND

- (1) EXISTING ROADWAY TO REMAIN
- (2) EXISTING TYPE M-2.12 CURB AND GUTTER TO REMAIN
- (3) CONCRETE SIDEWALK TO REMAIN
- (4) EXISTING DEPRESSED CURB TO REMAIN
- (5) PROPOSED P.C.C. SIDEWALK, 5"
- (6) PROPOSED SUB-BASE GRANULAR MATERIAL, TYPE B 4"
- (7) PROPOSED TOPSOIL, FURNISH AND PLACE, 4"
NUTRIENTS (NITROGEN, PHOSPHORUS, POTASSIUM)
SODDING, SALT TOLERANT
- (8) AGGREGATE BASE COURSE, TYPE B - 8"
- (9) HOT MIX ASPHALT BINDER COURSE, (HMA BINDER IL-19.0, N50) - 2 1/2"
- (10) HOT MIX ASPHALT SURFACE COURSE, MIX C, N50 - 2"
- (11) PROPOSED COMBINATION CONCRETE CURB AND GUTTER, TYPE M-4.12
- (12) PROPOSED SUB-BASE GRANULAR MATERIAL, TYPE B 4"

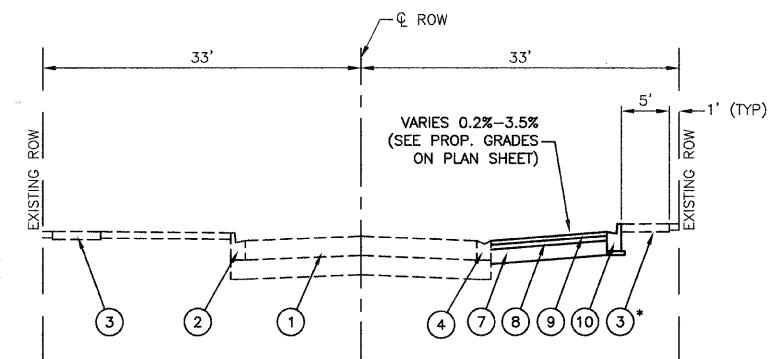

PROPOSED TYPICAL CROSS SECTION
STA 12+13 TO STA 12+88

* NEW P.C.C. SIDEWALK, 5" AND SUB-BASE
GRANULAR MATERIAL, 4" FROM STA 12+13
TO STA 12+57

HOT-MIX ASPHALT MIXTURE REQUIREMENTS		
MIXTURE TYPE	AC TYPE	AIR VOIDS
BUS LOADING ZONE LANE EXTENSION		
HOT-MIX ASPHALT SURFACE COURSE, MIX C, N50; (IL 9.5mm)	PG 64-22	4% AT 50 Gyr
HOT-MIX ASPHALT BINDER COURSE, N50; (IL-19.0mm)	PG 64-22 *	4% AT 50 Gyr

*WHEN RAP EXCEEDS 20%, THE NEW ASPHALT BINDER IN THE MIX SHALL BE PG 58-22
THE UNIT WEIGHT USED TO CALCULATE ALL HOT-MIX ASPHALT SURFACE MIXTURES IS 112 lbs/sq yd/ in.

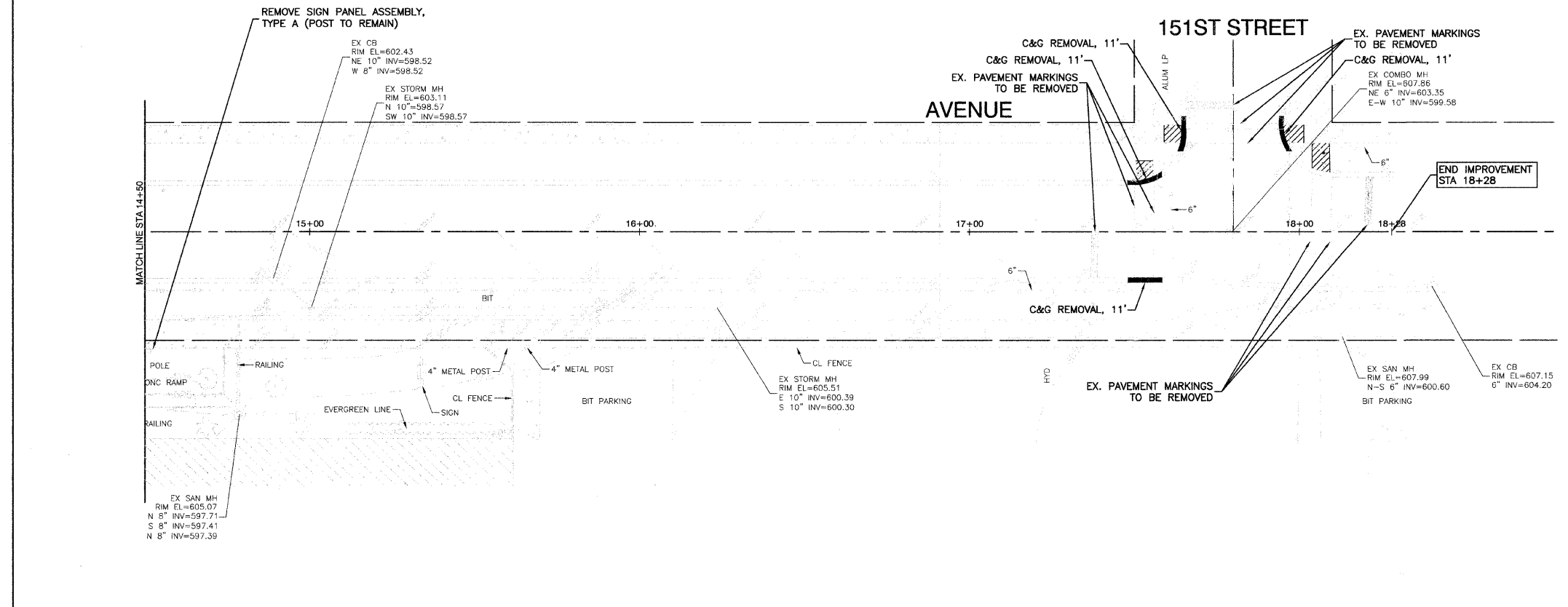
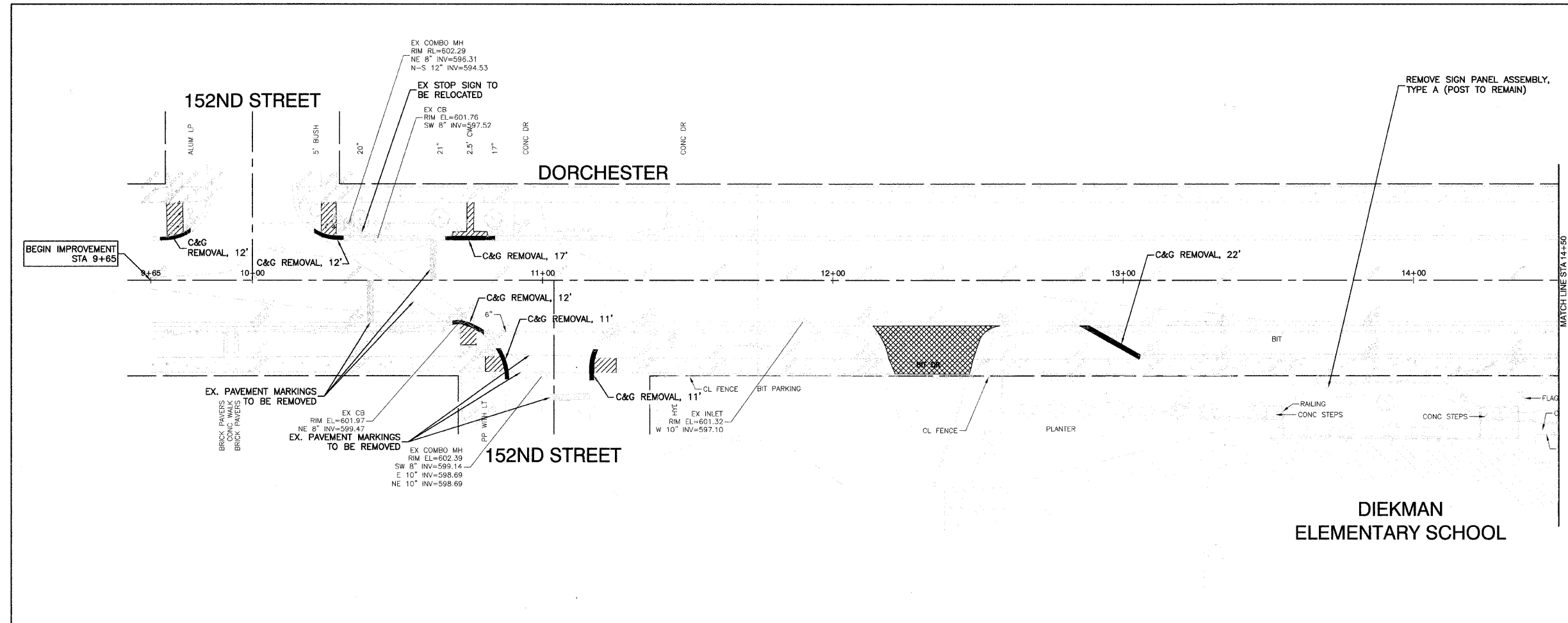
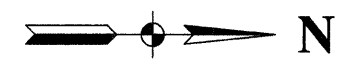

LEGEND

- SIDEWALK REMOVAL
- COMBINATION CONCRETE CURB AND GUTTER REMOVAL
- DRIVEWAY REMOVAL TO BE PAID FOR AS EARTH EXCAVATION
- EXISTING SIGN

BENCH MARK

SQUARE CUT ON SOUTH WEST CORNER OF CONC BASE FOR FLAG POLE AT MAIN ENTRANCE TO DIEKMAN SCHOOL ELEVATION=603.85

FILE NAME = 06012_02-PLAN-01
USER NAME =
PLOT SCALE =
PLOT DATE = 12-23-08

DESIGNED — MPN	REVISED —
CHECKED — MPN	REVISED —
DRAWN — RG	REVISED —
CHECKED — RG	REVISED —

**STATE OF ILLINOIS
DEPARTMENT OF TRANSPORTATION**

**DORCHESTER AVENUE
SIDEWALK CONSTRUCTION AND BUS LOADING ZONE EXTENSION
EXISTING PLAN**

SCALE: 1"=20' SHEET NO. 4 OF 6 SHEETS STA. 9+65 TO STA. 18+28

F.A.U. RTE.	SECTION	COUNTY	TOTAL SHEETS	SHEET NO.
	06-00162-02-SW	COOK	6	4
CONTRACT NO. 63119				
FED. ROAD DIST. NO. 1 ILLINOIS FED. AID PROJECT CMM-9003(079)				

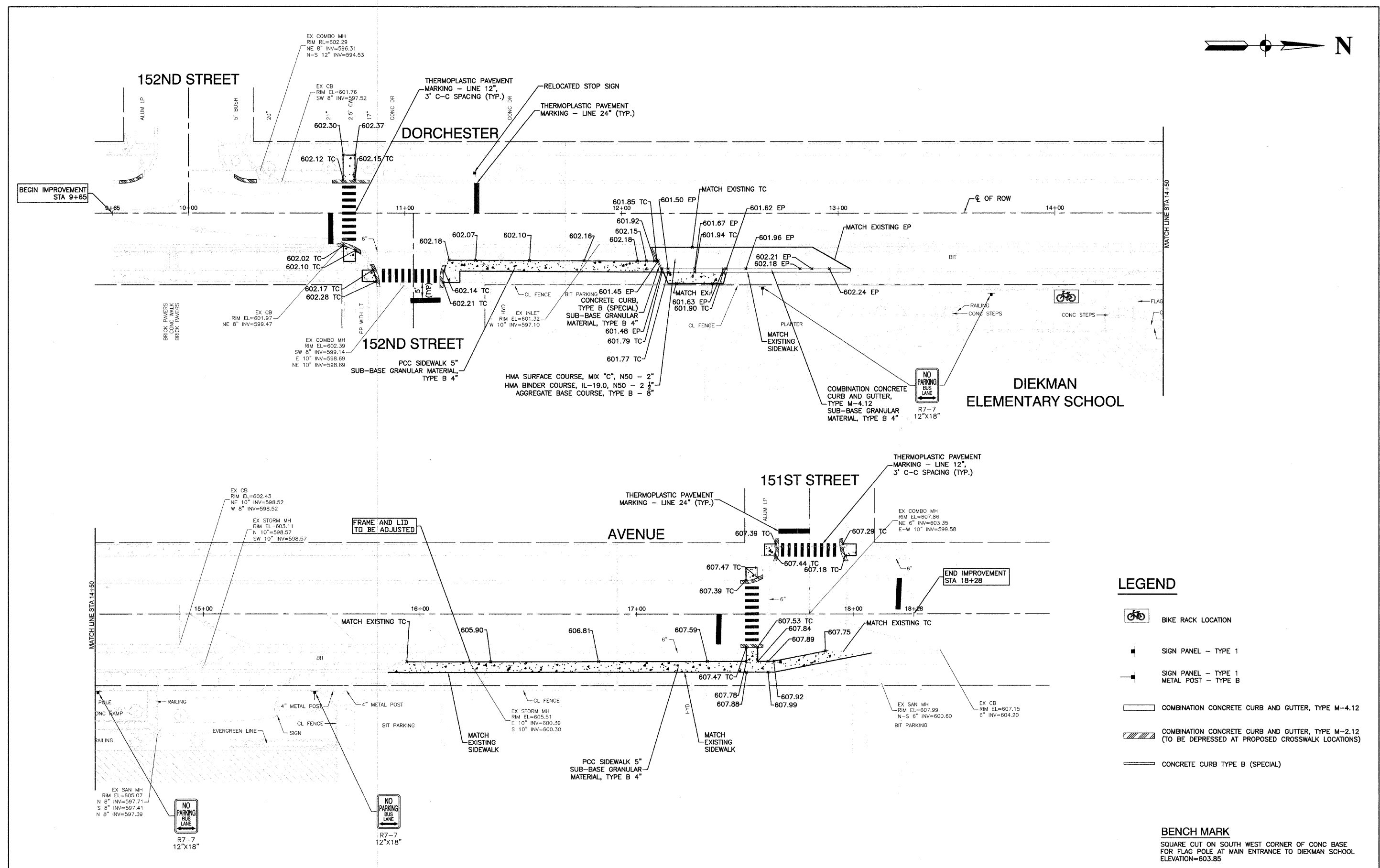
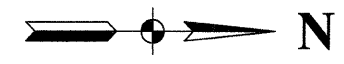

- LEGEND**
- BIKE RACK LOCATION
 - SIGN PANEL - TYPE 1
 - SIGN PANEL - TYPE 1 METAL POST - TYPE B
 - COMBINATION CONCRETE CURB AND GUTTER, TYPE M-4.12
 - COMBINATION CONCRETE CURB AND GUTTER, TYPE M-2.12 (TO BE DEPRESSED AT PROPOSED CROSSWALK LOCATIONS)
 - CONCRETE CURB TYPE B (SPECIAL)

BENCH MARK
 SQUARE CUT ON SOUTH WEST CORNER OF CONC BASE FOR FLAG POLE AT MAIN ENTRANCE TO DIEKMAN SCHOOL ELEVATION=603.85

FILE NAME = 05612_02-PLAN-01	USER NAME =	DESIGNED -- MPN	REVISED --	STATE OF ILLINOIS DEPARTMENT OF TRANSPORTATION	DORCHESTER AVENUE SIDEWALK CONSTRUCTION AND BUS LOADING ZONE EXTENSION PROPOSED SIDEWALK, PAVEMENT MARKING, AND BUS LANE PLAN			F.A.U. RTE.	SECTION	COUNTY	TOTAL SHEETS	SHEET NO.	
	PLOT SCALE =	CHECKED -- MPN	REVISED --		06-00162-02-SW	COOK	6	5					
	PLOT DATE = 12-23-08	DRAWN -- RG	REVISED --		SCALE: 1"=20'			SHEET NO. 5 OF 6 SHEETS		STA. 9+65 TO STA. 18+25		CONTRACT NO. 63119	
		CHECKED -- RG	REVISED --		FED. ROAD DIST. NO. 1		ILLINOIS		FED. AID PROJECT CMM-9003(079)				

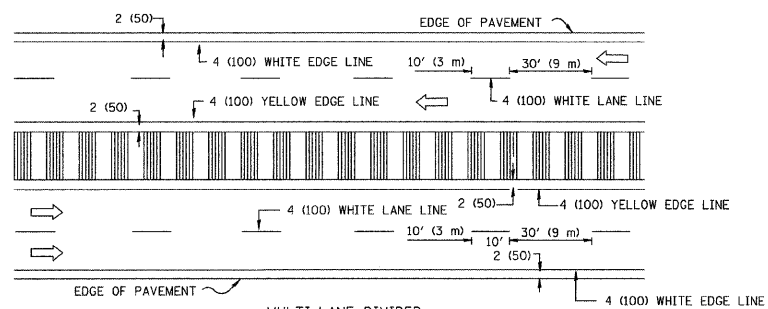
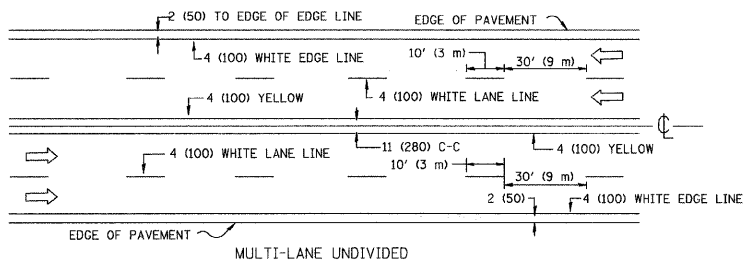
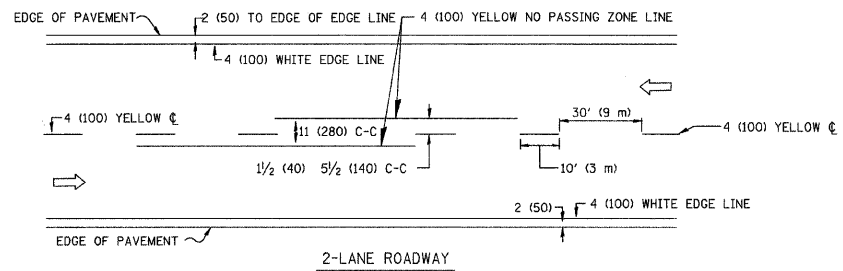

NOTE: MEDIANS WITH BARRIER CURB DO NOT REQUIRE AN EDGE LINE

TYPICAL LANE AND EDGE LINE MARKING

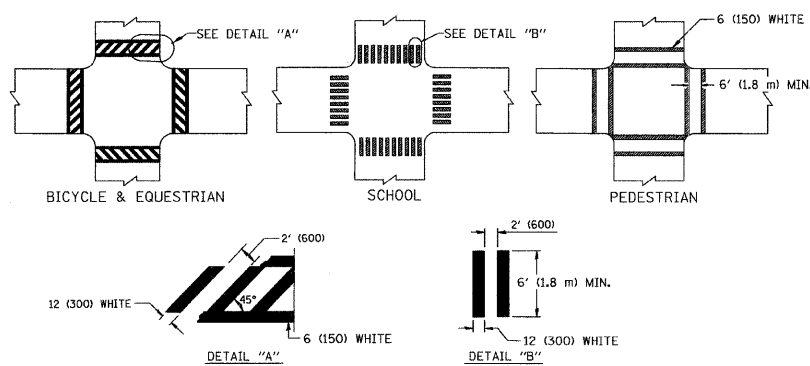

TYPICAL CROSSWALK MARKING

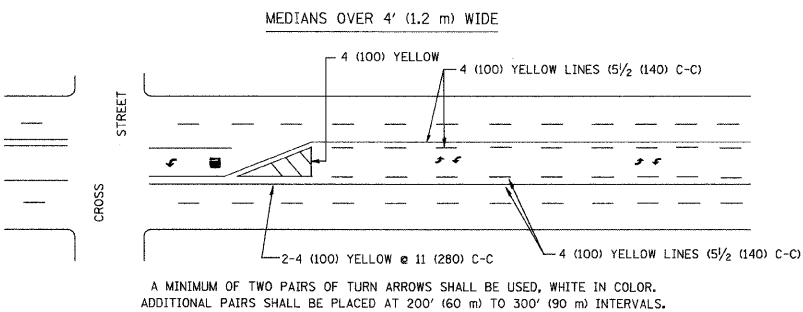
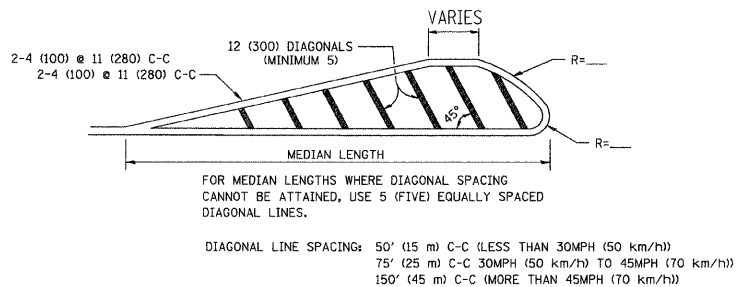
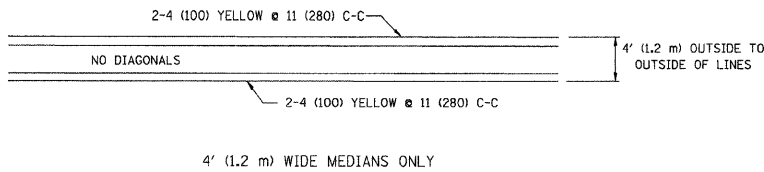

TYPICAL PAINTED MEDIAN MARKING

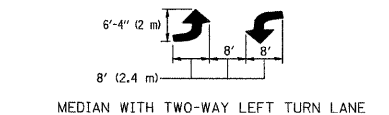

MEDIAN WITH TWO-WAY LEFT TURN LANE

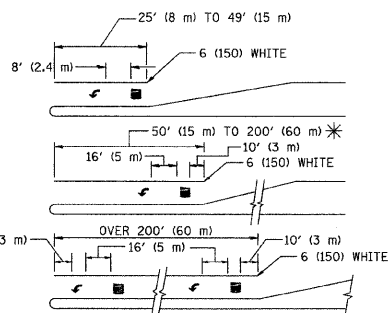

TYPICAL LEFT (OR RIGHT) TURN LANE

FULL SIZE LETTERS 8" (2.4 m) AND ARROWS SHALL BE USED.
 AREA = 15.6 SQ. FT. (1.5 m²) ONLY AREA = 20.8 SQ. FT. (1.9 m²)
 * TURN LANES IN EXCESS OF 400' (120 m) IN LENGTH MAY HAVE AN ADDITIONAL SET OF ARROW - "ONLY" INSTALLED MIDWAY BETWEEN THE OTHER TWO SETS OF ARROW - "ONLY".

TYPICAL TURN LANE MARKING

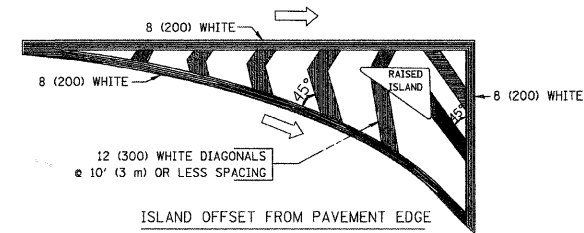

ISLAND OFFSET FROM PAVEMENT EDGE

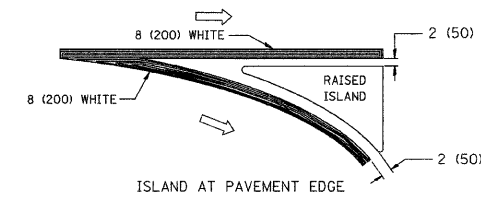

ISLAND AT PAVEMENT EDGE

TYPICAL ISLAND MARKING

TYPE OF MARKING	WIDTH OF LINE	PATTERN	COLOR	SPACING / REMARKS
CENTERLINE ON 2 LANE PAVEMENT	4 (100)	SKIP-DASH	YELLOW	10' (3 m) LINE WITH 30' (9 m) SPACE
CENTERLINE ON MULTI-LANE UNDIVIDED PAVEMENT	2 @ 4 (100)	SOLID	YELLOW	11 (280) C-C
NO PASSING ZONE LINES FOR ONE DIRECTION FOR BOTH DIRECTIONS	4 (100) 2 @ 4 (100)	SOLID SOLID	YELLOW YELLOW	5 1/2 (140) C-C FROM SKIP-DASH CENTERLINE 11 (280) C-C OMIT SKIP-DASH CENTERLINE BETWEEN
LANE LINES	4 (100) 5 (125) ON FREEWAYS	SKIP-DASH SKIP-DASH	WHITE WHITE	10' (3 m) LINE WITH 30' (9 m) SPACE
DOTTED LINES (EXTENSIONS OF CENTER, LANE OR TURN LANE MARKINGS)	SAME AS LINE BEING EXTENDED	SKIP-DASH	SAME AS LINE BEING EXTENDED	2' (600) LINE WITH 6' (1.8 m) SPACE
EDGE LINES	4 (100)	SOLID	YELLOW-LEFT WHITE-RIGHT	OUTLINE MOUNTABLE MEDIANS IN YELLOW; EDGE LINES ARE NOT USED NEXT TO BARRIER CURB
TURN LANE MARKINGS	6 (150) LINE; FULL SIZE LETTERS & SYMBOLS (8' (2.4m))	SOLID	WHITE	SEE TYPICAL TURN LANE MARKING DETAIL
TWO WAY LEFT TURN MARKING	2 @ 4 (100) EACH DIRECTION 8' (2.4m) LEFT ARROW	SKIP-DASH AND SOLID IN PAIRS	YELLOW WHITE	10' (3 m) LINE WITH 30' (9 m) SPACE FOR SKIP-DASH; 5 1/2 (140) C-C BETWEEN SOLID LINE AND SKIP-DASH LINE SEE TYPICAL TWO-WAY LEFT TURN MARKING DETAIL
CROSSWALK LINES (PEDESTRIAN) A. DIAGONALS (BIKE & EQUESTRIAN) B. LONGITUDINAL BARS (SCHOOL)	2 @ 6 (150) 12 (300) @ 45° 12 (300) @ 90°	SOLID SOLID SOLID	WHITE WHITE WHITE	NOT LESS THAN 6' (1.8 m) APART 2' (600) APART SEE TYPICAL CROSSWALK MARKING DETAILS.
STOP LINES	24 (600)	SOLID	WHITE	PLACE 4' (1.2 m) IN ADVANCE OF AND PARALLEL TO CROSSWALK, IF PRESENT. OTHERWISE, PLACE AT DESIRED STOPPING POINT, PARALLEL TO CROSSROAD CENTERLINE, WHERE POSSIBLE
PAINTED MEDIANS	2 @ 4 (100) WITH 12 (300) DIAGONALS @ 45° NO DIAGONALS USED FOR 4' (1.2 m) WIDE MEDIANS	SOLID	YELLOW; TWO WAY TRAFFIC WHITE; ONE WAY TRAFFIC	11 (280) C-C FOR THE DOUBLE LINE SEE TYPICAL PAINTED MEDIAN MARKING.
GORE MARKING AND CHANNELIZING LINES	8 (200) WITH 12 (300) DIAGONALS @ 45°	SOLID	WHITE	DIAGONALS: 15' (4.5 m) C-C (LESS THAN 30MPH (50 km/h)) 20' (6 m) C-C (30MPH (50 km/h) TO 45MPH (70 km/h)) 30' (9 m) C-C (OVER 45MPH (70 km/h))
RAILROAD CROSSING	24 (600) TRANSVERSE LINES; "RR" IS 5' (1.8 m) LETTERS; 16 (400) LINE FOR "X"	SOLID	WHITE	SEE STATE STANDARD 780001 AREA OF: "R"=3.6 SQ. FT. (0.33 m ²) EACH "X"=54.0 SQ. FT. (5.0 m ²)
SHOULDER DIAGONALS	12 (300) @ 45°	SOLID	WHITE - RIGHT YELLOW - LEFT	50' (15 m) C-C (LESS THAN 30MPH (50 km/h)) 75' (25 m) C-C (30 MPH (50 km/h) TO 45MPH (70 km/h)) 150' (45 m) C-C (OVER 45MPH (70 km/h))

FOR FURTHER DETAILS ON PAVEMENT MARKING REFER TO STANDARD SPECIFICATIONS FOR ROAD AND BRIDGE CONSTRUCTION AND STATE STANDARD 780001.

All dimensions are in inches (millimeters) unless otherwise shown.

FILE NAME = W:\data\td\22x34\td13.dgn	USER NAME = goglianobt	DESIGNED - EVERS	REVISED -T. RAMMACHER 10-27-94	STATE OF ILLINOIS DEPARTMENT OF TRANSPORTATION	DORCHESTER AVENUE SIDEWALK CONSTRUCTION AND BUS LOADING ZONE EXTENSION DISTRICT 1 TYPICAL PAVEMENT MARKINGS			F.A.U. RITE. 1	SECTION 06-00162-02-SW	COUNTY COOK	TOTAL SHEETS 6	SHEET NO. 6
05612_02-DTL5-01 - TC-13	PLOT SCALE = 50,000 / IN.	CHECKED -	REVISED -A. HOUSEH 10-09-96		SCALE: NONE	SHEET NO. 6	OF 6 SHEETS	STA. TO STA.	TC-13		CONTRACT NO. 63119	
	PLOT DATE = 1/4/2008	DATE - 03-19-90	REVISED -A. HOUSEH 10-17-96		FED. ROAD DIST. NO. 1	ILLINOIS	FED. AID PROJECT	CMM-9003(079)				
			REVISED -T. RAMMACHER 01-06-00									