

**ACKMAN ROAD (LOCATION 1)**

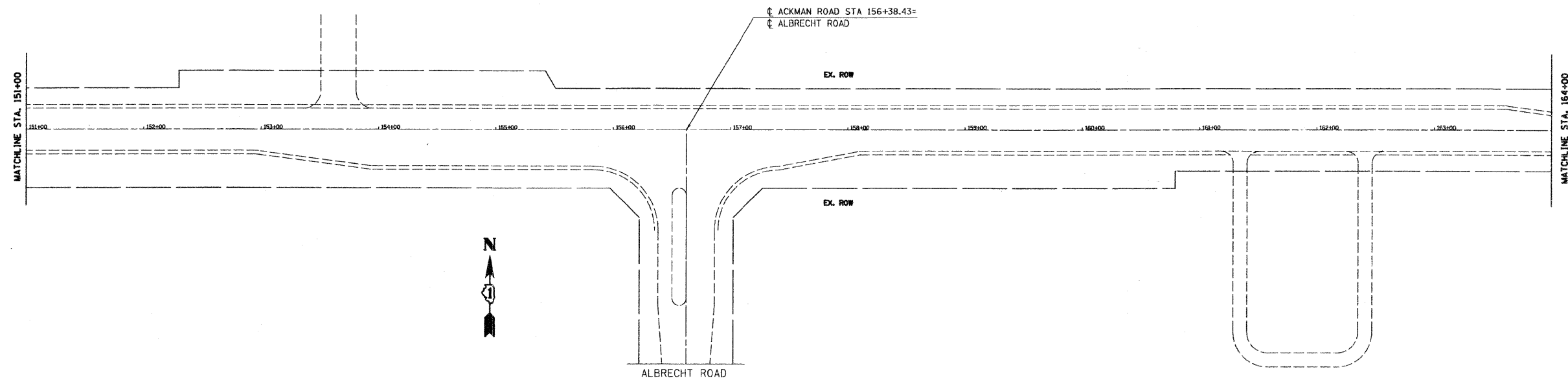

**ACKMAN ROAD (LOCATION 1)**

NOTES:

- 1) FOR PAVEMENT MARKING DETAILS, FOLLOW DISTRICT 1 STANDARD TC-13 "DISTRICT ONE TYPICAL PAVEMENT MARKINGS", WHERE APPLICABLE.
- 2) RECESSED REFLECTIVE PAVEMENT MARKERS SHALL FOLLOW STANDARD 781001-03 TYPICAL APPLICATIONS RAISED REFLECTIVE PAVEMENT MARKERS. SEE "RECESSED PAVEMENT MARKER DETAIL" FOR INSTALLATION.

\*FAU 3873 (ACKMAN ROAD) AND FAU 4066 (MAIN STREET)

FILE NAME = #FILE#	USER NAME = #USER*	DESIGNED -	REVISED -	<b>McHENRY COUNTY DIVISION OF TRANSPORTATION</b>	<b>ACKMAN ROAD (LOCATION 1)</b>	SCALE: 1"=50'	SHEET NO. OF SHEETS STA. TO STA.	F.A. RTE.	SECTION	COUNTY	TOTAL SHEETS	SHEET NO.
	PLOT SCALE = #SCALE*	CHECKED -	REVISED -					*	09-00360-00-RS	McHENRY	19	6
PLOT DATE = #DATE*	DATE -	REVISED -	REVISED -	<b>ACKMAN ROAD AND MAIN STREET</b>	<b>PROPOSED PLAN</b>			<b>CONTRACT NO. 63130</b>		FED. ROAD DIST. NO. ILLINOIS FED. AID PROJECT		