

NOTES:

1. COMBINATION CONCRETE CURB AND GUTTER REMOVAL TO BE DETERMINED BY THE RESIDENT ENGINEER IN THE FIELD.
2. PAVEMENT PATCHING LIMITS TO BE DETERMINED BY THE RESIDENT ENGINEER IN THE FIELD.
3. THE EXACT THERMOPLASTIC PAVEMENT MARKING LOCATIONS WILL BE DETERMINED IN THE FIELD BY THE ENGINEER. ALL THERMOPLASTIC PAVEMENT MARKINGS MUST FOLLOW THE IDOT DETAIL AND HIGHWAY STANDARDS. THE THERMOPLASTIC PAVEMENT MARKINGS WILL BE REPLACED INKIND.

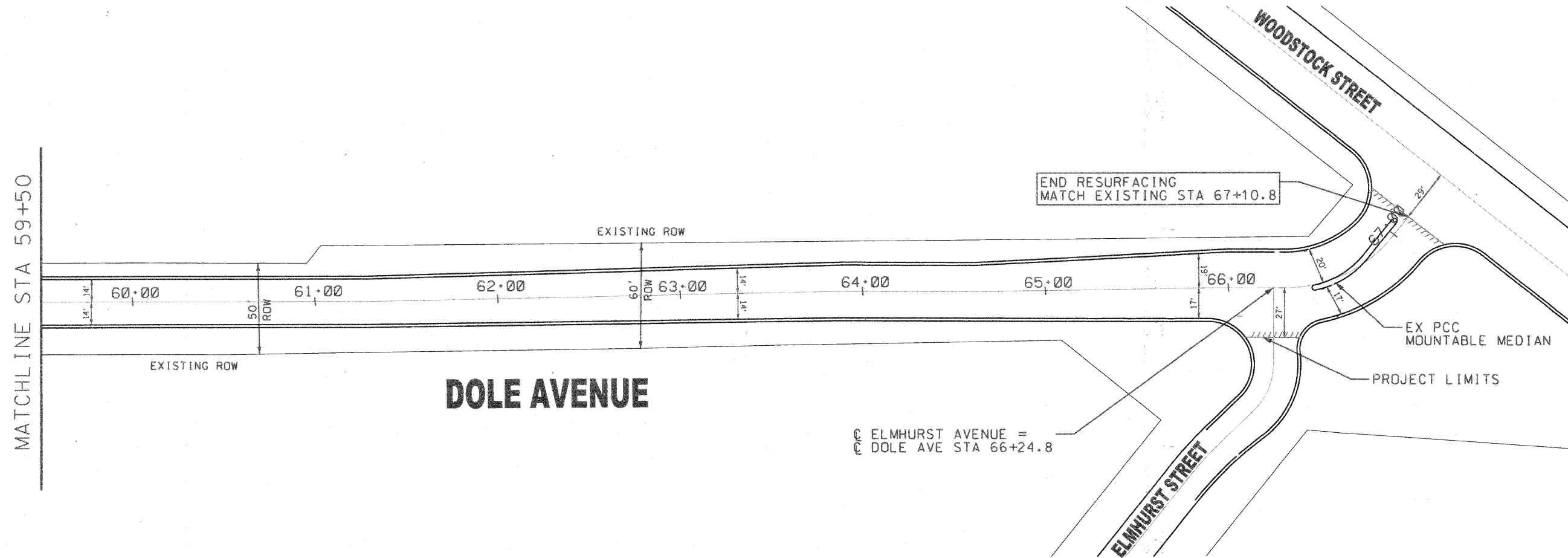
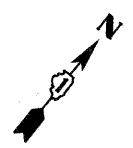

FILE NAME = DOLE_SHEETS.DGN	DESIGNED	SCC	REVISED	2-25-2009	STATE OF ILLINOIS DEPARTMENT OF TRANSPORTATION	City of Crystal Lake, Illinois STP (LAPP) IMPROVEMENTS	Location No. 1: DOLE AVENUE	F.A. RTE.	SECTION	COUNTY	TOTAL SHEETS	SHEET NO.
	DRAWN	JAM	REVISED					4057	08-00110-00-RS	MCHENRY	43	20
	PLOT SCALE = 60 (plot to 11x17)	CHECKED	EDM	REVISED								
	PLOT DATE = 11-26-08	DATE	11-26-2008	REVISED		SCALE: 1"=30'	SHEET NO. 8 OF 8 SHEETS	STA. 59+50 TO STA. 67+10.8	FED. ROAD DIST. NO. 1 ILLINOIS FED. AID PROJECT			
											CONTRACT NO.	63139