

NOTES:

1. COMBINATION CONCRETE CURB AND GUTTER REMOVAL TO BE DETERMINED BY THE RESIDENT ENGINEER IN THE FIELD.
2. PAVEMENT PATCHING LIMITS TO BE DETERMINED BY THE RESIDENT ENGINEER IN THE FIELD.
3. THE EXACT THERMOPLASTIC PAVEMENT MARKING LOCATIONS WILL BE DETERMINED IN THE FIELD BY THE ENGINEER. ALL THERMOPLASTIC PAVEMENT MARKINGS MUST FOLLOW THE IDOT DETAIL AND HIGHWAY STANDARDS. THE THERMOPLASTIC PAVEMENT MARKINGS WILL BE REPLACED INKIND.

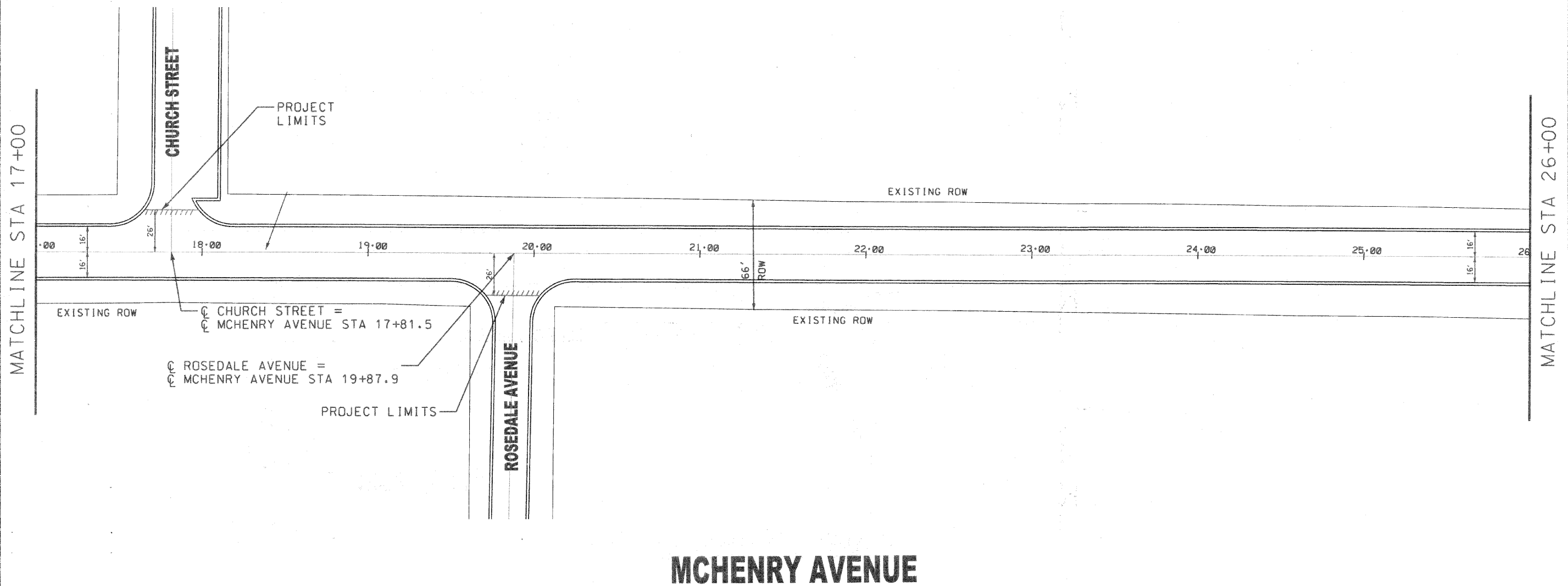
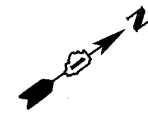

FILE NAME = MCHENRY_SHEETS.DGN	DESIGNED	SCC	REVISED	2-25-2009	STATE OF ILLINOIS DEPARTMENT OF TRANSPORTATION	City of Crystal Lake, Illinois STP (LAPP) IMPROVEMENTS	Location No. 2: MCHENRY AVENUE	F.A. RTE.	SECTION	COUNTY	TOTAL SHEETS	SHEET NO.
	DRAWN	JAM	REVISED					120	08-00110-00-RS	MCHENRY	43	23
	CHECKED	EDM	REVISED					CONTRACT NO. 63139				
	PLOT SCALE = 60 (plot to 11x17)	DATE	11-26-2008	REVISED				SCALE: 1"=30'	SHEET NO. 3 OF 5 SHEETS	STA. 17+00 TO STA. 26+00	FED. ROAD DIST. NO. 1 (ILLINOIS) FED. AID PROJECT	