

NOTES:

1. COMBINATION CONCRETE CURB AND GUTTER REMOVAL TO BE DETERMINED BY THE RESIDENT ENGINEER IN THE FIELD.
2. PAVEMENT PATCHING LIMITS TO BE DETERMINED BY THE RESIDENT ENGINEER IN THE FIELD.
3. THE EXACT THERMOPLASTIC PAVEMENT MARKING LOCATIONS WILL BE DETERMINED IN THE FIELD BY THE ENGINEER. ALL THERMOPLASTIC PAVEMENT MARKINGS MUST FOLLOW THE IDOT DETAIL AND HIGHWAY STANDARDS. THE THERMOPLASTIC PAVEMENT MARKINGS WILL BE REPLACED INKIND.

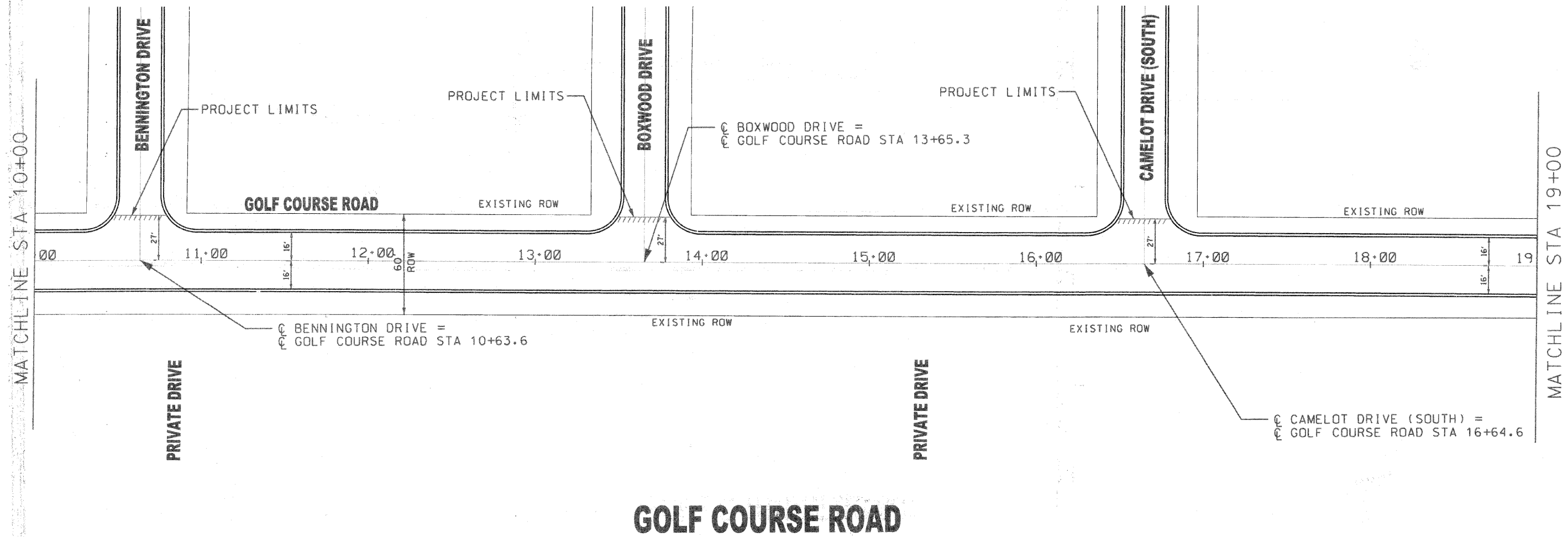

FILE NAME = GOLF COURSE_SHEET2.DGN	DESIGNED <i>SCC</i>	REVISED <i>2-25-2009</i>	<b>STATE OF ILLINOIS DEPARTMENT OF TRANSPORTATION</b>	<b>City of Crystal Lake, Illinois STP (LAPP) IMPROVEMENTS</b>	<b>Location No. 3: GOLF COURSE ROAD</b>	F.A. RTE. 3872	SECTION 08-00110-00-RS	COUNTY MCHENRY	TOTAL SHEETS 43	SHEET NO. 34
	PLOT SCALE = 60 (plot to 11x17)	DRAWN <i>JAM</i>				REVISED	CONTRACT NO. 63139			
	PLOT DATE = 11-26-08	CHECKED <i>EDM</i>				REVISED	FED. ROAD DIST. NO. 1 ILLINOIS FED. AID PROJECT			
	DATE <i>11-26-2008</i>	DATE <i>11-26-2008</i>				REVISED	SCALE: 1"=30' SHEET NO. 2 OF 3 SHEETS STA. 10+00 TO STA. 19+00			