

DATE: \_\_\_\_\_ BY: \_\_\_\_\_  
 SURVEYED: \_\_\_\_\_ PLOTTED: \_\_\_\_\_  
 CHECKED: \_\_\_\_\_ REVISIONS: \_\_\_\_\_  
 NOTE BOOK NO. \_\_\_\_\_ FILE NAME: \_\_\_\_\_

DATE: \_\_\_\_\_ BY: \_\_\_\_\_  
 SURVEYED: \_\_\_\_\_ PLOTTED: \_\_\_\_\_  
 CHECKED: \_\_\_\_\_ REVISIONS: \_\_\_\_\_  
 NOTE BOOK NO. \_\_\_\_\_ FILE NAME: \_\_\_\_\_

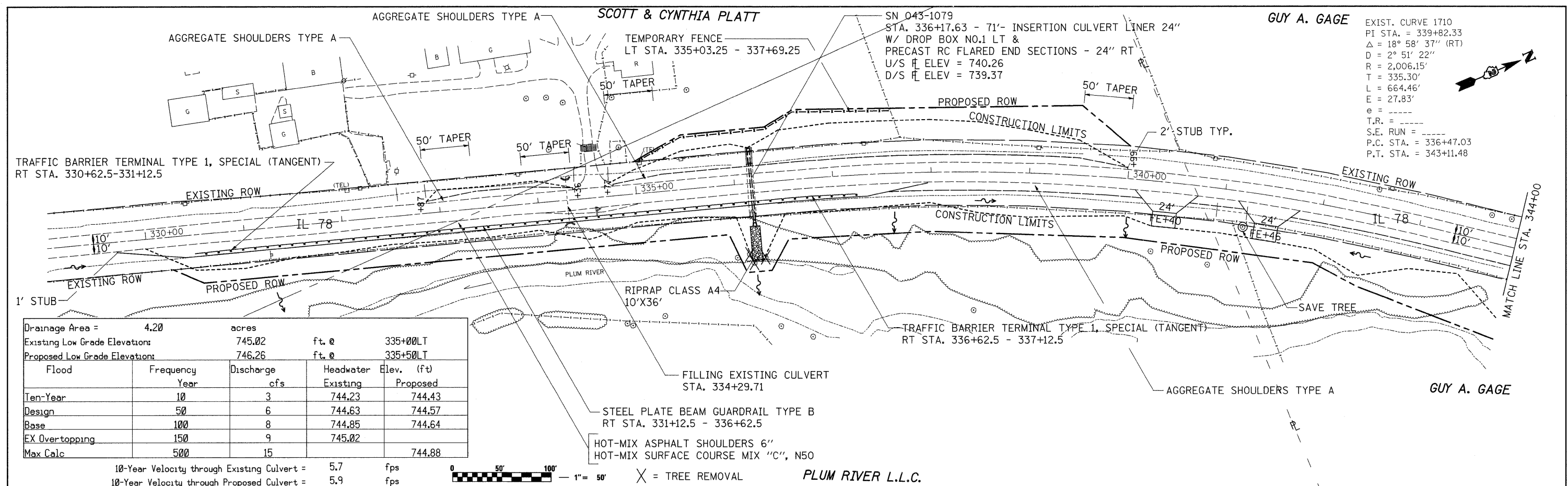

Drainage Area = 4.20 acres

Existing Low Grade Elevations:	745.02	ft. @	335+00LT
Proposed Low Grade Elevations:	746.26	ft. @	335+50LT
Flood	Frequency	Discharge	Headwater Elev. (ft)
	Year	cfs	Existing Proposed
Ten-Year	10	3	744.23 744.43
Design	50	6	744.63 744.57
Base	100	8	744.85 744.64
EX Overtopping	150	9	745.02
Max Calc	500	15	744.88

10-Year Velocity through Existing Culvert = 5.7 fps  
 10-Year Velocity through Proposed Culvert = 5.9 fps

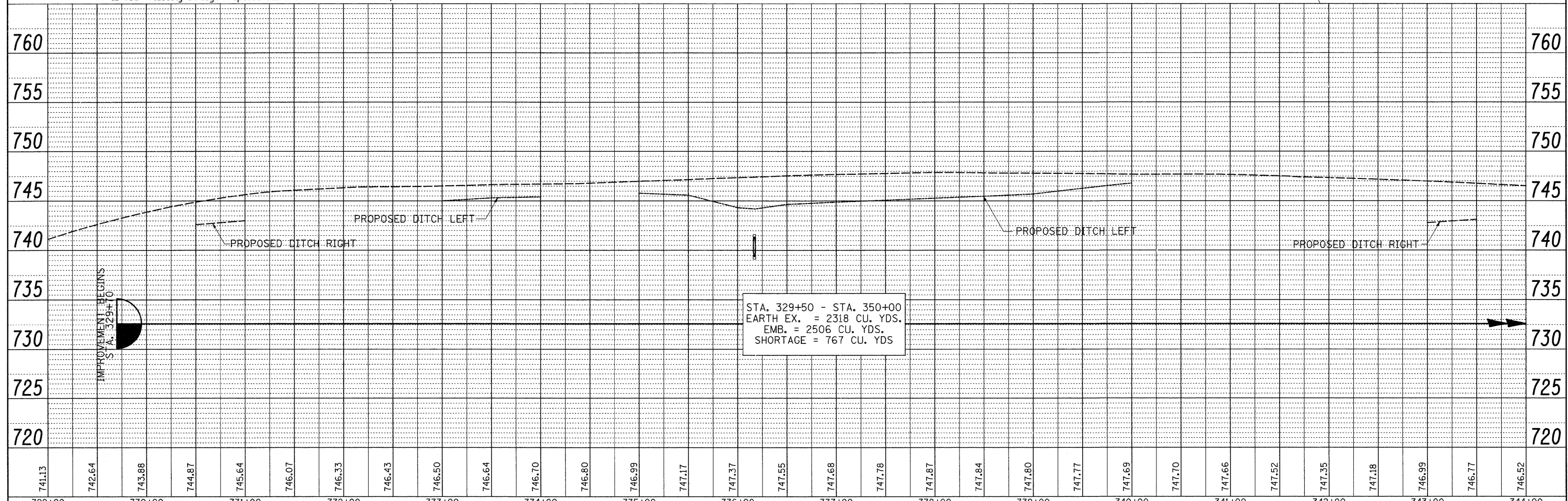

FILE NAME =	USER NAME = hansonke	DESIGNED -	REVISED -	STATE OF ILLINOIS DEPARTMENT OF TRANSPORTATION	IL 78 PLAN & PROFILE	F.A.P. RTE.	SECTION	COUNTY	TOTAL SHEETS	SHEET NO.
03:\pwork\p\WID01\HENSONKE\dms33697\0804707.plndgn		DRAWN -	REVISED -			642	(10-11)T	JODAVIESS	283	50
PLOT SCALE = 50.0000' / IN.		CHECKED -	REVISED -			CONTRACT NO. 64D07				
PLOT DATE = Tue Sep 30 14:08:24 2008		DATE -	REVISED -			FED. ROAD DIST. NO. [ILLINOIS] FED. AID PROJECT				

SCALE: 1/50 SHEET NO. OF SHEETS STA. TO STA.