

KENNETH B. & DEBRA L. ANDERSEN

BRADLEY J. & LEESA S. HATFIELD

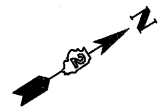

DATE	
BY	
PLAN	
NO.	
DATE	
BY	
PROFILE	
NO.	

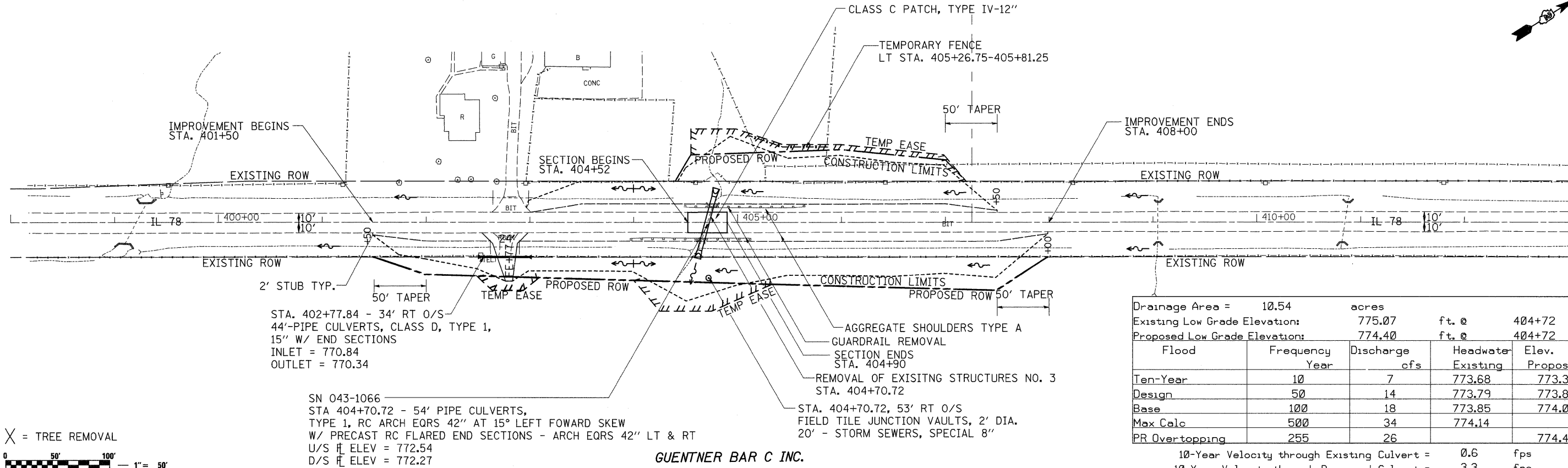

Drainage Area =	10.54	acres		
Existing Low Grade Elevation:	775.07	ft. @	404+72	
Proposed Low Grade Elevation:	774.40	ft. @	404+72	
Flood	Frequency Year	Discharge cfs	Headwater Existing	Elev. (ft) Proposed
Ten-Year	10	7	773.68	773.38
Design	50	14	773.79	773.80
Base	100	18	773.85	774.03
Max Calc	500	34	774.14	
PR Overtopping	255	26		774.40

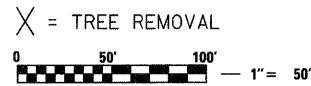

DATE	
BY	
PROFILE	
NO.	
DATE	
BY	
PROFILE	
NO.	

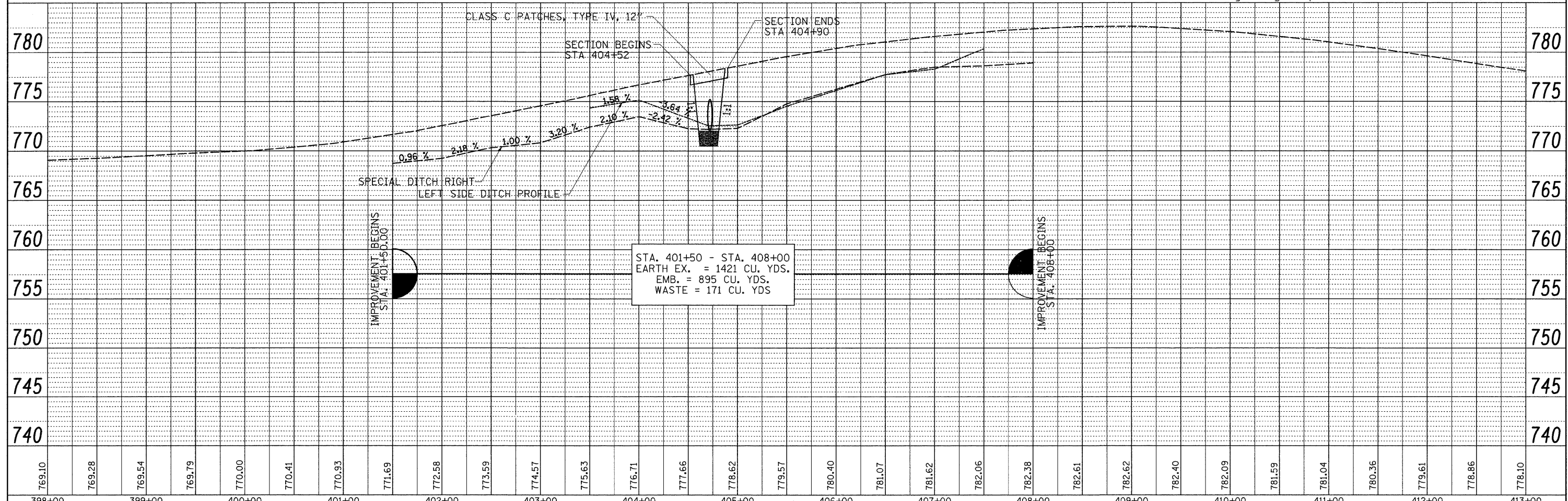

FILE NAME =	USER NAME = henssonke	DESIGNED -	REVISED -	<b>STATE OF ILLINOIS DEPARTMENT OF TRANSPORTATION</b>	<b>IL 78 PLAN &amp; PROFILE</b>	F.A.P. RTE.	SECTION	COUNTY	TOTAL SHEETS	SHEET NO.	
ca:\pw_wor\k\PWIDOT\HENSONKE\dms33697\04707pln.dgn	7/1/07	DRAWN -	REVISED -			642	(10-11)T	JODAVIESS	283	52	
PLOT SCALE = 50.0000' / IN.		CHECKED -	REVISED -			CONTRACT NO. 64D07		FED. ROAD DIST. NO. ILLINOIS FED. AID PROJECT			
PLOT DATE = Tue Sep 30 14:08:28 2008		DATE -	REVISED -			SCALE: 1:50	SHEET NO. OF SHEETS	STA. TO STA.			