

WILLIAM V. &
JANICE L. KEHL

JAMES E. & KATHY S.
WILLIAMS

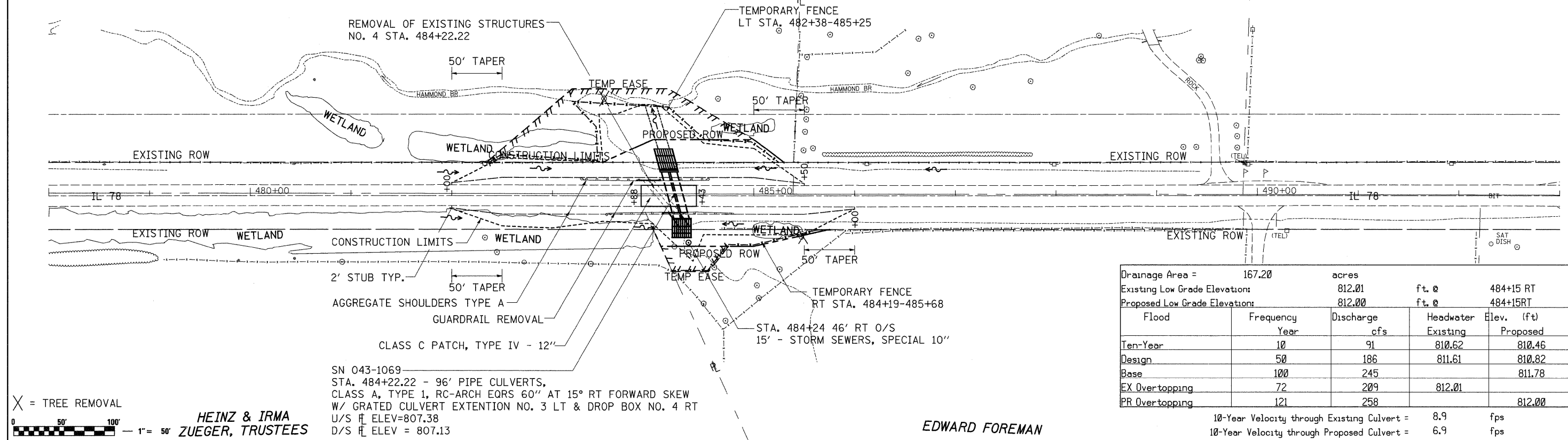

DATE	
BY	
SURVEYED	
PLOTTED	
CHECKED	
BY	
DATE	
NOTE BOOK NO.	
CADD FILE NAME	



Drainage Area =	167.20	acres		
Existing Low Grade Elevation:	812.01	ft. @	484+15 RT	
Proposed Low Grade Elevation:	812.00	ft. @	484+15RT	
Flood	Frequency	Discharge	Headwater	Elev. (ft)
	Year	cfs	Existing	Proposed
Ten-Year	10	91	810.62	810.46
Design	50	186	811.61	810.82
Base	100	245		811.78
EX Overtopping	72	209	812.01	
PR Overtopping	121	258		812.00

SN 043-1069
STA. 484+22.22 - 96' PIPE CULVERTS,
CLASS A, TYPE 1, RC-ARCH EQRS 60" AT 15° RT FORWARD SKEW
W/ GRATED CULVERT EXTENTION NO. 3 LT & DROP BOX NO. 4 RT
U/S ELEV=807.38
D/S ELEV = 807.13

X = TREE REMOVAL

HEINZ & IRMA
ZUEGER, TRUSTEES

EDWARD FOREMAN

10-Year Velocity through Existing Culvert = 8.9 fps
10-Year Velocity through Proposed Culvert = 6.9 fps

DATE	
BY	
SURVEYED	
PLOTTED	
CHECKED	
BY	
DATE	
NOTE BOOK NO.	
STRUCTURE NOTATIONS CHRD	

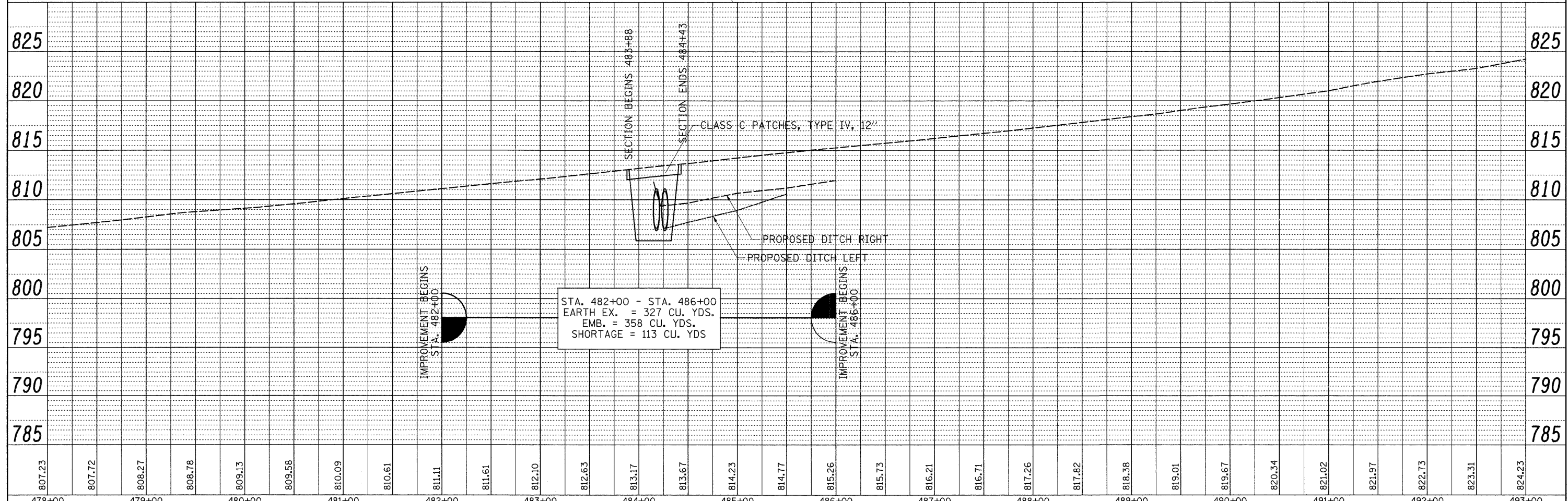

FILE NAME =	USER NAME = hensonike	DESIGNED -	REVISED -	STATE OF ILLINOIS DEPARTMENT OF TRANSPORTATION	IL 78 PLAN & PROFILE	F.A.P. RTE.	SECTION	COUNTY	TOTAL SHEETS	SHEET NO.	
ca:\pwwork\p\WIDOT\HENSON\KE\dms33697\047777.plt	17.plt	DRAWN -	REVISED -			642	(10-11)T	JODAVIESS	283	55	
PLOT SCALE = 50.0000' / IN.		CHECKED -	REVISED -			CONTRACT NO. 64D07					
PLOT DATE = Tue Sep 30 14:08:33 2008		DATE -	REVISED -			FED. ROAD DIST. NO. ILLINOIS FED. AID PROJECT					

SCALE: 1:50 SHEET NO. OF SHEETS STA. TO STA.