

DATE	
BY	
FINAL SURVEY	
REVISION	
NOTE BOOK	
NO.	
AREAS CHECKED	

DATE	
BY	
ORIGINAL SURVEY	
REVISION	
NOTE BOOK	
NO.	
AREAS CHECKED	

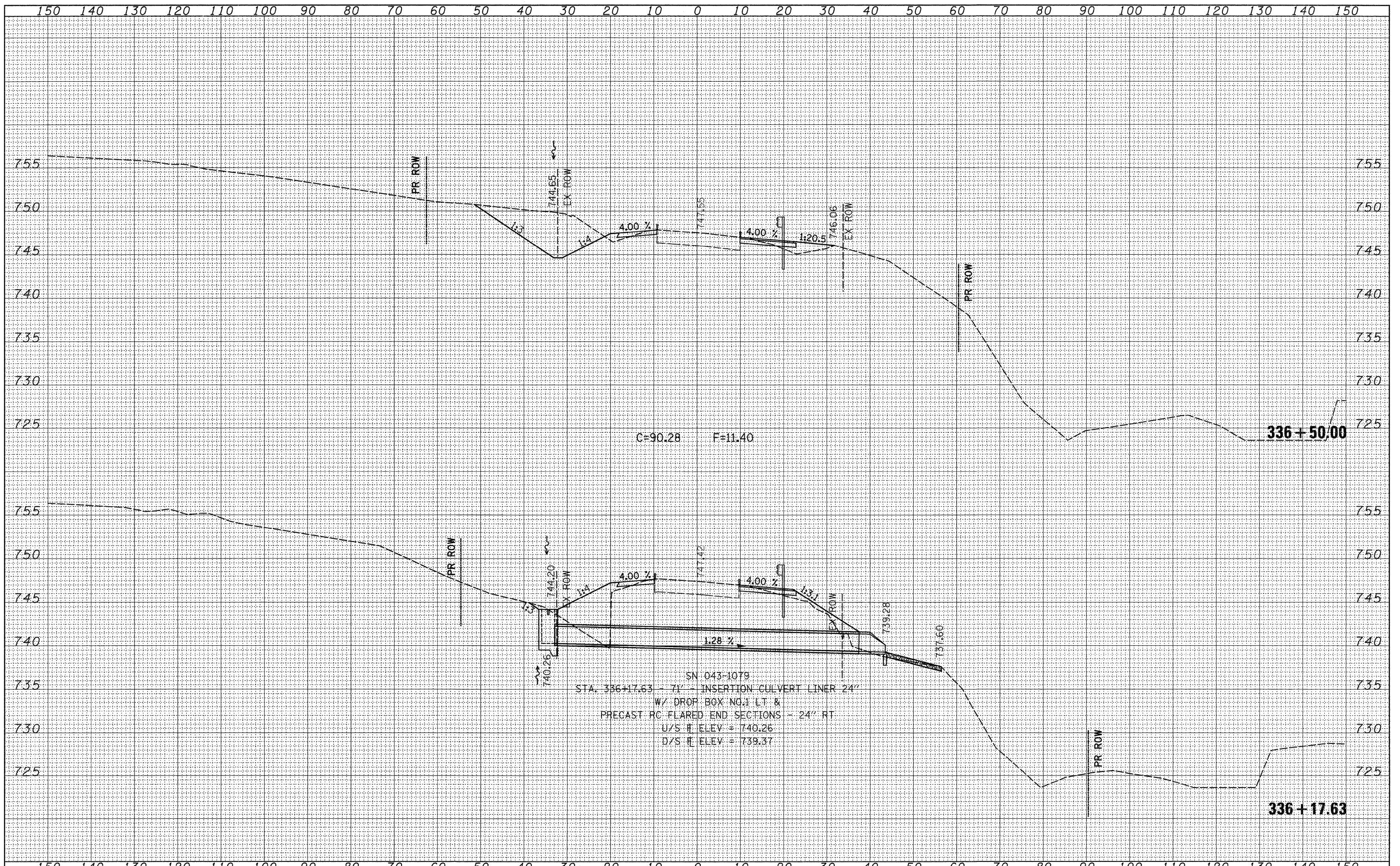

C=90.28 F=11.40

336+50.00

SN 043-1079
 STA. 336+17.63 - 71' - INSERTION CULVERT LINER 24"
 W/ DROP BOX NO. 1 LT &
 PRECAST RC FLARED END SECTIONS - 24" RT
 U/S ELEV = 740.26
 D/S ELEV = 739.37

336+17.63

FILE NAME =	USER NAME = hensanke	DESIGNED -	REVISED -	STATE OF ILLINOIS DEPARTMENT OF TRANSPORTATION	IL 78 CROSS SECTIONS			F.A.P. RTE.	SECTION	COUNTY	TOTAL SHEETS	SHEET NO.
at:\p\work\PWID01\HENSONKE\dms33699\d04787\sc5.dgn		DRAWN -	REVISED -					642	(10,11)T	JO DAVIESS	283	207
PLOT SCALE = 10,0000' / IN.		CHECKED -	REVISED -					CONTRACT NO. 64D07				
PLOT DATE = Tue Sep 30 11:51:23 2008		DATE -	REVISED -					FED. ROAD DIST. NO. ILLINOIS FED. AID PROJECT				
				SCALE:	SHEET NO.	OF	SHEETS	STA. 336+17.63	TO STA. 336+50.00			