

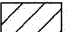



**LEGEND**

-  WORK AREA
-  SIGN
-  TYPE III BARRICADE
-  TYPE II BARRICADE OR DRUM
-  VERTICAL PANEL
-  IMPACT ATTENUATOR

**STAGE 1**

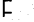
1. ERECT BARRICADES, SIGNS AND PLACE TEMPORARY PAINT MARKINGS AS SHOWN ON THE STAGE 1 DRAWINGS, STATE STANDARDS AND AS DIRECTED BY THE ENGINEER.
2. CONSTRUCT THE HOT-MIX ASPHALT SHOULDER AND PAVEMENT WIDENING ALONG US 20 FROM STA. 575+62 LT. TO STA. 596+83 LT USING HIGHWAY STANDARDS 701326 AND 701006.
3. CONSTRUCT IL 84 PAVEMENT FROM STA. 1374+70 TO STA. 1376+10.
4. REMOVE 66" CMP AT STA 580+77 AND REPLACE WITH 36" PIPE CULVERT USING STANDARD 701201.

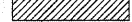
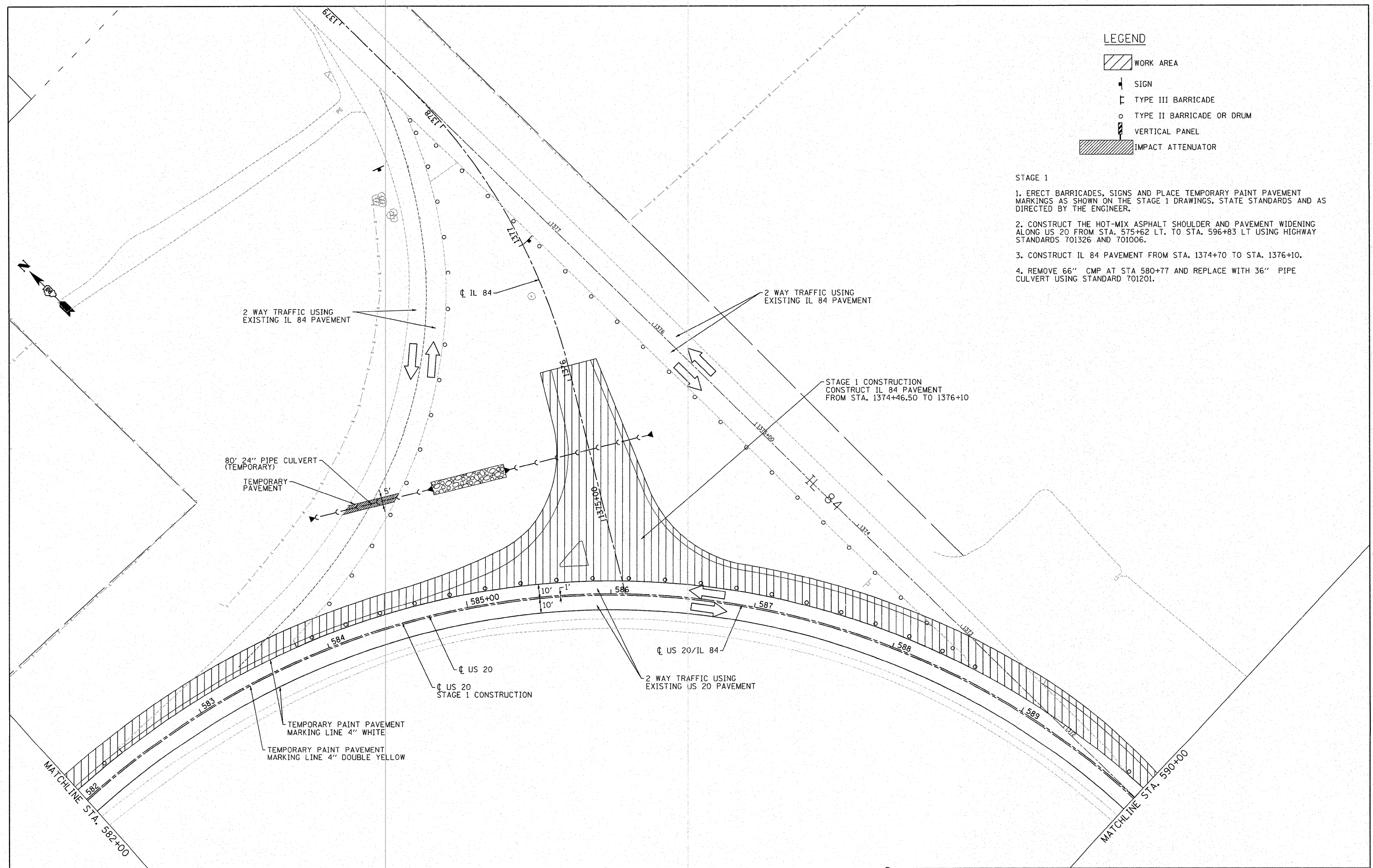

FILE NAME =	USER NAME = IDOTCAD	DESIGNED - SPF	REVISED -	<b>STATE OF ILLINOIS DEPARTMENT OF TRANSPORTATION</b>	<b>TRAFFIC STAGING PLANS STAGE 1 - US 20</b>	F.A.P. RTE.	SECTION	COUNTY	TOTAL SHEETS	SHEET NO.	
W:\2248-03 - US 20 IL 84 Intersection\CAD Sheets\0206108-sht-staging1.dgn	DRAWN - AJP	REVISED -	REVISED -			301	30-M-2	JoDAVISS	81	26	
PLOT SCALE = 30.0000' / IN.	CHECKED - JMS	REVISED -	REVISED -			CONTRACT NO. 64E29					
PLOT DATE = 1/22/2009	DATE - 01/23/09	REVISED -	REVISED -			FED. ROAD DIST. NO. ILLINOIS FED. AID PROJECT					
SCALE: 1"=30'						SHEET NO. 03 OF 04 SHEETS		STA.		TO STA.	