

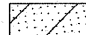





LEGEND

-  SEEDING, CLASS 2A
-  SEEDING, CLASS 4
-  TEMPORARY SEEDING
-  EROSION CONTROL BARRIER
-  INLET PIPE PROTECTION
-  TEMPORARY DITCH CHECK
-  CULVERT
-  TURF REINFORCEMENT MAT
-  RIP RAP

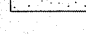

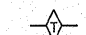
ROW

1399+00 | 1385+00 | IL-84 | 1380+00

MATCHLINE STA. 1379+00



ROW

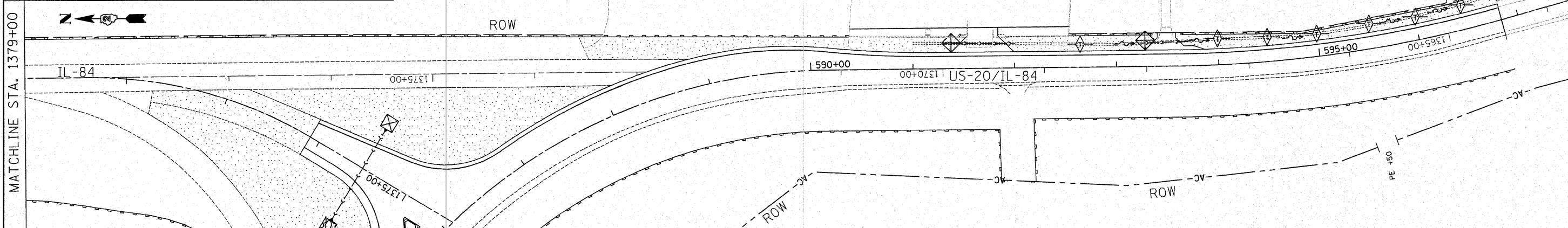

MATCHLINE STA. 1379+00

STA. 1375+50
80' PIPE CULVERT, CLASS D,
TYPE 1-24" (TEMPORARY)
U/S ELEV.= 878.30, 110' LT
D/S ELEV.= 877.50, 190' LT

STONE RIP RAP
CLASS A4



1575+00

1580+00

US-20

MATCHLINE STA. 1582+00

MATCHLINE STA. 582+00

FILE NAME =	USER NAME = IDOTCAD	DESIGNED - SPF	REVISED -
W:\2298-03 - US 20 IL 84 Intersection\CAD Sheets\208108-sht-eros.dgn		DRAWN - AJP	REVISED -
PLOT SCALE = 50.0000' / IN.		CHECKED - JMS	REVISED -
PLOT DATE = 1/22/2009		DATE - 01/23/09	REVISED -

**STATE OF ILLINOIS
DEPARTMENT OF TRANSPORTATION**

STAGE 1 EROSION CONTROL PLAN

SCALE: 1"=50' SHEET NO. 01 OF 02 SHEETS STA. TO STA.

F.A.P. RTE.	SECTION	COUNTY	TOTAL SHEETS	SHEET NO.
301	30-M-2	JoDAVISS	81	37
CONTRACT NO. 64E29				
FED. ROAD DIST. NO. ILLINOIS FED. AID PROJECT				