

F.A.P. RTE.	SECTION	COUNTY	TOTAL SHEETS	SHEET NO.
561	(32-4)M-2	WHITESIDE	34	1
FED. ROAD DIST. NO.	ILLINOIS	CONTRACT NO. 64E58		

STATE OF ILLINOIS
DEPARTMENT OF TRANSPORTATION
DIVISION OF HIGHWAYS
**PROPOSED
HIGHWAY PLANS**

FAP ROUTE 561 (IL 2)
SECTION (32-4)M-2
PROJECT HSIP-0561(028)
WHITESIDE COUNTY

C-92-044-09

D-92-001-09



LOCATION OF SECTION INDICATED THUS: - [thick black line] -

INDEX

- 1 COVER SHEET
- 2-4 SUMMARY OF QUANTITIES
- 5-6 GENERAL NOTES
- 7 TYPICAL SECTIONS
- 8-9 SCHEDULE OF QUANTITIES
- 10 BITUMINOUS SCHEDULE
- 11-12 HORIZONTAL & VERTICAL CONTROL
- 13-16 PLAN & PROFILE
- 17-18 TRAFFIC SIGNAL PLANS
- 19-20 STAGING PLANS
- 21 SIGNING DETAILS
- 22 CONCRETE MEDIAN DETAIL
- 23 INLET SPECIAL NO.5 (79.4b)
NOSE TYPE FOR INLET TOP SLAB (79.4d)
INLET SPECIAL NO.3,4,5,6 REINFORCEMENT DETAIL (79.4e)
- 24-26 TYPICAL PAVEMENT MARKINGS (41.1)
- 27-34 CROSS SECTIONS

STATE STANDARDS

- 000001-05 STANDARD SYMBOLS, ABBREVIATIONS AND PATTERNS
- 001006 DECIMAL OF AN INCH AND A FOOT
- 280001-04 TEMPORARY EROSION CONTROL SYSTEMS
- 420001-07 PAVEMENT JOINTS
- 421001-02 BAR REINFORCEMENT FOR CRC PAVEMENT
- 442001-04 CLASS A PATCHES
- 602401-02 MANHOLE TYPE A
- 604001-03 FRAME AND LIDS TYPE 1
- 606001-04 CONCRETE CURB TYPE B AND COMBINATION CONCRETE CURB AND GUTTER
- 606301-04 PC CONCRETE ISLANDS AND MEDIANS
- 701101-02 TYPICAL APPLICATION OF TRAFFIC CONTROL STANDARD
- 701201-03 TYPICAL APPLICATION OF TRAFFIC CONTROL STANDARD
- 701301-03 TYPICAL APPLICATION OF TRAFFIC CONTROL STANDARD
- 701400-03 TYPICAL APPLICATION OF TRAFFIC CONTROL STANDARD
- 701401-05 TYPICAL APPLICATION OF TRAFFIC CONTROL STANDARD
- 701406-05 TYPICAL APPLICATION OF TRAFFIC CONTROL STANDARD
- 701426-03 TYPICAL APPLICATION OF TRAFFIC CONTROL STANDARD
- 701601-06 TYPICAL APPLICATION OF TRAFFIC CONTROL STANDARD
- 701701-06 TYPICAL APPLICATION OF TRAFFIC CONTROL STANDARD
- 701901-01 TRAFFIC CONTROL DEVICES
- 720011-01 METAL POST FOR SIGNS, MARKERS AND DELINEATORS
- 720016-02 MAST ARM MOUNTED STREET NAME SIGNS
- 728001-01 TELESCOPING STEEL SIGN SUPPORT
- 729001-01 APPLICATIONS OF TYPES A & B METAL POSTS (FOR SIGNS AND MARKERS)
- 780001-02 TYPICAL PAVEMENT MARKINGS
- 857001-01 STANDARD PHASE DESIGNATION DIAGRAMS AND PHASE SEQUENCES
- 873001-02 TRAFFIC SIGNAL GROUNDING & BONDING
- 877011-04 STEEL COMBINATION MAST ARM ASSEMBLY AND POLE 16' THROUGH 55'
- 878001-07 CONCRETE FOUNDATION DETAILS
- 880006-01 TRAFFIC SIGNAL MOUNTING DETAILS

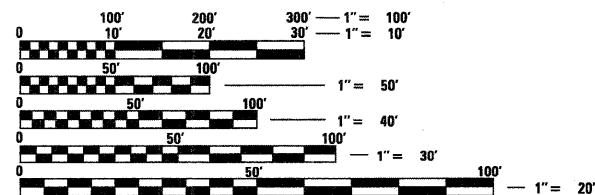

FULL SIZE PLANS HAVE BEEN PREPARED USING STANDARD ENGINEERING SCALES. REDUCED SIZED PLANS WILL NOT CONFORM TO STANDARD SCALES. IN MAKING MEASUREMENTS ON REDUCED PLANS, THE ABOVE SCALES MAY BE USED.

J.U.L.I.E.
JOINT UTILITY LOCATION INFORMATION FOR EXCAVATION
1-800-892-0123
OR 811

CONTRACT NO. 64E58

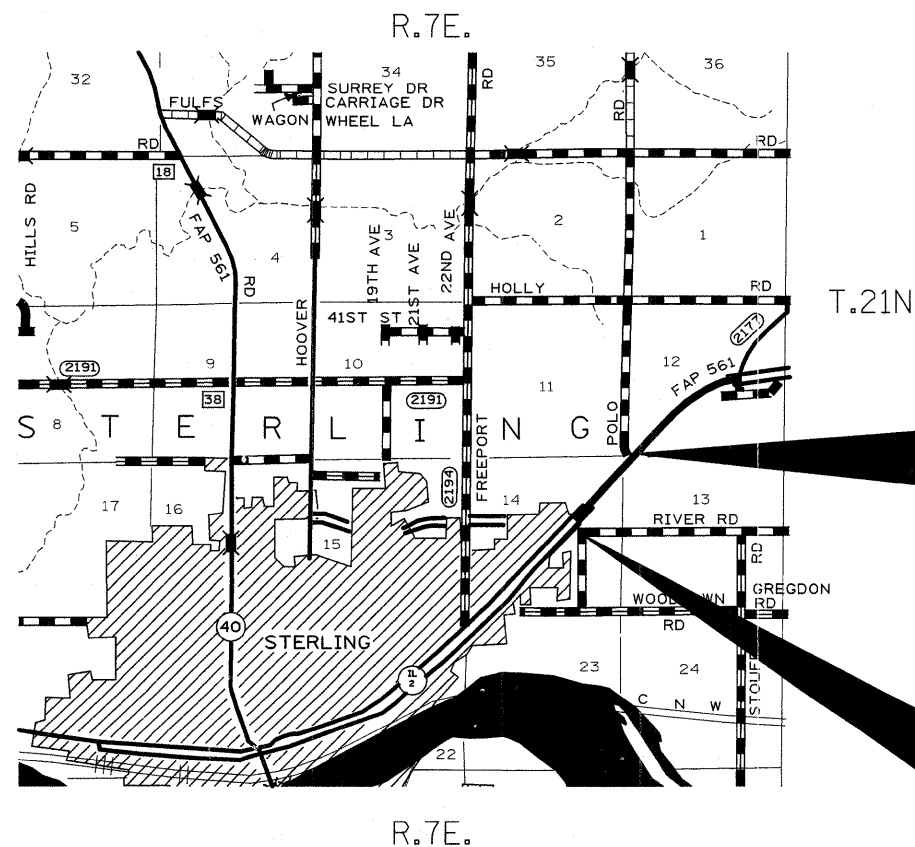

**IMPROVEMENT BEGINS
STA.160 + 92.58**

INCLUDES CONSTRUCTION OF OFFSET TURN LANE
AND SOME RESURFACING

**IMPROVEMENT ENDS
STA.171 + 93.55**

**IMPROVEMENT BEGINS
STA.128 + 84.14**

INCLUDES CONSTRUCTION OF OFFSET TURN LANE
AND SOME RESURFACING

**IMPROVEMENT ENDS
STA.139 + 18.66**

STERLING TOWNSHIP, SECTION 11,12,13,14

GROSS LENGTH OF PROJECT = 4,309 LIN. FT. = 0.82 MILES
NET LENGTH OF PROJECT = 2,135 LIN. FT. = 0.40 MILES

STATE OF ILLINOIS
DEPARTMENT OF TRANSPORTATION
DIVISION OF HIGHWAYS

SUBMITTED 11/23 2009

Debra F. Brown
DEPUTY DIRECTOR OF HIGHWAYS, REGION ENGINEER

March 27, 2009
Charles J. Ingersoll
ENGINEER OF DESIGN AND ENVIRONMENT

March 27, 2009
Christine M. Reed
DIRECTOR OF HIGHWAYS, CHIEF ENGINEER

**PRINTED BY THE AUTHORITY
OF THE STATE OF ILLINOIS**

PROJECT ENGINEER: REBECCA MARRUFFO

SQUAD LEADER: BRAD CUSHMAN (815)-284-5996

SUMMARY OF QUANTITIES

URBAN
90% FED / 10% STATE
HSIP

CODE NUMBER	ITEM	UNIT	TOTAL QUANTITY	SFTY-4A	Y031-1F
20200100	EARTH EXCAVATION	CU YD	844	844	
20800150	TRENCH BACKFILL	CU YD	110	110	
25200110	SODDING, SALT TOLERANT	SQ YD	863	863	
28000250	TEMPORARY EROSION CONTROL SEEDING	POUND	200	200	
28000500	INLET AND PIPE PROTECTION	EACH	3	3	
31200100	STABILIZED SUB-BASE 4"	SQ YD	2,231	2,231	
40600735	POLYMERIZED LEVELING BINDER, (HAND METHOD), N70	TON	15	15	
40600837	POLYMERIZED LEVELING BINDER, (MACHINE METHOD), N70	TON	225	225	
40600990	TEMPORARY RAMP	SQ YD	151	151	
40603540	POLYMERIZED HOT-MIX ASPHALT SURFACE COURSE, MIX "D", N70	TON	270	270	
42100100	CONTINUOUSLY REINFORCED PORTLAND CEMENT CONCRETE PAVEMENT 8"	SQ YD	1,382	1,382	
42100700	PAVEMENT REINFORCEMENT 8"	SQ YD	1,382	1,382	
44000100	PAVEMENT REMOVAL	SQ YD	72	72	
44000159	HOT-MIX ASPHALT SURFACE REMOVAL, 2-1/2"	SQ YD	2,322	2,322	
44000500	COMBINATION CURB AND GUTTER REMOVAL	FOOT	2,005	2,005	
44300200	STRIP REFLECTIVE CRACK CONTROL TREATMENT	FOOT	1,864	1,864	
550A0050	STORM SEWERS, CLASS A, TYPE 1 12"	FOOT	69	69	
55100500	STORM SEWER REMOVAL 12"	FOOT	30	30	
60218400	MANHOLES, TYPE A, 4'-DIAMETER, TYPE 1 FRAME, CLOSED LID	EACH	1	1	
60242801	INLETS, SPECIAL, NO.5	EACH	2	2	
60500060	REMOVING INLETS	EACH	8	8	
60603500	COMBINATION CONCRETE CURB AND GUTTER, TYPE B-6.06	FOOT	409	409	
60605000	COMBINATION CONCRETE CURB AND GUTTER, TYPE B-6.24	FOOT	93	93	
60619124	CONCRETE MEDIAN, TYPE SB-6 (SPECIAL)	SQ FT	6594	6,594	
67000400	ENGINEER'S FIELD OFFICE, TYPE A	CAL MO	3	3	

* SPECIALTY ITEMS

SUMMARY OF QUANTITIES

URBAN
90% FED / 10% STATE
HSIP

CODE NUMBER	ITEM	UNIT	TOTAL QUANTITY	SFTY-4A	Y031-1F
* 88040150	SIGNAL HEAD, POLYCARBONATE, LED, 1-FACE, 5-SECTION, BRACKET MOUNTED	EACH	1		1
* 88040160	SIGNAL HEAD, POLYCARBONATE, LED, 1-FACE, 5-SECTION, MAST ARM MOUNTED	EACH	3		3
* 88200100	TRAFFIC SIGNAL BACKPLATE	EACH	7		7
* 89502205	MODIFY EXISTING CONTROLLER (SPECIAL)	EACH	2		2
* 89502375	REMOVE EXISTING TRAFFIC SIGNAL EQUIPMENT	EACH	1		1
* 89502380	REMOVE EXISTING HANDHOLE	EACH	4		4
* 89502385	REMOVE EXISTING CONCRETE FOUNDATION	EACH	2		2
* X0323153	ELECTRIC CABLE IN CONDUIT, GROUND, NO. 6 1C (GREEN)	FOOT	551		551
* X0324887	CONDUIT INSTALLED, 2 1/2" DIA., NON-METALLIC	FOOT	82		82
* X0324888	CONDUIT INSTALLED, 4" DIA., NON-METALLIC	FOOT	803		803
* 72400710	RELOCATE SIGN PANEL - TYPE I	SQ FT	18		18
* X0320872	VIDEO VEHICLE DETECTION SYSTEM	EACH	2		2
Z0013798	CONSTRUCTION LAYOUT	L SUM	1	1	
* Z0023600	FILLING EXISTING CULVERTS	EACH	3	3	

* SPECIALTY ITEMS

GENERAL NOTES

ROUTE NO.	SEC.	COUNTY	TOTAL SHEETS	SHEET NO.
FAP 561 (IL 2)	(32-4)M-2	Whiteside	34	5
FED ROAD DIST. NO.	ILLINOIS	PROJECT		
Contract #64E58				

The final top 100 mm (four inches) of soil in any right-of-way area disturbed by the Contractor must be capable of supporting vegetation. The soil must be from the A horizon (zero to 2' deep) of soil profiles of local soils.

All Borrow/Waste/Use sites must be approved by the Department prior to removing any material from the project or initiating any earthmoving activities, including temporary stockpiling outside the limits of construction.

Fertilizer shall be applied to all disturbed areas and incorporated into the seedbed prior to seeding or placement of sod at the rate specified in Sections 250 and 252 of the Standard Specifications. This work shall be included in the cost of EARTH EXCAVATION.

The following Mixture Requirements are applicable for this project:

Mixture Uses(s):	Surface	Level Binder	
PG:	SBS PG 70-22	SBS PG 70-22	
Design Air Voids	4.0 @ N70	4.0 @ N70	
Mixture Composition (Gradation Mixture)	IL 9.5 or 12.5	IL 9.5	
Friction Aggregate	D	N/A	
20 Year ESAL	2.5	2.5	

The area to be primed shall be limited to that which can be covered with HMA the same day, unless otherwise permitted by the Engineer.

Reflective Crack Control shall be placed on the existing surface prior to any resurfacing, unless pavement is milled then it will be placed on the binder course.

Bituminous and Aggregate prime coat shall be placed in accordance with Section 406 of the Standard Specifications. The cost of the prime coats shall be included in the contract unit price per metric ton (ton) for LEVELING BINDER (MACHINE METHOD) of the type specified.

Noses of curbed corner islands noted as 1 & 2 on Highway Standard 606301 shall be ramped unless the curb function is for the protection of pedestrians, signals, light standards or sign truss supports.

The Contractor shall install 12" diameter formed openings in the Concrete Median Noses. All existing pavement surfaces or other existing obstructions beneath these openings shall be removed by the Contractor. After the median is in place, core each opening down 1.2 m (4') and fill with dirt. All costs incurred shall be included in the contract unit price per Square Foot for CONCRETE MEDIAN, TYPE SB-6 (SPECIAL).

All frames and grates of drainage structures to be removed or filled shall be carefully salvaged and shall remain the property of the Contractor.

The cost of making sewer connections to existing drainage structures shall be included in the various contract unit prices for STORM SEWER.

The cost of removing existing Storm Sewer during the installation of new storm sewers shall be included in the contract unit price for the STORM SEWER being installed.

The new manhole lids on this project shall have the word "STORM", "SANITARY", or "WATER" on the lid. The word to be used is noted on the plans. It will be the Contractor's responsibility to determine the word to be used on other lids not noted on the plans. No additional compensation will be allowed for this work.

All proposed manholes on this project shall be cast in place or precast. This work will be paid for at the contract unit price Each for MANHOLE of the type and size specified.

Pavement Marking shall be done according to Standard 780001, except as follows:

1. All words, such as ONLY, shall be 2.4 m (8 feet) high.
2. All non-freeway arrows shall be the large size.
3. The distance between yellow no-passing lines shall be 200 mm (8"), not 180 mm (7") as shown in the detail of Typical Lane and Edge Lines.

Work on this project will be in progress at the same time as work on Contract #64F12, patching and resurfacing on IL 2 from 19th Avenue to Palmyra Road in Sterling. Work on these projects shall be scheduled to keep interference between all the projects to a minimum. The contractors shall inform each other of progress of the projects and give fair warning to the other contractors when a problem might be encountered.

The Contractor shall be responsible for protecting utility property during construction operations as outlined in Article 107.31 of the Standard Specifications. A minimum of 48 hours advance notice is required for non-emergency work. The JULIE number is 800-892-0123. The following listed utilities located within the project limits or immediately adjacent to the project construction limits are members of JULIE:

Commonwealth Edison Co.
AT&T
Comcast

NICOR Gas Co.
IL American Water Co.

Following are the known utilities located within the project limits or immediately adjacent to the project construction limits which are not members of JULIE and should be notified individually by the contractor:

City of Sterling
Mr. Vernon Gottel
212 3rd Avenue
Sterling, IL 61081

Tie bars shall be installed to tie PCC appurtenance to adjacent existing concrete pavement.

Tie the following to the existing concrete pavement		Length, size, and spacing of Tie Bars
Gutter or Curb & Gutter	Std. 606001	600 mm (24") long No. 20 (No. 6) @ 600 mm (24") centers
PCC Base Course	Std. 353001	600 mm (24") long No. 20 (No. 6) @ 750 mm (30") centers
PCC Pavement	Std. 420101	600 mm (24") long No. 20 (No. 6) @ 750 mm (30") centers

Tie bars to be installed in accordance with the applicable portions of Article 420.05(b) of the Standard Specifications. See Highway Standard 420001 for detail on longitudinal construction joint grouted-in-place tie bar. The cost of the tie bars to be included in the cost of the PCC appurtenance adjacent to the existing pavement.

Program #5
(Arch. Size)
Enlarge
200%
Enlarge 107%

GENERAL NOTES

ROUTE NO.	SEC.	COUNTY	TOTAL SHEETS	SHEET NO.
FAP 561 (IL 2)	(32-4)M-2	Whiteside	34	6
FED ROAD DIST. NO.	ILLINOIS	PROJECT		
Contract #64E58				

CADD data will be available to Contractors and Consultants working on this project. This information will be provided upon request as MicroStation CADD files and Geopak coordinate geometry files ONLY. If data is required in other formats it will be your responsibility to make these conversions. If any discrepancy or inconsistency arises between the electronic data and the information on the hard copy, the information on the hard copy should be used. Contact the District's Project Engineer to request these files.

It shall be the Contractor's responsibility to contact the municipality to determine approved methods of utility structure adjustment. Utility structures may include, but are not limited to, manholes, water valves, handholes, etc. All materials and work necessary to complete adjustments per municipality requirements shall be considered included in the cost of the associated adjustment pay item.

All traffic signal mast arm assemblies must be designed for the loading shown on the highway standards or these signal plans, whichever is greater.

The City of Sterling shall do the J.U.L.I.E. locate for the traffic signals.

The Contractor shall contact Scott Kullerstrand (815/284-5468) with the Illinois Department of Transportation, Bureau of Operations, two weeks prior to the start date of construction.

The listed existing traffic signal equipment shall be removed by the Contractor and remain the property of the City of Sterling. Rich Power (815/625-6040) with the City of Sterling shall be contacted to arrange for delivery.

- 1 each Mast-Arm Assembly
- 1 each Combination Mast-Arm Assembly
- 6 each Mast-Arm Mounted Signal Heads
- 1 each Luminaire
- 2 each Loop Detector Amplifier System

The removal of all median noses will be included in the cost of Combination Curb and Gutter Removal.

The Contractor shall contact Vernon Gottel (815/632-6624), with the City of Sterling, two weeks prior to the start date of construction so that the City of Sterling can transplant the tree at Sta. 162+25.52, and also remove any prairie grass that will be disturbed by the Contractor.

All concrete trucks are prohibited from driving on any subgrade or sub-base.

Program #5
(Arch. Size)
Enlarge
200%
Enlarge 107%

TYPICAL SECTIONS

STA. 128+84.03 - 133+35.28

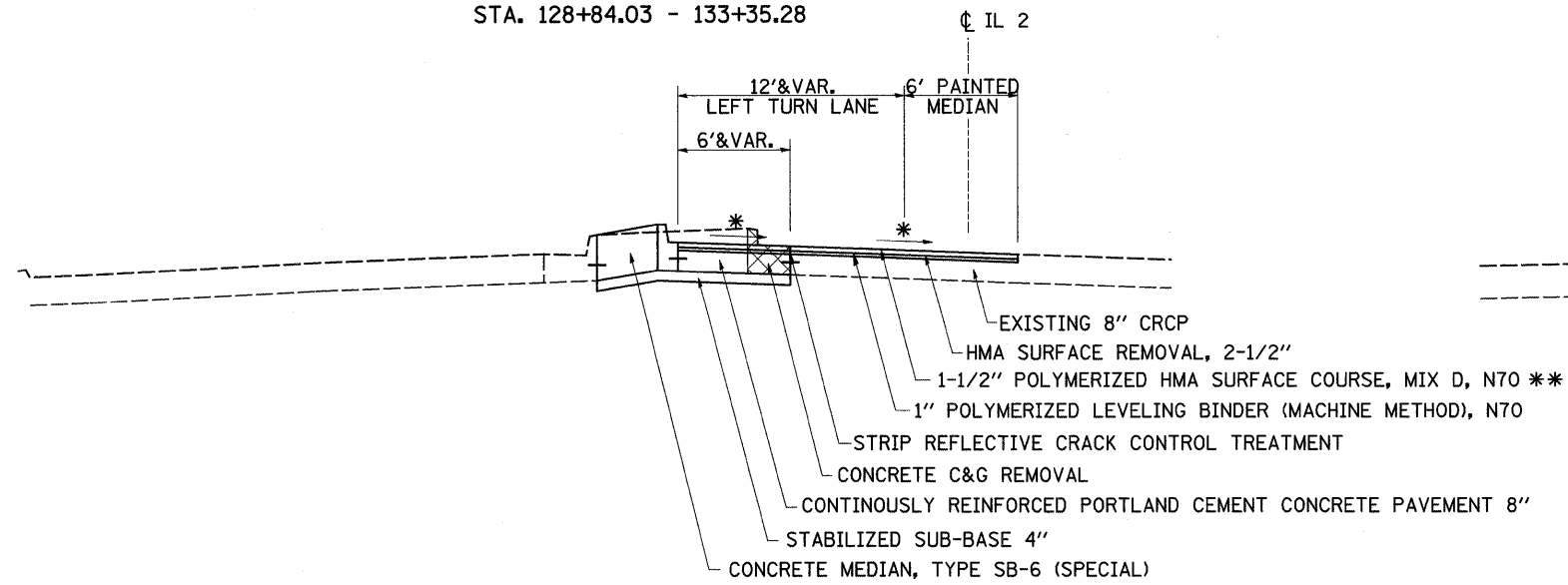

STA. 134+67.41 - 139+18.66

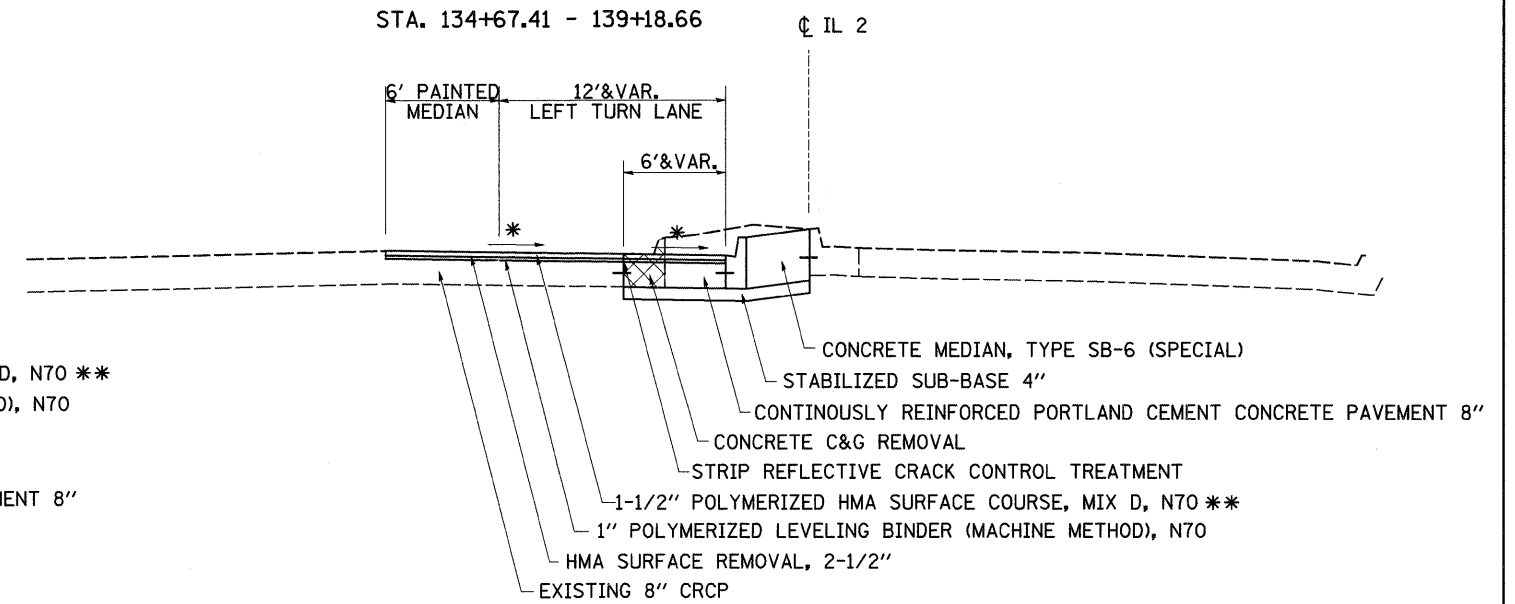

SEE (SCHEDULE OF QUANTITIES)
FOR APPROXIMATE LOCATIONS

* MATCH EXISTING X-SLOPE
** 112LB/SQ YD/IN

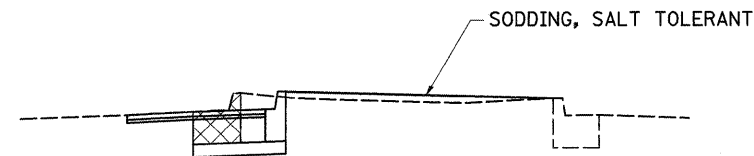

STA. 160+92.58 - 166+03.83

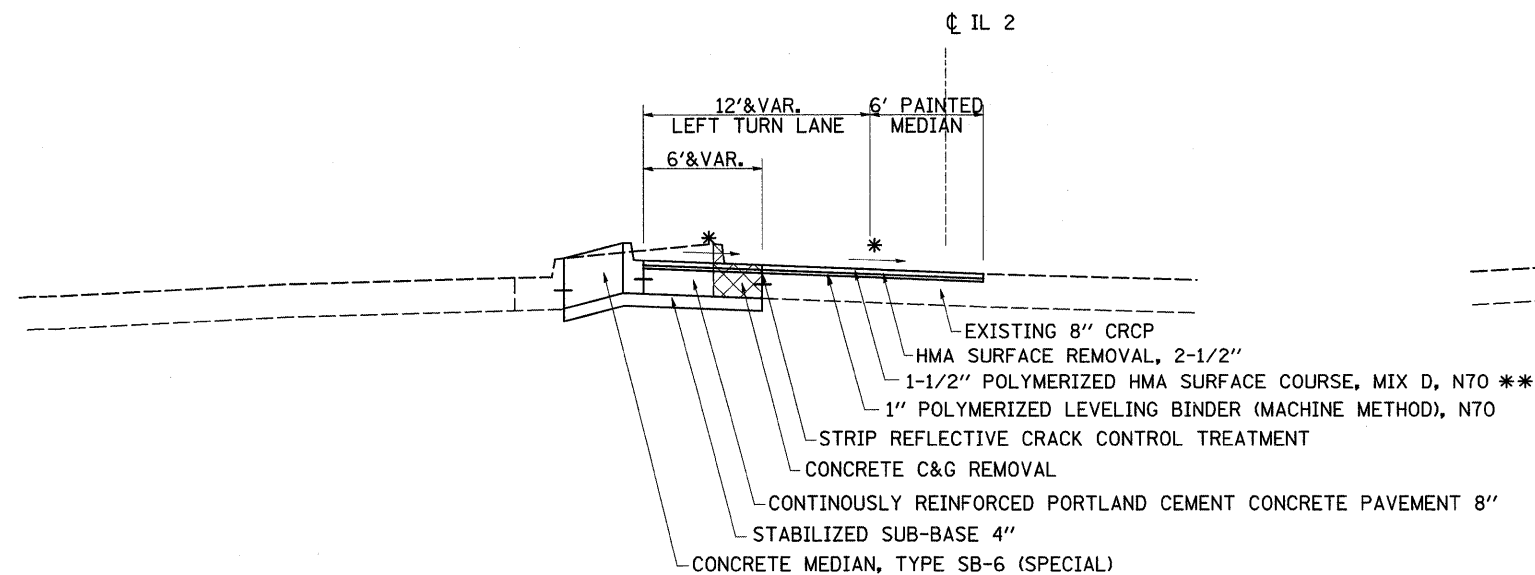

STA. 167+42.30 - 171+93.55

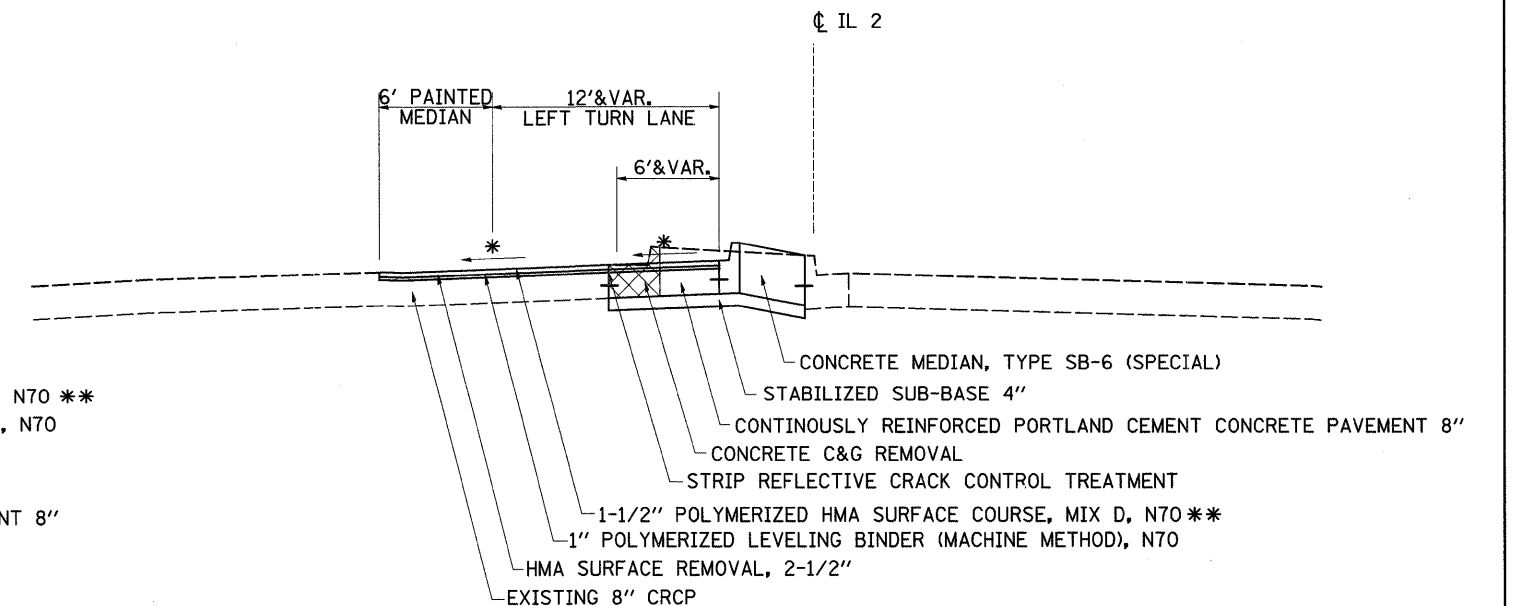

FILE NAME =	USER NAME = cushmanbw	DESIGNED -	REVISED -
ct:\pvc_work\pvc\dot\cushmanbw\dms51062\0200107-typicol.dgn		DRAWN -	REVISED -
PLOT SCALE = 50.0000' / IN.		CHECKED -	REVISED -
PLOT DATE = Fri Jan 23 06:59:56 2009		DATE -	REVISED -

STATE OF ILLINOIS
DEPARTMENT OF TRANSPORTATION

TYPICAL SECTIONS

SCALE: SHEET NO. OF SHEETS STA. TO STA.

F.A.P. RTE.	SECTION	COUNTY	TOTAL SHEETS	SHEET NO.
561	(32-4)M-2	WHITESIDE	34	7
CONTRACT NO. 64E58				
FED. ROAD DIST. NO. ILLINOIS FED. AID PROJECT				

BITUMINOUS SCHEDULE

LOCATION	REMARKS	WIDTH	AREA	40600837	40603540	44000159	40600735	40600990
				POLYMERIZED LEV. BINDER (MACHINE METHOD) N70	POLYMERIZED HMA SURFACE CSE. MIX "D", N70	HMA SURFACE REMOVAL, 2-1/2"	POLYMERIZED LEV. BINDER (HAND METHOD) N70	TEMPORARY RAMP
		FOOT	SQ YD	TON	TON	SQ YD	TON	SQ YD
<i>IL 251</i>							15.0	
128+84.14 - 171+93.55								
129+24.18 - 133+58.31			809	56.6	68.0			
134+48.31 - 139+18.66			748	52.4	62.8			
160+92.58 - 166+31.58			895	62.7	75.2			
167+19.55 - 171+93.55			762	53.3	64.0			
129+24.18 - 133+58.31			540			540		
134+48.31 - 139+18.66			618			618		
161+27.77 - 166+31.58			570			570		
167+19.55 - 171+34.95			594			594		
130+00			60					60
133+53.82			23					23
134+52.37			23					23
166+27.40			22					22
167+23.58			23					23
			<i>Total</i>	5687	225	270	2322	15

AGGREGATE SCHEDULE

LOCATION	REMARKS	WIDTH	AREA	31200100
				STABILIZED SUB-BASE 4"
		FOOT	SQ FT	SQ YD
<i>IL 251</i>				
128+84.03 - 129+90.78			699	77.7
130+11.74 - 133+53.62			4996	555.1
134+48.31 - 139+18.67			3968	440.9
160+92.58 - 166+15.90			6087	676.3
167+30.92 - 171+93.55			4330	481.1
			<i>Total</i>	20080

EARTHWORK SCHEDULE

LOCATION	20200100			
	EARTH EXCAVATION	EARTH EXCAVATION ADJUSTED FOR SHRINKAGE	EMBANKMENT	EARTHWORK BALANCE WASTE (+) SHORTAGE (-)
	(CU YD)	(CU YD)	(CU YD)	(CU YD)
128+84.00 TO 129+90.00	25.2	18.9	0.0	18.9
130+11.68 TO 133+41.23	163.4	122.6	0.0	122.6
134+52.00 TO 139+18.66	196.1	147.1	0.2	146.9
160+92.58 TO 166+15.65	269.5	202.1	0.3	201.8
167+30.84 TO 171+93.85	190.1	142.6	0.3	142.3
<i>TOTALS</i>	844.3	633.2	0.8	632.4

HORIZONTAL & VERTICAL CONTROL

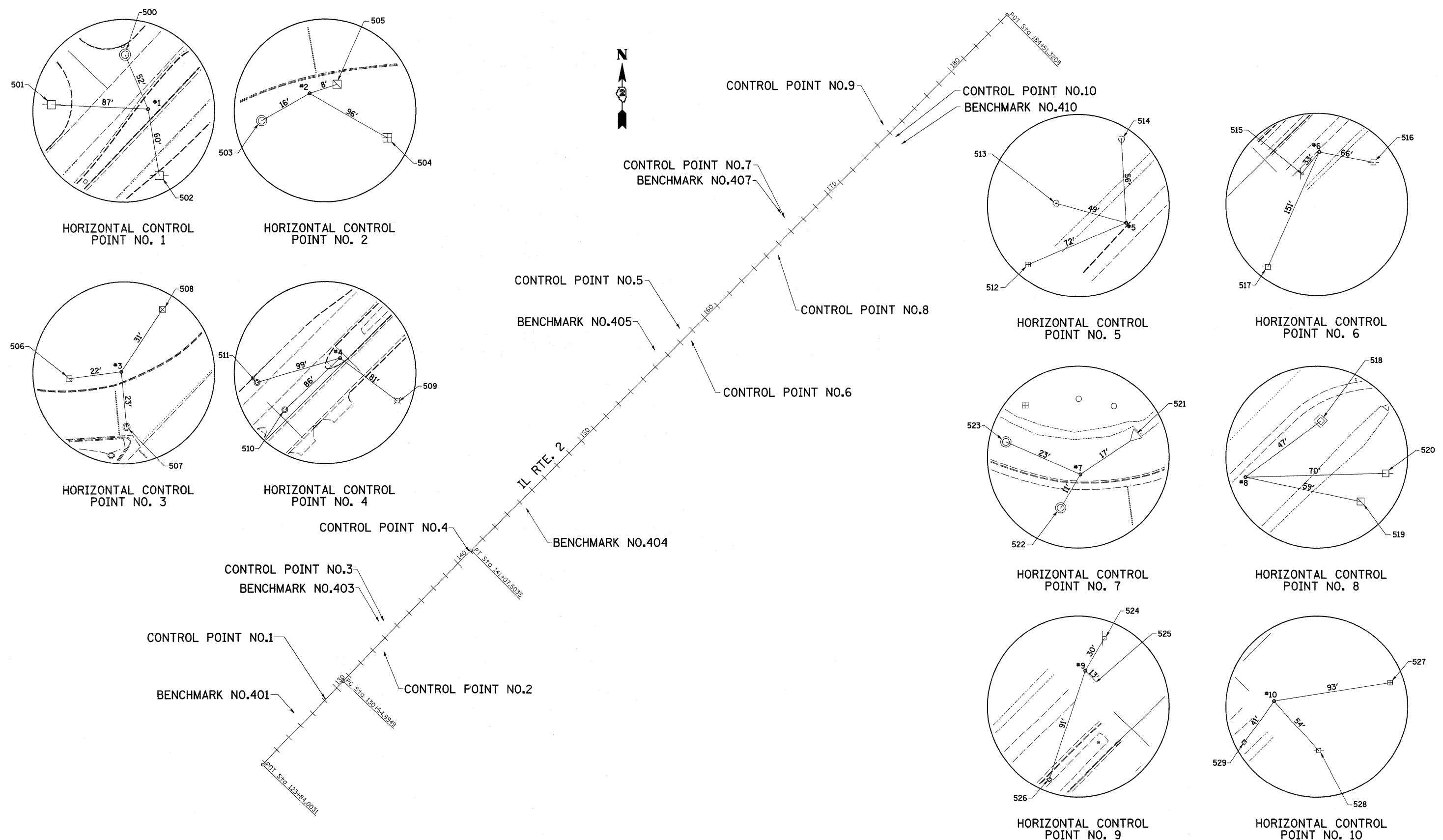

FILE NAME =	USER NAME = cushmanbw	DESIGNED -	REVISED -	STATE OF ILLINOIS DEPARTMENT OF TRANSPORTATION	HORIZONTAL & VERTICAL CONTROL	F.A.P. RTE.	SECTION	COUNTY	TOTAL SHEETS	SHEET NO.	
ct:\pwork\pwork\cushmanbw\dms51082\02001019-shr-ATB.dgn	PLOT SCALE = 50.0000' / IN.	DRAWN -	REVISED -			561	(32-4)M-2	WHITESIDE	34	11	
PLOT DATE = Fri Jan 23 06:59:25 2009	DATE -	CHECKED -	REVISED -			CONTRACT NO. 64E58					
		DATE -	REVISED -			FED. ROAD DIST. NO. ILLINOIS FED. AID PROJECT					

Chain ILRT2 contains:

HORIZONTAL & VERTICAL CONTROL

Beginning chain ILRT2 description

Point 1011 N 1,872,604.4996 E 2,434,591.7699 Sta 123+84.00

Course from 1011 to PC 200 N 43° 33' 14.06" E Dist 670.8918'

Curve Data

Curve 200
 P.I. Station 135+81.23 N 1,873,472.1635 E 2,435,416.7050
 Delta = 1° 34' 53.67" (RT)
 Degree = 0° 09' 00.91"
 Tangent = 526.3377'
 Length = 1,052.6086'
 Radius = 38,132.9054'
 External = 3.6323'
 Long Chord = 1,052.5752'
 Mid. Ord. = 3.6319'
 P.C. Station 130+54.89 N 1,873,090.7126 E 2,435,054.0390
 P.T. Station 141+07.50 N 1,873,843.4594 E 2,435,789.7610
 C.C. N 1,846,815.7410 E 2,462,689.9637

Course from PT 200 to 1004 N 45° 08' 07.72" E Dist 4,343.8173'

Point 1004 N 1,876,907.7306 E 2,438,868.5578 Sta 184+51.32

Ending chain ILRT2 description

REFERENCE TIES

POINT	CHAIN	STATION	OFFSET	DESCRIPTION
500	ILRT2	129+30.52	56.1381' LT	MANHOLE LID, CENTER
501	ILRT2	128+53.02	73.7559' LT	POWER POLE, SHINER
502	ILRT2	128+73.44	40.1816' RT	POWER POLE, SHINER
503	ILRT2	133+24.07	46.5863' RT	MANHOLE LID, CENTER
504	ILRT2	133+45.59	76.0213' RT	TELEPHONE SPLICE BOX, SHINER
505	ILRT2	133+46.60	55.0087' RT	HANDHOLE, CENTER
506	ILRT2	134+49.73	87.0982' LT	HANDHOLE, CENTER
507	ILRT2	134+51.99	56.0225' LT	MANHOLE LID, CENTER
508	ILRT2	134+97.13	79.3259' LT	R.O.W. MARKER, BACK
509	ILRT2	141+05.94	74.136' RT	LIGHT POLE
510	ILRT2	140+08.10	9.1377' LT	MANHOLE LID, CENTER
511	ILRT2	140+07.59	53.5647' LT	MANHOLE LID, CENTER
512	ILRT2	157+87.82	84.8198' LT	TELEPHONE SPLICE BOX, SHINER
513	ILRT2	158+30.10	100.7665' LT	7" TREE DECIDUOUS, TREE DECIDUOUS
514	ILRT2	158+91.67	100.2506' LT	7" TREE DECIDUOUS, TREE DECIDUOUS
515	ILRT2	158+20.07	43.0287' RT	STREET - SIGN, SHINER
516	ILRT2	158+90.41	93.9975' RT	POWER POLE, SHINER
517	ILRT2	157+12.52	93.4818' RT	POWER POLE WITH TRANSFORMER, SHINER
518	ILRT2	165+98.08	51.8143' RT	HANDHOLE, CENTER
519	ILRT2	165+83.85	94.4678' RT	HANDHOLE, CENTER
520	ILRT2	166+02.68	93.3022' RT	POWER POLE, SHINER
521	ILRT2	167+46.09	79.8905' LT	PIPE CULVERT, TOP
522	ILRT2	167+18.52	80.3158' LT	MANHOLE LID, CENTER
523	ILRT2	167+20.74	104.8927' LT	MANHOLE LID, CENTER
524	ILRT2	175+35.85	66.6348' LT	STREET - SIGN, SHINER
525	ILRT2	175+06.71	46.4977' LT	PAVEMENT STATION NUMBER
526	ILRT2	174+25.58	17.7434' LT	HANDHOLE, CENTER
527	ILRT2	175+83.90	94.3951' RT	TELEPHONE SPLICE BOX, CORNER
528	ILRT2	175+05.04	93.4864' RT	POWER POLE
529	ILRT2	174+68.02	47.2476' RT	HANDHOLE, CENTER

HORIZONTAL CONTROL POINTS

POINT	NORTH	EAST	ELEVATION	CHAIN	STATION	OFFSET	DESCRIPTION
1	1872991.1675	2434948.2133	692.0809	ILRT2	129+09.83	8.1044' LT	GPS CONTROL POINT, PIN
2	1873260.5429	2435287.5093	696.3821	ILRT2	133+39.23	51.1242' RT	GPS CONTROL POINT, PIN
3	1873438.8543	2435286.6944	697.2415	ILRT2	134+66.72	73.499' LT	GPS CONTROL POINT, PIN
4	1873838.6194	2435775.7135	699.7299	ILRT2	140+94.13	6.4814' LT	GPS CONTROL POINT, PIN
5	1875116.8574	2436986.7957	708.9210	ILRT2	158+54.23	58.1274' LT	GPS CONTROL POINT, PIN
6	1875046.7960	2437054.7712	708.6477	ILRT2	158+52.99	39.4827' RT	GPS CONTROL POINT, PIN
7	1875751.9132	2437589.3461	716.1560	ILRT2	167+29.29	83.1814' LT	GPS CONTROL POINT, PIN
8	1875535.6167	2437553.8810	714.9644	ILRT2	165+51.57	45.1063' RT	GPS CONTROL POINT, PIN
9	1876283.2993	2438157.5461	720.0735	ILRT2	175+06.88	58.9886' LT	GPS CONTROL POINT, PIN
10	1876214.1974	2438228.4788	720.1064	ILRT2	175+08.41	40.0275' RT	GPS CONTROL POINT, PIN

SURVEY WORK POINTS

POINT	NORTH	EAST	ELEVATION	CHAIN	STATION	OFFSET	DESCRIPTION
100	1872999.5190	2434878.0085	691.0691	ILRT2	128+67.51	64.7382' LT	TOPO SURVEY POINT, PIN
101	1873185.2841	2435055.0651	693.7512	ILRT2	131+24.02	64.4823' LT	TOPO SURVEY POINT, PIN
102	1873290.9958	2435155.6053	696.2857	ILRT2	132+69.66	65.0005' LT	TOPO SURVEY POINT, PIN
103	1873378.8563	2435154.7125	697.6024	ILRT2	133+32.17	126.5922' LT	TOPO SURVEY POINT, PIN

BENCH MARKS

POINT	NORTH	EAST	ELEVATION	CHAIN	STATION	OFFSET	DESCRIPTION
401	1872907.0389	2434771.8028	689.4319	ILRT2	127+27.31	77.9861' LT	CHISELED SQUARE, HEADWALL
403	1873435.8392	2435257.8347	696.7449	ILRT2	134+44.51	92.1039' LT	CHISELED SQUARE, TRAFFIC SIGNAL FOUNDATION
404	1874083.4748	2436105.9669	697.0117	ILRT2	145+00.94	52.9447' RT	CHISELED SQUARE, HEADWALL
405	1874993.7235	2436844.7749	706.4561	ILRT2	156+66.71	71.0391' LT	CHISELED SQUARE, HEADWALL
407	1875776.2701	2437568.8670	716.6277	ILRT2	167+31.96	114.8916' LT	POWER POLE, RAIL ROAD SPIKE
410	1876174.0519	2438263.6896	720.6964	ILRT2	175+05.04	93.3206' RT	POWER POLE, RAIL ROAD SPIKE

APPARENT PROPERTY CORNERS

POINT	NORTH	EAST	ELEVATION	CHAIN	STATION	OFFSET	DESCRIPTION
700	1873006.4482	2434870.4056	689.5565	ILRT2	128+67.30	75.0227' LT	PROPERTY CORNER, PIN
701	1872803.6561	2434677.5904	690.7558	ILRT2	125+87.47	75.0298' LT	PROPERTY CORNER, PIN
702	1872675.2873	2434742.1517	693.4728	ILRT2	125+38.92	60.2103' RT	PROPERTY CORNER, PIPE
703	1872563.1118	2434635.1682	697.1775	ILRT2	OUT OF CHAIN	-----	PROPERTY CORNER, PIN
704	1872651.6943	2434719.2543	694.9085	ILRT2	125+06.05	59.8724' RT	PROPERTY CORNER, PIN
705	1874487.7464	2436491.4075	702.5747	ILRT2	150+59.32	38.3088' RT	PROPERTY CORNER, PIPE
706	1876692.8913	2438518.0310	722.1974	ILRT2	180+51.32	95' LT	PROPERTY CORNER, PIN
707	1876615.1022	2438439.7778	721.2062	ILRT2	179+40.98	95.0673' LT	PROPERTY CORNER, PIN
708	1876488.5930	2438312.6088	719.0223	ILRT2	177+61.60	95.1097' LT	PROPERTY CORNER, PIN
709	1876364.3048	2438187.8087	718.3484	ILRT2	175+85.47	95.0552' LT	PROPERTY CORNER, PIN
710	1876061.0991	2437883.2439	717.0838	ILRT2	171+55.71	95' LT	PROPERTY CORNER, PIN
711	1874649.6284	2436500.8335	703.4012	ILRT2	151+80.19	69.78' LT	PROPERTY CORNER, PIN

CURVE POINT NUMBERS

CHAIN	CURVE	PI	CC	PC	PT
ILRT2	200	200	201	202	203

IL 2 / LYNN BLVD.

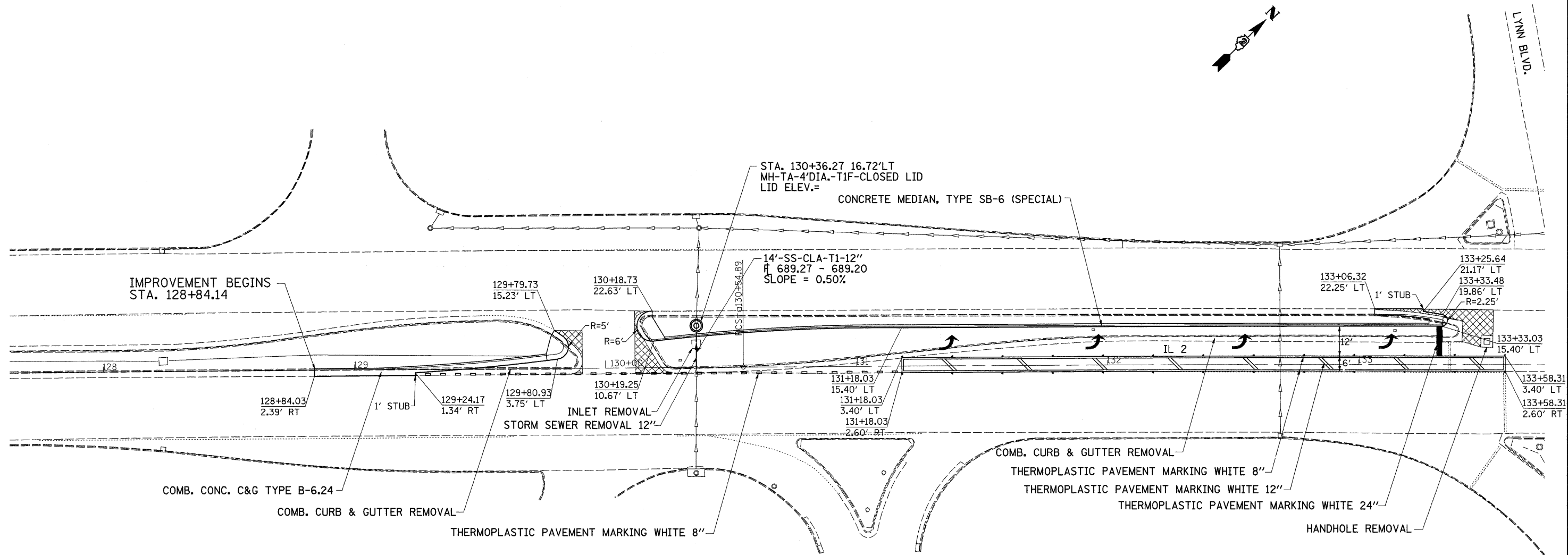

STA. 128+84 to 129+90	
EARTH EX. = 25.2	CU.YDS.
EMB. = 0	CU.YDS.
WASTE = 18.9	CU.YDS.

STA. 130+11.68 to 133+41.23	
EARTH EX. = 163.4	CU.YDS.
EMB. = 0	CU.YDS.
WASTE = 122.6	CU.YDS.

 PAVEMENT REMOVAL

FILE NAME =	USER NAME = cushmanbw	DESIGNED -	REVISED -	STATE OF ILLINOIS DEPARTMENT OF TRANSPORTATION	IL 2 / LYNN BLVD.	F.A. RTE.	SECTION	COUNTY	TOTAL SHEETS	SHEET NO.
ct:\pw\work\p\dot\cushmanbw\dms51062\0200109-sht-plan.dgn	DRAWN -	REVISED -	561			(32-4M-2)	WHITESIDE	34	13	
PLOT SCALE = 20,0000' / IN.	CHECKED -	REVISED -	CONTRACT NO. 64E58							
PLOT DATE = Fri Jan 23 06:59:41 2009	DATE -	REVISED -	FED. ROAD DIST. NO. [ILLINOIS] FED. AID PROJECT							
SCALE: SHEET NO. OF SHEETS STA. TO STA.										

IL 2 / LYNN BLVD.

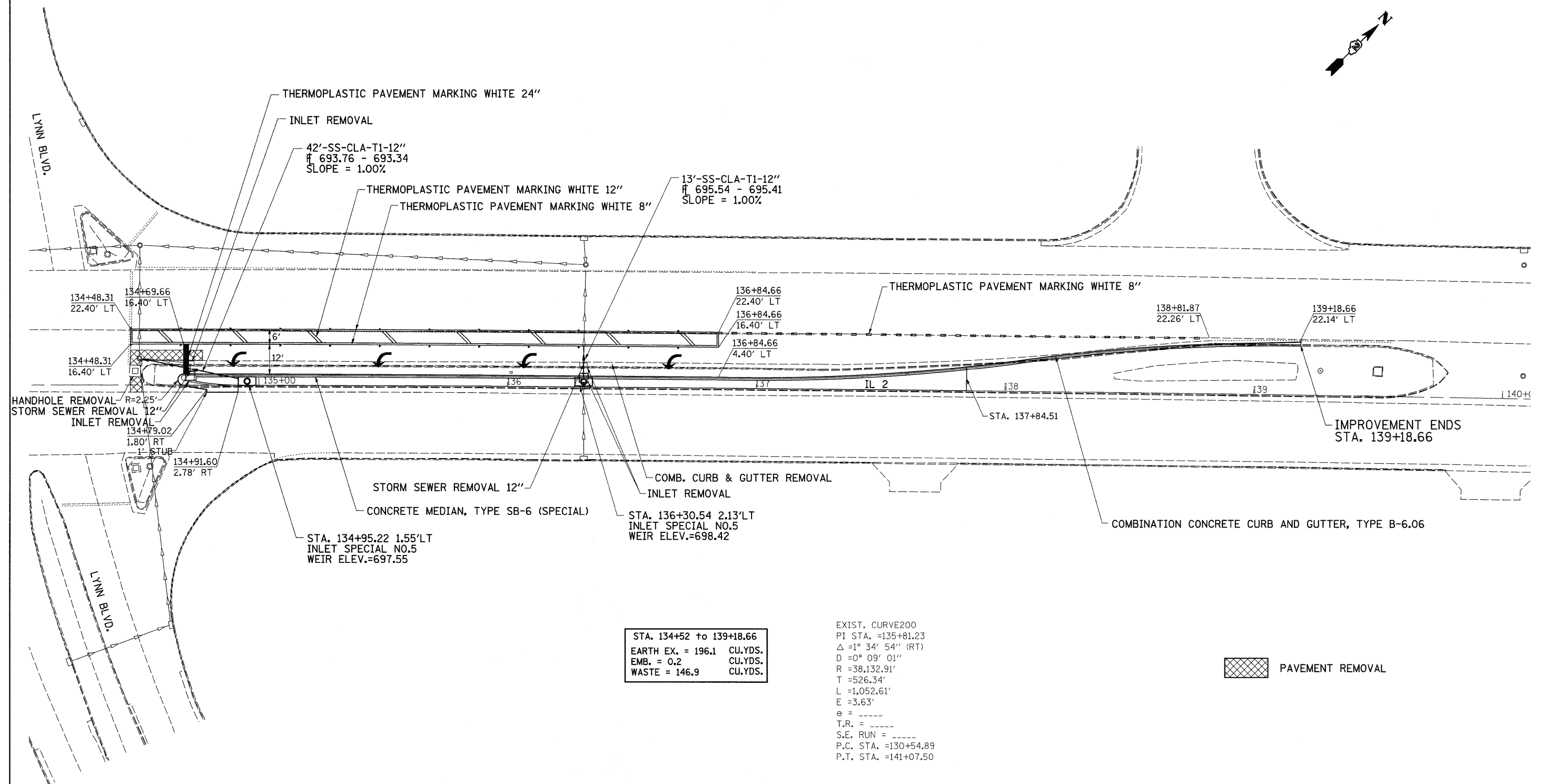

STA. 134+52 to 139+18.66
 EARTH EX. = 196.1 CU.YDS.
 EMB. = 0.2 CU.YDS.
 WASTE = 146.9 CU.YDS.

EXIST. CURVE200
 PI STA. =135+81.23
 $\Delta = 1^{\circ} 34' 54''$ (RT)
 $D = 0^{\circ} 09' 01''$
 $R = 38,132.91'$
 $T = 526.34'$
 $L = 1,052.61'$
 $E = 3.63'$
 $e =$ -----
 $T.R. =$ -----
 $S.E. RUN =$ -----
 $P.C. STA. = 130+54.89$
 $P.T. STA. = 141+07.50$

 PAVEMENT REMOVAL

FILE NAME =	USER NAME = cushmanbw	DESIGNED -	REVISED -
c:\pwwork\pwwork\cushmanbw\dms51082\02	010189-sht-plen.dgn	DRAWN -	REVISED -
	PLOT SCALE = 20.0000' / IN.	CHECKED -	REVISED -
	PLOT DATE = Fri Jan 23 06:59:42 2009	DATE -	REVISED -

STATE OF ILLINOIS
 DEPARTMENT OF TRANSPORTATION

IL 2 / LYNN BLVD.

SCALE: SHEET NO. OF SHEETS STA. TO STA.

F.A. RTE.	SECTION	COUNTY	TOTAL SHEETS	SHEET NO.
561	(32-4M-2)	WHITESIDE	34	14
CONTRACT NO. 64E58				
FED. ROAD DIST. NO. [ILLINOIS] FED. AID PROJECT				

IL 2 / POLO RD.

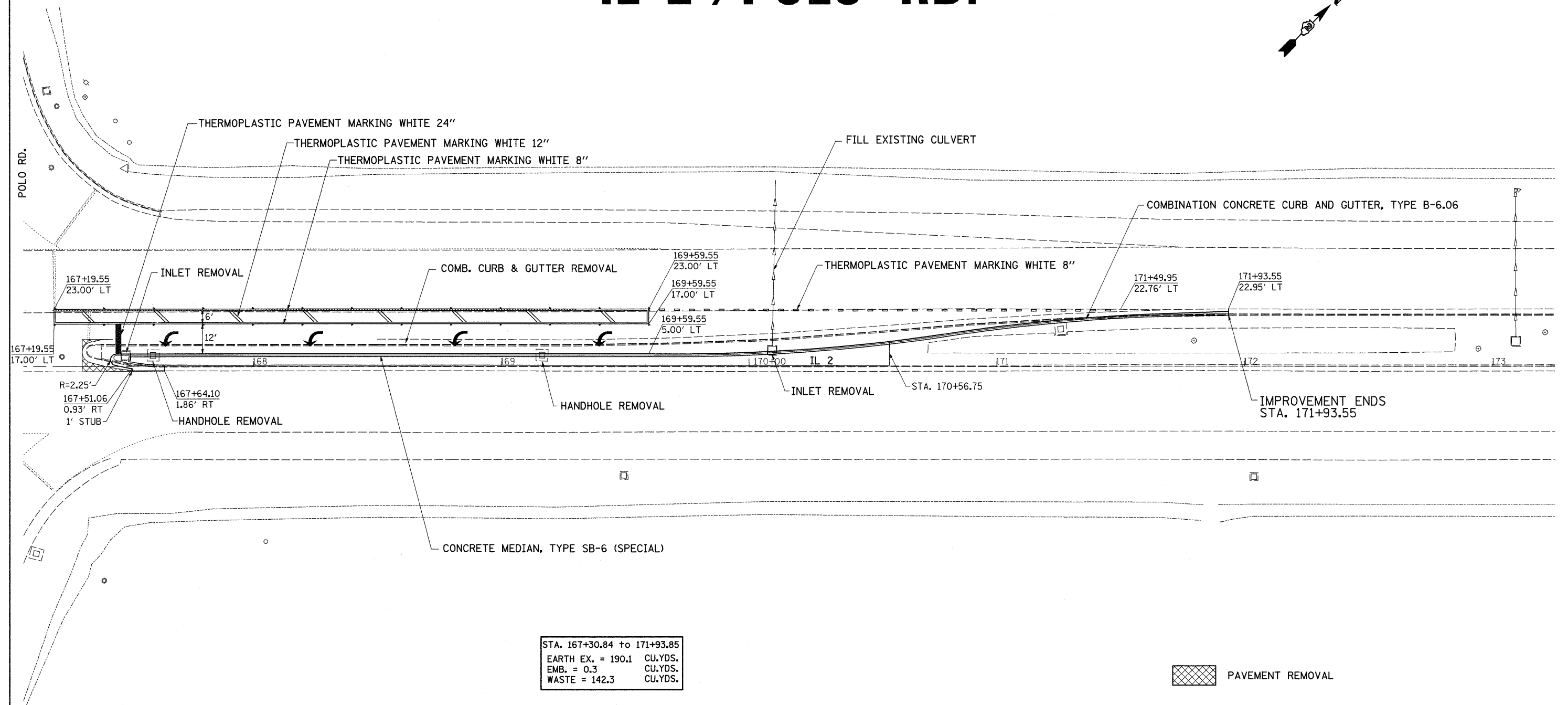
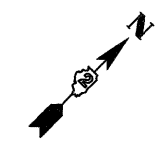

STA. 167+30.84 to 171+93.85
 EARTH EX. = 190.1 CU.YDS.
 EMB. = 0.3 CU.YDS.
 WASTE = 142.3 CU.YDS.

 PAVEMENT REMOVAL

FILE NAME =	USER NAME = cushmanbw	DESIGNED -	REVISED -	STATE OF ILLINOIS DEPARTMENT OF TRANSPORTATION	IL 2 / POLO RD.			F.A. RTE.	SECTION	COUNTY	TOTAL SHEETS	SHEET NO.
c:\pwwork\pwwork\cushmanbw\dms51082\0200109-sht-plan.dgn	DRAWN -	REVISED -	561					(32-4)M-2	WHITESIDE	34	16	
PLOT SCALE = 20.0000' / IN.	CHECKED -	REVISED -	SCALE: SHEET NO. OF SHEETS STA. TO STA.			CONTRACT NO. 64E58						
PLOT DATE = Fri Jan 23 06:59:42 2009	DATE -	REVISED -	FED. ROAD DIST. NO. ILLINOIS FED. AID PROJECT									

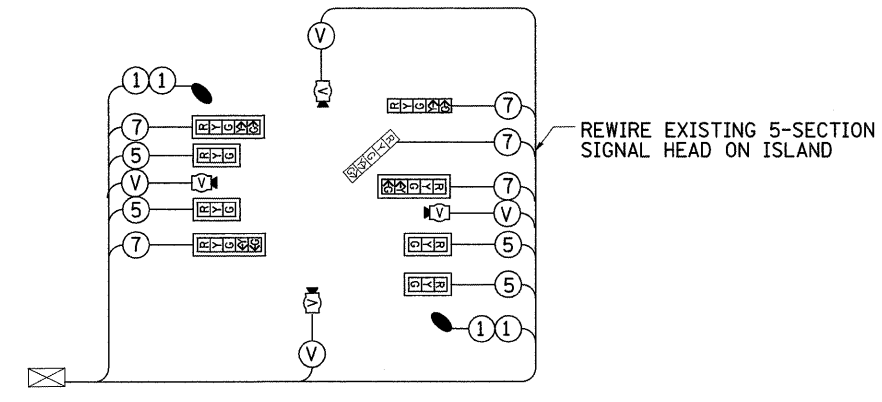

PROPOSED SIGNALS FOR NEW COMBINATION MAST-ARMS
VIDEO DETECTION CAMERA SHALL BE MOUNTED ON THE MAST-ARMS WITH EXTENSION POLES

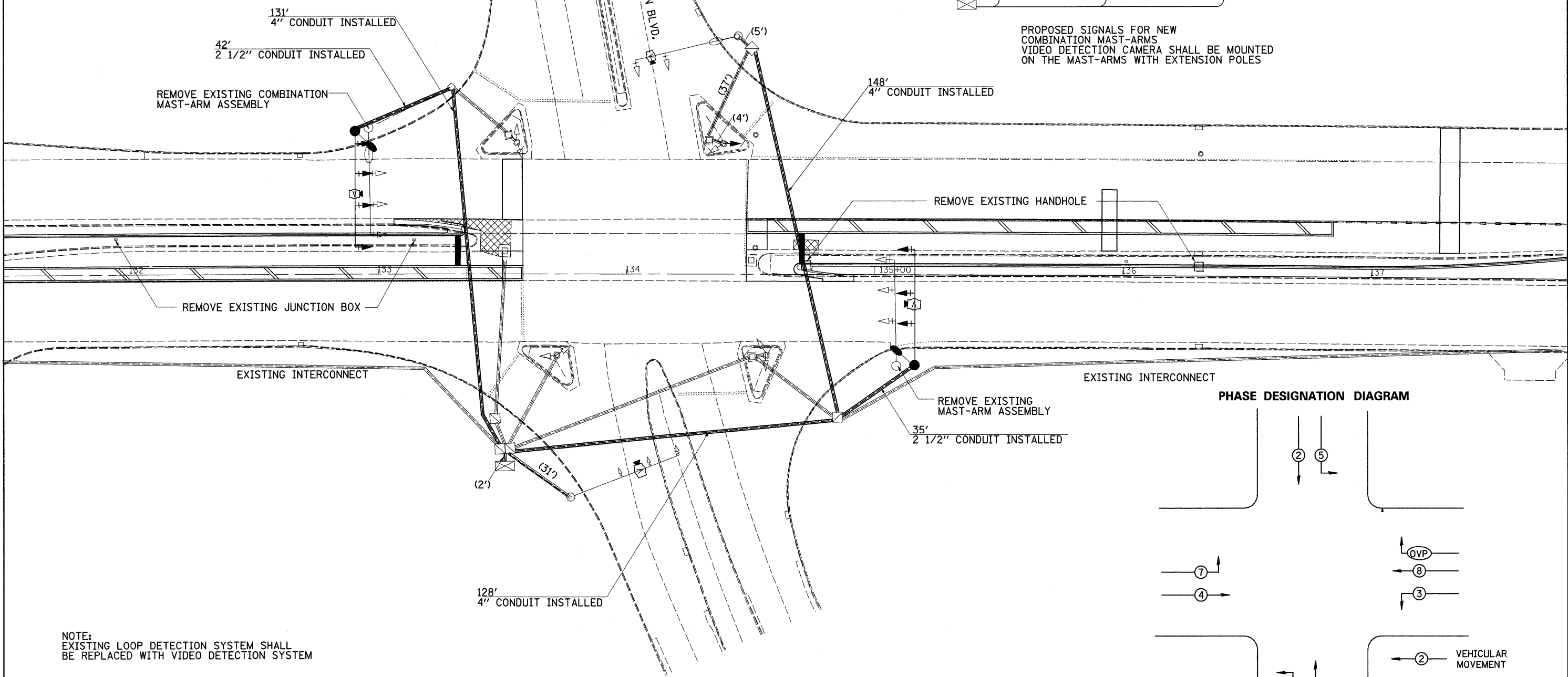

PHASE DESIGNATION DIAGRAM

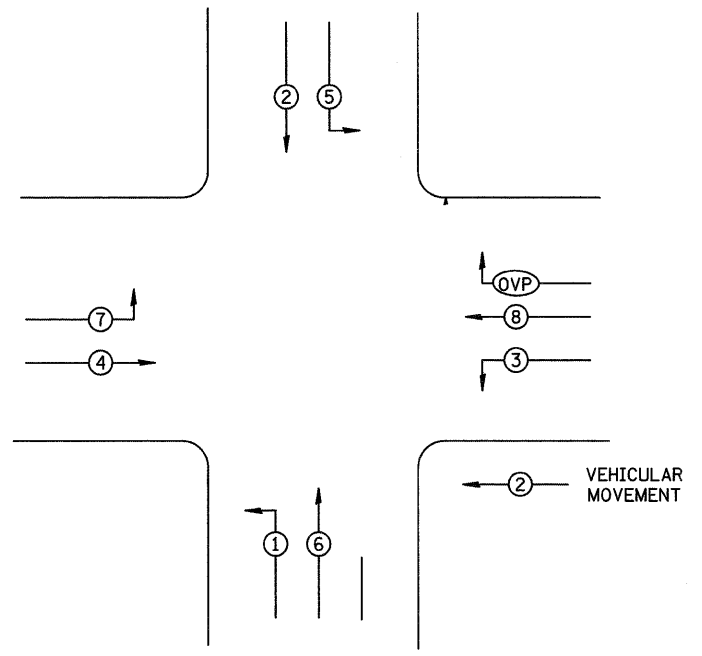

NOTE:
EXISTING LOOP DETECTION SYSTEM SHALL BE REPLACED WITH VIDEO DETECTION SYSTEM

FILE NAME =	USER NAME = cushmanbw	DESIGNED -	REVISED -	STATE OF ILLINOIS DEPARTMENT OF TRANSPORTATION	IL 2 /LYNN BLVD.	F.A.P. RTE.	SECTION	COUNTY	TOTAL SHEETS	SHEET NO.	
C:\pw_work\PWIDOT\CUSHMANBW\dms51115\020109-signal-plan.dgn	20109-signal-plan.dgn	DRAWN -	REVISED -			561	(32-4)M-2	WHITESIDE	34	17	
PLOT SCALE = 20.0000' / IN.		CHECKED -	REVISED -			CONTRACT NO. 64E58					
PLOT DATE = Fri Jan 23 07:05:55 2009		DATE -	REVISED -			FED. ROAD DIST. NO. ILLINOIS FED. AID PROJECT					
SCALE:						SHEET NO. OF SHEETS		STA. TO STA.			

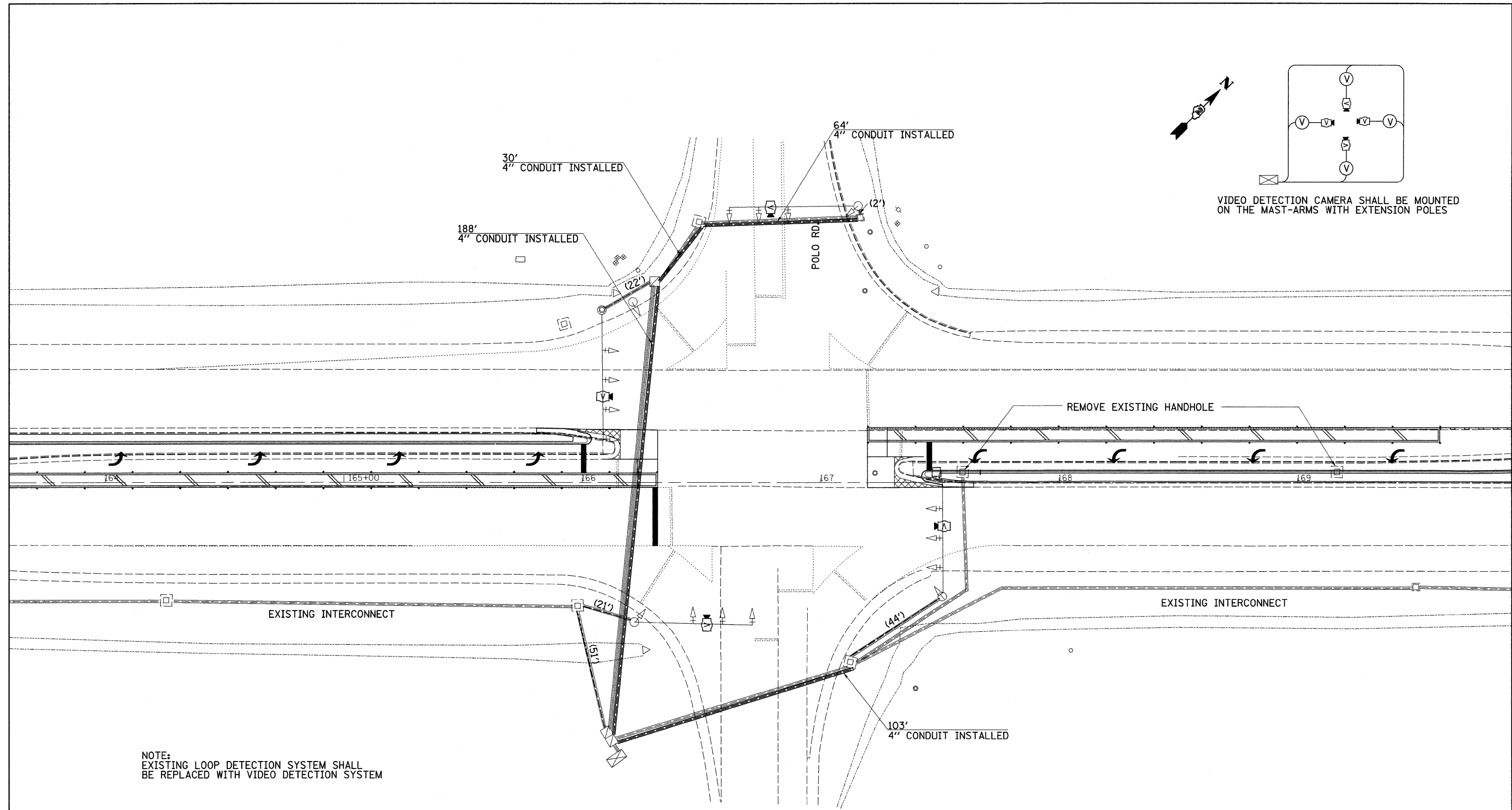

NOTE:
EXISTING LOOP DETECTION SYSTEM SHALL
BE REPLACED WITH VIDEO DETECTION SYSTEM

FILE NAME =	USER NAME = cushmanbw	DESIGNED -	REVISED -
C:\pwork\PWIDOT\CUSHMANBW\dms51115\020109-signal-plan.dgn		DRAWN -	REVISED -
PLOT SCALE = 20.0000' / IN.		CHECKED -	REVISED -
PLOT DATE = Fri Jan 23 07:06:45 2009		DATE -	REVISED -

**STATE OF ILLINOIS
DEPARTMENT OF TRANSPORTATION**

IL 2 / POLO RD.

SCALE: SHEET NO. OF SHEETS STA. TO STA.

F.A.P. RTE.	SECTION	COUNTY	TOTAL SHEETS	SHEET NO.
561	(32-4M-2)	WHITESIDE	34	18
CONTRACT NO. 64E58				
FED. ROAD DIST. NO.		ILLINOIS FED. AID PROJECT		

TRAFFIC CONTROL PLAN @ LYNN BOULEVARD

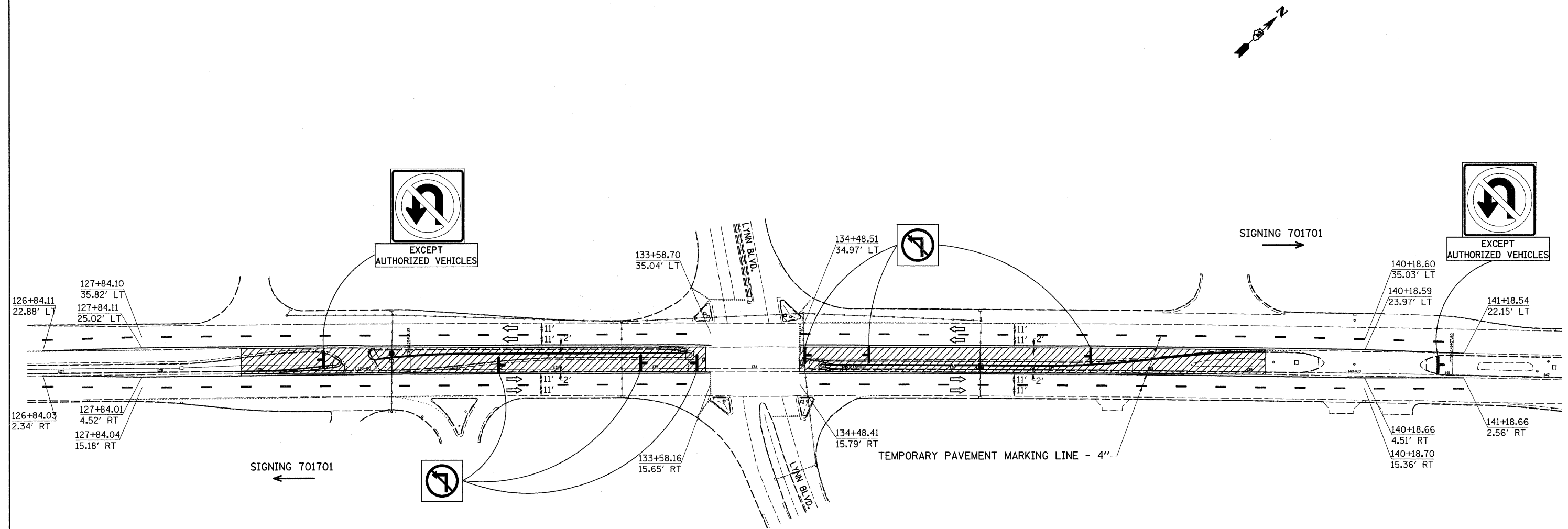

STAGING NOTES:

1. REMOVE EXISTING PAVEMENT MARKING IN STAGING AREA.
2. APPLY TEMP. PAVEMENT MARKING LINE 4".
3. LEFT TURN LANES ON IL 2 AT LYNN BOULEVARD INTERSECTION WILL BE CLOSED.
4. LOCATION OF "NO LEFT TURN" SIGNS WILL BE DETERMINED BY THE FIELD ENGINEER.
5. COVER LEFT TURN SIGNAL HEADS

FILE NAME =	USER NAME = cushmanbw	DESIGNED -	REVISED -	STATE OF ILLINOIS DEPARTMENT OF TRANSPORTATION	TRAFFIC CONTROL PLAN	F.A.P. RTE.	SECTION	COUNTY	TOTAL SHEETS	SHEET NO.
c:\pwork\pwork\dot\cushmanbw\dms51082\0200109-sht-staging.dgn	DRAWN -	REVISED -	561			(32-4M-2)	WHITESIDE	34	19	
PLOT SCALE = 50.0000' / IN.	CHECKED -	REVISED -	CONTRACT NO. 64E58							
PLOT DATE = Fri Jan 23 06:59:50 2009	DATE -	REVISED -	ILLINOIS FED. AID PROJECT							
SCALE:						SHEET NO.	OF	SHEETS	STA.	TO STA.

TRAFFIC CONTROL PLAN @ POLO RD.

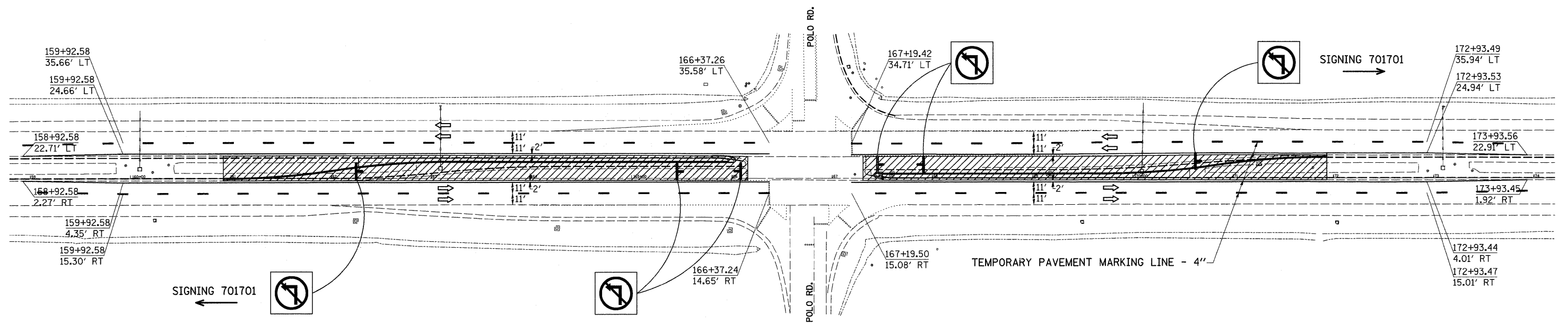
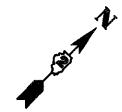

SIGNING 701701 ←

→ SIGNING 701701

TEMPORARY PAVEMENT MARKING LINE - 4"

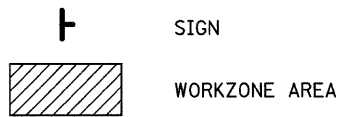

STAGING NOTES:

1. REMOVE EXISTING PAVEMENT MARKING IN STAGING AREA.
2. APPLY TEMP. PAVEMENT MARKING LINE 4".
3. LEFT TURN LANES ON IL 2 AT POLO RD. INTERSECTION WILL BE CLOSED.
4. LOCATION OF "NO LEFT TURN" SIGNS WILL BE DETERMINED BY THE FIELD ENGINEER.
5. COVER LEFT TURN SIGNAL HEADS

FILE NAME =	USER NAME = cushmanbw	DESIGNED -	REVISED -	STATE OF ILLINOIS DEPARTMENT OF TRANSPORTATION	TRAFFIC CONTROL PLAN	F.A.P. RTE.	SECTION	COUNTY	TOTAL SHEETS	SHEET NO.	
ca:\pw_work\pwwork\cushmanbw\dms51082\0240109-sht-staging.dgn	PLOT SCALE = 50.0000' / IN.	DRAWN -	REVISED -			561	(32-4M-2	WHITESIDE	34	20	
PLOT DATE = Fri Jan 23 06:59:50 2009	DATE -	CHECKED -	REVISED -			CONTRACT NO. 64E58					
						ILLINOIS FED. AID PROJECT					

SIGNING DETAILS



2.3" Radius, 0.9" Border, 0.6" Indent, Black on Orange;
 [NO LEFT TURNS] D 2K; [PERMITTED] D 2K;
 [AT LYNN BLVD] D 2K;

Table of letter and object lefts.

N	O	L	E	F	T			
10.4	15.8	26.0	30.7	35.4	39.5			
T U R N S								
49.2	53.8	59.3	64.4	69.5				
P	E	R	M	I	T	T	E	D
21.8	26.8	31.6	36.7	42.8	44.6	48.7	53.3	58.1
A	T	L	Y	N				
12.2	17.6	27.4	31.4	37.5	43.0			
B L V D								
53.1	58.2	62.3	67.7					



2.3" Radius, 0.9" Border, 0.6" Indent, Black on Orange;
 [NO LEFT TURNS] D 2K; [PERMITTED] D 2K;
 [AT RIVER ROAD] D 2K;

Table of letter and object lefts.

N	O	L	E	F	T			
10.4	15.8	26.0	30.7	35.4	39.5			
T U R N S								
49.2	53.8	59.3	64.4	69.5				
P	E	R	M	I	T	T	E	D
21.8	26.8	31.6	36.7	42.8	44.6	48.7	53.3	58.1
A	T	R	I	V	E	R		
10.7	16.2	25.9	31.0	32.9	38.3	43.1		
R O A D								
53.2	58.1	63.2	69.2					

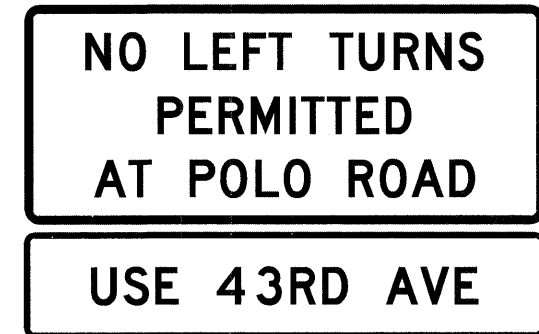
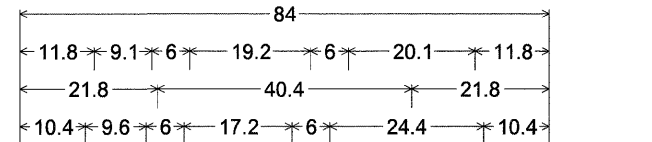

3.0" Radius, 1.3" Border, 0.8" Indent, Black on Orange;
 [NO LEFT TURNS] D 2K; [PERMITTED] D 2K;
 [AT POLO ROAD] D 2K;
 0.9" Border, 0.6" Indent, Black on Orange;
 [USE 43RD AVE] D 2K;

Table of letter and object lefts.

N	O	L	E	F	T			
10.4	15.8	26.0	30.7	35.4	39.5			
T U R N S								
49.2	53.8	59.3	64.4	69.5				
P	E	R	M	I	T	T	E	D
21.8	26.8	31.6	36.7	42.8	44.6	48.7	53.3	58.1
A	T	P	O	L	O			
11.8	17.2	26.9	31.8	37.4	41.9			
R O A D								
52.1	57.1	62.2	68.2					
U	S	E	4	3	R	D		
11.3	16.4	21.5	31.2	37.5	42.9	48.0		
A V E								
58.1	63.5	69.0						

NOTES

TO BE PAID FOR USING TRAFFIC CONTROL STANDARD 701401.

FILE NAME =	USER NAME = cushmanbw	DESIGNED -	REVISED -	STATE OF ILLINOIS DEPARTMENT OF TRANSPORTATION	SIGNING DETAILS	F.A.P. RTE.	SECTION	COUNTY	TOTAL SHEETS	SHEET NO.
ct:\pw\work\pww\dot\cushmanbw\dms51082\0200109-sht-detail.dgn	DRAWN -	REVISED -	561			(32-4)M-2	WHITESIDE	34	21	
PLOT SCALE = 50.0000' / IN.	CHECKED -	REVISED -	CONTRACT NO. 64E58							
PLOT DATE = Fri Jan 23 06:45:33 2009	DATE -	REVISED -	ILLINOIS FED. AID PROJECT							
SCALE:						SHEET NO.	OF	SHEETS	STA.	TO STA.

CONCRETE MEDIAN, TYPE SB-6 (SPECIAL)

SEE PLANS FOR APPROXIMATE LOCATIONS

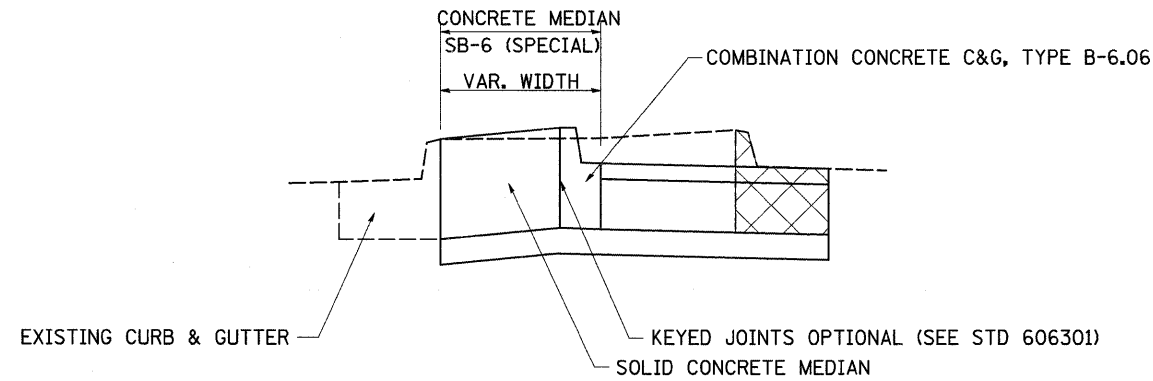

NOTES

ALL MEDIAN WORK WILL BE BUILT USING ARTICLE 606.09 (CONCRETE MEDIANS) AND HIGHWAY STANDARD 606301-03 (PC CONCRETE ISLANDS AND MEDIANS).
METHOD OF PAYMENT IS IN SQ FT (CONCRETE MEDIAN, TYPE SB-6 (SPECIAL)).

SEE PLANS FOR APPROXIMATE LOCATIONS

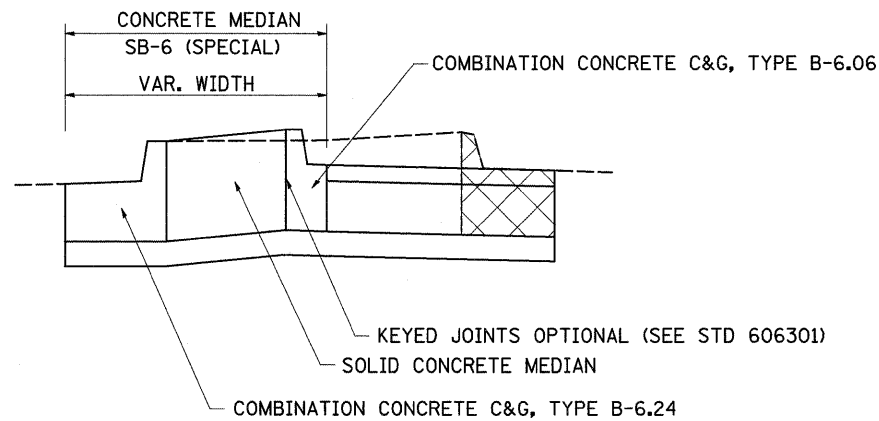

FILE NAME =	USER NAME = cushmanbw	DESIGNED -	REVISED -	STATE OF ILLINOIS DEPARTMENT OF TRANSPORTATION	SCALE: SHEET NO. OF SHEETS STA. TO STA.	F.A.P. RTE.	SECTION	COUNTY	TOTAL SHEETS	SHEET NO.	
ct:\p\work\p\widot\cushmanbw\dms51082\02	02109-sht-details.dgn	DRAWN -	REVISED -			561	(32-4M-2)	WHITESIDE	34	22	
	PLOT SCALE = 50.0000' / IN.	CHECKED -	REVISED -			CONTRACT NO. 64E58					
	PLOT DATE = Fri Jan 23 06:59:33 2009	DATE -	REVISED -			ILLINOIS FED. AID PROJECT					

INLET SPECIAL NO. 5

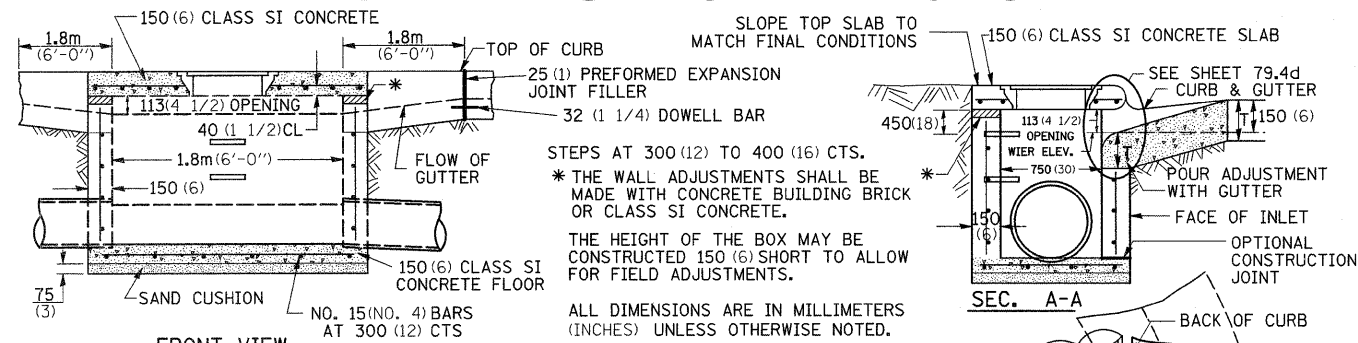

FRONT VIEW

NOTES

SEE STANDARD 602701 FOR DETAILS OF STEPS. 25 (1) PREFORMED EXPANSION JOINTS AS SHOWN SHALL BE PROVIDED ON EACH SIDE OF INLET. CLASS SI CONCRETE OR PRECAST CONCRETE SHALL BE USED THROUGHOUT. THE SIDE WALLS MAY BE BUILT AS PRECAST SEGMENTAL SECTIONS. REINFORCEMENT FOR INLET SPECIAL NO. 5 SHALL BE ACCORDING TO DISTRICT STANDARD 79.4e

LIGHT WEIGHT MANHOLE CASTING

TOTAL WEIGHT 73 KG. (160 LBS.)
REVISED - 4-4-05

STEPS AT 300(12) TO 400(16) CTS. * THE WALL ADJUSTMENTS SHALL BE MADE WITH CONCRETE BUILDING BRICK OR CLASS SI CONCRETE. THE HEIGHT OF THE BOX MAY BE CONSTRUCTED 150 (6) SHORT TO ALLOW FOR FIELD ADJUSTMENTS. ALL DIMENSIONS ARE IN MILLIMETERS (INCHES) UNLESS OTHERWISE NOTED.

STEPS SHALL BE OMITTED WHEN DEPTH OF INLET IS LESS THAN 1.5 m (5 ft.) THE INLET SHALL BE CAST IN PLACE OR PRECAST. EXCEPT AS NOTED HEREON INLET SPECIAL NO. 5 SHALL BE CONSTRUCTED IN ACCORDANCE WITH SECTION 602 OF THE STANDARD SPECIFICATIONS. THE CONTRACT UNIT PRICE EACH FOR INLET SPECIAL NO. 5 SHALL INCLUDE THE COST OF FURNISHING AND INSTALLING THE FRAME, LID, REINFORCEMENT BARS, FLOOR AND TOP SLABS, CAST IRON STEPS (IF USED). THE CURB AND GUTTER WILL BE PAID FOR SEPARATELY AND WILL BE MEASURED THROUGH THE INLET. THE CURB AND GUTTER ADJACENT TO AND 1.8m (6 FT) ON EITHER SIDE OF THE INLET SHALL BE CONSTRUCTED AS SHOWN WITH NO ADDITIONAL COMPENSATION FOR THE TRANSITION. ** WHEN INLET IS CONSTRUCTED IN RETURN, THE TOP OF SLAB SHALL CONFORM TO THE RADIUS OF THE RETURN.

INLET SPECIAL NO. 5 79.4b

NOSE TYPE FOR INLET TOP SLAB

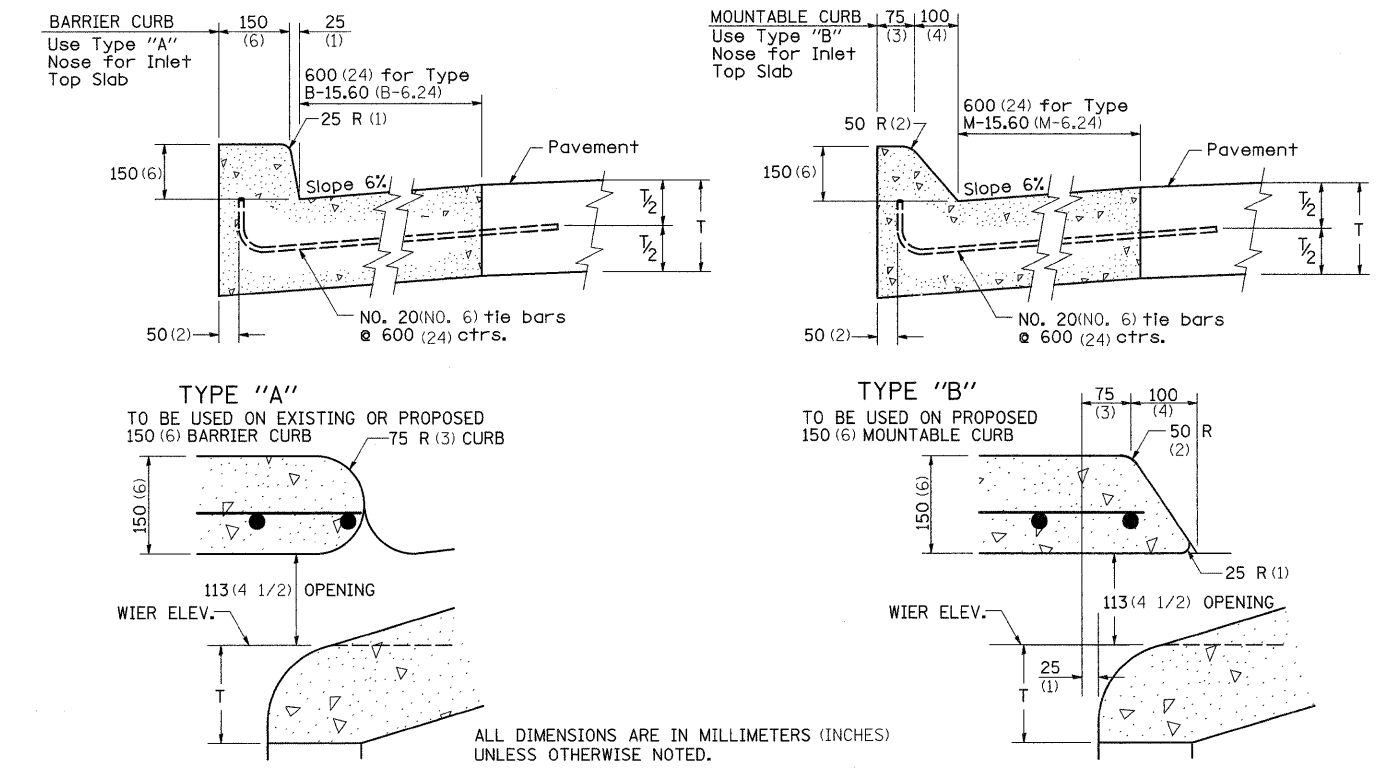

NOSE TYPE FOR INLET TOP SLAB 79.4d

REVISED - 2-14-95

INLET SPECIAL NO. 3, 4, 5, 6 REINFORCEMENT DETAIL

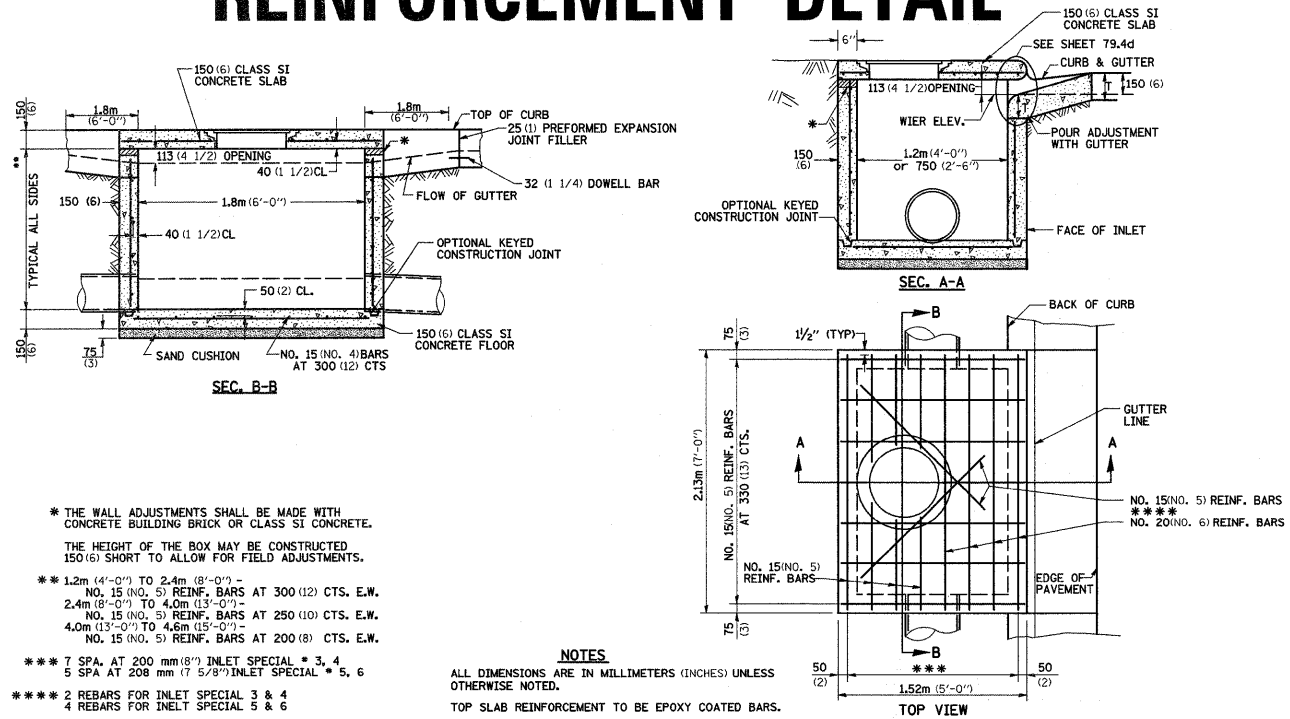

NOTES

* THE WALL ADJUSTMENTS SHALL BE MADE WITH CONCRETE BUILDING BRICK OR CLASS SI CONCRETE. THE HEIGHT OF THE BOX MAY BE CONSTRUCTED 150 (6) SHORT TO ALLOW FOR FIELD ADJUSTMENTS.

** 1.2m (4'-0") TO 2.4m (8'-0") - NO. 15 (NO. 5) REINF. BARS AT 300 (12) CTS. E.W.
2.4m (8'-0") TO 4.0m (13'-0") - NO. 15 (NO. 5) REINF. BARS AT 250 (10) CTS. E.W.
4.0m (13'-0") TO 4.6m (15'-0") - NO. 15 (NO. 5) REINF. BARS AT 200 (8) CTS. E.W.

*** 7 SPA. AT 200 mm (8") INLET SPECIAL * 3, 4
5 SPA AT 208 mm (7 5/8") INLET SPECIAL * 5, 6

**** 2 REBARS FOR INLET SPECIAL 3 & 4
4 REBARS FOR INLET SPECIAL 5 & 6

ALL DIMENSIONS ARE IN MILLIMETERS (INCHES) UNLESS OTHERWISE NOTED.
TOP SLAB REINFORCEMENT TO BE EPOXY COATED BARS.

INLET SPECIAL NO. 3, 4, 5, 6 REINFORCEMENT DETAIL 79.4e

REVISED -	REGION 2 / DISTRICT 2 STANDARD	F.A.P. RTE.	SECTION	COUNTY	TOTAL SHEETS	SHEET NO.
REVISED -		561	(32-4M-2)	WHITESIDE	34	23
REVISED -		CONTRACT NO. 64E58				
REVISED -		FED. ROAD DIST. NO. ILLINOIS FED. AID PROJECT				
REVISED -		SCALE: 50.0000 / IN	SHEET NO.	OF	SHEETS	STA.

TYPICAL PAVEMENT MARKINGS

TYPICAL PAVEMENT MARKING FOR FLUSH MEDIAN AT LEFT TURN LANE

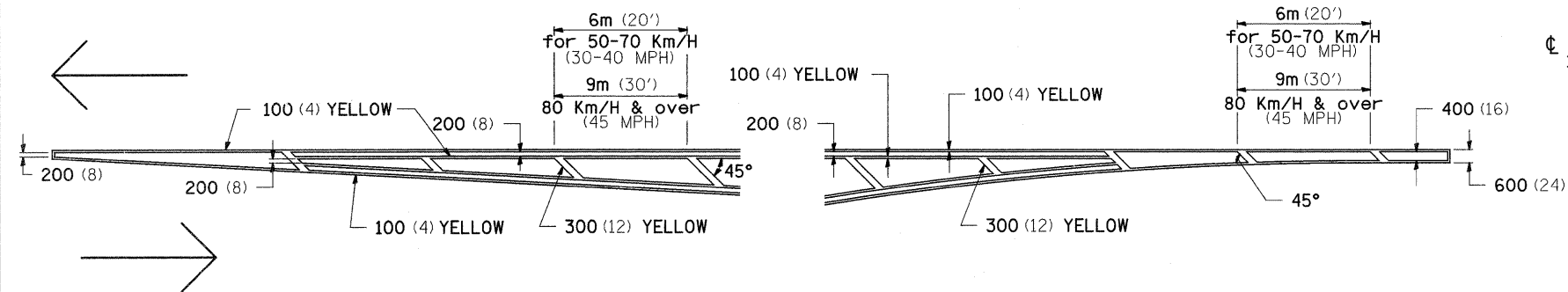

MEDIAN PAVEMENT MARKING

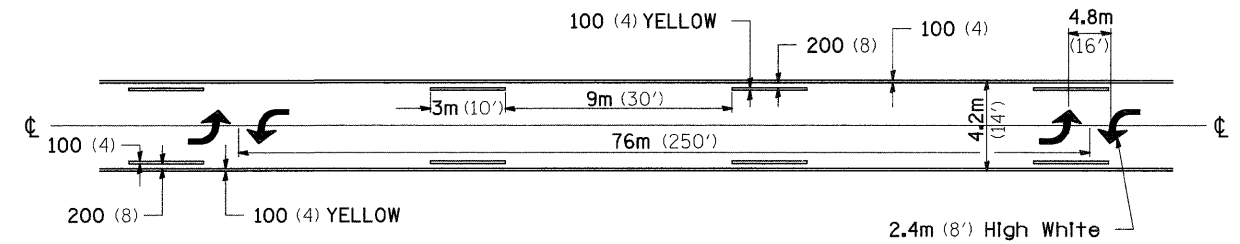

** ALL DIMENSIONS ARE IN MILLIMETERS (INCHES) UNLESS OTHERWISE NOTED.

TYPICAL ISLAND OFFSET SHOULDER WIDTH

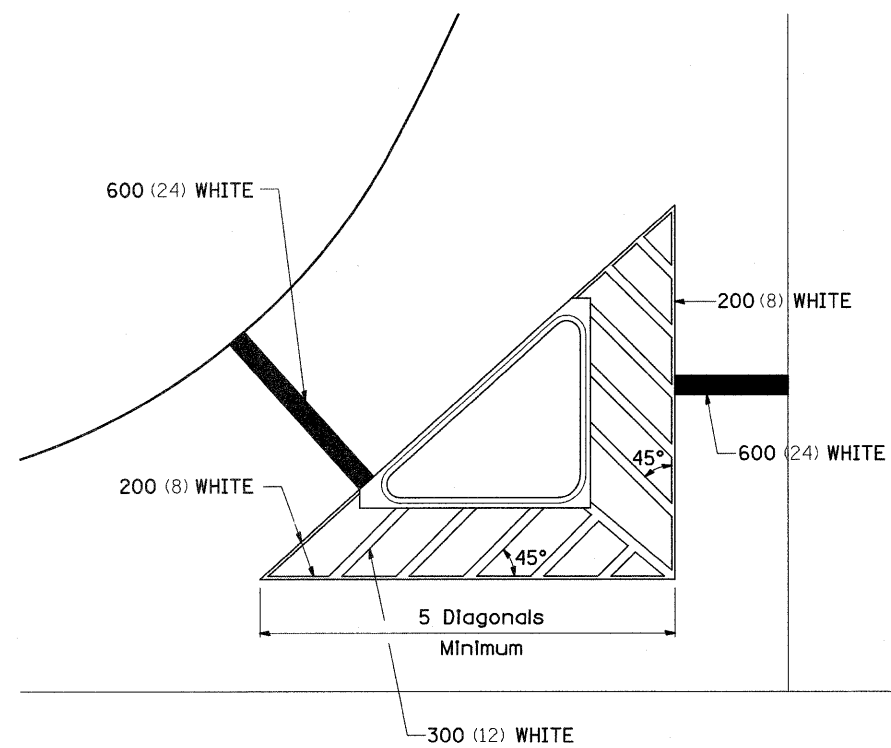

TYPICAL PARKING SPACING

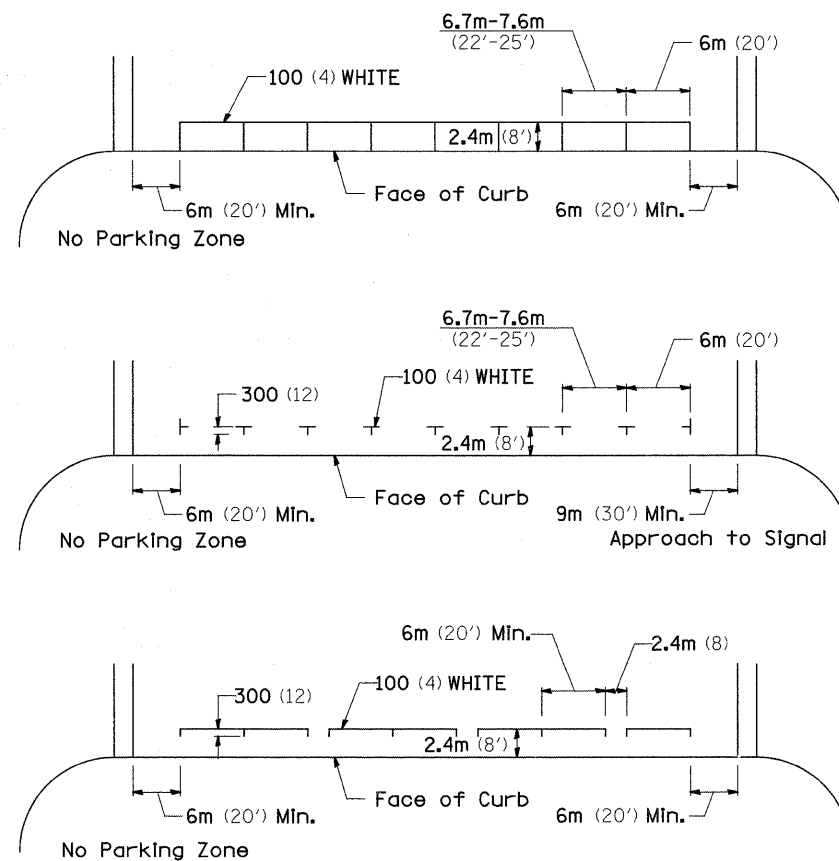

STANDARD CROSSWALK MARKING

See Schedules for Locations

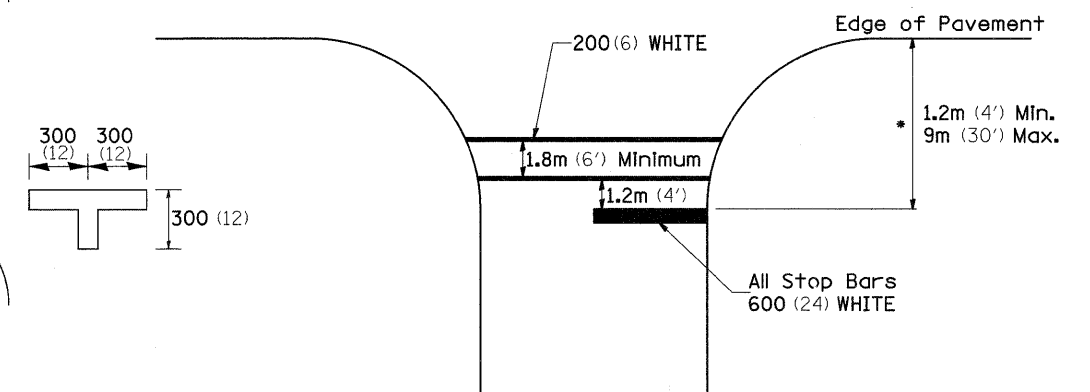

* Distance to the nearest edge of the intersecting roadway in the absence of a marked crosswalk.

FILE NAME =	USER NAME = cushmanbw	DESIGNED -	REVISED - 10-21-08	STATE OF ILLINOIS DEPARTMENT OF TRANSPORTATION	REGION 2 / DISTRICT 2 STANDARD	F.A.P. RTE.	SECTION	COUNTY	TOTAL SHEETS	SHEET NO.
ct:\pw_work\pwwid\cushmanbw\dms51062\0200109-sht-details.dgn	DRAWN -	REVISED -	561			(32-4)M-2	WHITESIDE	34	24	
PLOT SCALE = 50.0000' / IN.	CHECKED -	REVISED -	CONTRACT NO. 64E58							
PLOT DATE = Fri Jan 23 06:59:31 2009	DATE -	REVISED -	FED. ROAD DIST. NO. ILLINOIS FED. AID PROJECT							

TYPICAL PAVEMENT MARKINGS

ARROW LAYOUT

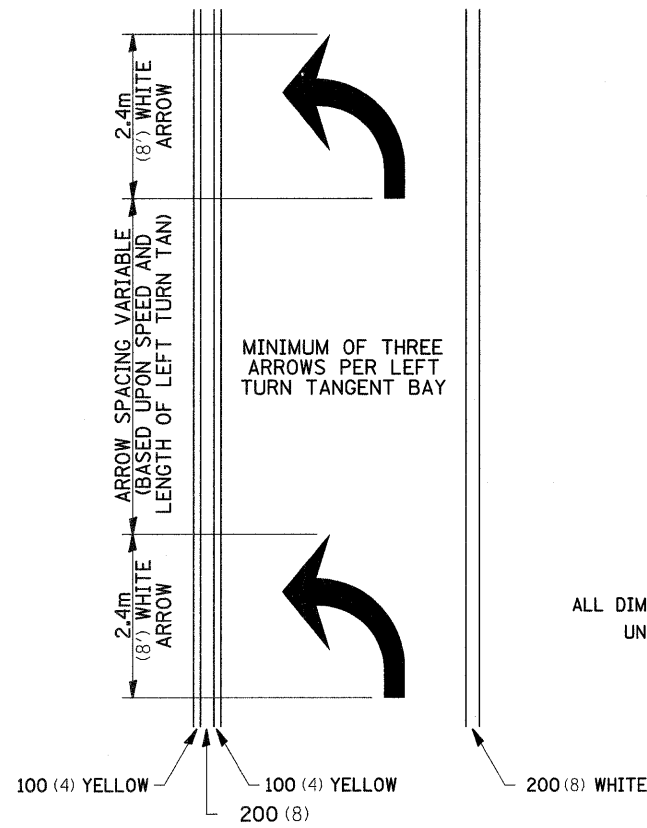

- ◀ ONE-WAY AMBER MARKER
- ◁ ONE-WAY CRYSTAL MARKER
- ◆ TWO-WAY AMBER MARKER

ALL DIMENSIONS ARE IN MILLIMETERS (INCHES) UNLESS OTHERWISE NOTED.

12.2m
6 at (40') O.C.
APPROACH SIDE ONLY

TYPICAL PAVEMENT MARKING FOR FLUSH MEDIAN

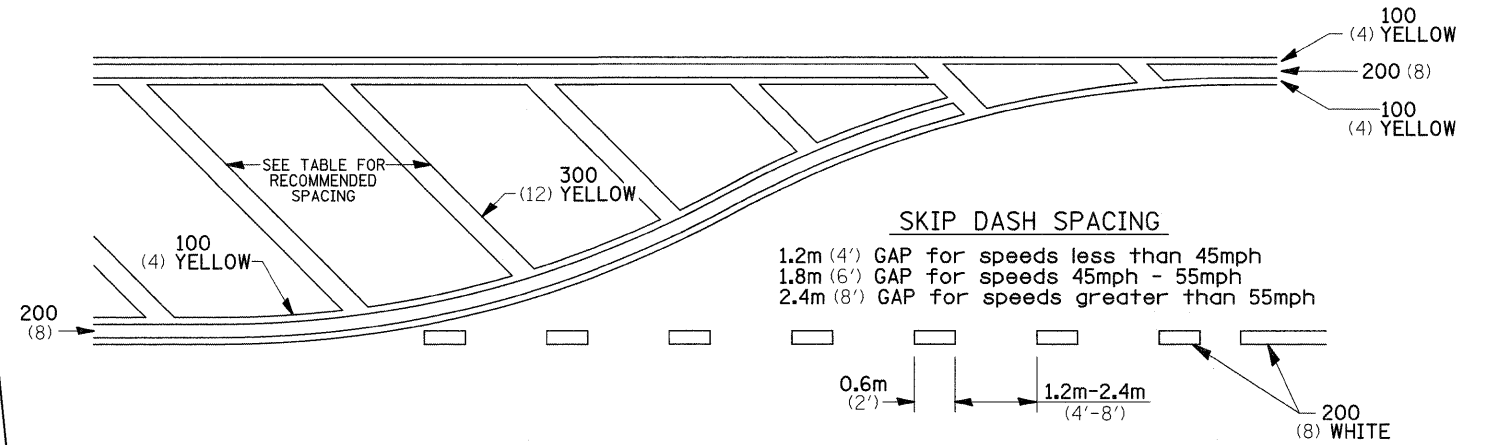

RECOMMENDED SPACING BETWEEN DIAGONALS (IN FEET)

Speed Limit Range	Continuous Median Area	Intersection Channelization	Objects (Islands)
less than 50km/H (30MPH)	15.3m (50')	4.53m (15')	3.05m (10')
50-60km/H (30-40MPH)	22.9m (75')	6.1m (20')	4.53m (15')
70km/H (45MPH) & over	22.9m (75')	9.05m (30')	6.1m (20')

NOTE: If the spacing recommended in the Table does not permit at least five diagonal lines in the area being marked, the spacing from the next lowest speed range should be used. The recommended spacing is measured parallel to the pavement center line.

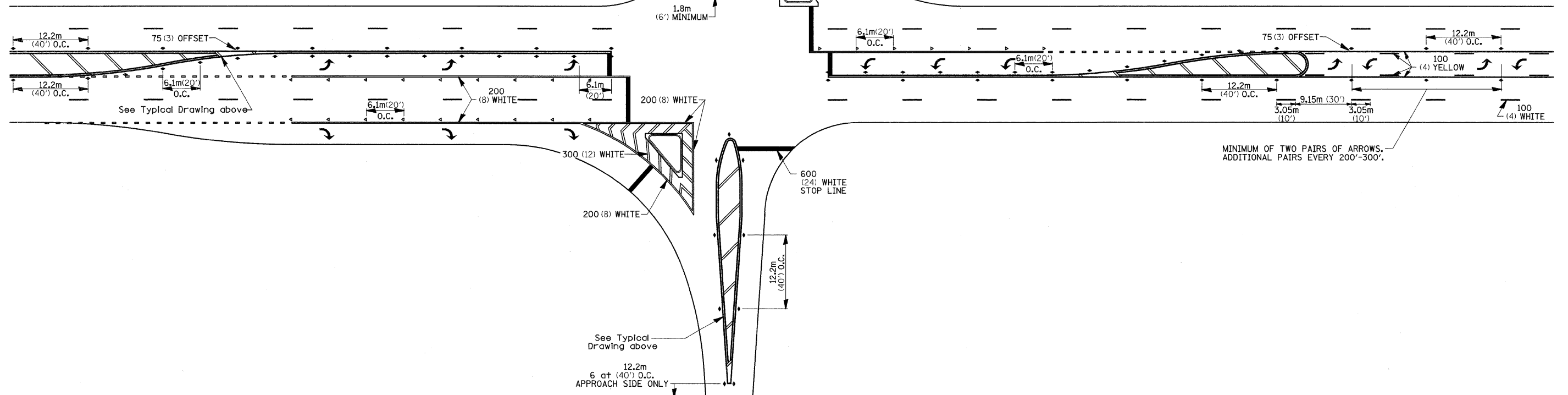

FILE NAME =	USER NAME = cushmanbw	DESIGNED -	REVISED - 10-21-08	STATE OF ILLINOIS DEPARTMENT OF TRANSPORTATION	REGION 2 / DISTRICT 2 STANDARD	F.A.P. RTE.	SECTION	COUNTY	TOTAL SHEETS	SHEET NO.
es:\pw_work\pws\dots\cushmanbw\dms51082\0200109-sht-details.dgn	DRAWN -	REVISED -	561			(32-4M-2)	WHITESIDE	34	25	
PLOT SCALE = 50.0000' / IN.	CHECKED -	REVISED -	CONTRACT NO. 64E58							
PLOT DATE = Fri Jan 23 06:59:32 2009	DATE -	REVISED -	FED. ROAD DIST. NO. ILLINOIS FED. AID PROJECT							
SCALE: SHEET NO. OF SHEETS STA. TO STA.										

TYPICAL PAVEMENT MARKINGS

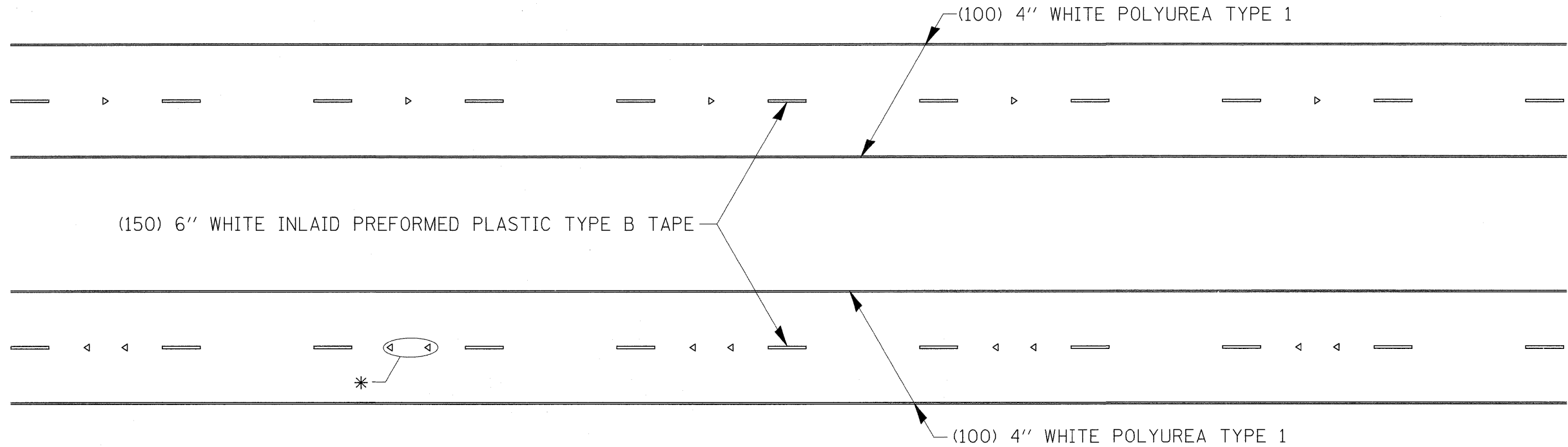

* SEE HIGHWAY STANDARD 781001 FOR SPACING DETAILS.
 USE DOUBLE MARKERS WHEN ADT \geq 25,000.

MULTI-LANE / DIVIDED

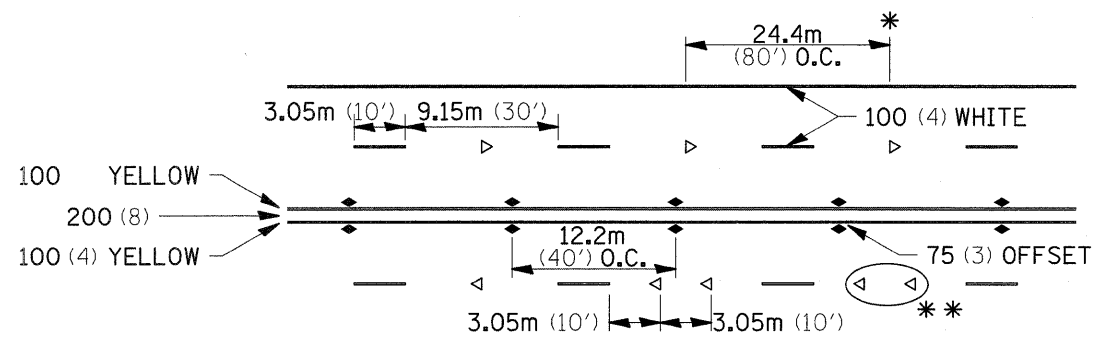

* REDUCE TO 12.2m (40') O.C. ON CURVES WHERE ADVISORY SPEEDS ARE 15Km/H (10MPH) LOWER THAN POSTED SPEEDS.

** USE DOUBLE MARKERS WHEN ADT \geq 25,000

MULTI-LANE / UNDIVIDED

SYMBOLS

TYPICAL PAVEMENT MARKING FOR TWO LANE SECTION – NO PASSING ZONES

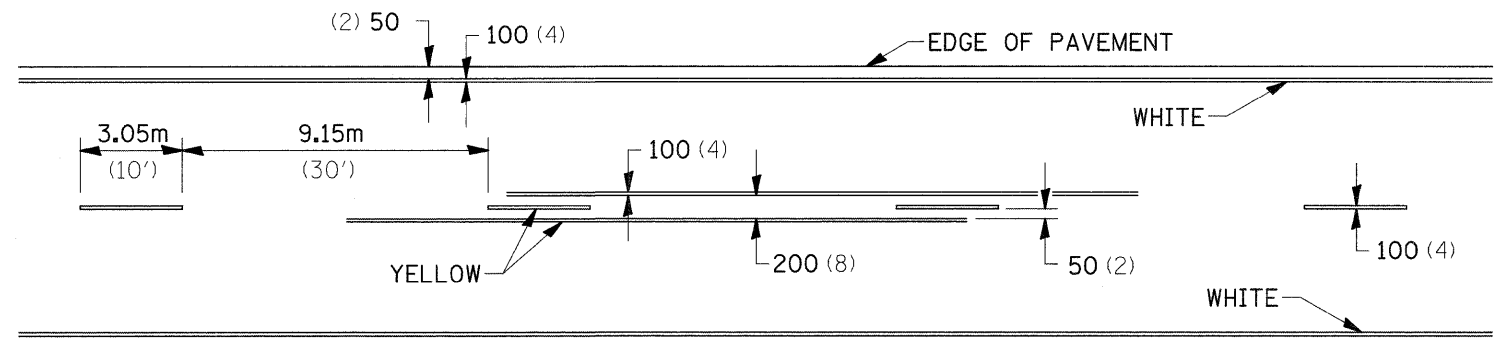

FILE NAME =	USER NAME = cushmanbw	DESIGNED -	REVISED - 10-21-08	STATE OF ILLINOIS DEPARTMENT OF TRANSPORTATION	REGION 2 / DISTRICT 2 STANDARD				F.A.P. RTE.	SECTION	COUNTY	TOTAL SHEETS	SHEET NO.
cd:\pw\work\pw\dot\cushmanbw\dms51082\0200109-sht-details.dgn		DRAWN -	REVISED -		561	(32-4M-2)	WHITESIDE	34	26				
PLOT SCALE = 50.0000' / IN.		CHECKED -	REVISED -		SCALE: SHEET NO. OF SHEETS STA. TO STA.				FED. ROAD DIST. NO.	ILLINOIS FED. AID PROJECT	CONTRACT NO. 64E58		
PLOT DATE = Fri Jan 23 06:59:32 2009		DATE -	REVISED -										

FINAL SURVEY	SURVEYED	BY	DATE
NOTE BOOK	PLOTTED		
AREAS CHECKED	TEMPLATE		
NO.	AREAS CHECKED		

ORIGINAL SURVEY	SURVEYED	BY	DATE
NOTE BOOK	PLOTTED		
AREAS CHECKED	TEMPLATE		
NO.	AREAS CHECKED		

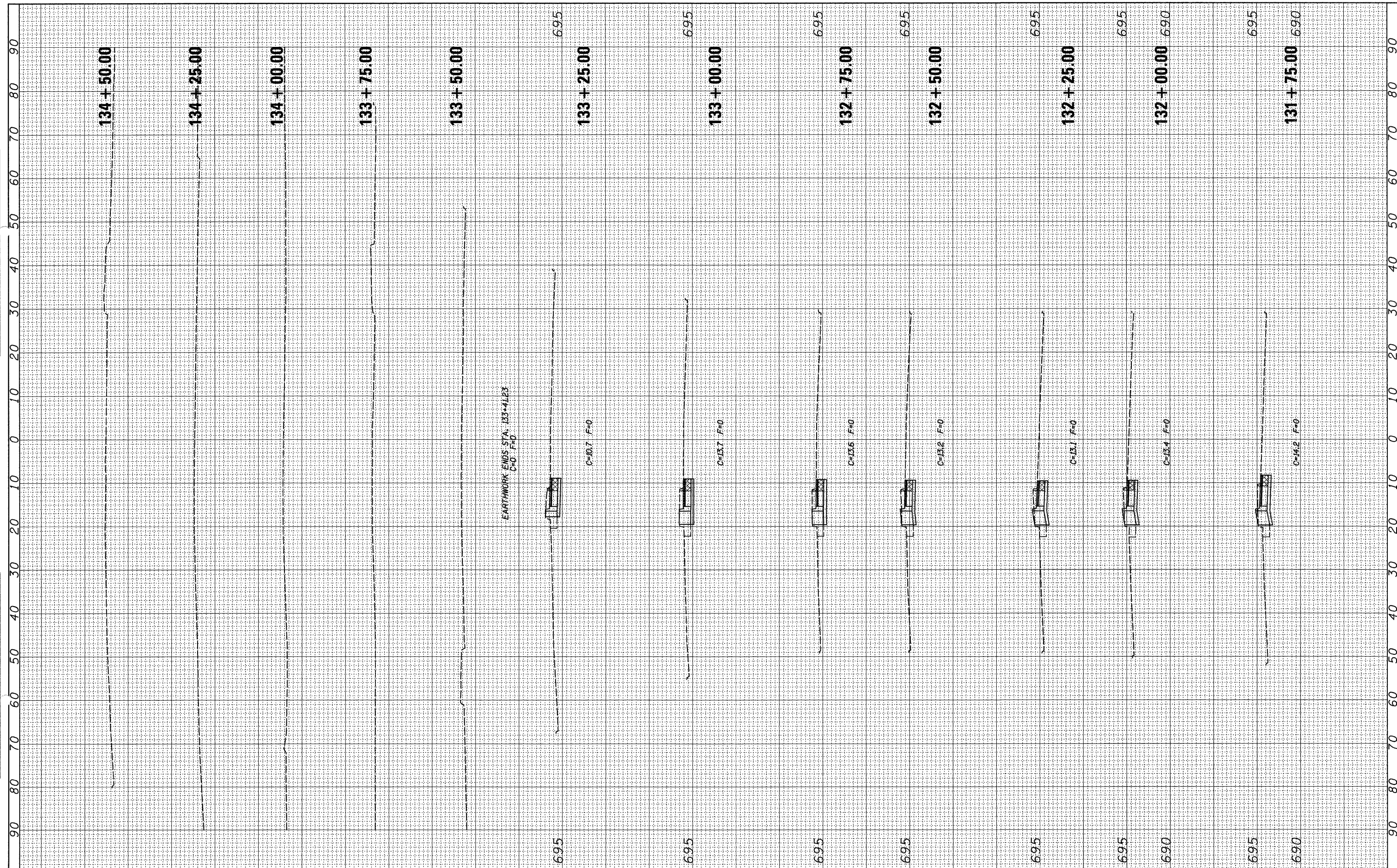

FILE NAME = c:\pwwork\pwwork\cushmenbw\dms51084\0200109-sht-xxsht.dgn

USER NAME = cushmenbw
 PLOT SCALE = 10.0000' / IN.
 PLOT DATE = Thu Jan 22 16:16:17 2009

DESIGNED -
 DRAWN -
 CHECKED -
 DATE -

REVISED -
 REVISED -
 REVISED -
 REVISED -

**STATE OF ILLINOIS
 DEPARTMENT OF TRANSPORTATION**

IL 2

SCALE: SHEET NO. OF SHEETS STA. 131+75.00 TO STA. 134+50.00

F.A.P. RTE. 561	SECTION (32-4)M-2	COUNTY WHITESIDE	TOTAL SHEETS 34	SHEET NO. 28
ILLINOIS FED. AID PROJECT			CONTRACT NO. 64E58	

FINAL SURVEY	SURVEYED	BY	DATE
NOTE BOOK	PLOTTED		
AREAS CHECKED	TEMPLATE		
NO.			

ORIGINAL SURVEY	SURVEYED	BY	DATE
NOTE BOOK	PLOTTED		
AREAS CHECKED	TEMPLATE		
NO.			

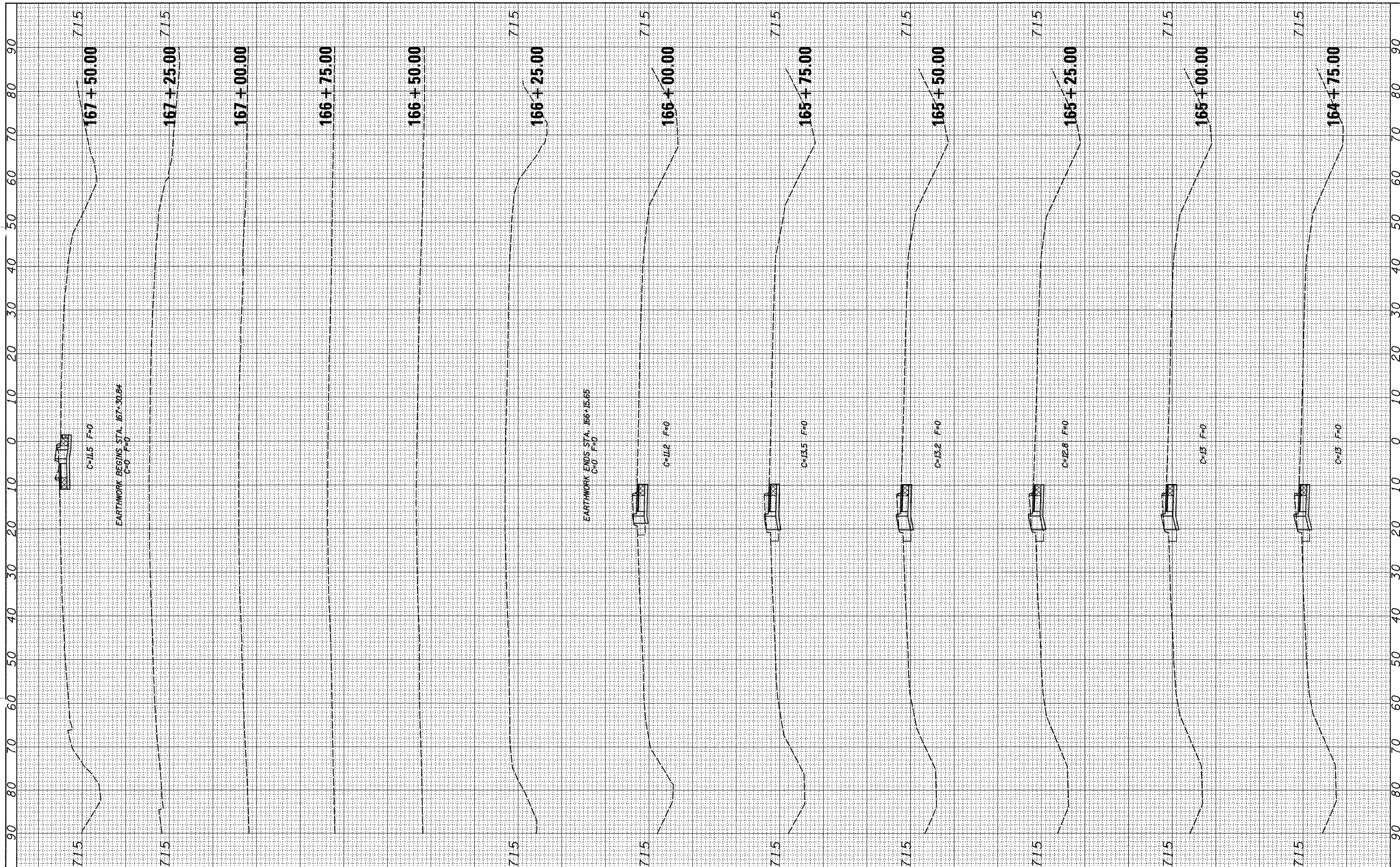

FILE NAME = c:\pwr\work\pwr\dot\cushmanbw\dms51084\2200109-st-xssht.dgn
 USER NAME = cushmanbw
 PLOT SCALE = 10,0000' / IN.
 PLOT DATE = Thu Jan 22 16:16:20 2009

DESIGNED -
 DRAWN -
 CHECKED -
 DATE -

REVISED -
 REVISED -
 REVISED -
 REVISED -

**STATE OF ILLINOIS
 DEPARTMENT OF TRANSPORTATION**

IL 2

SCALE: SHEET NO. OF SHEETS STA. 164+75.00 TO STA. 167+50.00

F.A.P. RTE. 561	SECTION (32-4)M-2	COUNTY WHITESIDE	TOTAL SHEETS 34	SHEET NO. 32
CONTRACT NO. 64E58				
ILLINOIS FED. AID PROJECT				

FINAL SURVEY	SURVEYED	BY	DATE
NOTE BOOK	PLOTTED		
NO.	TEMPLATE		
	AREAS		
	CHECKED		

ORIGINAL SURVEY	SURVEYED	BY	DATE
NOTE BOOK	PLOTTED		
NO.	TEMPLATE		
	AREAS		
	CHECKED		

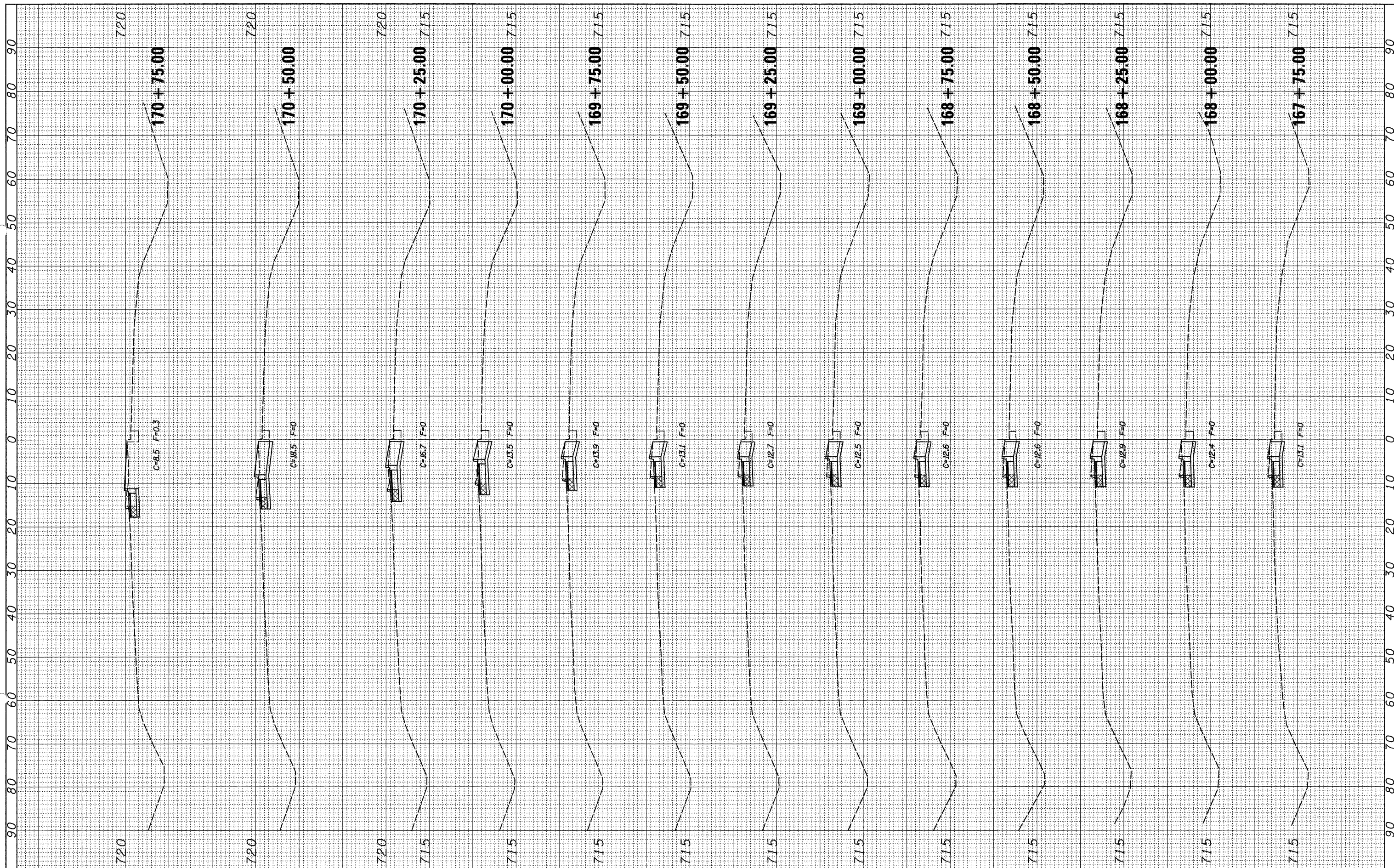

FILE NAME =
 c:\pwwork\p1\dot\cushmanbw\dms51094\200109-sht-xsah.tdgn

USER NAME = cushmanbw
 PLOT SCALE = 10,0000' / IN.
 PLOT DATE = Thu Jan 22 16:16:20 2009

DESIGNED -
 DRAWN -
 CHECKED -
 DATE -

REVISED -
 REVISED -
 REVISED -
 REVISED -

**STATE OF ILLINOIS
 DEPARTMENT OF TRANSPORTATION**

SCALE: SHEET NO. OF SHEETS STA. 167+75.00 TO STA. 170+75.00

IL 2

F.A.P. RTE.	SECTION	COUNTY	TOTAL SHEETS	SHEET NO.
561	(32-4)M-2	WHITESIDE	34	33
CONTRACT NO. 64E58				
ILLINOIS FED. AID PROJECT				

