

ELEVATION SHEETS

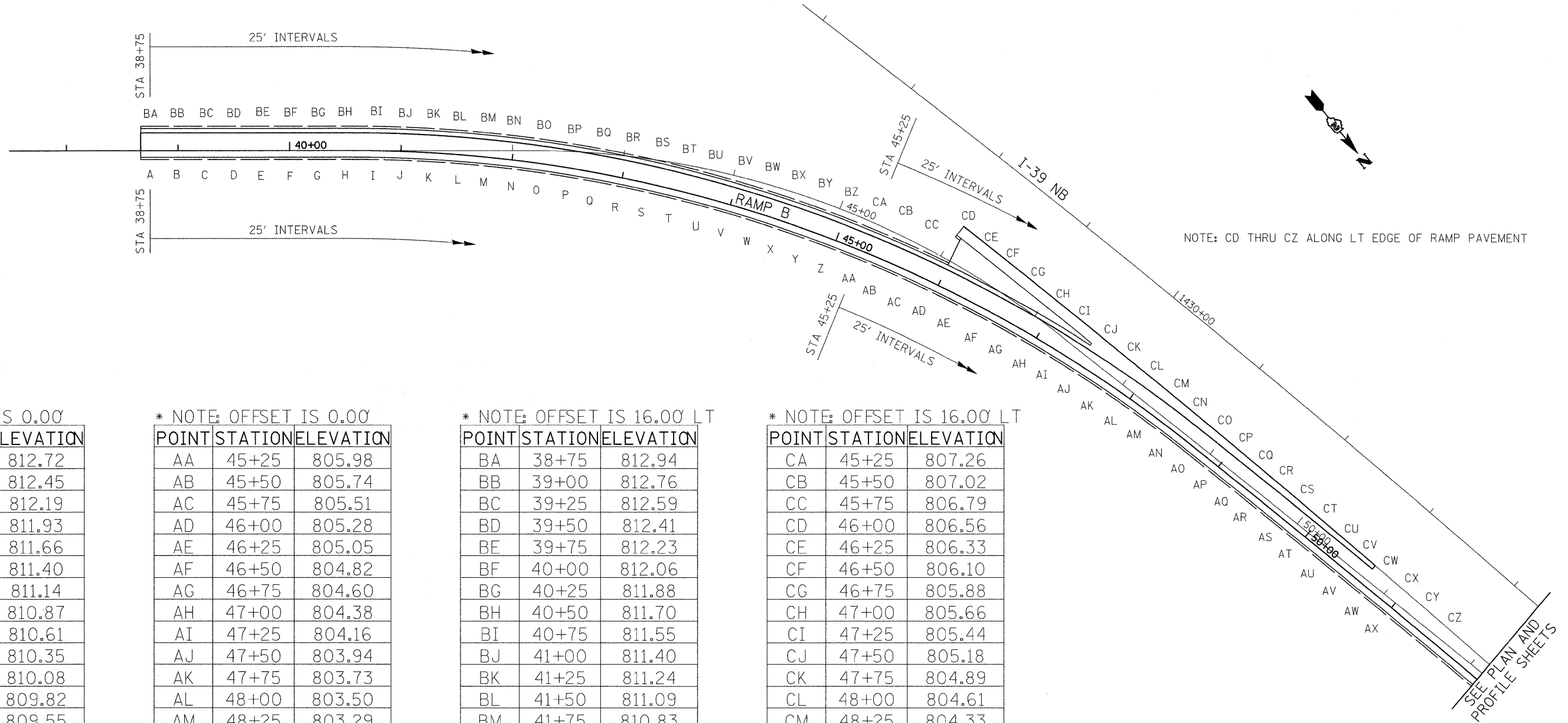

* NOTE: OFFSET IS 0.00

POINT	STATION	ELEVATION
A	38+75	812.72
B	39+00	812.45
C	39+25	812.19
D	39+50	811.93
E	39+75	811.66
F	40+00	811.40
G	40+25	811.14
H	40+50	810.87
I	40+75	810.61
J	41+00	810.35
K	41+25	810.08
L	41+50	809.82
M	41+75	809.55
N	42+00	809.29
O	42+25	809.03
P	42+50	808.76
Q	42+75	808.50
R	43+00	808.24
S	43+25	807.97
T	43+50	807.72
U	43+75	807.46
V	44+00	807.21
W	44+25	806.95
X	44+50	806.71
Y	44+75	806.46
Z	45+00	806.22

* NOTE: OFFSET IS 0.00

POINT	STATION	ELEVATION
AA	45+25	805.98
AB	45+50	805.74
AC	45+75	805.51
AD	46+00	805.28
AE	46+25	805.05
AF	46+50	804.82
AG	46+75	804.60
AH	47+00	804.38
AI	47+25	804.16
AJ	47+50	803.94
AK	47+75	803.73
AL	48+00	803.50
AM	48+25	803.29
AN	48+50	803.07
AO	48+75	802.87
AP	49+00	802.69
AQ	49+25	802.52
AR	49+50	802.34
AS	49+75	802.17
AT	50+00	801.99
AU	50+25	801.82
AV	50+50	801.65
AW	50+75	801.48
AX	51+00	801.33

* NOTE: OFFSET IS 16.00' LT

POINT	STATION	ELEVATION
BA	38+75	812.94
BB	39+00	812.76
BC	39+25	812.59
BD	39+50	812.41
BE	39+75	812.23
BF	40+00	812.06
BG	40+25	811.88
BH	40+50	811.70
BI	40+75	811.55
BJ	41+00	811.40
BK	41+25	811.24
BL	41+50	811.09
BM	41+75	810.83
BN	42+00	810.57
BO	42+25	810.31
BP	42+50	810.04
BQ	42+75	809.78
BR	43+00	809.52
BS	43+25	809.25
BT	43+50	809.00
BU	43+75	808.74
BV	44+00	808.49
BW	44+25	808.23
BX	44+50	807.99
BY	44+75	807.74
BZ	45+00	807.5

* NOTE: OFFSET IS 16.00' LT

POINT	STATION	ELEVATION
CA	45+25	807.26
CB	45+50	807.02
CC	45+75	806.79
CD	46+00	806.56
CE	46+25	806.33
CF	46+50	806.10
CG	46+75	805.88
CH	47+00	805.66
CI	47+25	805.44
CJ	47+50	805.18
CK	47+75	804.89
CL	48+00	804.61
CM	48+25	804.33
CN	48+50	804.04
CO	48+75	803.78
CP	49+00	803.55
CQ	49+25	803.33
CR	49+50	803.10
CS	49+75	802.88
CT	50+00	802.64
CU	50+25	802.42
CV	50+50	802.20
CW	50+75	801.99
CX	51+00	801.89
CY	51+25	801.69
CZ	51+50	801.49