

DATE	
BY	
PLANNED	
DESIGNED	
CHECKED	
DATE	
BY	
PLANNED	
DESIGNED	
CHECKED	
DATE	
BY	

DATE	
BY	
PLANNED	
DESIGNED	
CHECKED	
DATE	
BY	
PLANNED	
DESIGNED	
CHECKED	
DATE	
BY	

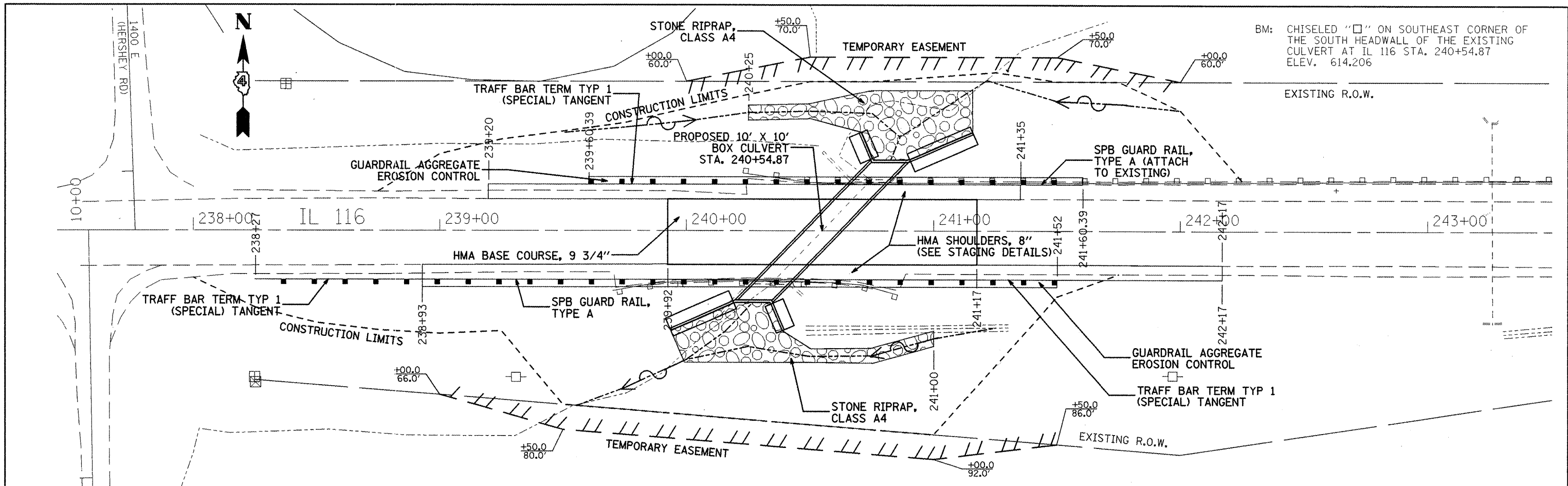

BM: CHISELED "□" ON SOUTHEAST CORNER OF THE SOUTH HEADWALL OF THE EXISTING CULVERT AT IL 116 STA. 240+54.87 ELEV. 614.206

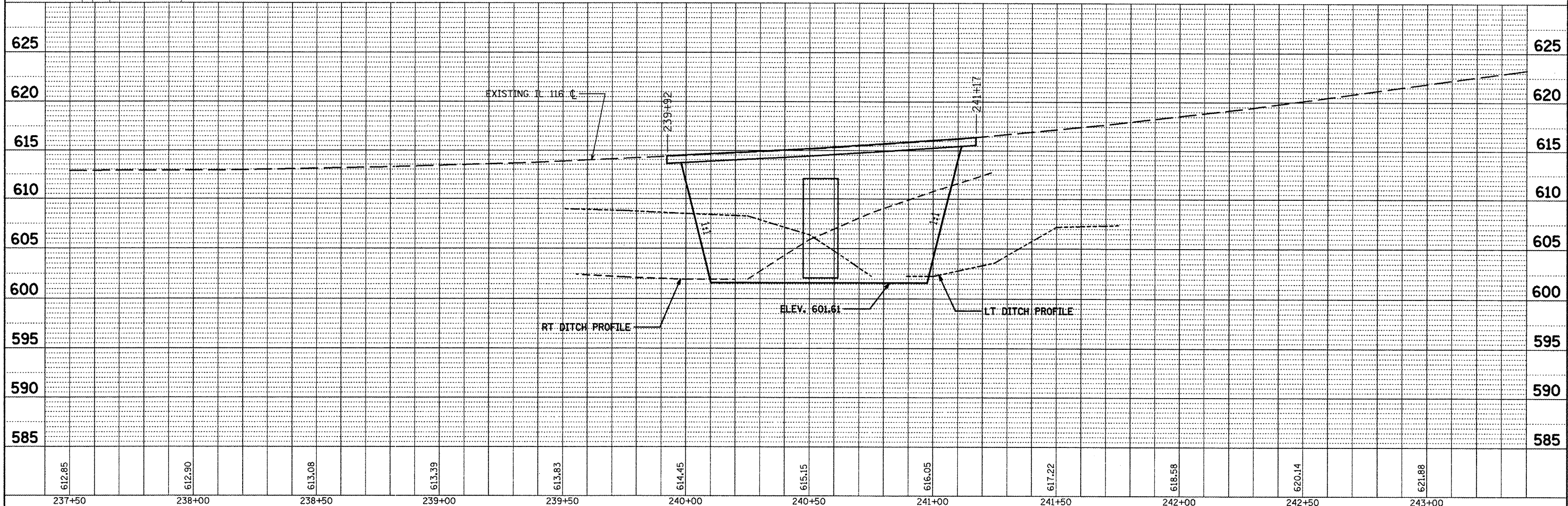

FILE NAME = masterplans (final).dgn	USER NAME = swisher.dh	DESIGNED -	REVISED -	STATE OF ILLINOIS DEPARTMENT OF TRANSPORTATION	IL ROUTE 116 - CULVERT PLAN AND PROFILE	F.A.P. RTE. 665	SECTION 142RS-6; 143CRS-4; (C-8)BR; 142X(C-1)I	COUNTY FULTON	TOTAL SHEETS 76	SHEET NO. 24
PLLOT SCALE = 40.0000' / IN.	CHECKED -	REVISED -	REVISED -			CONTRACT NO. 68353				
PLLOT DATE = 1/29/2009	DATE - 3/27/08	REVISED -	REVISED -			SCALE: SHEET NO. 1 OF 1 SHEETS STA. 237+50 TO STA. 243+40				
FED. ROAD DIST. NO. 4 ILLINOIS FED. AID PROJECT										