

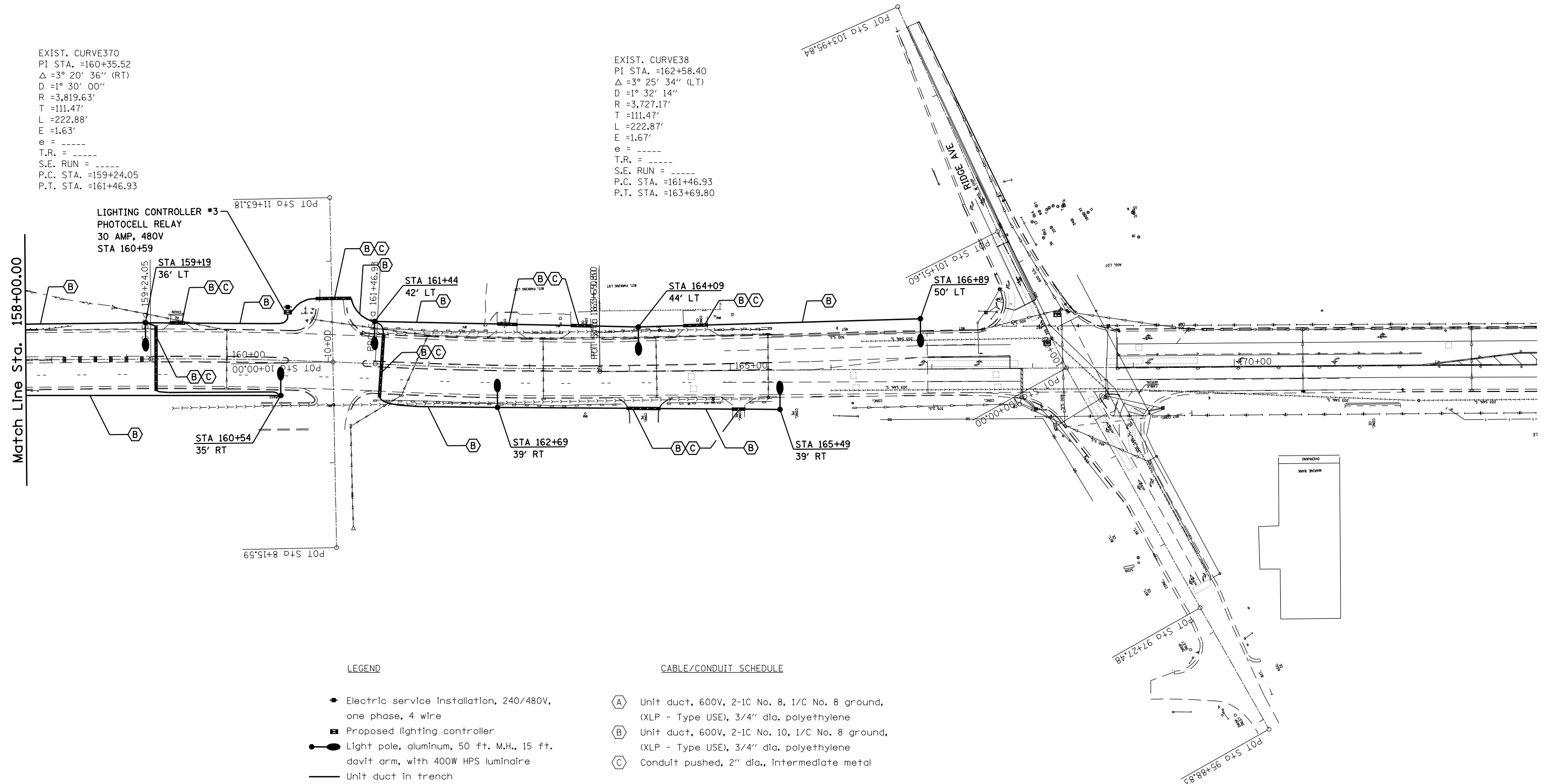

EXIST. CURVE370  
 PI STA. =160+35.52  
 $\Delta = 3^\circ 20' 36''$  (RT)  
 $D = 1^\circ 30' 00''$   
 $R = 3,819.63'$   
 $T = 111.47'$   
 $L = 222.88'$   
 $E = 1.63'$   
 $e = \text{-----}$   
 $T.R. = \text{-----}$   
 $S.E. \text{ RUN} = \text{-----}$   
 $P.C. \text{ STA.} = 159+24.05$   
 $P.T. \text{ STA.} = 161+46.93$

EXIST. CURVE38  
 PI STA. =162+58.40  
 $\Delta = 3^\circ 25' 34''$  (LT)  
 $D = 1^\circ 32' 14''$   
 $R = 3,727.17'$   
 $T = 111.47'$   
 $L = 222.87'$   
 $E = 1.67'$   
 $e = \text{-----}$   
 $T.R. = \text{-----}$   
 $S.E. \text{ RUN} = \text{-----}$   
 $P.C. \text{ STA.} = 161+46.93$   
 $P.T. \text{ STA.} = 163+69.80$



LIGHTING CONTROLLER #3  
 PHOTOCELL RELAY  
 30 AMP, 480V  
 STA 160+59

LEGEND

- ⬤ Electric service installation, 240/480V, one phase, 4 wire
- ⬤ Proposed lighting controller
- Light pole, aluminum, 50 ft. M.H., 15 ft. davit arm, with 400W HPS luminaire
- Unit duct in trench
- - - Unit duct in conduit
- ▬ Conduit pushed

CABLE/CONDUIT SCHEDULE

- (A) Unit duct, 600V, 2-1C No. 8, 1/C No. 8 ground, (XLP - Type USE), 3/4" dia. polyethylene
- (B) Unit duct, 600V, 2-1C No. 10, 1/C No. 8 ground, (XLP - Type USE), 3/4" dia. polyethylene
- (C) Conduit pushed, 2" dia., intermediate metal

|   |                                    |            |           |
|---|------------------------------------|------------|-----------|
| FILE NAME =   | USER NAME = laughlinr1             | DESIGNED - | REVISED - |
| et:\pwork\pwork\LAUGHLINRL\dms76543\672C46-shr-plan_50Scale-2.dgn |                                    | DRAWN -    | REVISED - |
|   | PLOT SCALE = 100.0000' / IN.       | CHECKED -  | REVISED - |
|   | PLOT DATE = Feb-05-2009 02:56:05PM | DATE -     | REVISED - |

STATE OF ILLINOIS  
 DEPARTMENT OF TRANSPORTATION

LIGHTING PLAN

SCALE: SHEET NO. OF SHEETS STA. TO STA.

|                    |         |          |                           |           |
|--------------------|---------|----------|---------------------------|-----------|
| F.A.P. RTE.        | SECTION | COUNTY   | TOTAL SHEETS              | SHEET NO. |
| 668                | 28L-1   | SANGAMON | 20                        | 12        |
| CONTRACT NO. 72C46 |         |          | ILLINOIS FED. AID PROJECT |           |