

TBM 10H-1 DESCRIPTION:
 CHISELED "□" @ TOP CENTER OF CONCRETE HEADWALL FOR
 36" CMP IN NORTHWEST QUADRANT OF BRIDGE #26-0075;
 WEST OF CENTER OF BRIDGE IN NORTH RIGHT-OF-WAY OF I-70
 ASSUMED ELEV.=100.00'

NOTE: REFERENCE CONTROL POINT
 NUMBERS TO FIELD BOOK

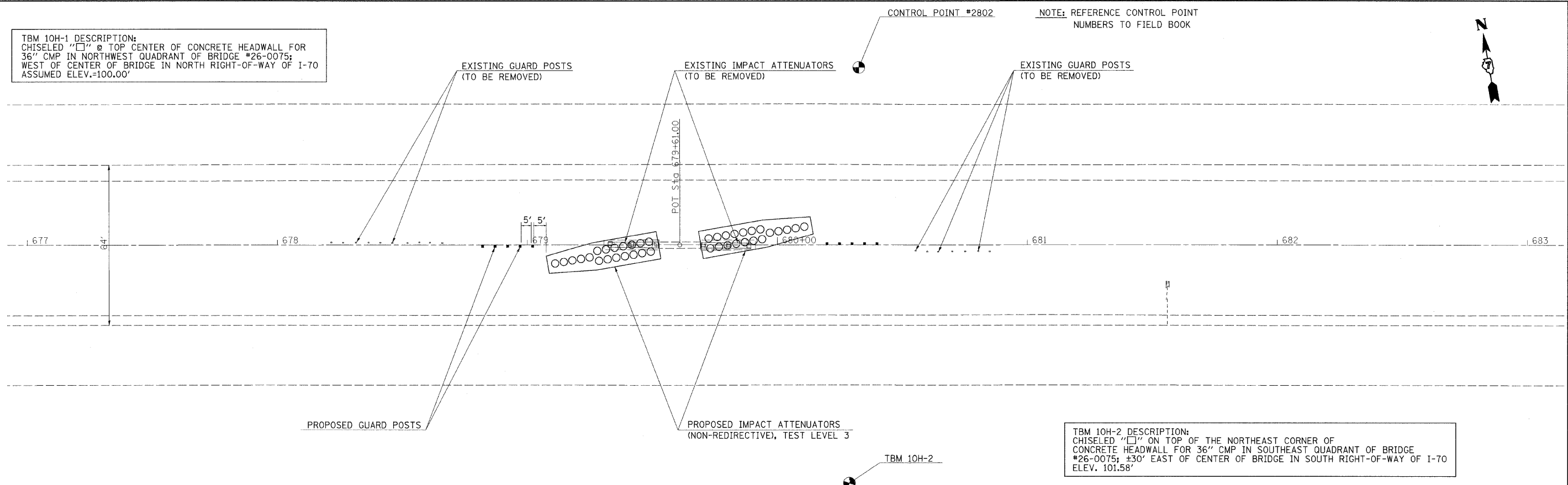

TBM 10H-2 DESCRIPTION:
 CHISELED "□" ON TOP OF THE NORTHEAST CORNER OF
 CONCRETE HEADWALL FOR 36" CMP IN SOUTHEAST QUADRANT OF BRIDGE
 #26-0075; ±30' EAST OF CENTER OF BRIDGE IN SOUTH RIGHT-OF-WAY OF I-70
 ELEV. 101.58'

PLAN	DATE
BY	
DESIGNED	
DRAWN	
CHECKED	
DATE	
FILE NO.	
PROJECT NO.	
STRUCTURE NO.	
DATE	

PROFILE	DATE
BY	
DESIGNED	
DRAWN	
CHECKED	
DATE	
FILE NO.	
PROJECT NO.	
STRUCTURE NO.	
DATE	

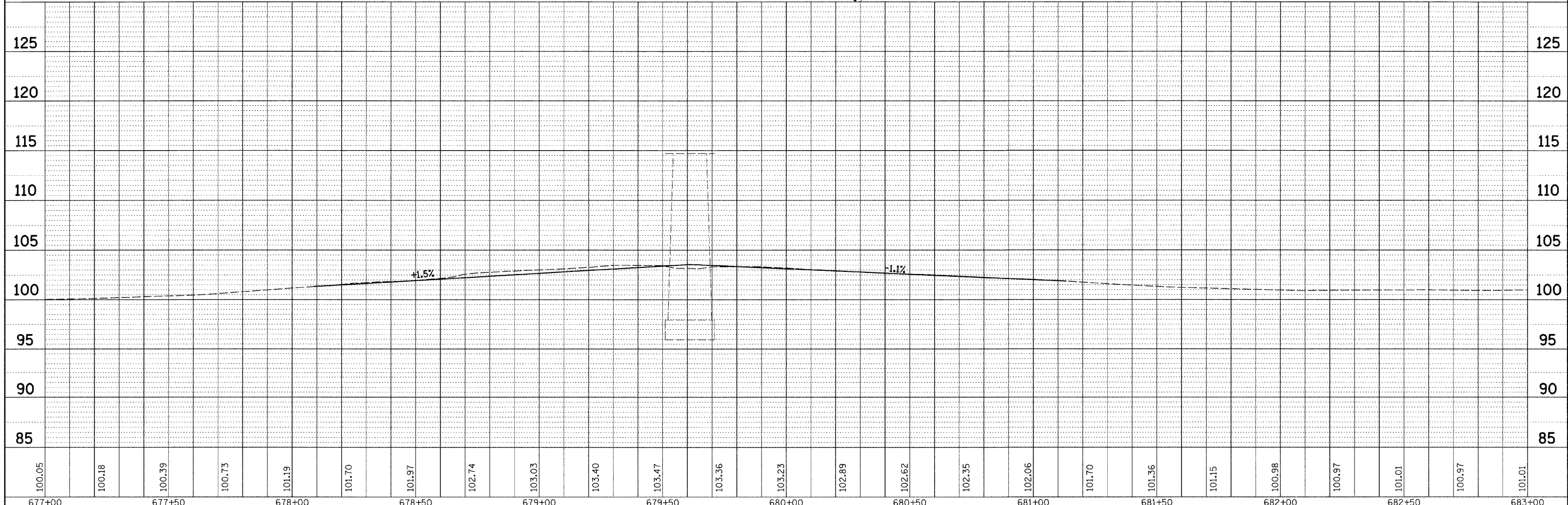

FILE NAME =	USER NAME = swartzw	DESIGNED -	REVISED -	STATE OF ILLINOIS DEPARTMENT OF TRANSPORTATION	PLAN PROFILE 026-0075	F.A.I. RTE.	SECTION	COUNTY	TOTAL SHEETS	SHEET NO.	
c:\pwwork\pwwork\swartzw\dms50720\shp&	20_74313.dgn	DRAWN -	REVISED -			70	D-7 SAFETY 2009-1	FAYETTE	100	23	
PLOT SCALE = 20.0000' / IN.		CHECKED -	REVISED -			CONTRACT NO. 74313					
PLOT DATE = 1/20/2009		DATE -	REVISED -			FED. ROAD DIST. NO. ILLINOIS FED. AID PROJECT					