

**STATE OF ILLINOIS
DEPARTMENT OF TRANSPORTATION
DIVISION OF HIGHWAYS**

PLANS FOR PROPOSED IMPROVEMENT

**T.R. 389A (THOMPSON MILL ROAD)
SECTION D-7 BRIDGE APPROACH 2009-1
PROJECT : ACNHCB-0173(165)
SHELBY COUNTY
THOMPSON MILL COVERED BRIDGE
STRUCTURE NO. 087-0019
C-97-104-08
REPLACE APPROACH SPANS**

T.R. RTE.	SECTION	COUNTY	TOTAL SHEETS	SHEET NO.
389A	D-7 Bridge Appr. 2009-1	SHELBY	14	1
FED. ROAD DIST. NO.	ILLINOIS	CONTRACT NO. 74337		

D-97-054-08

INDEX OF SHEETS

- 1 COVER SHEET
- 2 SUMMARY OF QUANTITIES & GENERAL NOTES
- 3-14 STRUCTURE PLANS

HIGHWAY STANDARDS

- 280001-04 TEMPORARY EROSION CONTROL SYSTEMS
- 701801-04 LANE CLOSURE MULTILANE 1W OR 2W CROSSWALK OR SIDEWALK CLOSURE
- 701901-01 TRAFFIC CONTROL DEVICES

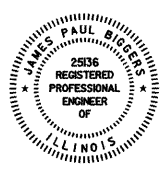
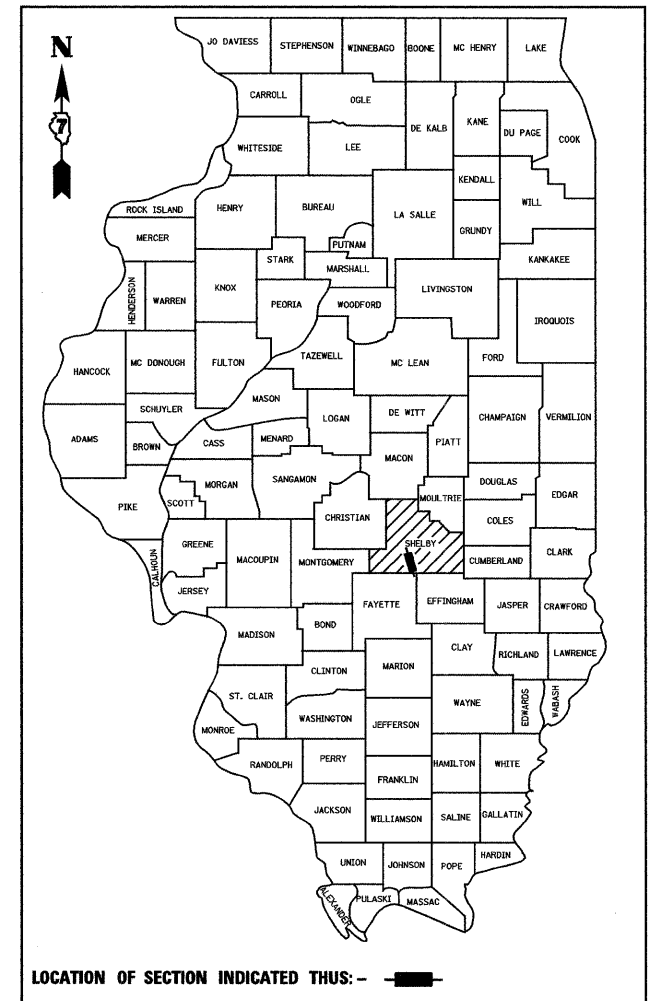

James Paul Biggers
JAMES PAUL BIGGERS, P.E.
DATE 02/01/09
LICENSE EXPIRES 11/30/09

PLANS PREPARED BY:



JOHNSON, DEPP & QUISENBERRY
CONSULTING ENGINEERS

6450 South Sixth Street Road, Suite B Springfield, Illinois 62712
Phone: (217) 529-4534 Fax: (217) 529-8278

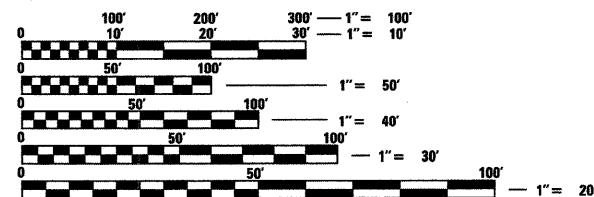

FULL SIZE PLANS HAVE BEEN PREPARED USING STANDARD ENGINEERING SCALES. REDUCED SIZED PLANS WILL NOT CONFORM TO STANDARD SCALES. IN MAKING MEASUREMENTS ON REDUCED PLANS, THE ABOVE SCALES MAY BE USED.

J.U.L.I.E.
JOINT UTILITY LOCATION INFORMATION FOR EXCAVATION
1-800-892-0123
OR 811

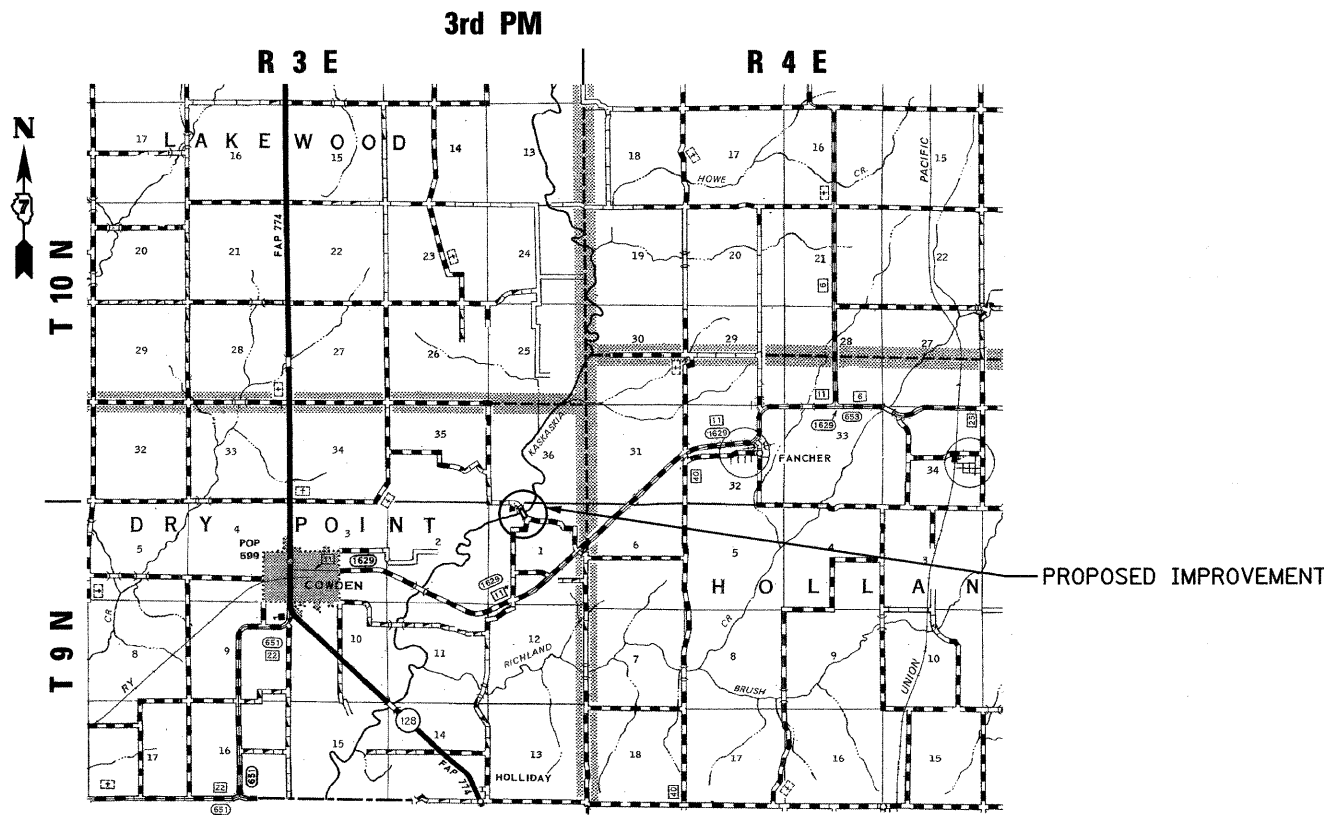

LOCATION MAP



STATE OF ILLINOIS
DEPARTMENT OF TRANSPORTATION
DIVISION OF HIGHWAYS

SUBMITTED February 11, 20 09

Roger L. Shubert
DEPUTY DIRECTOR OF HIGHWAYS, REGION ENGINEER

March 27, 20 09
Charles J. Ingersoll
ENGINEER OF DESIGN AND ENVIRONMENT

March 27, 20 09
Christie M. Reed
DIRECTOR OF HIGHWAYS, CHIEF ENGINEER

**PRINTED BY THE AUTHORITY
OF THE STATE OF ILLINOIS**

02/03/2009 14:58:33 ...:\D774337-sh1-cover.dgn

**PROJECT ENGINEER: THOMAS RONAN (217)342-8320
SQUAD LEADER: JENNIFER WENTHE (217)342-8361
CONTRACT NO. 74337**