

PROP. CURVE EFR-1  
 PI STA. = 13+71.04  
 $\Delta = 3^\circ 02' 40''$  (RT)  
 $D = 2^\circ 51' 53''$   
 $R = 2,000.00'$   
 $T = 53.15'$   
 $L = 106.27'$   
 $E = 0.71'$   
 $e = NC$   
 $T.R. = N/A$   
 $S.E. RUN = N/A$   
 $P.C. STA. = 13+17.89$   
 $P.T. STA. = 14+24.16$

PROP. CURVE EFR-2  
 PI STA. = 25+68.57  
 $\Delta = 45^\circ 16' 03''$  (RT)  
 $D = 4^\circ 24' 27''$   
 $R = 1,300.00'$   
 $T = 542.04'$   
 $L = 1,027.09'$   
 $E = 108.48'$   
 $e = NC$   
 $T.R. = N/A$   
 $S.E. RUN = N/A$   
 $P.C. STA. = 20+26.54$   
 $P.T. STA. = 30+53.62$

NOTE:  
 1. ALL DIMENSIONS, STATIONS AND OFFSETS ARE TO THE EDGE OF PAVEMENT UNLESS OTHERWISE NOTED.

PLAN	DESIGNED	DATE
	NOTED	
	ALIGNED	
	CHECKED	
	PLOTTED	
	FILE NAME	
	NO.	

PROFILE	DESIGNED	DATE
	NOTED	
	GRADES	
	CHECKED	
	STRUCTURE	
	NOTATION	
	CHKD	
	NO.	

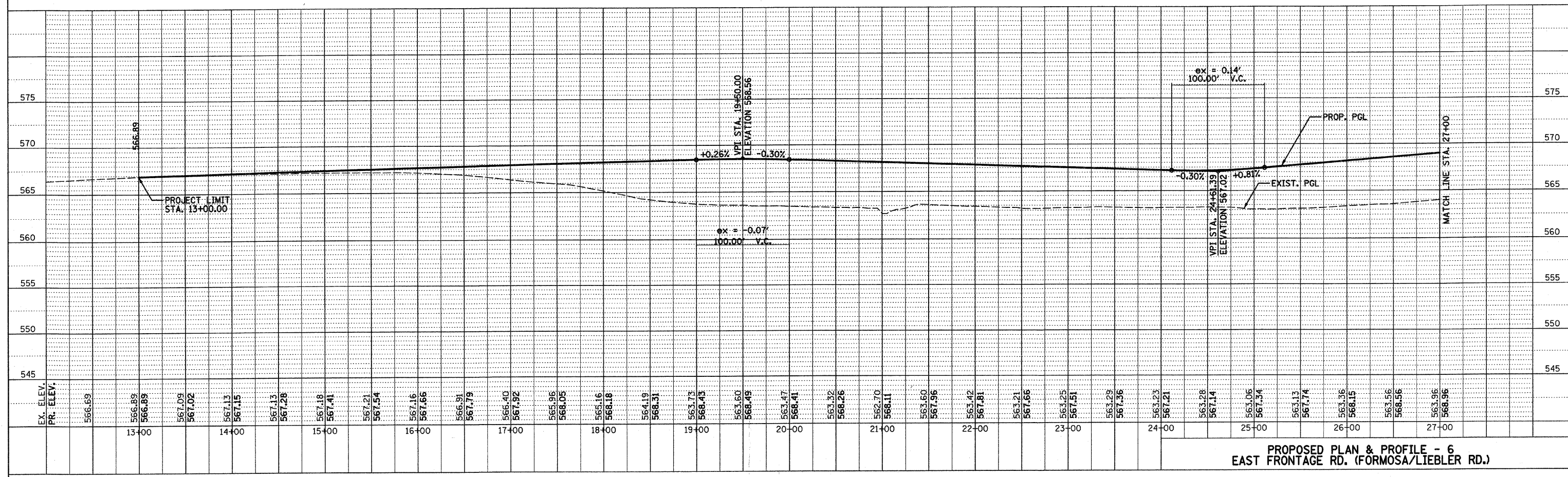

**PROPOSED PLAN & PROFILE - 6**  
**EAST FRONTAGE RD. (FORMOSA/LIEBLER RD.)**

\*NON-SPEC\*  
 \*REF- 236c0101.dgn  
 \*REF- 236c0101.dgn  
 \*REF- 236c0101.dgn  
 \*REF- 236c0101.dgn  
 \*REF- 236c0101.dgn