

FAP ROUTE	SECTION	COUNTY	TOTAL SHEETS	SHEET NO
70	*	MADISON	420	68
STA. TO STA.				
CONTRACT NO.: T6709				
* 60-10K-1,60-10HB				



PLAN	SURVEYED	DATE
	PLOTTED	
	CHECKED	
	BY	
	NO. OF WAY CHECKED	
	ADD FILE NAME	

**LEGEND**

- EXISTING OR NEW PAVEMENT USED FOR MAINTENANCE OF TRAFFIC
- CONSTRUCTION LIMITS DURING STAGE
- DIRECTION OF TRAFFIC ARROW
- NEW PAVEMENT
- TEMPORARY PAVEMENT
- TEMPORARY TRAFFIC SIGN

**IL. ROUTE 162**

STAGE I TRAFFIC

1. CONSTRUCT TEMPORARY PAVEMENT ALONG SOUTH SIDE OF IL 162.
2. IL. ROUTE 162 TRAFFIC USES SOUTH SIDE OF IL. 162 AND TEMPORARY PAVEMENT.

STAGE I CONSTRUCTION

1. CONSTRUCT WESTBOUND LANES FOR IL. 162.

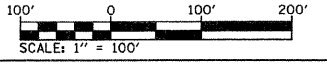

REVISIONS	
NAME	DATE

ILLINOIS DEPARTMENT OF TRANSPORTATION  
**MAINTENANCE OF TRAFFIC - 7**  
**STAGE I PLAN VIEW**  
 FAP ROUTE 70  
 SECTION 60-10K-1, 60-10HB  
 MADISON COUNTY

DRAWN BY: HJB

PLOT DATE: \*DATE-TIME\*

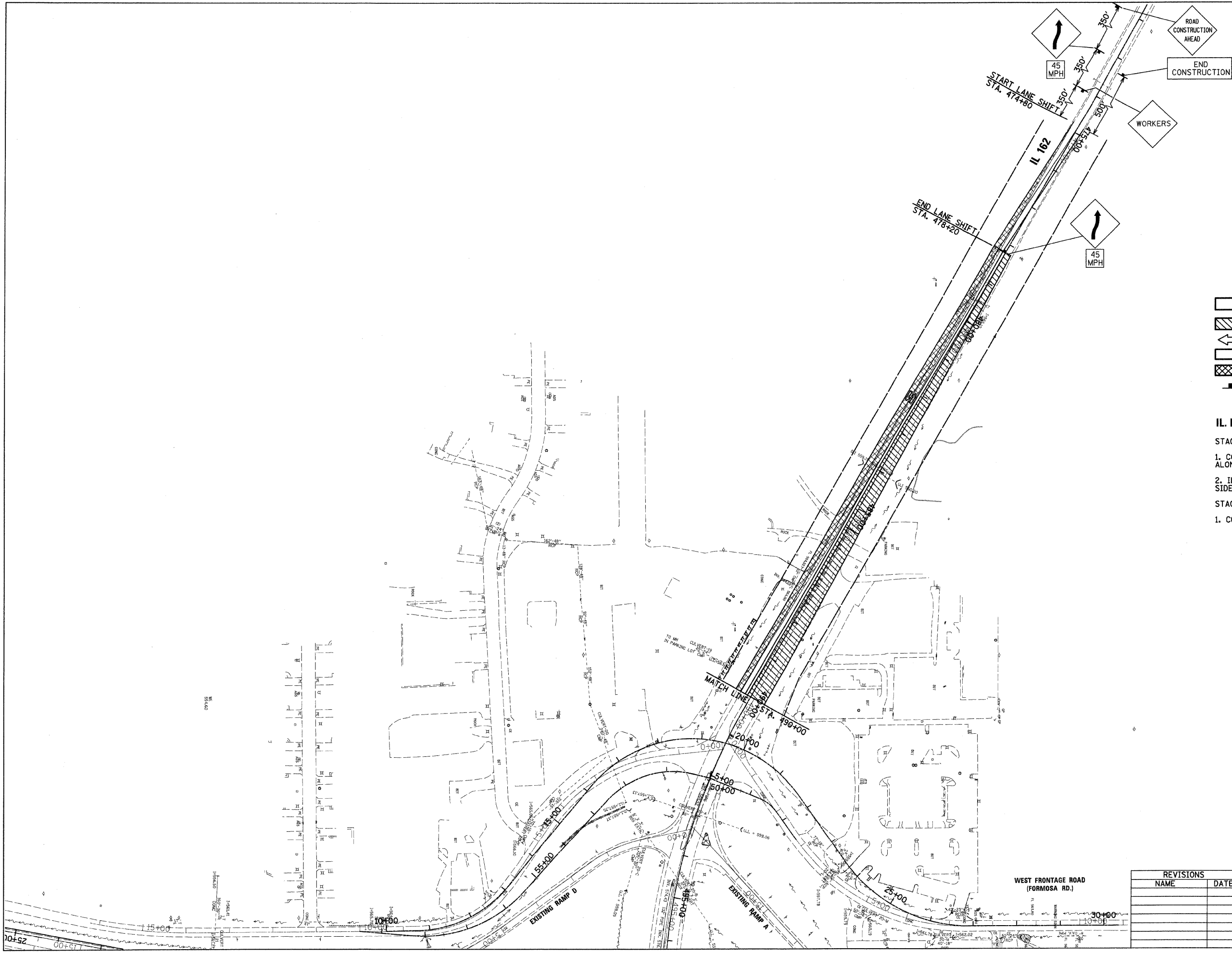

\*DATE-TIME\*  
 \*DIRN-SPEC\*  
 \*REF\*