

FAP ROUTE	SECTION	COUNTY	TOTAL SHEETS	SHEET NO
70	*	MADISON	420	76
STA. TO STA.		CONTRACT NO.: 76709 * 60-10K-1,60-10HB		



**LEGEND:**

- EXISTING OR NEW PAVEMENT USED FOR MAINTENANCE OF TRAFFIC
- CONSTRUCTION LIMITS DURING STAGE
- DIRECTION OF TRAFFIC ARROW
- NEW PAVEMENT
- TEMPORARY PAVEMENT
- TEMPORARY TRAFFIC SIGN

**IL ROUTE 162**

**STAGE III TRAFFIC**

1. TRAFFIC USES WESTBOUND LANES DURING CONSTRUCTION OF EASTBOUND LANES, EAST OF STA. 490+00.

PLAN	SURVEYED	DATE
NOTE BOOK NO.	PLOTTED	BY
	RT. OF WAY CHECKED	
	PAID FILE NAME	

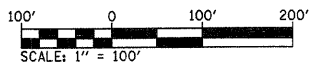
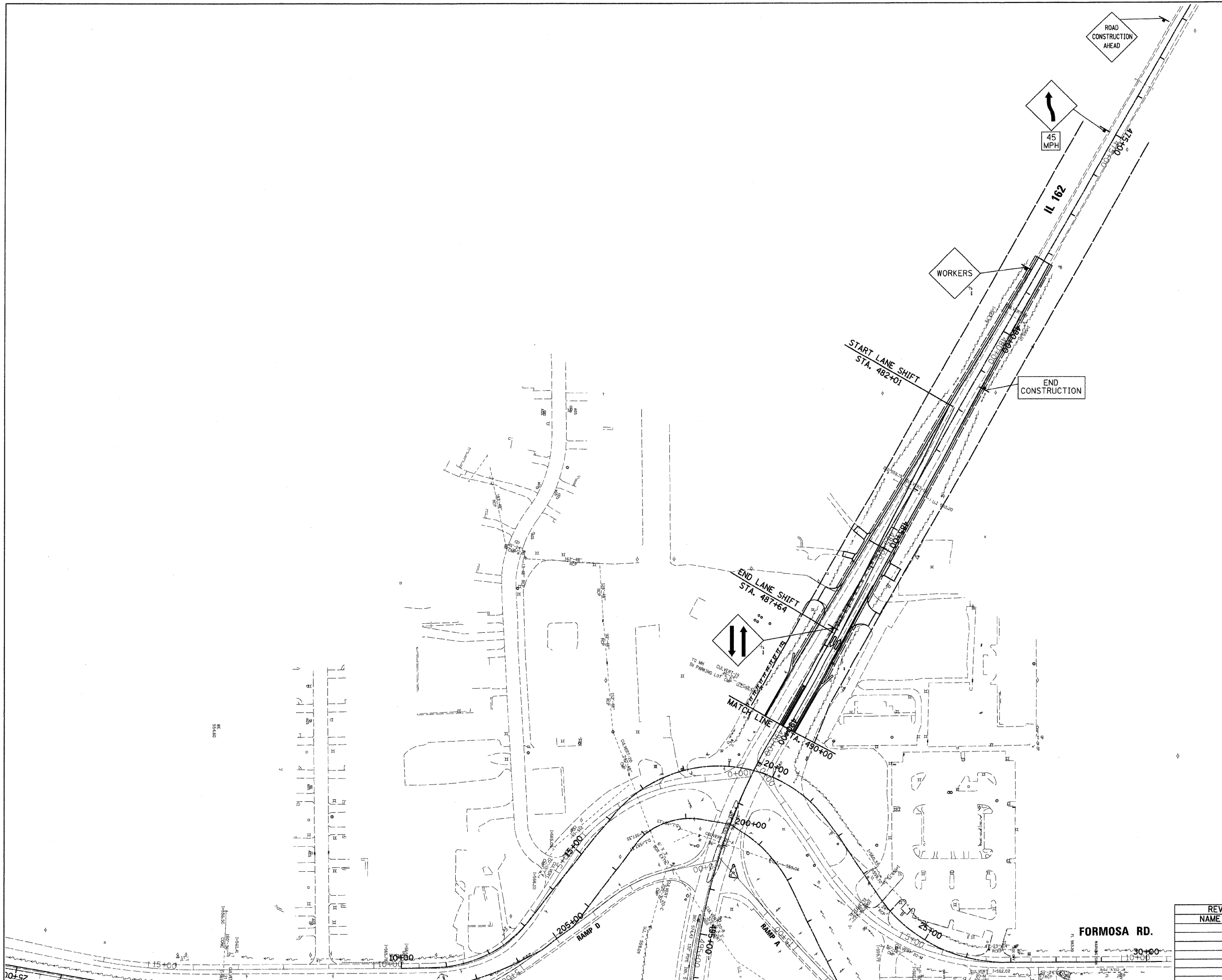

ILLINOIS DEPARTMENT OF TRANSPORTATION  
**MAINTENANCE OF TRAFFIC - 15**  
**STAGE III PLAN VIEW**

FAP ROUTE 70  
SECTION 60-10K-1, 60-10HB  
MADISON COUNTY

DRAWN BY: HJB  
PLOT DATE: \*DATE-TIME\*

REVISIONS	
NAME	DATE

\*DATE-TIME\*  
\*DON-SPEC\*  
\*REF\*  
\*REF\*