

FAP ROUTE	SECTION	COUNTY	TOTAL SHEETS	SHEET NO
70		MADISON	420	80
STA.		TO STA.		
CONTRACT NO.: 76709				
• 60-10K-1, 60-10HB				



NOTE 1
FROM STA. 204+05 @ 4.49%
TRANSITION TO 2.0% AT STA. 203+20.

PROP. CURVE TD-1
PI STA. = 201+55.23
 $\Delta = 63^\circ 00' 32''$ (LT)
D = 38' 11" 50"
R = 150.00'
T = 91.94'
L = 164.96'
E = 25.93'
P.C. STA = 200+63.29
P.T. STA = 202+28.25

Sta. 492+50.00 Prop IL 162 =
Sta. 200+00 Temp Ramp D =
Sta. 64+78.65 Temp Ramp A =

PROP. CURVE TA-3
PI STA. = 63+57.35
 $\Delta = 28^\circ 20' 00''$ (LT)
D = 19' 05' 55"
R = 300.00'
T = 75.73'
L = 148.35'
E = 9.41'
P.C. STA = 62+81.62
P.T. STA = 64+29.98

PROP. CURVE TD-3
PI STA. = 212+87.22
 $\Delta = 8^\circ 15' 23''$ (RT)
D = 3' 49' 11"
R = 1,500.00'
T = 108.26'
L = 216.15'
E = 3.90'
P.C. STA = 211+78.96
P.T. STA = 213+95.11

Sta. 214+27.45 Temp Ramp D =
Sta. 27+00 Prop Ramp D, 1' Lt.

PROP. CURVE TD-2
PI STA. = 207+37.76
 $\Delta = 26^\circ 54' 58''$ (RT)
D = 9' 32' 57"
R = 600.00'
T = 143.58'
L = 281.87'
E = 16.94'
P.C. STA = 205+94.18
P.T. STA = 208+76.05

PLAN	DATE
BY	
REVISIONS	
NO.	

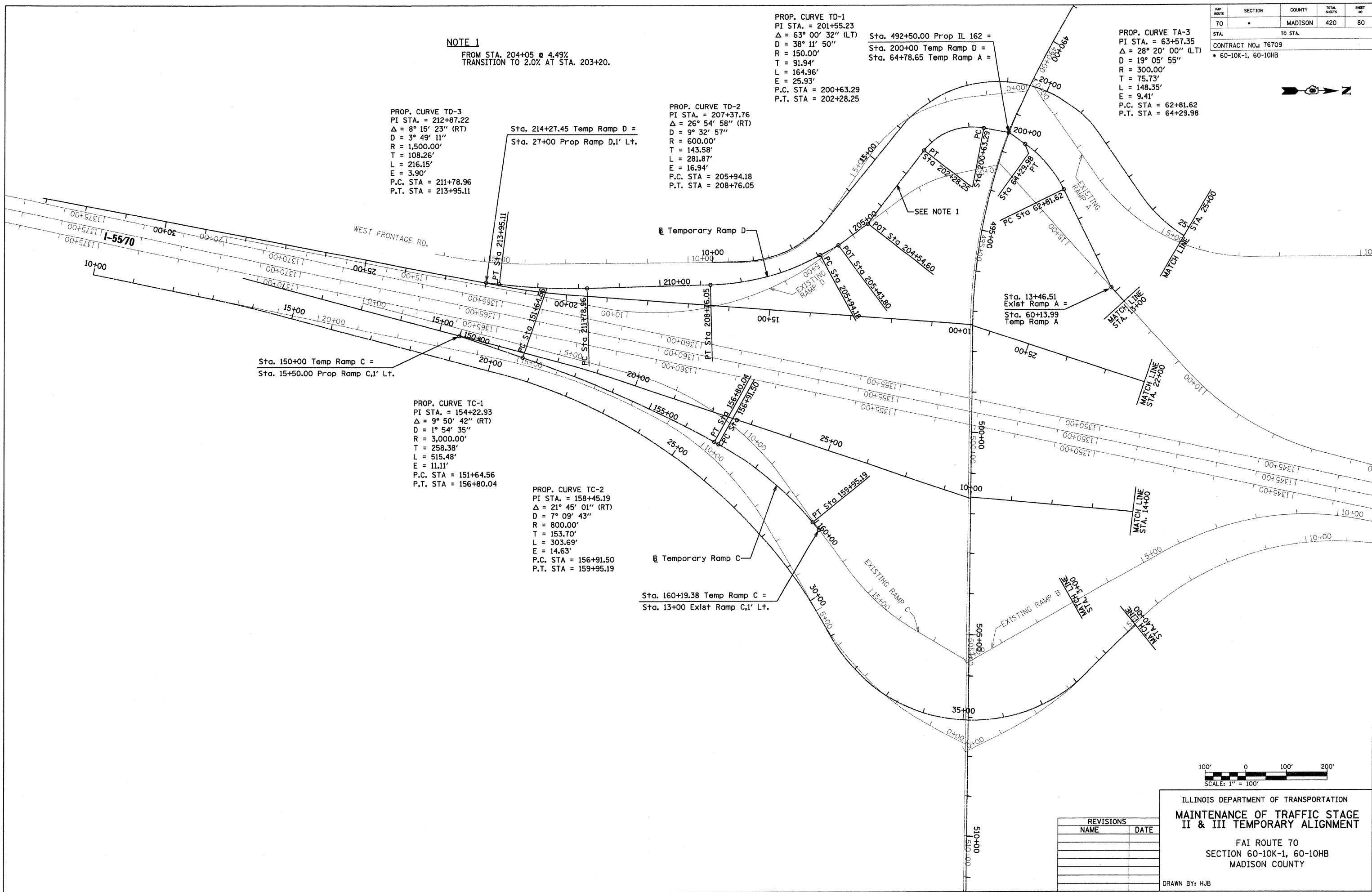

Sta. 150+00 Temp Ramp C =
Sta. 15+50.00 Prop Ramp C, 1' Lt.

PROP. CURVE TC-1
PI STA. = 154+22.93
 $\Delta = 9^\circ 50' 42''$ (RT)
D = 1' 54' 35"
R = 3,000.00'
T = 258.38'
L = 515.48'
E = 11.11'
P.C. STA = 151+64.56
P.T. STA = 156+80.04

PROP. CURVE TC-2
PI STA. = 158+45.19
 $\Delta = 21^\circ 45' 01''$ (RT)
D = 7' 09' 43"
R = 800.00'
T = 153.70'
L = 303.69'
E = 14.63'
P.C. STA = 156+91.50
P.T. STA = 159+95.19

Sta. 160+19.38 Temp Ramp C =
Sta. 13+00 Exist Ramp C, 1' Lt.

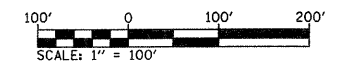

REVISIONS	
NAME	DATE

ILLINOIS DEPARTMENT OF TRANSPORTATION
MAINTENANCE OF TRAFFIC STAGE II & III TEMPORARY ALIGNMENT
FAI ROUTE 70
SECTION 60-10K-1, 60-10HB
MADISON COUNTY
DRAWN BY: HJB
PLOT DATE: *DATE-TIME*

DATE-TIME
DATE-TIME
REF-