

FAP ROUTE	SECTION	COUNTY	TOTAL SHEETS	SHEET NO.
TO	*	MADISON	420	88
STA.	TO STA.			
CONTRACT NO.: 76709				
* 60-10K-1, 60-10HB				



PLAN	SURVEYED	DATE
NOTE BOOK NO.	PLOTTED	
	CHECKED	
	BY	
	DATE	
	NO. OF WAY CHECKED	
	CADD FILE NAME	

LEGEND:

- EXISTING OR NEW PAVEMENT USED FOR MAINTENANCE OF TRAFFIC
- CONSTRUCTION LIMITS DURING STAGE
- DIRECTION OF TRAFFIC ARROW
- NEW PAVEMENT
- TEMPORARY PAVEMENT
- TEMPORARY DITCH CHECK
- EROSION CONTROL BLANKET
- PERIMETER EROSION BARRIER
- INLET AND PIPE PROTECTION

NOTES:

1. FOR MORE TEMPORARY EROSION CONTROL INFORMATION, SEE STORM WATER POLLUTION PREVENTION PLANS.
2. USE EROSION CONTROL BLANKET WITH TEMPORARY EROSION CONTROL SEEDING FOR LINING DITCHES WITH SIDESLOPES STEEPER THAN 3:1.

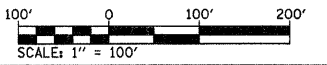
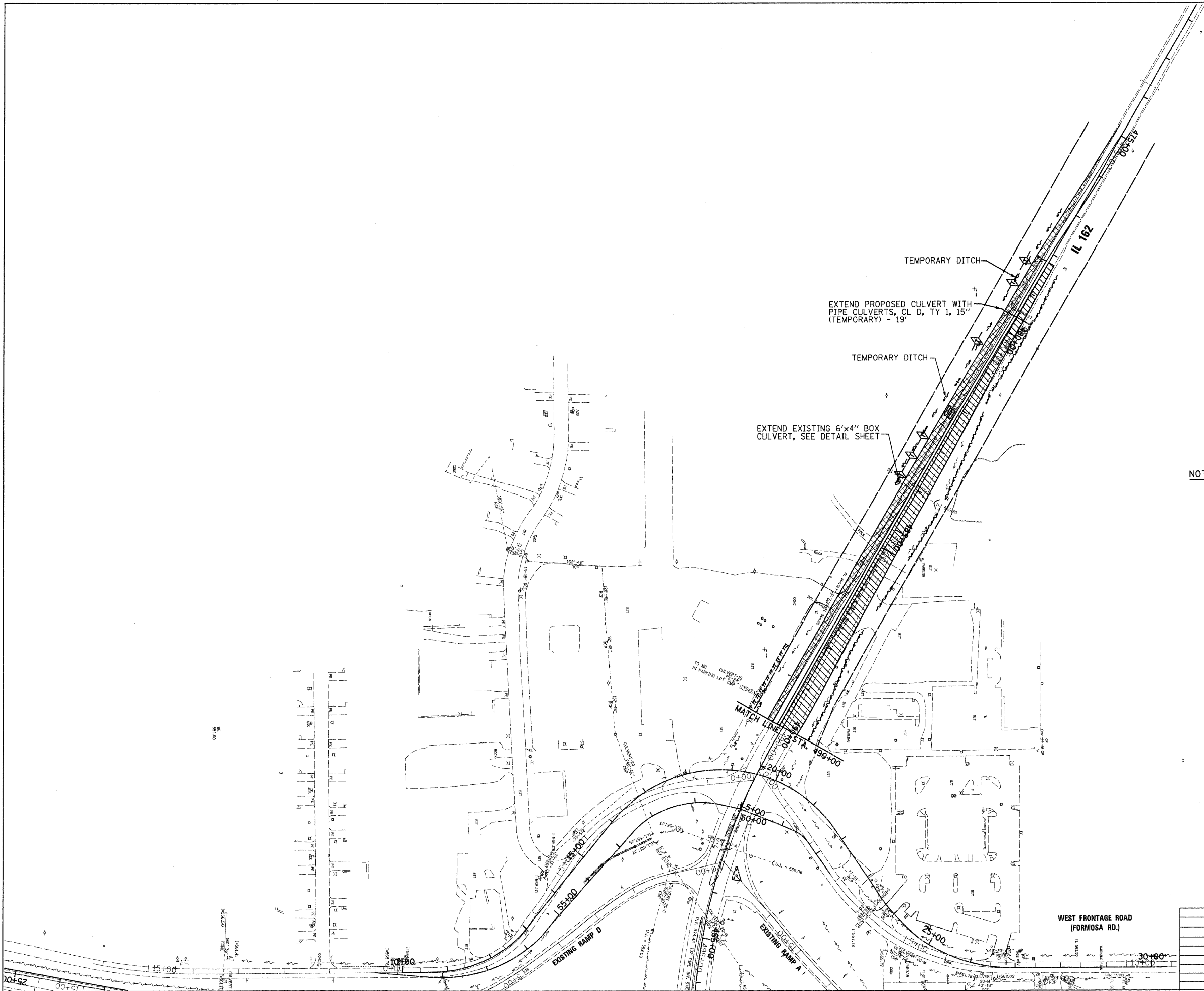

REVISIONS	
NAME	DATE

ILLINOIS DEPARTMENT OF TRANSPORTATION
EROSION CONTROL AND TEMPORARY DRAINAGE PLAN (STAGE I) - 3

FAP ROUTE 70
 SECTION 60-10K-1, 60-10HB
 MADISON COUNTY

DRAWN BY: GRH
 PLOT DATE: *DATE-TIME*

DATE-TIME
 JOB-SPEC
 REF