

FAI ROUTE	SECTION	COUNTY	TOTAL SHEETS	SHEET NO.
70		MADISON	420	134
STA. 494+00		TO STA. 499+80		
CONTRACT NO.: 76709				
• 60-10K-1, 60-10HB				

DATE	BY
PLANNED	
DESIGNED	
CHECKED	
APPROVED	

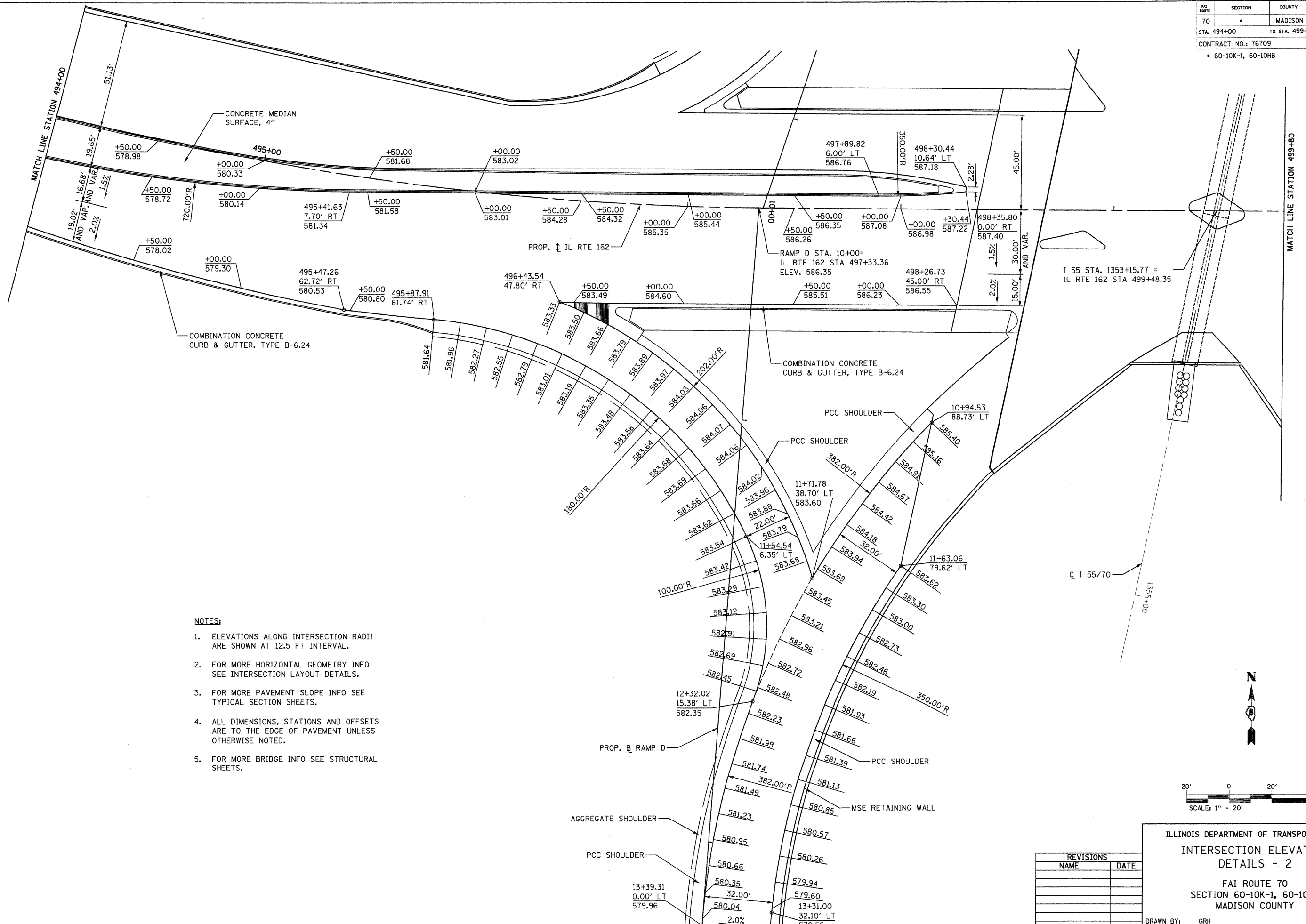

- NOTES:**
1. ELEVATIONS ALONG INTERSECTION RADII ARE SHOWN AT 12.5 FT INTERVAL.
 2. FOR MORE HORIZONTAL GEOMETRY INFO SEE INTERSECTION LAYOUT DETAILS.
 3. FOR MORE PAVEMENT SLOPE INFO SEE TYPICAL SECTION SHEETS.
 4. ALL DIMENSIONS, STATIONS AND OFFSETS ARE TO THE EDGE OF PAVEMENT UNLESS OTHERWISE NOTED.
 5. FOR MORE BRIDGE INFO SEE STRUCTURAL SHEETS.

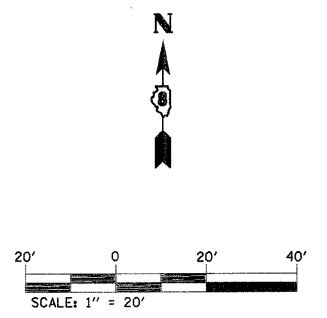

REVISIONS	
NAME	DATE

ILLINOIS DEPARTMENT OF TRANSPORTATION
**INTERSECTION ELEVATION
 DETAILS - 2**
 FAI ROUTE 70
 SECTION 60-10K-1, 60-10HB
 MADISON COUNTY
 DRAWN BY: GRH
 PLOT DATE: *DATE-TIME*

DATE-TIME
 REF- 236c0201.dgn
 REF- 236c020.dgn
 REF- 236c020.dgn