

FILE NO.	SECTION	COUNTY	TOTAL SHEETS	SHEET NO.
70		MADISON	420	138
STA. 504+50		TO STA. 510+50		

CONTRACT NO.: 76709
• 60-10K-1, 60-10HB

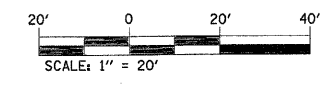

PLAN	SURVEYED	DATE
	PLOTTED	
	CHECKED	
	BY	
	NO. OF SHEETS	
	NO. OF SHEETS CHECKED	
	CAD FILE NAME	

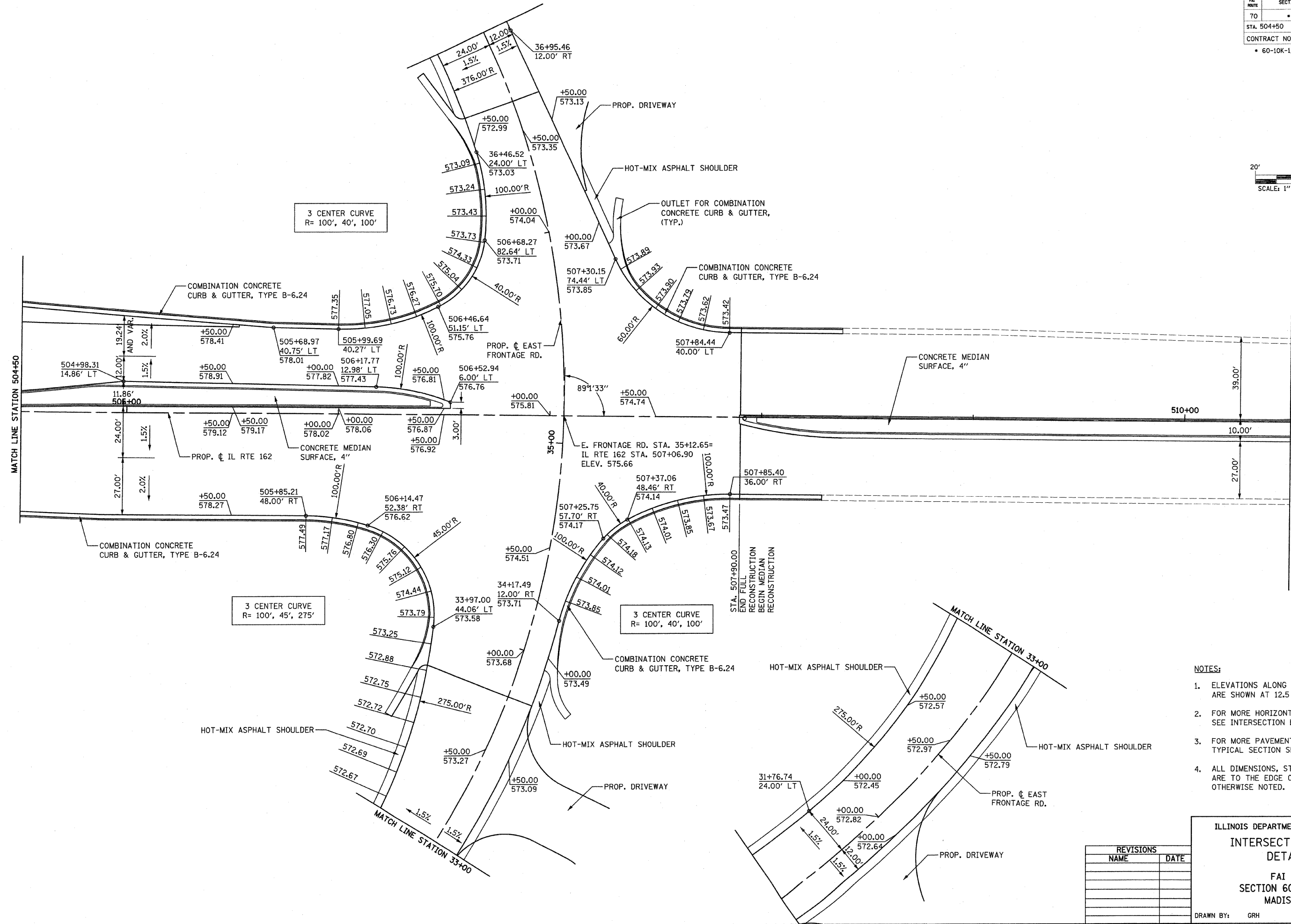

- NOTES:**
1. ELEVATIONS ALONG INTERSECTION RADII ARE SHOWN AT 12.5 FT INTERVAL.
 2. FOR MORE HORIZONTAL GEOMETRY INFO SEE INTERSECTION LAYOUT DETAILS.
 3. FOR MORE PAVEMENT SLOPE INFO SEE TYPICAL SECTION SHEETS.
 4. ALL DIMENSIONS, STATIONS AND OFFSETS ARE TO THE EDGE OF PAVEMENT UNLESS OTHERWISE NOTED.

REVISIONS	
NAME	DATE

ILLINOIS DEPARTMENT OF TRANSPORTATION
**INTERSECTION ELEVATION
 DETAILS - 6**
 FAI ROUTE 70
 SECTION 60-10K-1, 60-10HB
 MADISON COUNTY
 DRAWN BY: GRH
 PLOT DATE: .DATE-TIME.

• DON-SPEC
 • REF- 2350H20L01
 • REF- 2350020L01