

| FAI ROUTE | SECTION | COUNTY | TOTAL SHEETS | SHEET NO |
|---------------------|---------|-----------------|--------------|----------|
| 70 | | MADISON | 420 | 143 |
| STA. 1351+00 | | TO STA. 1365+00 | | |
| CONTRACT NO. 76709 | | | | |
| • 60-10K, 60-10-4HB | | | | |

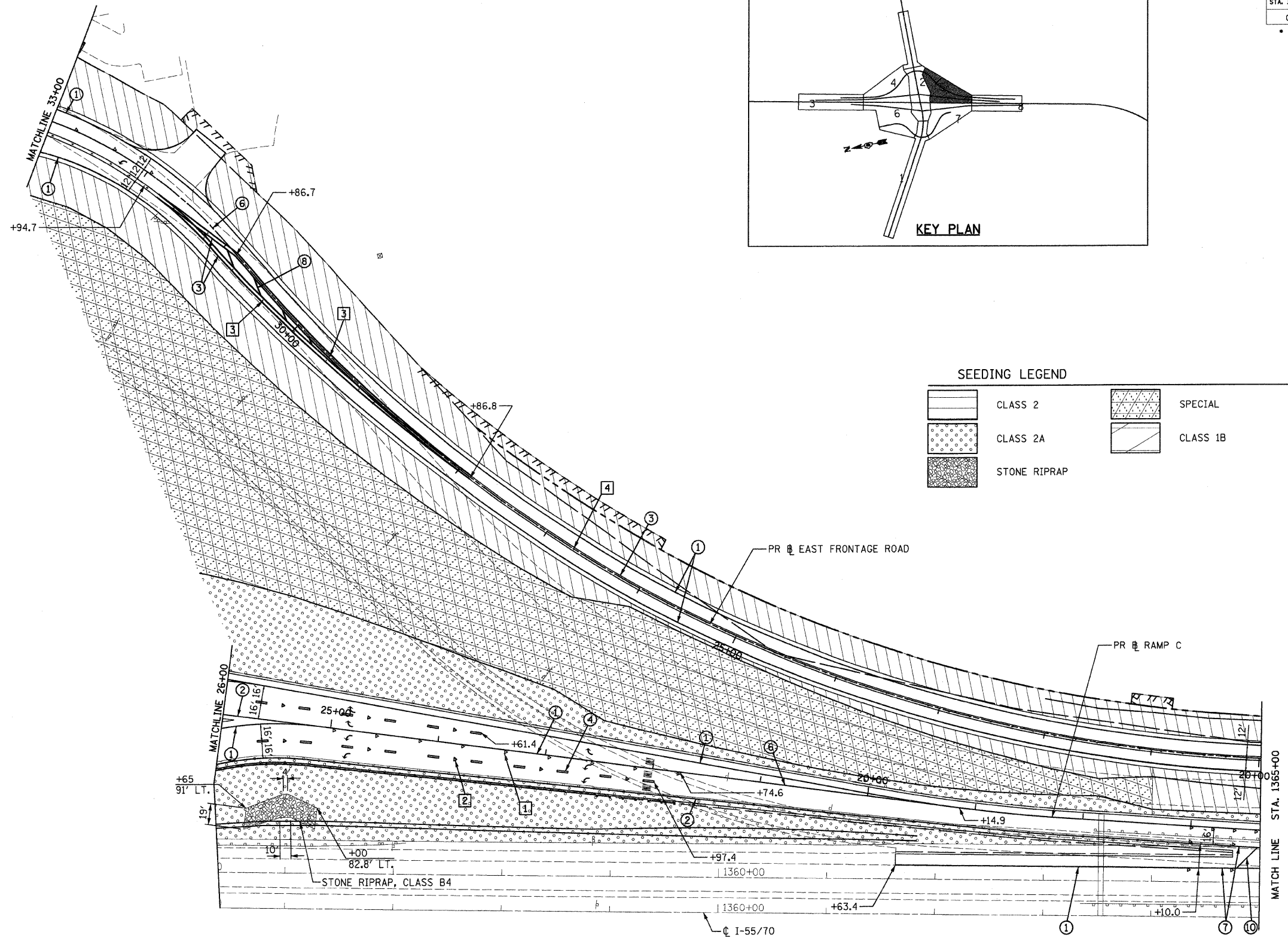
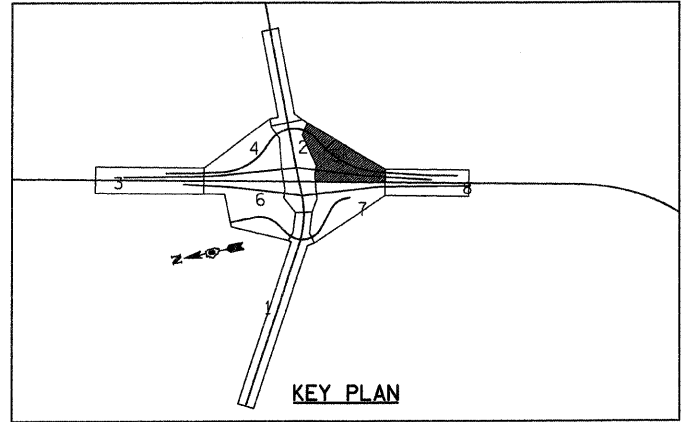

SEEDING LEGEND

| | | | |
|-----------|--------------|-----------|----------|
| [Pattern] | CLASS 2 | [Pattern] | SPECIAL |
| [Pattern] | CLASS 2A | [Pattern] | CLASS 1B |
| [Pattern] | STONE RIPRAP | | |

PAVEMENT MARKING LEGEND

- ① 4" WHITE SOLID
- ② 4" YELLOW SOLID
- ③ 4" DOUBLE YELLOW SOLID
- ④ 4" WHITE SKIP-DASH
- ⑤ 4" YELLOW SKIP-DASH
- ⑥ 4" WHITE DASHED
- ⑦ 8" WHITE SOLID

- ⑧ 12" YELLOW DIAGONAL-20'C-C
- ⑨ 12" WHITE DIAGONAL-20'C-C
- ⑩ 12" WHITE DIAGONAL-30'C-C
- ⑪ 24" STOP BAR (TYP.)
- ⑫ TURN ARROW WHITE
- ⑬ CURB MARKING (SEE DETAIL)

RAISED REFLECTIVE PAVEMENT MARKER LEGEND

- ① CRYSTAL ONE-WAY-40'C-C
- ② CRYSTAL ONE-WAY-80'C-C
- ③ AMBER ONE-WAY-40'C-C
- ④ AMBER TWO-WAY-40'C-C
- ⑤ PRISMATIC CURB REFLECTOR ON CURBS (SEE DETAIL)

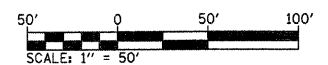

REVISIONS

| NAME | DATE |
|------|------|
| | |
| | |
| | |
| | |
| | |

ILLINOIS DEPARTMENT OF TRANSPORTATION
PROPOSED PAVEMENT MARKING AND SEEDING PLAN - 5
 FAI ROUTE 70
 SECTION 60-10K, 60-10-4HB
 MADISON COUNTY

DRAWN BY: GRH
 PLOT DATE: *DATE-TIME*

| | | |
|---------------|--------------------|------|
| PLAN | SURVEYED | DATE |
| NOTE BOOK NO. | ALIGNED | |
| | CHECKED | |
| | BY: OF WAY CHECKED | |
| | PAID FILE NAME | |

DATE-TIME
 DATE-TIME
 DATE-TIME
 DATE-TIME
 DATE-TIME
 DATE-TIME
 DATE-TIME