

SECTION	COUNTY	TOTAL SHEETS	SHEET NO.
60-10 (K-1,HB)	MADISON	420	196
CONTRACT NO.: 76709			

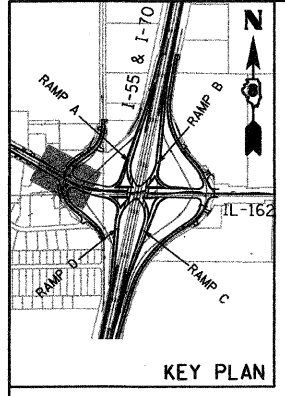

TRAFFIC SIGNALS LEGEND

- PROPOSED
- CONTROLLER
 - SERVICE INSTALLATION
 - GALVANIZED STEEL CONDUIT (T) INDICATES IN TRENCH (P) INDICATES PUSHED
 - HANDHOLE
 - DOUBLE HANDHOLE
 - SIGNAL POST
 - MAST ARM ASSEMBLY AND POLE, STEEL
 - SIGNAL HEAD
 - SIGNAL HEAD WITH BACKPLATE
 - SIGN ON SIGNAL POLE / MAST ARM
 - DETECTOR LOOP
 - ADVANCED DETECTOR LOOP INTERCONNECT SYSTEMS DETECTOR LOOP

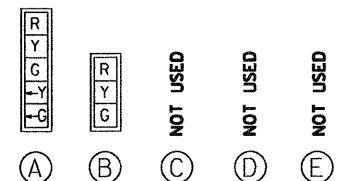

2 TRAFFIC SIGNALS FACES
N.T.S.

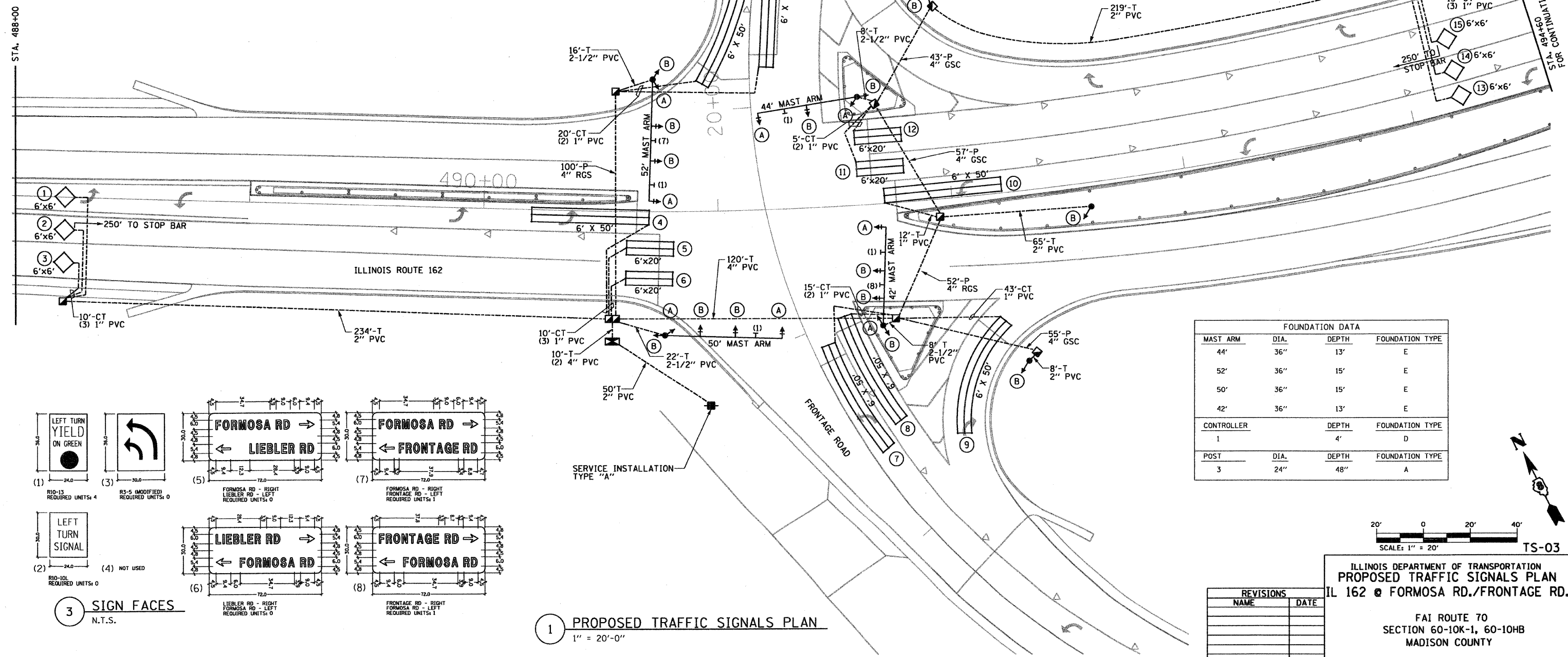

FOUNDATION DATA

MAST ARM	DIA.	DEPTH	FOUNDATION TYPE
44'	36"	13'	E
52'	36"	15'	E
50'	36"	15'	E
42'	36"	13'	E
CONTROLLER	DEPTH		FOUNDATION TYPE
1	4'		D
POST	DIA.	DEPTH	FOUNDATION TYPE
3	24"	48"	A

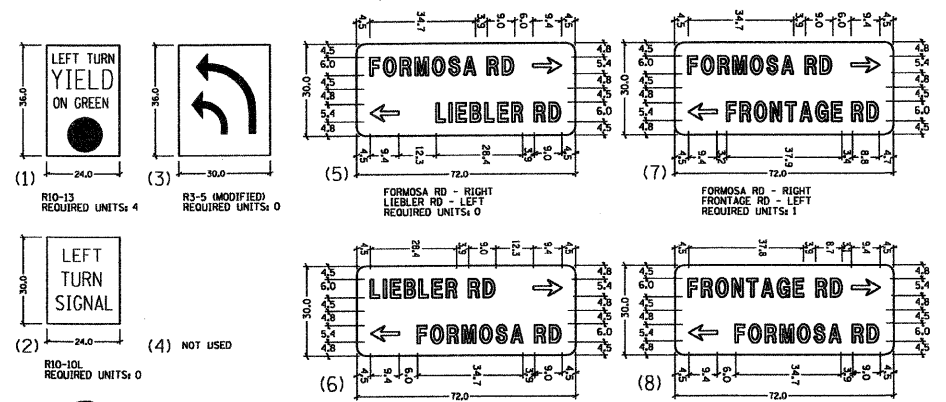

3 SIGN FACES
N.T.S.

1 PROPOSED TRAFFIC SIGNALS PLAN
1" = 20'-0"

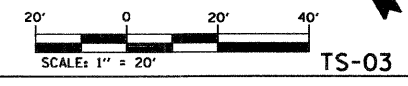

REVISIONS

NAME	DATE

ILLINOIS DEPARTMENT OF TRANSPORTATION
PROPOSED TRAFFIC SIGNALS PLAN
IL 162 @ FORMOSA RD./FRONTAGE RD.

FAI ROUTE 70
SECTION 60-10K-1, 60-10HB
MADISON COUNTY

DRAWN BY: RPJ CHECKED BY: A. OSHANA, P.E.

PLAN

DATE	BY	REVISION

XXXXXX - 1007 IL 162 over 1-55.70 revisions
236-15-03 West_Plan.dgn
1/28/2009 5:14:30 PM
Robert Swanson