

F.A. RTE.	SECTION	COUNTY	TOTAL SHEETS	SHEET NO.
70		MADISON	420	208
STA.		TO STA.		
FED. ROAD DIST. NO.	ILLINOIS	FED. AID PROJECT		
• 60-10K-1, 60-10HB				

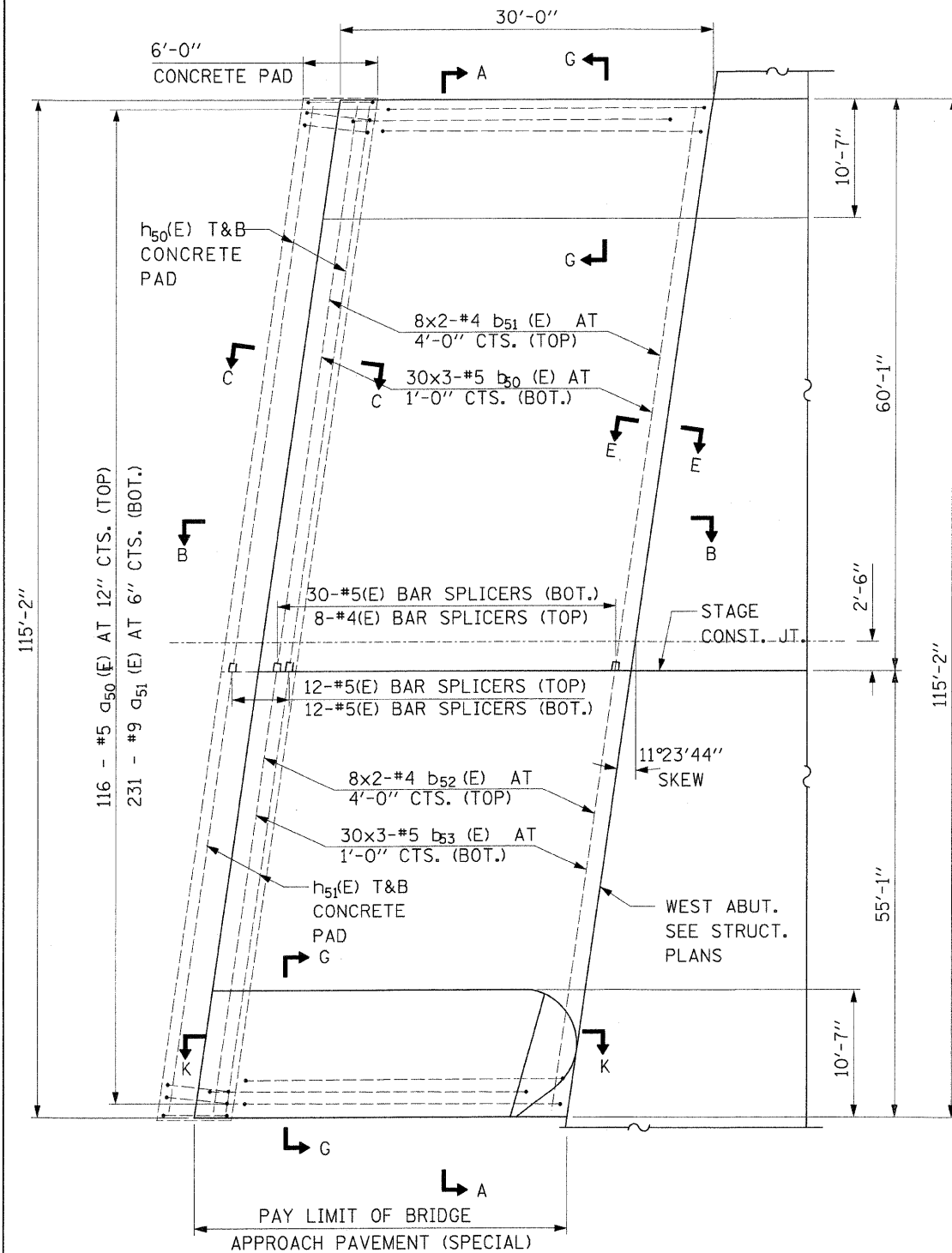

BRIDGE APPROACH PAVEMENT PLAN - WEST

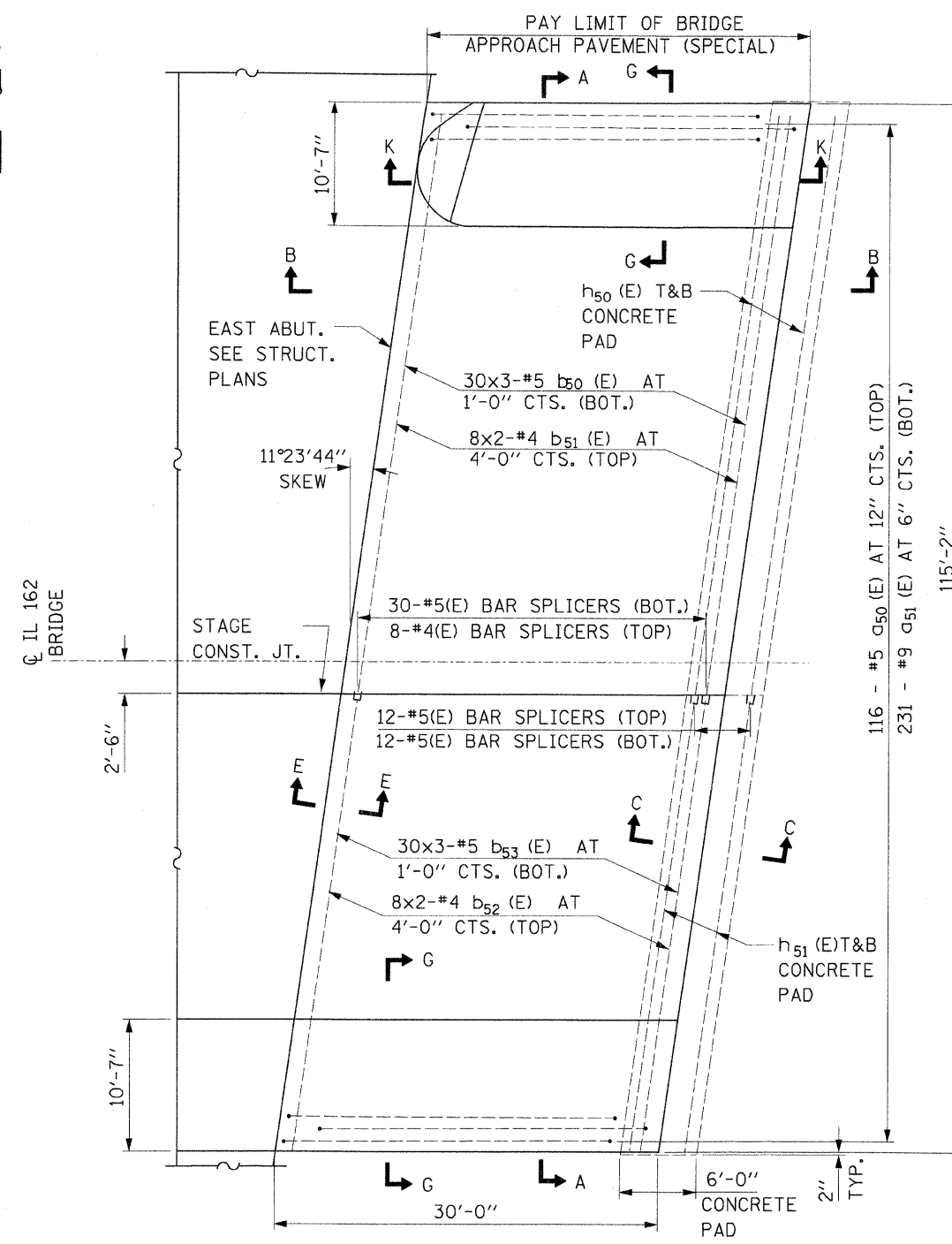
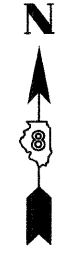

BRIDGE APPROACH PAVEMENT PLAN - EAST

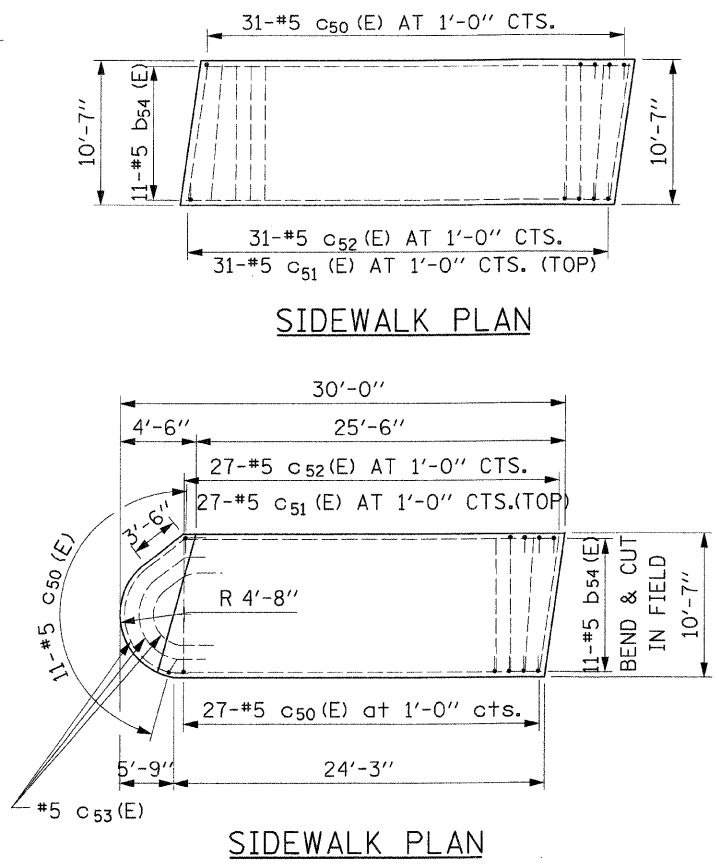

GENERAL NOTES

1. SEE STANDARD 421001 FOR REINFORCEMENT DETAILS NOT SHOWN.
2. SEE STANDARD 420001 FOR DETAILS OF JOINTS NOT SHOWN.
3. REFER TO STRUCTURAL BRIDGE PLANS FOR ABUTMENT.

- MIN. LAP
- #4 = 1'-8"
 - #5 = 2'-2"
4. BLOCK OUT CONCRETE SLEEPER SLAB FOR STEEL PLATE BEAM GUARD RAIL POSTS. COORDINATE WITH STANDARD 631031.

REVISIONS	
NAME	DATE

ILLINOIS DEPARTMENT OF TRANSPORTATION

BRIDGE APPROACH PAVEMENT

FAI ROUTE 70

SECTION 60-10K, 60-10-4HB

MADISON COUNTY

SCALE: NOT TO SCALE

DATE: 4/06

DRAWN BY: HJB

CHECKED BY: JAW