

F.A.I. RTE.	SECTION	COUNTY	TOTAL SHEETS	SHEET NO.
70		MADISON	420	305
STA.	TO STA.			
FED. ROAD DIST. NO.	ILLINOIS	FED. AID PROJECT		
60-10K-1, 60-10HB		CONTRACT NO. 76709		

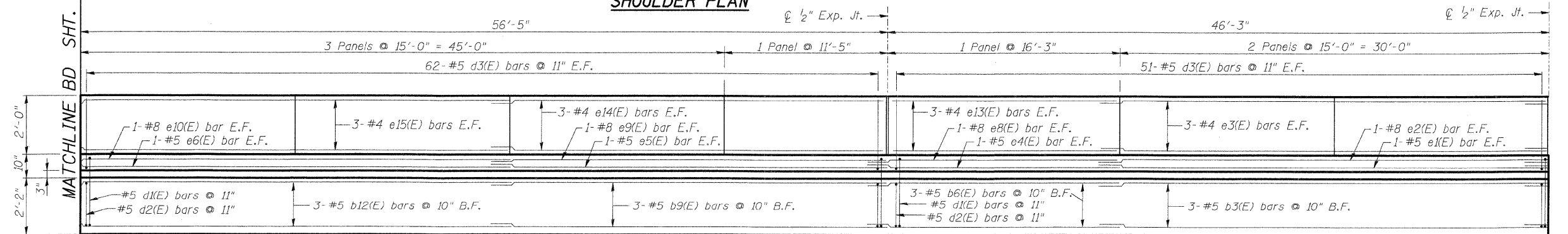
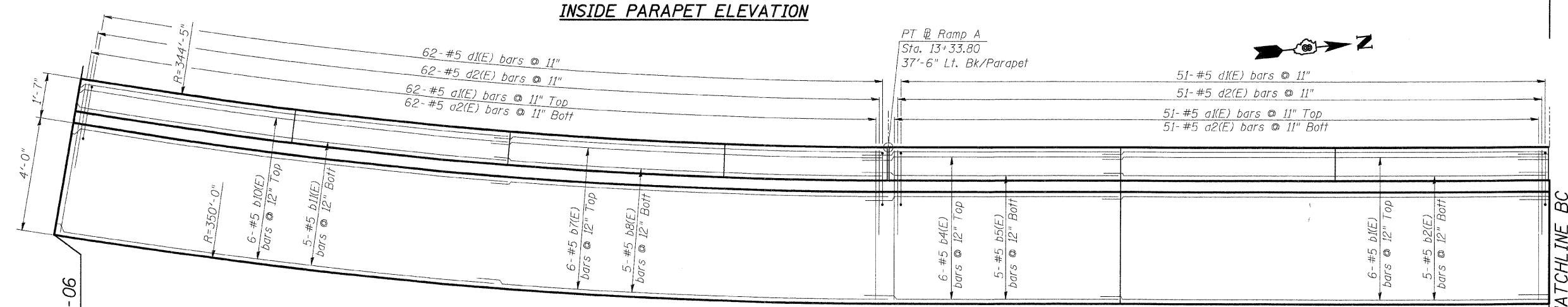
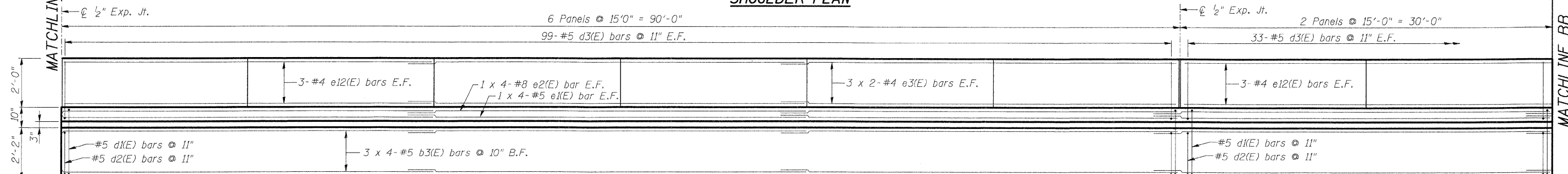
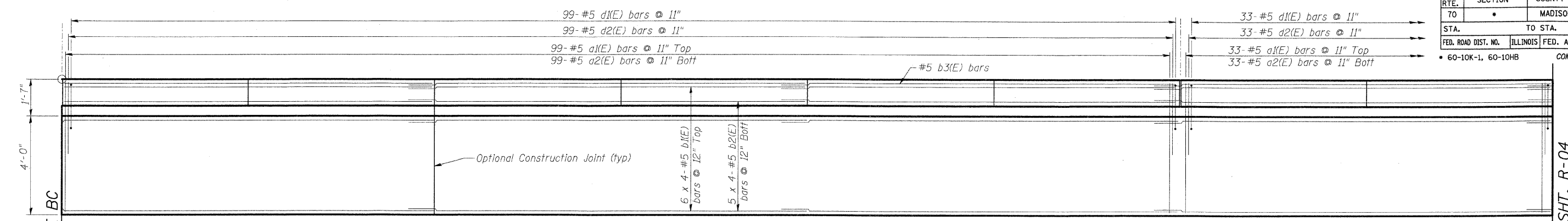

INSIDE PARAPET ELEVATION

MIN. BAR LAP

- #4 - 1'-4"
- #5 - 2'-2"
- #8 - 4'-6"

Sht. R-05 of R-13

STV Incorporated
Engineers/Architects/Planners/Construction Managers
200 W. Monroe Street, Suite 1650
Chicago, IL 60606-3015
312-553-0655, FAX 312-553-0661

REVISIONS	
NAME	DATE

ILLINOIS DEPARTMENT OF TRANSPORTATION
IL ROUTE 162 OVER I-55/70 IN TROY
F.A.I ROUTE 70 SECTION 60-10K-1, 60-10HB
MADISON COUNTY STA. 17+40 TO STA. 22+50
STRUCTURE NO. 060-W006

**PARAPET ELEVATIONS & SHOULDER PLANS
RAMP B**

DRAWN BY KM
CHECKED BY BJG
DATE: 05/2006