

BENCH MARK 203: RR SPIKE DRIVEN IN NORTH SIDE OF POWER POLE ON SOUTH SIDE RT. 3, NEAR NORTHWEST CORNER OF GRAVEL TURN-A-ROUND, 600' WEST OF CENTER OF BRIDGE, SN 060-0153 AT PIASA CREEK
APPROX. STA.: ±632+00, RT, ELEV.= 449.141

BENCH MARK 204: RR SPIKE DRIVEN IN NORTH SIDE OF POWER POLE ON SOUTH SIDE RT. 3, ON WEST SIDE OF GRAVEL SERVICE ROAD, 232' EAST OF CENTER OF BRIDGE, SN 060-0153 AT PIASA CREEK
APPROX. STA.: ±640+32, RT, ELEV.= 443.672

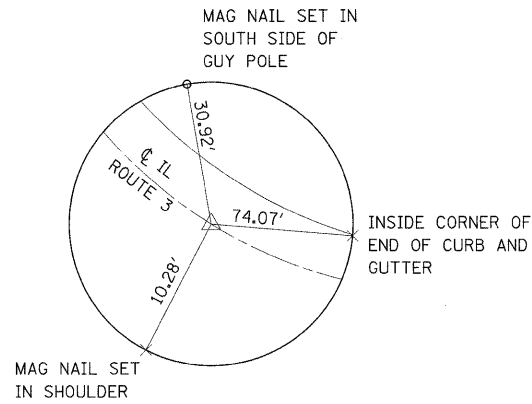

TIE POINT
MAG NAIL
P.C. STA. 629+29.69

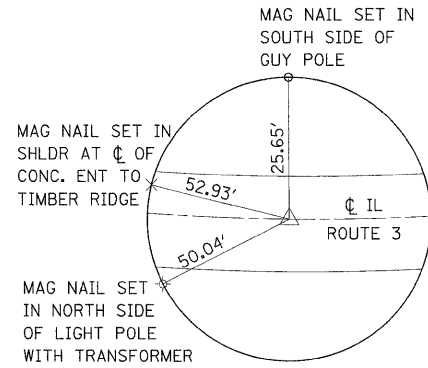

TIE POINT
MAG NAIL
P.T. STA. 631+77.44

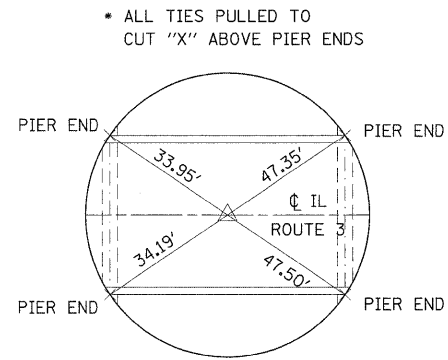

TIE POINT
MAG NAIL
BRIDGE C STA 638+00

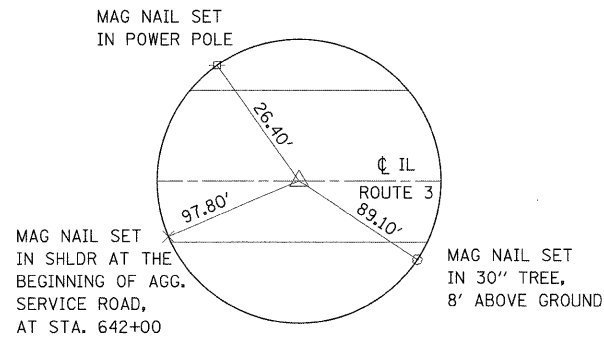

TIE POINT
MAG NAIL
P.C. STA. 642+97.06
±175' WEST OF C OF HIGH MEADOW LANE

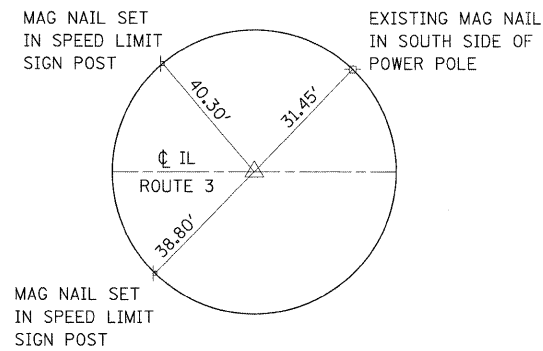

TIE POINT
MAG NAIL
P.O.C. STA. 646+22.35
±162' EAST OF C OF HIGH MEADOW LANE

NOTES: ALL TIES PULLED DIRECT
NOT TO SCALE

FILE NAME =	USER NAME = herbaughrd	DESIGNED -	REVISED -	STATE OF ILLINOIS DEPARTMENT OF TRANSPORTATION	TIE POINTS & BENCHMARKS			F.A.U. RTE.	SECTION	COUNTY	TOTAL SHEETS	SHEET NO.
et:\pw_work\pwidot\harbaughrd\dms52107\p	02106a.dgn	DRAWN -	REVISED -		8956	59BR-1	MADISON	75	8			
PLOT SCALE = 50.0000' / IN.	CHECKED -	REVISED -	REVISED -		CONTRACT NO. 76B18							
PLOT DATE = 3/16/2009	DATE -	REVISED -	REVISED -		SCALE:	SHEET NO.	OF SHEETS	STA.	TO STA.	FED. ROAD DIST. NO.	ILLINOIS FED. AID PROJECT	