

STATE OF ILLINOIS
DEPARTMENT OF TRANSPORTATION

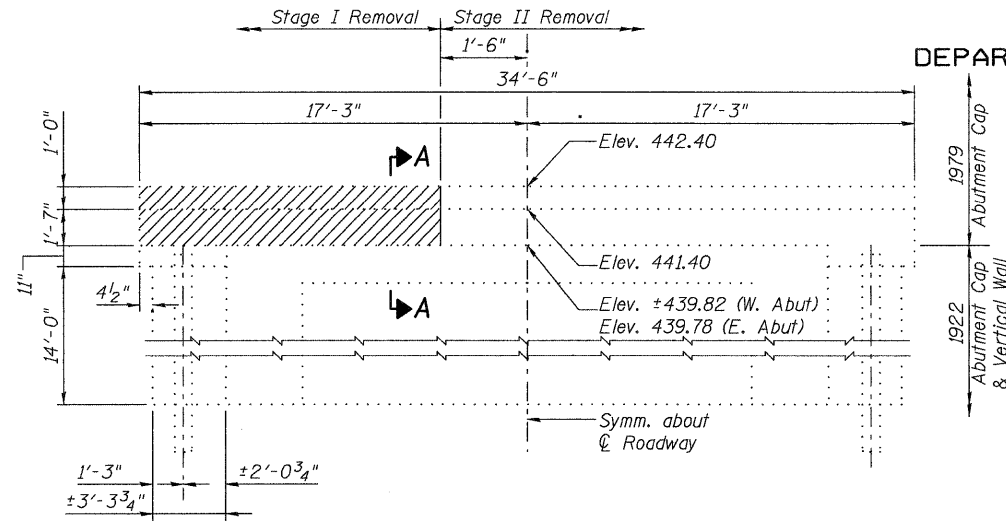

ELEVATION - ABUTMENT
(East Abutment - Looking East)
(West Abutment similar, but opposite hand)

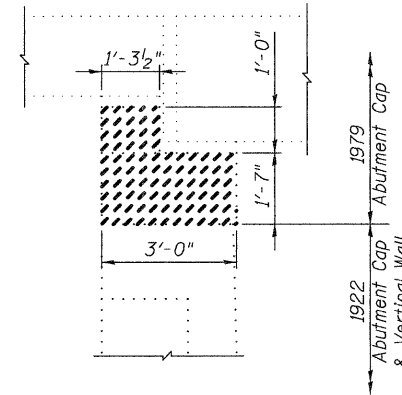

Section A-A

Removal of Existing Abutments Notes:

Stage 1 Removal

Removal of the westbound portion of the struts, side walls and approach bents, located behind the proposed abutments, shall be the minimum amount necessary for the placement of the soil retention system and the construction of the proposed abutments and bridge approach slabs, in accordance with Section 501 of the Standard Specifications.

Removal of the westbound portion of the abutment cap and side walls, located in front of the proposed abutments, shall extend down to the elevation shown corresponding to the top of the original 1922 abutment cap. The original 1922 abutment cap, the vertical wall, the side walls and struts, shall remain in place through Stage 1 Construction.

Stage 2 Removal

The removal of the remaining portion of the Abutments shall be in accordance with Section 501 of the Standard Specifications.

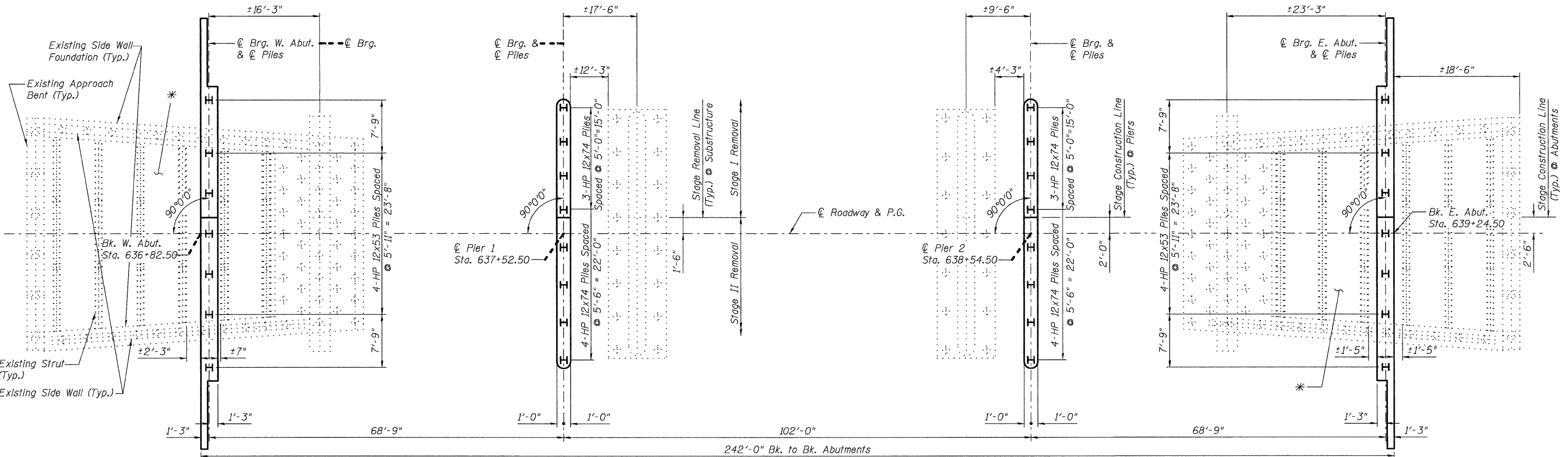

* Based on as-built drawings, the area confined by the existing abutment vertical wall, side walls and approach bent contains earth material.

SUBSTRUCTURE LAYOUT
ILLINOIS ROUTE 3 OVER
PIASA CREEK
F.A.U. ROUTE 8956 SEC 59BR-1
MADISON COUNTY
STATION 638+11.00
STRUCTURE NO. 060-0343

DESIGNED	DB
CHECKED	RS
DRAWN	ER
CHECKED	WWH



Juneau Associates, Inc. P.C.
CONSULTING ENGINEERS AND LAND SURVEYORS
2100 State Street
Granite City, Illinois 62040
Phone: (618) 977-1400
Fax: (618) 652-5541
100 North Research Drive
Edwardsville, Illinois 62025
Phone: (618) 659-9900/(618) 659-0800
Fax: (618) 659-4941
Registered Professional Service Corporation License No. 184-003389

SHEET NO. 4 28 SHEETS	F.A.U. RTE.	SECTION	COUNTY	TOTAL SHEETS	SHEET NO.
	8956	59BR-1	MADISON	75	33
STRUCTURE NO. 060-0343			CONTRACT NO. 76B18		
FED. ROAD DIST. NO.		ILLINOIS	FED. AID PROJECT		