

DATE	
BY	
DESIGNED	
DRAWN	
CHECKED	
DATE	
FILE NAME	
PROJECT NO.	
SECTION	
COUNTY	
TOTAL SHEETS	
SHEET NO.	

DATE	
BY	
DESIGNED	
DRAWN	
CHECKED	
DATE	
FILE NAME	
PROJECT NO.	
SECTION	
COUNTY	
TOTAL SHEETS	
SHEET NO.	

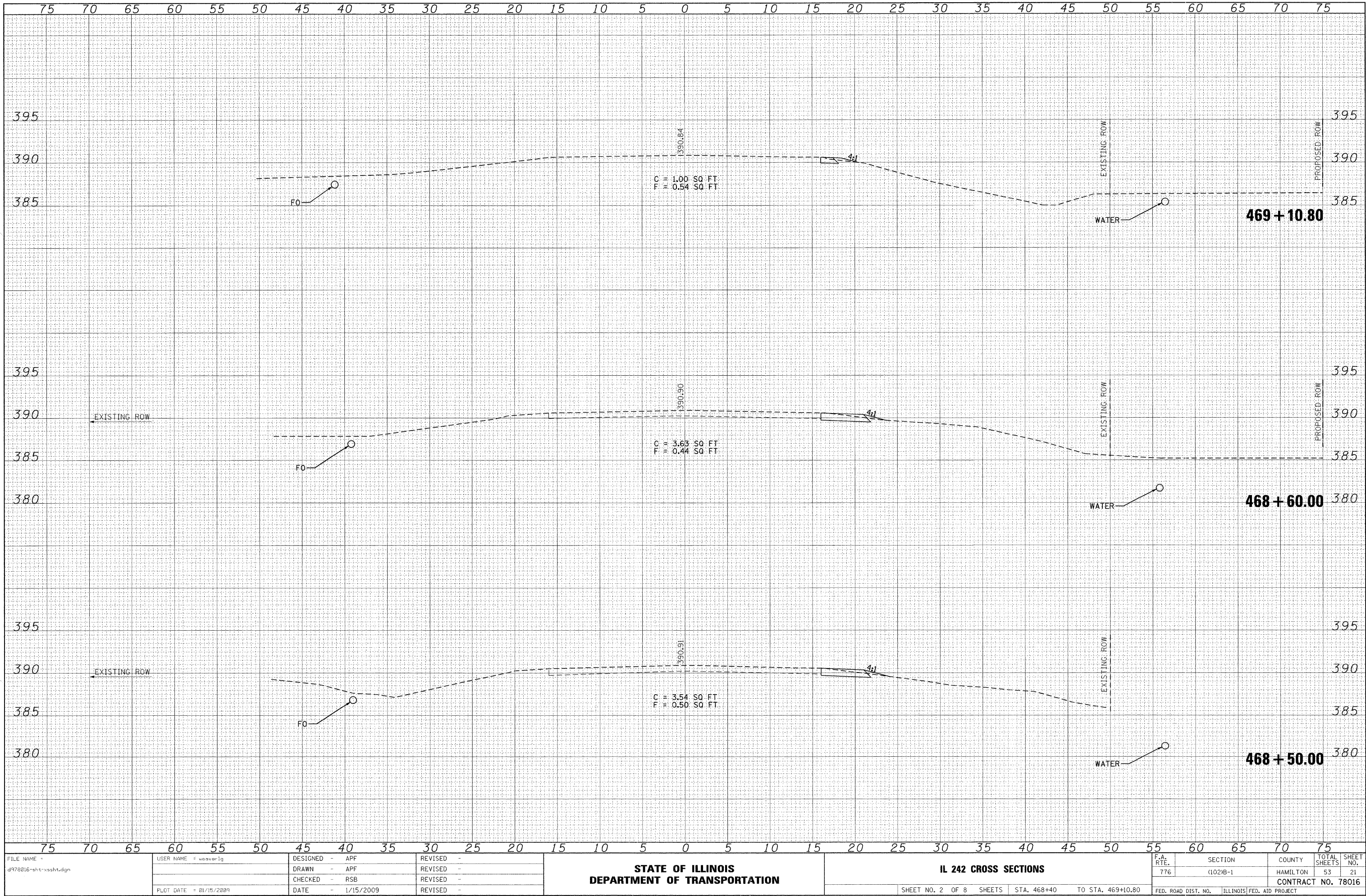

FILE NAME = d978016-sh1-xssht.dgn	USER NAME = weaverlg	DESIGNED - APF	REVISED -	STATE OF ILLINOIS DEPARTMENT OF TRANSPORTATION	IL 242 CROSS SECTIONS				F.A. RTE.	SECTION	COUNTY	TOTAL SHEETS	SHEET NO.
		DRAWN - APF	REVISED -						776	(102)B-1	HAMILTON	53	21
		CHECKED - RSB	REVISED -						CONTRACT NO. 78016				
	PLOT DATE = 01/15/2009	DATE - 1/15/2009	REVISED -						SHEET NO. 2 OF 8 SHEETS		STA. 468+40 TO STA. 469+10.80		FED. ROAD DIST. NO.